

(R-82-1034)

RESOLUTION NUMBER R- 255790

Adopted on FEB 8 1982

WHEREAS, Section 8330 et seq. of the Streets and Highways Code provides a procedure for the summary vacation of streets by City Council resolution where the street to be vacated is excess to City needs; and

WHEREAS, in connection with said vacation the City desires to reserve certain easement; and

WHEREAS, the property owners have requested the vacation of Scripps Westview Circle adjacent to Lot 3, Scripps Westview, Map 10109; and

WHEREAS, the street to be vacated is excess right-of-way; and

WHEREAS, the street to be vacated lies within property under one ownership and does not continue through such ownership; NOW, THEREFORE,

BE IT RESOLVED, by the Council of The City of San Diego, as follows:

1. That Scripps Westview Circle, adjacent to Lot 3, Scripps Westview, Map 10109, as more particularly shown on Drawing No. 15472-B on file in the office of the City Clerk as Document No. RR- 255790-, which is by this reference incorporated herein and made a part hereof, be and the same is hereby ordered vacated.

2. That the general utility easement in Scripps Westview

Circle, adjacent to Lot 3, Scripps Westview, Map 10109, as more particularly shown on Drawing No. 15472-B, a copy of which is attached hereto and by this reference herein is hereby reserved.

3. That The City of San Diego hereby reserves and excepts the right, easement and privilege of placing, constructing, repairing, replacing, maintaining, using and operating public utilities of any kind or nature, including, but not limited to general utilities and all necessary and proper fixtures and equipment for use in connection therewith, through, over, under, upon, along and across the hereinafter described easement, together with the right of ingress thereto and egress therefrom, together with the right to maintain the said easement free and clear of any excavation or fills, the erection or construction of any building or other structures, the planting of any tree or trees thereon, or the drilling or digging of any well or wells thereon, together with the right to otherwise protect from all hazards the operation and use of any right hereby reserved.

add
Upon acquisition of encroachment permit from the City Engineer pursuant to the Municipal Code of the City, the owners of the underlying fee may utilize the above-described parcel of land for structures, the planting or growing of trees or the installation of privately owned pipelines.

4. That the City of San Diego hereby reserves and excepts from vacation and abandonment, easements and rights of any public utility pursuant to any existing franchise or renewals thereof, at any time, or from time to time, to construct, maintain, operate, replace, remove, renew and enlarge overhead or underground lines of pipe, conduits, cables, wires, poles and

other structures, equipment and fixtures for the transportation and distribution of electrical or electronic energy and natural gas and for incidental purposes including access to protect the property from all hazards in, upon, over and across the above-described portions of streets to be vacated and abandoned.

5. That the City Clerk shall cause a certified copy of this resolution, with drawing, attested by him under seal, to be recorded in the office of the County Recorder.

APPROVED: John W. Witt, City Attorney

By 
Janis Sammartino Gardner, Deputy

JSG:ta:221.1
1/20/82
Or./Dept:E&D
R-82-1034
W.O.:117729
15472-B
Form=r.sumv

LOT 2
MAP NO. 10109

N 86°39'42"W 319.81'
SCRIPPS WESTVIEW WAY
DEDICATED PER MAP NO. 10109

$\Delta = 88^{\circ}59'41''$
 $R = 48'$
 $L = 74.56'$
T.P.O.B.

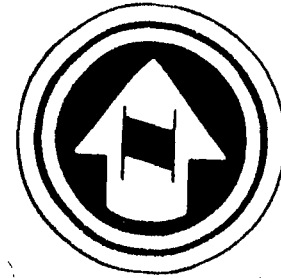

LOT 3

MAP NO. 10109

SCALE: 1"=100'

**ASSESSOR'S
PARCEL NO**

319-150-08

BASIS OF BEARINGS

THE BASIS OF BEARINGS FOR THIS
DWG. IS THE MOST SOUTHERLY
SUBDIVISION BOUNDARY OF SCRIPPS
WESTVIEW, MAP # 10109 I.E. N 88°21'41"W

**REFERENCE
DRAWINGS & MAP**

MAP # 10109
19337-16-D
19337-4-D

INDICATES AREA
VACATED AND GENERAL
UTILITY EASEMENT
RESERVED. AREA: 2.855 AC.

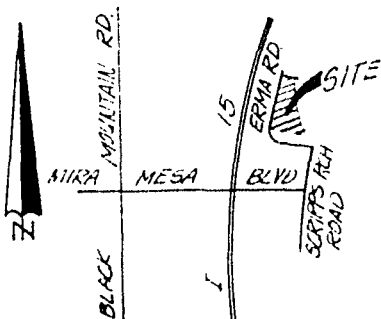

VICINITY MAP
SCALE

TABLE FOR STREET VACATION DATA

N ^o	Δ OR BEARING (RAD.)	LENGTH	N ^o	Δ OR BEARING (RAD.)	LENGTH
1	35°32'08"	20' 12.40'	19	60°19'33"	20' 21.06'
2	N 33°12'08"W	132.97'	20	84°08'20"	48' 70.49'
3	87°13'52"	73' 111.14'	21	N 59°34'01"E	148.16'
4	N 75°25'59"W	7.07'	22	160°50'30"	43' 120.71'
5	N 59°34'01"E	60.36'	23	N 40°24'31"E	35.43'
6	169°48'57"	92' 272.67'	24	N 49°22'57"E	149.14'
7	N 49°22'57"E	33.00'	25	N 85°37'03"W	7.07'
8	N 85°37'03"W	7.07'	26	N 49°22'57"E	51.31'
9	N 49°22'57"E	129.80'	27	40°55'01"	73' 52.13'
10	N 44°41'34"E	56.16'	28	N 89°42'02"W	28.59'
11	45°36'24"	122' 97.11'	29	120°00'21"	33' 69.12'
12	N 89°42'02"W	28.59'	30	N 3°43'23"W	7.92'
13	110°51'56"	82' 158.67'	31	N 41°16'37"E	80.61'
14	N 41°16'37"E	150.24'	32	N 86°16'37"E	7.07'
15	97°14'46"	25' 42.43'	33	N 41°16'37"E	41.10'
16	0°58'27"	78' 1.33'	34	18°17'24"	73' 23.30'
17	23°44'28"	122' 50.55'			
18	N 33°12'08"W	113.41'			



**ASSESSOR'S
PARCEL NO**
319-150-08

BASIS OF BEARINGS
THE BASIS OF BEARINGS FOR THIS
DNG. IS THE MOST SOUTHERLY
SUBDIVISION BOUNDARY OF SCRIPPS
WESTVIEW, MAP # 10109 I.E. N 88° 41' 41" W

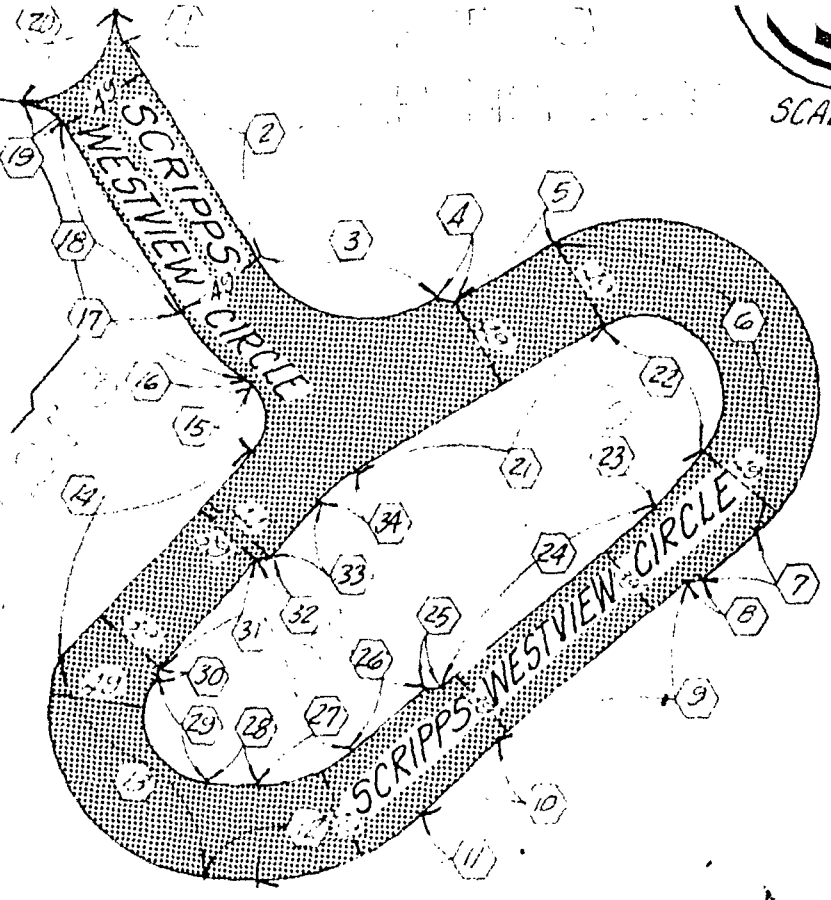

**REFERENCE
DRAWINGS & MAP**
MAP # 10109
19337-16-D
19337-4-D

INDICATES AREA
VACATED AND GENERAL
UTILITY EASEMENT
RESERVED. AREA: 2.855 AC.

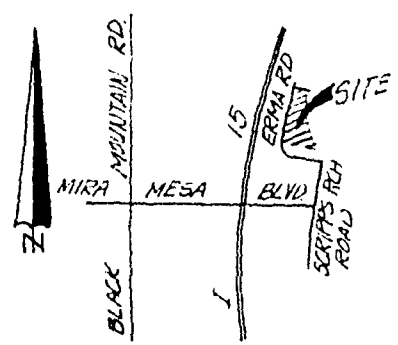

VICINITY MAP
NOT TO SCALE

TABLE FOR STREET VACATION DATA

NO	Δ OR BEARING (RAD)	LENGTH	NO	Δ OR BEARING (RAD)	LENGTH		
1	35° 32' 08"	20'	12.40'	19	60° 19' 33"	20'	21.06'
2	N 33° 12' 08" W	—	132.97'	20	84° 08' 20"	48'	70.49'
3	87° 13' 52"	73'	111.14'	21	N 59° 34' 01" E	—	148.16'
4	N 75° 25' 59" W	—	7.07'	22	160° 50' 30"	43'	120.71'
5	N 59° 34' 01" E	—	60.36'	23	N 40° 24' 31" E	—	35.43'
6	169° 48' 57"	92'	272.67'	24	N 49° 22' 57" E	—	149.14'
7	N 49° 22' 57" E	—	33.00'	25	N 85° 37' 03" W	—	7.07'
8	N 85° 37' 03" W	—	7.07'	26	N 49° 22' 57" E	—	51.31'
9	N 49° 22' 57" E	—	129.80'	27	40° 55' 01"	73'	52.13'
10	N 44° 21' 34" E	—	56.16'	28	N 89° 42' 02" W	—	28.59'
11	45° 36' 24"	122'	97.11'	29	120° 00' 21"	33'	69.12'
12	N 89° 42' 02" W	—	28.59'	30	N 3° 43' 23" W	—	7.92'
13	110° 51' 56"	82'	158.67'	31	N 41° 16' 37" E	—	80.61'
14	N 41° 16' 37" E	—	150.24'	32	N 86° 16' 37" E	—	7.07'
15	97° 14' 46"	25'	42.43'	33	N 41° 16' 37" E	—	41.10'
16	0° 58' 27"	78'	1.33'	34	18° 17' 24"	73'	23.30'
17	23° 44' 28"	122'	50.55'				
18	N 33° 12' 08" W	—	113.41'				

SHOLDERS & SANFORD, INC
Planning, Engineering, Surveying
3585 Fifth Avenue San Diego, CA 92103
Telephone (714) 299-7272

Robert W. Sanford DATE 8/17/81
ROBERT W. SANFORD R.C.E. 18405

DOCUMENT NO. **RR-255730**
FILED **FEB 8 1982**
OFFICE OF THE CITY CLERK
SAN DIEGO, CALIFORNIA

STREET VACATION: SCRIPPS WESTVIEW CIRCLE
ADJACENT TO LOT 3, SCRIPPS WESTVIEW, MAP 10109 & GENERAL UTILITY EASEMENT RESERVED FOR TM. 02-187

DESCRIPTION	BY	APPROVED	DATE	FILMED	CITY OF SAN DIEGO, CALIFORNIA	W O SA 81-639
ORIGINAL					SHEET 1 OF 1 SHEET	NO 117798
					<i>Robert W. Sanford</i> 7/09/1981	<i>Robert W. Sanford</i>
					FOR CITY ENGINEER	CONTROL CERTIFICATION
						274-1735
						LAMBERT COORDINATES
						15472 - B

Passed and adopted by the Council of The City of San Diego on FEB 8 1982,
 by the following vote:

Councilmen	Yeas	Nays	Not Present	Ineligible
Bill Mitchell	<input checked="" type="checkbox"/>	<input type="checkbox"/>	<input type="checkbox"/>	<input type="checkbox"/>
Bill Cleator	<input checked="" type="checkbox"/>	<input type="checkbox"/>	<input type="checkbox"/>	<input type="checkbox"/>
Susan Golding	<input checked="" type="checkbox"/>	<input type="checkbox"/>	<input type="checkbox"/>	<input type="checkbox"/>
Leon L. Williams	<input checked="" type="checkbox"/>	<input type="checkbox"/>	<input type="checkbox"/>	<input type="checkbox"/>
Ed Struiksma	<input checked="" type="checkbox"/>	<input type="checkbox"/>	<input type="checkbox"/>	<input type="checkbox"/>
Mike Gotch	<input checked="" type="checkbox"/>	<input type="checkbox"/>	<input type="checkbox"/>	<input type="checkbox"/>
Dick Murphy	<input checked="" type="checkbox"/>	<input type="checkbox"/>	<input type="checkbox"/>	<input type="checkbox"/>
Lucy Killea	<input checked="" type="checkbox"/>	<input type="checkbox"/>	<input type="checkbox"/>	<input type="checkbox"/>
Mayor Pete Wilson	<input checked="" type="checkbox"/>	<input type="checkbox"/>	<input type="checkbox"/>	<input type="checkbox"/>

AUTHENTICATED BY:

PETE WILSON
 Mayor of The City of San Diego, California.

(Seal)

CHARLES G. ABDELNOUR
 City Clerk of The City of San Diego, California.

By Barbara Berridge Deputy.

Office of the City Clerk, San Diego, California

Resolution Number R-255780 Adopted FEB 8 1982