

(R-82-1402)

RESOLUTION NUMBER R- 256186

Adopted on APR 12 1982

VACATION OF 34TH STREET, WHALEY AVENUE AND ASH STREET.

WHEREAS, it is proposed that 34th Street, Whaley Avenue and Ash Street be vacated; and

WHEREAS, there is no present or prospective use for the streets either for the public street system for which the right-of-way was acquired or for any other public use of a like nature that can be anticipated; and

WHEREAS, the public will benefit from the vacation through improved utilization of land; and

WHEREAS, the vacation or abandonment is not inconsistent with the General Plan or an approved Community Plan; and

WHEREAS, the public street system for which the right-of-way was originally acquired will not be detrimentally affected by this vacation; NOW, THEREFORE,

BE IT RESOLVED, by the Council of the City of San Diego, California, that 34th Street, Whaley Avenue and Ash Street, as more particularly referred to in Resolution of Intention No. R- 255942, is unnecessary for present or prospective public street purposes.

BE IT FURTHER RESOLVED, that 34th Street, Whaley Avenue and Ash Street, as more particularly shown on Drawing No. 19574-D on file in the office of the City Clerk as Document No. RR- 255942, which said Drawing is attached hereto and made a part hereof, be, and the same is hereby ordered vacated.

BE IT FURTHER RESOLVED, that the City Clerk shall cause a certified copy of this resolution, attested by him under seal, to be recorded in the office of the County Recorder.

APPROVED: John W. Witt, City Attorney

By 
Janis Sammartino Gardner, Deputy

JSG:ta:221.1
2/23/82
T.M.:79-127
W.O.:71384
I9574-D
R-82-1402
Or.Dept:E&D
Form=r.stv

BLOCK 87

MORSE, WHALEY & DALTON'S MAP 516

BLOCK

86

1 2 3 4 5 6 7 8 9 10

80'

80'

80'

WHALEY

SUBDIVISION BOUNDARY

A B C D E F G H

STREET

24 23 22 21 20 19 18 17 16 15 14
MORSE - WHALEY & DALTON'S

83

PROPOSED
PARCEL MAP
TM 01-235

BLOCK MAP 515

5 6 7 8 9 10

80'

N BOUNDARY

11/18

WHALEY'S MAP 516



PROPOSED PARCEL MAP TW 03-008

QUALITY BRANDS TRACT UNIT NO. 3 MAP 4929 PARCEL A

WESTERY BOUNDARY OF MAP 4929

WHALEY

SUBDIVISION BOUNDARY

AVENUE

STREET LIMITS

40'
80'
40'

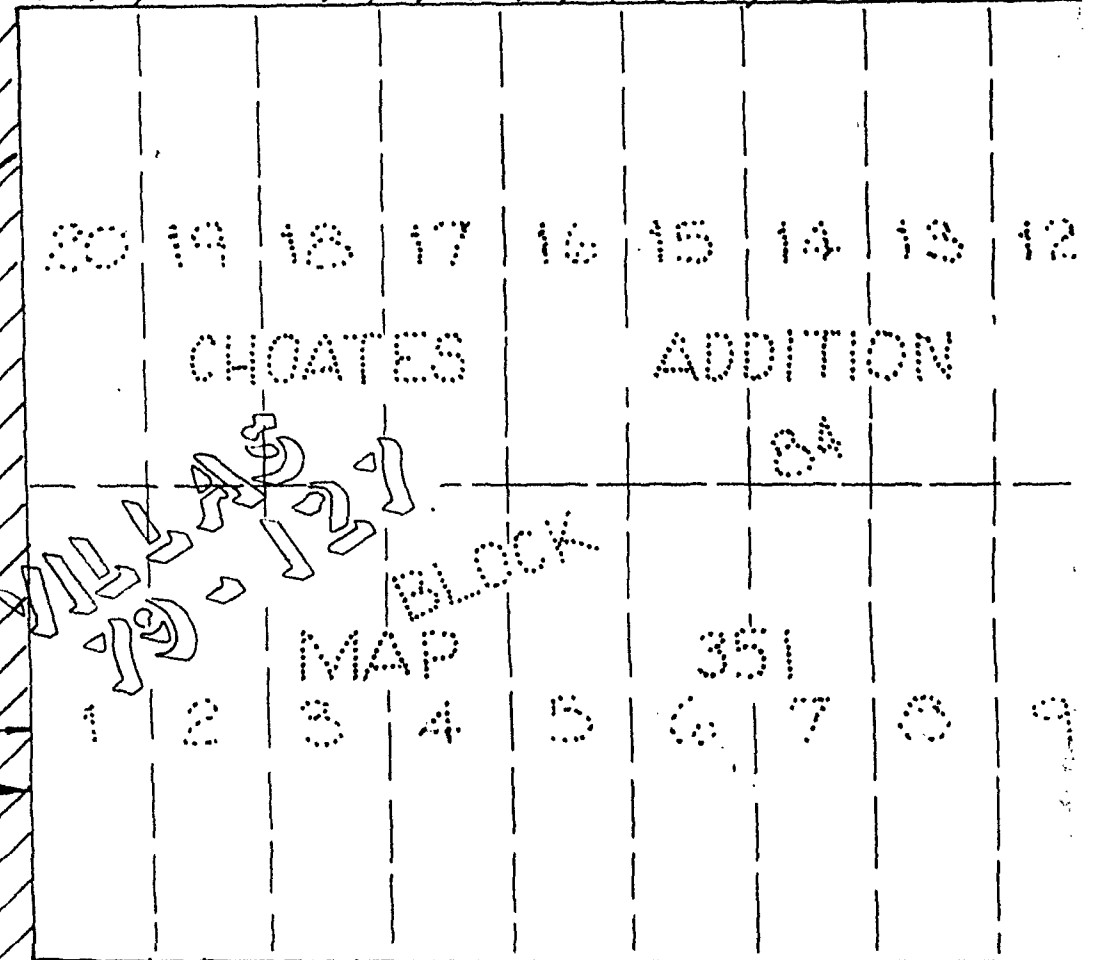
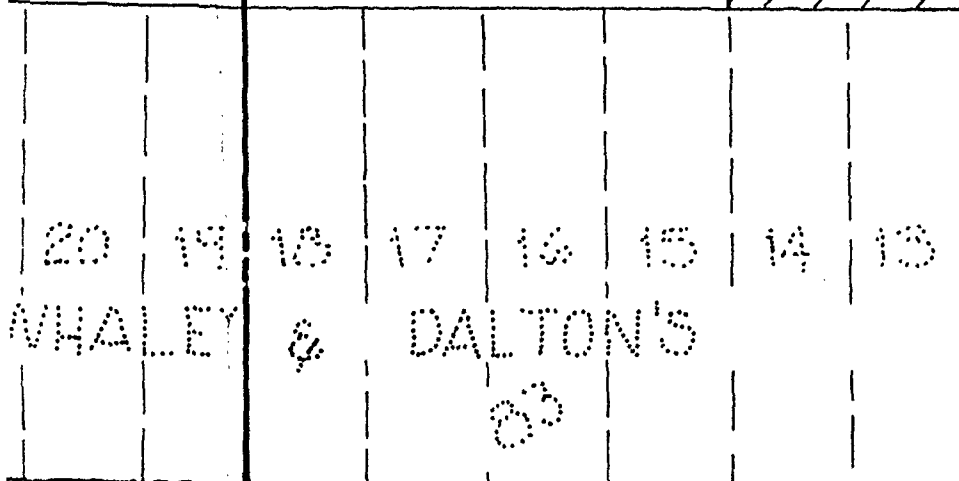

STREET LIMITS

80'
40' 40'

BLOCK MAP 516

Parcel 5 Parcel 6 Parcel 7 Parcel 8 Parcel 9 Parcel 10 Parcel 11 Parcel 12

MAP

351

BLOCK

Parcel 1 Parcel 2 Parcel 3 Parcel 4 Parcel 5 Parcel 6 Parcel 7 Parcel 8 Parcel 9

01881-3

GRANDS TRACT
3 MAP 4929
PARCEL A

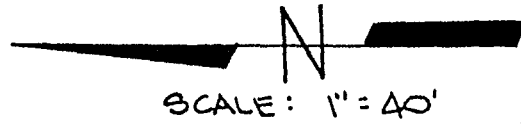

BOUNDARY OF MAP 4929 62.62'

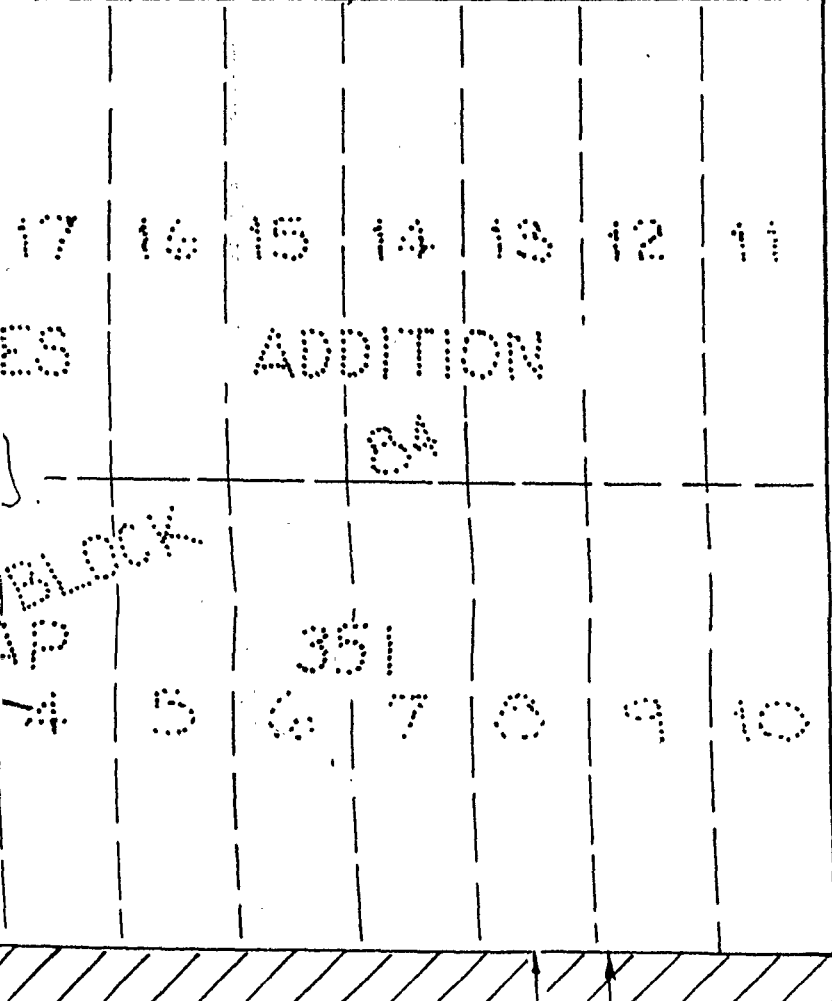
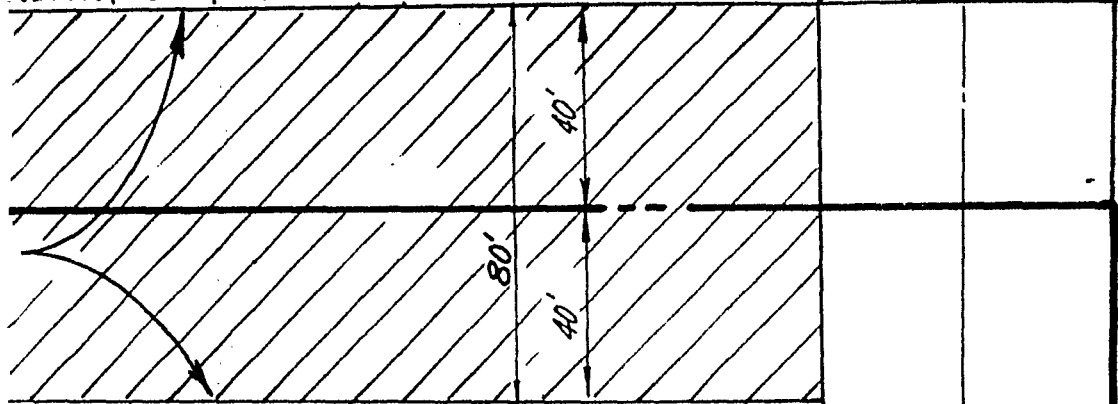

STREET

SUBDIVISION BOUNDARY

PARCEL MAP 10383

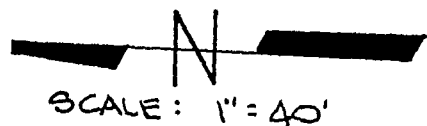

LEGEND

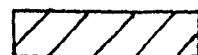

INDICATES STREET VACATED



INDICATES STREET RESERVATION
TO BE RESERVED ON MAP

TOTAL AREA OF STREET VACATION = 2.319 AC

REFERENCE DRAWINGS - 19573-D

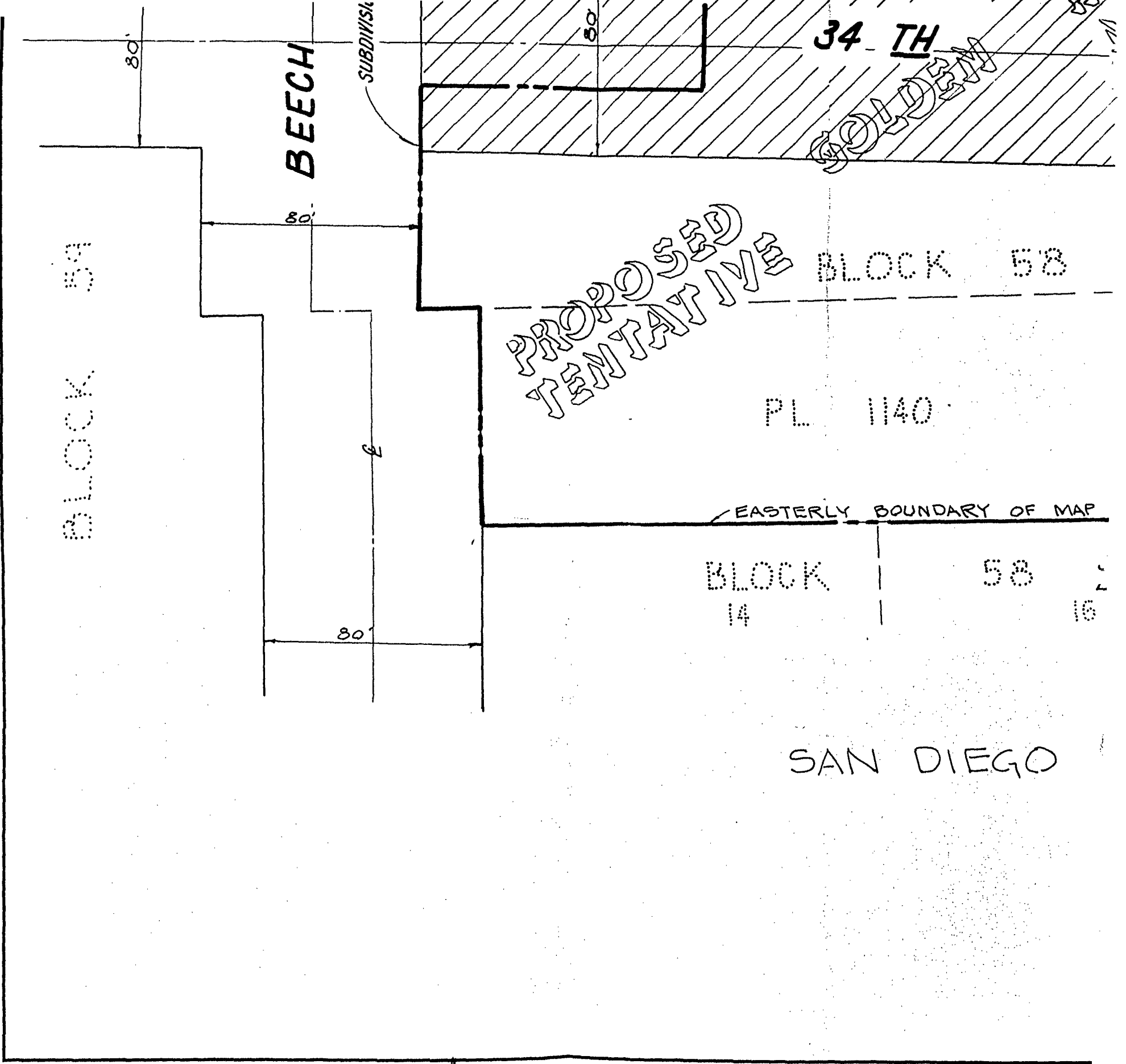

BLOCK 59

BEECH

34 TH

GOLDEN

PROPOSED
TENTATIVE

BLOCK 58

PL 1140

EASTERLY BOUNDARY OF MAP

BLOCK
14

58

16

SAN DIEGO

80'

80'

80'

80'

SUBDIVISION

01881-5

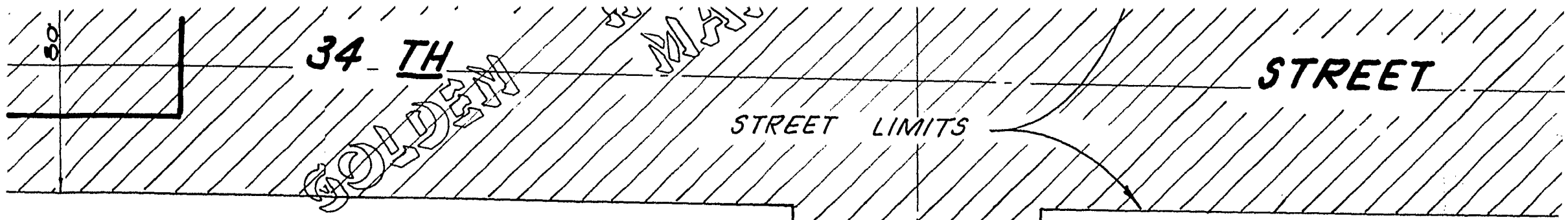

PROPOSED
RENTAL

BLOCK 58

BLOCK 57
W'LY BOUNDARY OF MAP 516-A

PL 1140

ASH

PL 1140

EASTERLY BOUNDARY OF MAP 314

BLOCK 14

58

SUBDIVISION BOUNDARY

16

ASH STREET DEDICATED PER MAP 314

BLOCK 14

SAN DIEGO PROPERTY UNION MAP 314

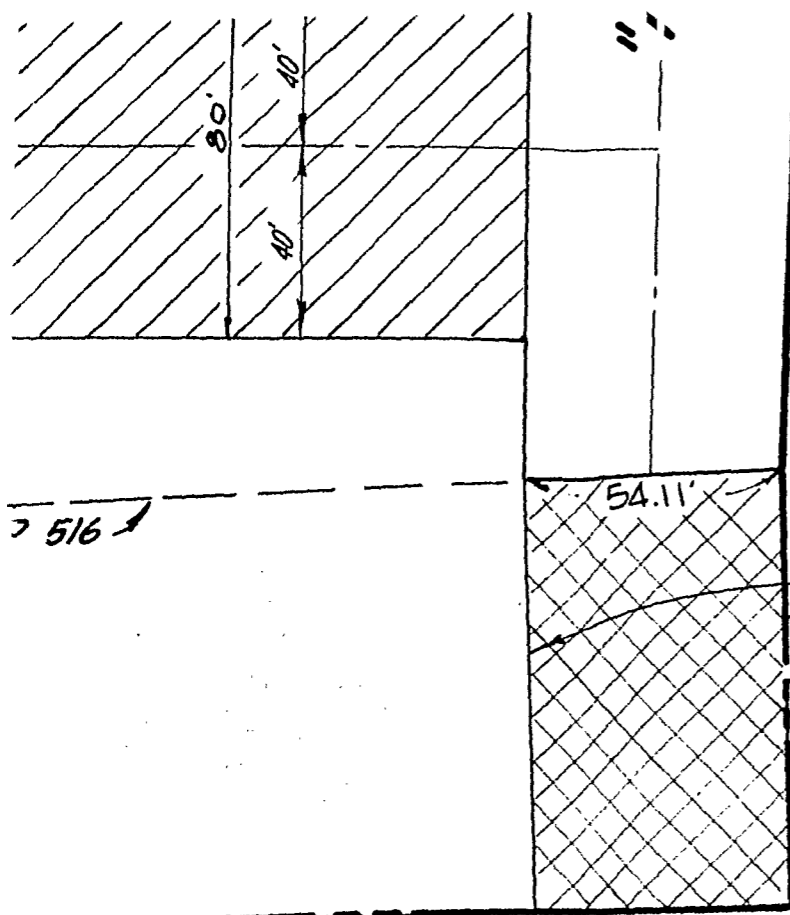

PARCEL 1

STREET RESERVATION
TO BE RESERVED ON MAP

34 TH STREET

57

15

314

CHOATE'S ADD.
MAP 167

"A" STREET

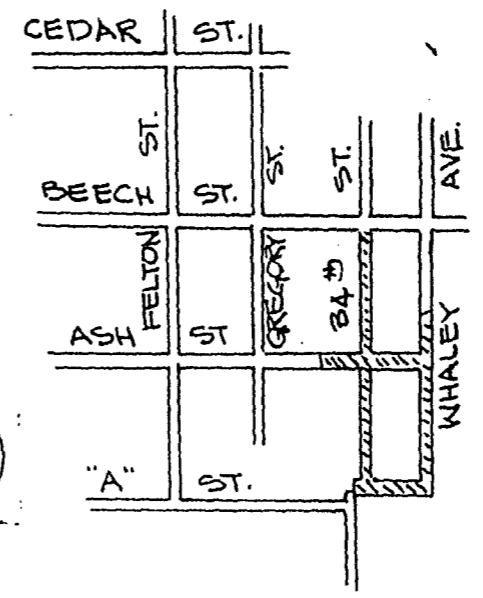

STATE HWY. 94

VICINITY MAP

NOT TO SCALE



ENGINEER

KEN COOK
7574 CLAIRE
SAN DIEGO, CA
PH. (714) 27

James J. L.
JAMES J. L.

STRE

3
SOUTH OF SOUTH
TO NORTHERLY

WH
SOUTH OF THE F
BLK 83, MORSE,

A
BETWEEN EAST
EASTERLY RIGH

FOR PROPOSED

CITY OF SAN
ENGINEER
SHEET

O.R. Loebler
FOR CITY ENGINEER

DESCRIPTION	
ORIGINAL	
CONTRACTOR	
INSPECTOR	

ENGINEER OF WORK

KEN COOK & ASSOC.

7574 CLAIREMONT MESA BLVD.
SAN DIEGO, CALIF. 92111
PH. (714) 279-6335

James J. Locke, Jr.

JAMES J. LOCKE, JR. R.C.E. 30632 DATE 4/16/80



ON
D ON MAP

STREET

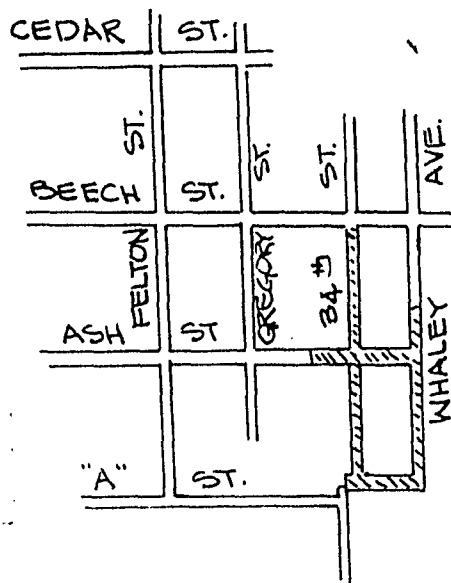

WABASH BLVD.

STATE HWY. 94

VICINITY MAP

NOT TO SCALE

STREET VACATION

34TH STREET

SOUTH OF SOUTHERLY BEECH STREET RIGHT-OF-WAY LINE
TO NORTHERLY "A" STREET RIGHT-OF-WAY LINE.

WHALEY AVENUE

SOUTH OF THE PROLONGATION OF THE SOUTHERLY LINE OF LOT 15,
BLK 83, MORSE, WHALEY & DALTON'S MAP 516 TO NORTHERLY ST. R/W.

ASH STREET

BETWEEN EASTERLY BOUNDARY OF MAP 314 AND THE
EASTERLY RIGHT-OF-WAY LINE OF WHALEY AVENUE.

DOCUMENT NO. RR-255942

FILED MAR 8 1982

CITY OF THE CITY CLERK
SAN DIEGO, CALIFORNIA

FOR PROPOSED GOLDEN HILLS VILLAS T.M. 79-127

CITY OF SAN DIEGO, CALIFORNIA
ENGINEERING DEPARTMENT
SHEET 1 OF 1 SHEET

W.O. 79-127
NO. 71384

J.R. Jacobs
FOR CITY ENGINEER

11-20-81
DATE

DESCRIPTION	BY	APPROVED	DATE	FILMED
ORIGINAL				
CONTRACTOR		DATE STARTED		
INSPECTOR		DATE COMPLETED		

J.R. Jacobs 11-20-81
CONTROL CERTIFICATION

202-1731

LAMBERT COORDINATES

19574 -D

01881-8

Passed and adopted by the Council of The City of San Diego on APR 12 1982,
 by the following vote:

Councilmen	Yeas	Nays	Not Present	Ineligible
Bill Mitchell	<input checked="" type="checkbox"/>	<input type="checkbox"/>	<input type="checkbox"/>	<input type="checkbox"/>
Bill Cleator	<input checked="" type="checkbox"/>	<input type="checkbox"/>	<input type="checkbox"/>	<input type="checkbox"/>
Susan Golding	<input checked="" type="checkbox"/>	<input type="checkbox"/>	<input type="checkbox"/>	<input type="checkbox"/>
Leon L. Williams	<input checked="" type="checkbox"/>	<input type="checkbox"/>	<input type="checkbox"/>	<input type="checkbox"/>
Ed Struiksma	<input checked="" type="checkbox"/>	<input type="checkbox"/>	<input type="checkbox"/>	<input type="checkbox"/>
Mike Gotch	<input checked="" type="checkbox"/>	<input type="checkbox"/>	<input type="checkbox"/>	<input type="checkbox"/>
Dick Murphy	<input checked="" type="checkbox"/>	<input type="checkbox"/>	<input type="checkbox"/>	<input type="checkbox"/>
Lucy Killea	<input checked="" type="checkbox"/>	<input type="checkbox"/>	<input type="checkbox"/>	<input type="checkbox"/>
Mayor Pete Wilson	<input type="checkbox"/>	<input type="checkbox"/>	<input checked="" type="checkbox"/>	<input type="checkbox"/>

AUTHENTICATED BY:

PETE WILSON

Mayor of The City of San Diego, California.

CHARLES G. ABDELNOUR

City Clerk of The City of San Diego, California.

(Seal)

By June A. Blackwell, Deputy.

Office of the City Clerk, San Diego, California

Resolution Number R-256186 Adopted APR 12 1982