

(R-85-1234)

RESOLUTION NUMBER R- 262362

ADOPTED ON JAN 22 1985

WHEREAS, Section 8330 et seq. of the California Streets and Highways Code provide a procedure for the summary vacation of streets and public service easements by City Council resolution where a street has been superseded by relocation; and

WHEREAS, the abutting property owners have requested the vacation of Summerdale Way, Summerdale Road and Garde Street in Concord Square Units 2 and 3, Map Nos. 9470 and 10322 respectively, all within the Concord Villas subdivision (TM 83-0588) boundaries, to facilitate development of their properties; and

WHEREAS, those properties adjoining the street to be vacated will continue to have access; and

WHEREAS, the public will benefit from the vacation through improved utilization of land; and

WHEREAS, the vacation is not inconsistent with the General Plan or an approved Community Plan; NOW, THEREFORE,

BE IT RESOLVED, by the Council of The City of San Diego, as follows:

1. That Summerdale Way, Summerdale Road and Garde Street, all within the Concord Villas subdivision (TM 83-0588) boundaries, as more particularly shown on Drawing No. 21538-D, on file in the office of the City Clerk as Document No. RR- 262362-1, which is by this reference incorporated herein and made a part hereof, be and the same is hereby ordered vacated.

2. That the resolution shall not become effective unless and until the final subdivision map for Concord Villas subdivision (TM 85-0588) has been approved by Council action. In the event that the final map is not approved by August 29, 1990, this resolution shall become void and be of no further force or effect.

3. That the City Engineer shall advise the City Clerk of the approval of the aforementioned subdivision map, and that the City Clerk shall then cause a certified copy of this resolution, attested by him under seal, to be recorded in the office of the County Recorder.

APPROVED: John W. Witt, City Attorney

By

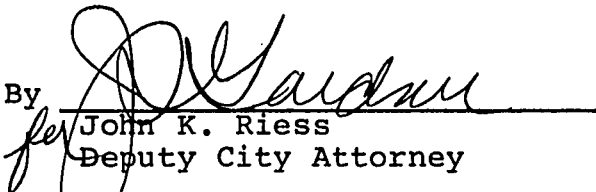
John K. Riess
Deputy City Attorney

JKR:mem
1/7/85
Or.Dept:E&D
R-85-1234
SA:84-517
TM,WO:83-0588
DWG:21538-D
Form=r.sumv2

BASIS OF BEARINGS

THE BASIS OF BEARINGS FOR THIS MAP IS THE NORTHERLY BOUNDARY OF CONCORD SQUARE UNITS 2 AND 3, MAP NO.'S 9740 AND 10322; I.E. N. 88°46'39"E.

LEGEND

STREET VACATION OF SUMMERDALE ROAD, SUMMERDALE WAY AND GARDE STREET PER MAP NO.'S 9740 AND 10322 SHOWN THUS



ABANDONMENT OF GENERAL UTILITY EASEMENTS PER MAP NO. 9740 SHOWN THUS



ABANDONMENT OF 15' SEWER EASEMENT PER MAP NO. 9740 SHOWN THUS



GENERAL UTILITY EASEMENTS RECORDED JULY 30, 1982, FILE/PAGE NO. 82-234175, O.R. ABANDONED

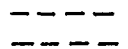

EXISTING EASEMENTS TO REMAIN

ASSESSOR'S PARCEL NO.'S

311 - 200 - 25
 311 - 200 26
 311 - 200 27
 311 - 200 28
 311 - 200 31
 311 - 200 32

AREA OF STREET VACATION

2.396 ACRES

REFERENCE DRAWINGS

15193-B

00477

MAP NO 6663

N.E. CORNER OF
LOT 8, MAP NO.
10322
AND P.O.B.

BASIS OF BE

THE BASIS OF BE
OF CONCORD SQ
I.E. N. 88°46'39"

LEGEND



STREET VACATING
GARDE STREET



ABANDONMENT
SHOWN THUS



ABANDONMENT
THUS



GENERAL UTILIT
NO. 82-234175, C

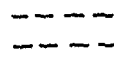

EXISTING EASE

ASSESSOR'S

311 - 200 - 2
311 - 200 2
311 - 200 2
311 - 200 2
311 - 200 3
311 - 200 3

AREA OF S

2.396 ACRES

REFERENCE

15193-B

RD SQUARE

LOT 1

VIA COLONIA 25' 25'

EASEMENT
5-152192, REC.
1975, O.R.

LOT 8

25'

25'

LIMITS OF GARDE STREET

NO 3

10322

GARDE WAY 23' 23'

STREET

GARDE STREET DEDICATED
FOR MAP NO. 8893

8893

MAP NO

T.M. 83-0588

3 SA

00478

LARWIN MESA VIEW UNIT NO 4 MAP NO 666

EXIST. DRAINAGE EASEMENT
PER MAP NO. 9740

LOT 4

CONCORD SQUARE

EXIST. 15' SEWER EASEMENT
PER FIP NO. 75-152192, REC.
6-17-75, BOOK 1975, O.R.

UNIT NO 2

MAP NO. 9740
AND 9740.

DDALE

LOT 8

ROAD

GENERAL UTILITY EASE-
MENT RECORDED JULY
30, 1982, FIP NO. 82-
234175, O.R.

UNIT NO 3

9740

10322

MAP NO

T.M. 83-0588

CONCORD

VILLAS

LOT 6

WAY

00479

LARWIN MESA VIEW
UNIT NO 5 MAP
NO 6733

LARWIN

LOT 1
MAP NO 9097

LOT 1
MAP NO 9097

SUMMERDALE ROAD (FORMERLY
VIA FIRENZA) DEDICATED PER
MAP NO. 9097.

CONCORD

LOT 3

SQUARE

PORTION OF EXIST. SEWER EASEMENT
PER MAP NO.'S 6954 AND 9740

EXIST.
DRAINAGE EASEMENT
PER MAP NO. 9740

EXIST. 15' SEWER
EASEMENT PER
MAP NO. 9740

EXIST. 10' DRAINAGE EASE-
MENT PER MAP NO. 9740

EXIST. 15' DRAINAGE
EASEMENT PER
MAP NO.'S 6954
AND 9740.

EXIST. 15'
PER

SUMMERDALE

GENERAL UTILITY EASE-
MENT RECORDED JULY
30, 1982, FIP NO. 82-
234175, O.R.

NO

PORTION OF EXIST. 10' DRAIN-
AGE EASEMENT PER FIP
NO. 73-353711, REC. 12-24-73,
BOOK 1973, O.R.

MAP

LOT 5

WAY

PROPOSED

SUMMERDALE RD
VIA FIRENZA) DE
MAP NO. 9097.

CONCORD SQUARE UNIT
LOT 2

LOT 5

NO. 13-300111, REC. 12-1-10,
BOOK 1973, O.R.

PROPOSED

GENERAL UTILITY
EASEMENT RECORD-
ED JULY 30, 1982,
F/P NO. 82-234175
O.R.

SUMMERDALE
WAY

PORTION
AGE EAS.
MAP NO.'S
9740

30'
30'

WESTMORE

WESTMORE ROAD DEDICATED PER MAP NO. 6954

PCL 2

PCL 1

PARCEL MAP

12256



SCALE 1" = 60'

APEC CIVIL ENGINEERING 2074

MAP

NO

10522

T.M. 83-0588

WAY

CONCORD

VILLAS

LOT 6

LOT 7

PORTION OF 15' DRAINAGE EASEMENT PER MAP NO'S 6954 AND 9740

WESTMORE ROAD DEDICATED PER MAP NO. 6954

SUMMERDALE ROAD DEDICATED PER MAP NO. 8893

P NO. 6954

ROAD

LIMITS OF GARDE STREET

GARDE STREET

PARCEL "A"

SUMMER ROAD

LOT 4

PORTION OF WESTMORE ROAD DEDICATED PER FILE/PAGE NO. 68959, RECORDED APRIL 22, 1963, SERIES 4, BOOK 1963, O.R.

T 14 S R 3 W NE 1/4 SEC 36

S B M

56

T.M. 83-0588

GARDE STREET DEDICATED PER MAP NO. 8893

GARDE

GARDE COURT

SUMMERDALE ROAD DEDICATED PER MAP NO. 8893

SUMMERDALE ROAD

GARDE STREET

PARCEL "A"

LOT 4

MIRA LOT 3 MESA

COLONY HOMES

MAP A

VICINITY MAP
NO SCALE

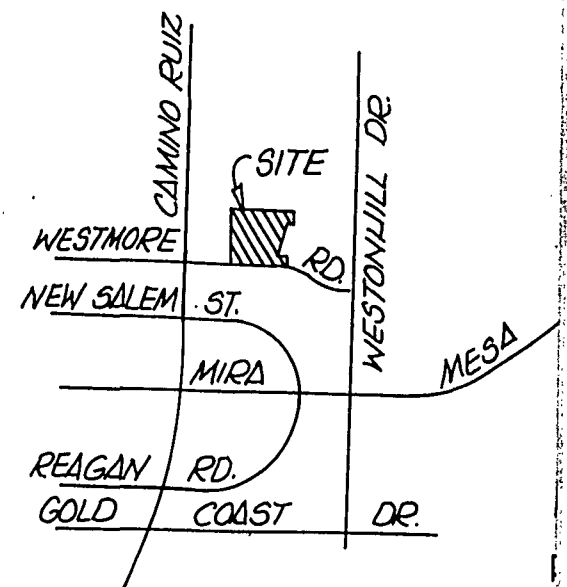

LIMITS OF GARDE STREET MAP NO. 6954

ED PER FILE/PAGE NO. 1
PIES 4, BOOK 1963, O.R.
SEC 35

dpec
 Associated Professional
William G. Clarke
 WILLIAM G. CLARKE, L.S. 3663
 2341 Fifth Avenue
 San Diego, Ca. 92101
 (619) 239-7501

2.396 ACRES

REFERENCE DRAWINGS

15193-B

DOCUMENT NO. RR-262362-1

FILED JAN 22 1985

OFFICE OF THE CITY CLERK
SAN DIEGO, CALIFORNIA

UNITY MAP
NO SCALE

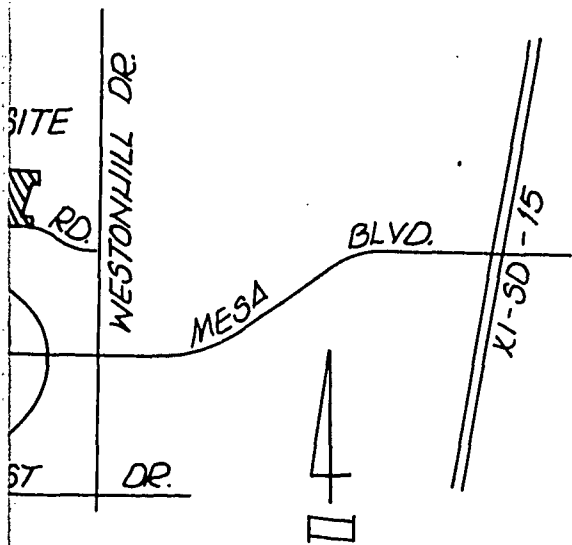

GENERAL UTILITY EASEMENTS ABANDONMENT IN LOTS 3, 4, 5 AND 6, CONCORD SQUARE UNIT NO. 2, MAP NO. 9740 AND PER FILE/ PAGE 82-234175, RECORDED JULY 30, 1982, O.R.

STREET VACATION SUMMERDALE ROAD, SUMMERDALE WAY AND PORTIONS OF GARDE STREET IN CONCORD SQUARE UNITS 2 AND 3, MAP NO. 9740 AND 10322

SEWER EASEMENT ABANDONMENT IN LOT 3, CONCORD SQUARE UNIT NO. 2, MAP NO. 9740.

FOR PROPOSED CONCORD VILLAS, T.M. 83-0588

CITY OF SAN DIEGO, CALIFORNIA
ENGINEERING DEPARTMENT
SHEET 1 OF 1 SHEET

T.M. 83-0588
W.O. 830588
NO. SA 84-517

J. J. McLaughlin Nov. 9, 1984
FOR CITY ENGINEER DATE

DESCRIPTION	BY	APPROVED	DATE	FILMED
ORIGINAL 23 MAR 1985				

Jordan 11-9-84
CONTROL CERTIFICATION

274-1725
LAMBERT COORDINATES

CONTRACTOR _____ DATE STARTED _____
INSPECTOR _____ DATE COMPLETED _____

21538 -D

**Land Planning
Civil Engineering
Land Surveying**

ated Professional Eng. Corp.
G. Clarke 26 Oct. '84
G. CLARKE, "L.S. 3663" DATE
2341 Fifth Avenue
San Diego, Ca. 92101-1610
(619) 239-7501

1985

Passed and adopted by the Council of The City of San Diego on JAN 22 1985
by the following vote:

Councilmen	Yeas	Nays	Not Present	Ineligible
Bill Mitchell	<input checked="" type="checkbox"/>	<input type="checkbox"/>	<input type="checkbox"/>	<input type="checkbox"/>
Bill Cleator	<input checked="" type="checkbox"/>	<input type="checkbox"/>	<input type="checkbox"/>	<input type="checkbox"/>
Gloria McColl	<input checked="" type="checkbox"/>	<input type="checkbox"/>	<input type="checkbox"/>	<input type="checkbox"/>
William Jones	<input checked="" type="checkbox"/>	<input type="checkbox"/>	<input type="checkbox"/>	<input type="checkbox"/>
Ed Struiksm	<input type="checkbox"/>	<input type="checkbox"/>	<input checked="" type="checkbox"/>	<input type="checkbox"/>
Mike Gotch	<input checked="" type="checkbox"/>	<input type="checkbox"/>	<input type="checkbox"/>	<input type="checkbox"/>
Dick Murphy	<input checked="" type="checkbox"/>	<input type="checkbox"/>	<input type="checkbox"/>	<input type="checkbox"/>
Uvaldo Martinez	<input checked="" type="checkbox"/>	<input type="checkbox"/>	<input type="checkbox"/>	<input type="checkbox"/>
Mayor Roger Hedgecock	<input type="checkbox"/>	<input type="checkbox"/>	<input checked="" type="checkbox"/>	<input type="checkbox"/>

AUTHENTICATED BY:

ROGER HEDGECOCK

Mayor of The City of San Diego, California.

CHARLES G. ABDELNOUR

City Clerk of The City of San Diego, California.

By Barbara Baxter, Deputy.

(Seal)

Office of the City Clerk, San Diego, California

Resolution Number R-262362 Adopted JAN 22 1985

RECEIVED
CITY CLERK'S OFFICE
1984 JAN -9 PM 12:31
SAN DIEGO, CALIF.

001847

00185

///