

(R-86-865)

RESOLUTION NUMBER R- 264845

ADOPTED ON JAN 14 1986

A RESOLUTION ESTABLISHING AN UNDERGROUND UTILITY DISTRICT TO BE KNOWN AND DENOMINATED AS THE LA JOLLA BOULEVARD (VIA DEL NORTE TO MARINE STREET) UNDERGROUND UTILITY DISTRICT.

WHEREAS, by Resolution No. R-~~264509~~, a public hearing was called for on January 14, 1986 at the hour of 10:00 a.m. in the Council Chambers of the City Administration Building, 202 C Street, San Diego, California, to determine whether the public health, safety or general welfare requires the removal of poles, overhead wires and associated structures and the underground installation of wires and facilities for supplying electric, communication, community antenna television or similar or associated service within that certain area of the City of San Diego more particularly described as follows:

Lot 10 in Block 7, Lots 8, 10 and 12 through 14 in Block 6, Lots 11, 12 and 14 through 16 in Block 4 in Hermosa Terrace, Map 2353; Lots 25 through 32 in Block 13, Lots 26 through 33 in Block 11, Lots 28 through 35 in Block 8, Lots 30 and 31 in Block 5, Lot 44 in Block 1, Lots 1 through 8 in Block 12, Lots 7, 8 and the westerly half of Lots 1 through 6 in Block 7, Lots 1 through 17 in Block 6 of La Jolla Strand, Map 1216; Lots 43 and 44 in Block C in South La Jolla, Map 887; Lots 11 through 14 in Block C in Starkey's Prospect Park, Map 1729; Lots 2, 4, 6, 8, 10, 12, 14, 16, 18 in block 10, Lot 1 in Block 8, Lots 11 and 12 in Block 7,

the easterly half of Lots 21 and 23 in Block 6 in First Addition to South La Jolla, Map 891; Lot 22 in Block 8 in La Jolla Beach, Map 893; Lot 1 in Block 3, Lots 1 and 8 in Block 4, Lot 1 in Block 5, Lot 5 in Block 7 in F.T. Scripps Addition, Map 897; Lot 10 in Block B in Starkey's Prospect Park, Map 1729.

Said district shall also include the following described public rights-of-way:

LA JOLLA BOULEVARD between the northerly line of Via del Norte and the northerly line of Marine Street; MESA WAY between a line parallel to and 50 feet east of the easterly line of La Jolla Boulevard and a line parallel to and 50 feet west of the westerly line of La Jolla Boulevard; PALOMAR AVENUE between a line parallel to and 25 feet west of the westerly line of La Jolla Boulevard and the westerly line of Electric Avenue; ALLEY IN BLOCK 13 in LA JOLLA STRAND, Map 1216 between a line parallel to and 100 feet west of the westerly line of La Jolla Boulevard and the westerly line of La Jolla Boulevard; ROSEMONT STREET between a line parallel to and 50 feet east of the easterly line of La Jolla Boulevard and a line parallel to and 100 feet west of the westerly line of La Jolla Boulevard; ALLEY IN BLOCK 11 in LA JOLLA STRAND, Map 1216 between a line parallel to and 100 feet west of the westerly line of La Jolla Boulevard and the westerly line of La Jolla Boulevard; KOLMAR STREET between a line parallel to and 100 feet west of the westerly line of La Jolla Boulevard and the westerly line of La Jolla Boulevard; ALLEY IN BLOCK 8 in LA JOLLA STRAND, Map 1216 between a line parallel to and 100 feet west of the westerly line of La Jolla Boulevard and the westerly

line of La Jolla Boulevard; GRAVILLA STREET between a line parallel to and 50 feet east of the easterly line of La Jolla Boulevard and a line parallel to and 100 feet west of the westerly line of La Jolla Boulevard; PLAYA DEL SUR between a line parallel to and 50 feet west of the westerly line of La Jolla Boulevard and the westerly line of La Jolla Boulevard; PLAYA DEL NORTE between a line parallel to and 50 feet west of the westerly line of La Jolla Boulevard and the westerly line of La Jolla Boulevard; BONAIR STREET between a line parallel to and 50 feet west of the westerly line of La Jolla Boulevard and a line parallel to and 50 feet east of the easterly line of La Jolla Boulevard; BONAIR WAY between a line parallel to and 50 feet east of the easterly line of La Jolla Boulevard and the easterly line of La Jolla Boulevard; SOUTH LANE between a line parallel to and 50 feet west of the westerly line of La Jolla Boulevard and the westerly line of La Jolla Boulevard; NAUTILUS STREET between a line parallel to and 50 feet east of the easterly line of La Jolla Boulevard and a line parallel to and 50 feet west of the westerly line of La Jolla Boulevard; ALLEY BETWEEN BLOCKS E and F in SOUTH LA JOLLA, Map 887 between a line parallel to and 50 feet west of the westerly line of La Jolla Boulevard and the westerly line of La Jolla Boulevard; WESTBOURNE STREET between a line parallel to and 50 feet west of the westerly line of La Jolla Boulevard and a line parallel to and 50 feet east of the easterly line of La Jolla Boulevard; ALLEY IN BLOCK 7 in F.T. SCRIPPS ADDITION, Map 897 between a line parallel to and 50 feet east of the easterly line of La Jolla Boulevard and the easterly line of

La Jolla Boulevard; BELVEDERE STREET between a line parallel to and 100 feet west of the westerly line of La Jolla Boulevard and the westerly line of La Jolla Boulevard; FERN GLEN between a line parallel to and 50 feet east of the easterly line of La Jolla Boulevard and a line parallel to and 100 feet west of the westerly line of La Jolla Boulevard; RUSHVILLE STREET between a line parallel to and 25 feet east of the easterly line of La Jolla Boulevard and the easterly line of La Jolla Boulevard; ARENAS STREET between a line parallel to and 50 feet east of the easterly line of La Jolla Boulevard and a line parallel to and 100 feet west of the westerly line of La Jolla Boulevard; ALLEY IN BLOCK 4 in F.T. SCRIPPS ADDITION, Map 897 between a line parallel to and 100 feet east of the easterly line of La Jolla Boulevard and the easterly line of La Jolla Boulevard; ALLEY IN BLOCK 10 in FIRST ADDITION TO SOUTH LA JOLLA, Map 891 between a line parallel to and 25 feet west of the westerly line of La Jolla Boulevard and the westerly line of La Jolla Boulevard; GENTER STREET between a line parallel to and 100 feet east of the easterly line of La Jolla Boulevard and the easterly line of La Jolla Boulevard; SEA LANE between a line parallel to and 50 feet east of the easterly line of La Jolla Boulevard and a line parallel to and 25 feet west of the westerly line of La Jolla Boulevard; ALLEY IN BLOCK 2 in F.T. SCRIPPS ADDITION, Map 897 between a line parallel to and 50 feet east of the easterly line of La Jolla Boulevard and the easterly line of La Jolla Boulevard; ALLEY IN BLOCK 8 in LA JOLLA BEACH, Map 893 between a line parallel to and 100 feet west of the westerly line of La

Jolla Boulevard and the westerly line of La Jolla Boulevard; MARINE STREET between a line parallel to and 75 feet east of the easterly line of La Jolla Boulevard and a line parallel to and 50 feet west of the westerly line of La Jolla Boulevard; WINAMAR AVENUE between a line parallel to and 50 feet west of the westerly line of La Jolla Boulevard and the westerly line of La Jolla Boulevard; all as more particularly shown on Drawing No. 22459-D entitled "LA JOLLA BOULEVARD (VIA DEL NORTE TO MARINE STREET) UNDERGROUND UTILITY DISTRICT," copies of which are on file in the office of the City Clerk as Document No. RR- 264509 and attached hereto and incorporated herein as Exhibit A; and

WHEREAS, notice of such hearing has been given by the City Clerk to all affected property owners as defined in Chapter VI, Article 1, Division 5 of the San Diego Municipal Code, and the utilities concerned in the manner and for the time required by law; and

WHEREAS, such hearing has been duly and regularly held and all persons interested have been given an opportunity to be heard; NOW, THEREFORE,

BE IT RESOLVED, by the Council of the City of San Diego, as follows:

1. The City Council does hereby find and determine that the public health, safety and general welfare require the removal of poles, overhead wires and associated overhead structures and the underground installation of wires and facilities for supplying electric, communication, community antenna television or similar

or associated service within the area set forth above and that pursuant to Chapter VI, Article 1, Division 5 of the San Diego Municipal Code, the above-described area is hereby declared to be an underground utility district in the City of San Diego, and the maps and document referred to above are hereby incorporated as a part of this resolution.

2. The City Council shall by subsequent resolution fix the date upon which the property in the district must be ready to receive underground service, and shall by subsequent resolution order the removal of all poles, overhead wires and associated overhead structures and the underground installation of wires and facilities for supplying electric, communication, community antenna television or similar or associated service.

3. The City Clerk be and he is hereby instructed to notify all affected persons as defined in Chapter VI, Article 1, Division 5 of the San Diego Municipal Code, and all affected utility companies of the adoption of this resolution within fifteen (15) days after the date of such adoption. The City Clerk shall further notify said affected persons as defined in Chapter VI, Article 1, Division 5 of the San Diego Municipal Code of the necessity that if they desire to continue to receive electric, communication, community antenna television or similar or associated service they shall provide at their own expense all necessary facility changes on their premises so as to receive underground service from the lines relocated underground of the supplying utility company subject to applicable rules, regulations and tariffs of the respective utility company on file

with the Public Utilities Commission of the State of California
(as of the date of adoption of this resolution) and subject to
all other applicable requirements of State law and City
ordinances. The Clerk's notification shall be made in the manner
provided in Chapter VI, Article 1, Division 5 of the San Diego
Municipal Code.

APPROVED: John W. Witt, City Attorney

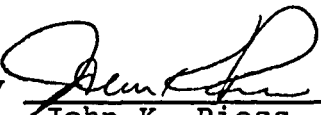
By 

John K. Riess
Deputy City Attorney

JKR:mem
11/6/85
Or.Dept:E&D
R-86-865
Form=r.uest

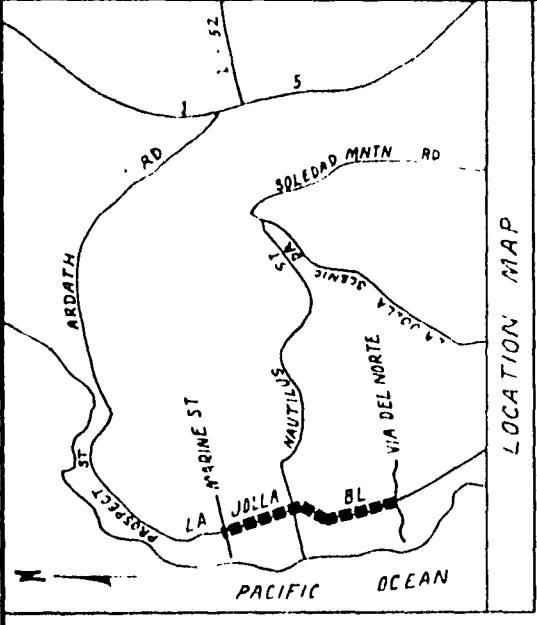

RESOLUTION NO **R-264845**

DATE ADOPTED **JAN 14 1986**

DOCUMENT NO. **R-264509**
 FILED **NOV 25 1985**
 OFFICE OF THE CITY CLERK
 SAN DIEGO, CALIFORNIA

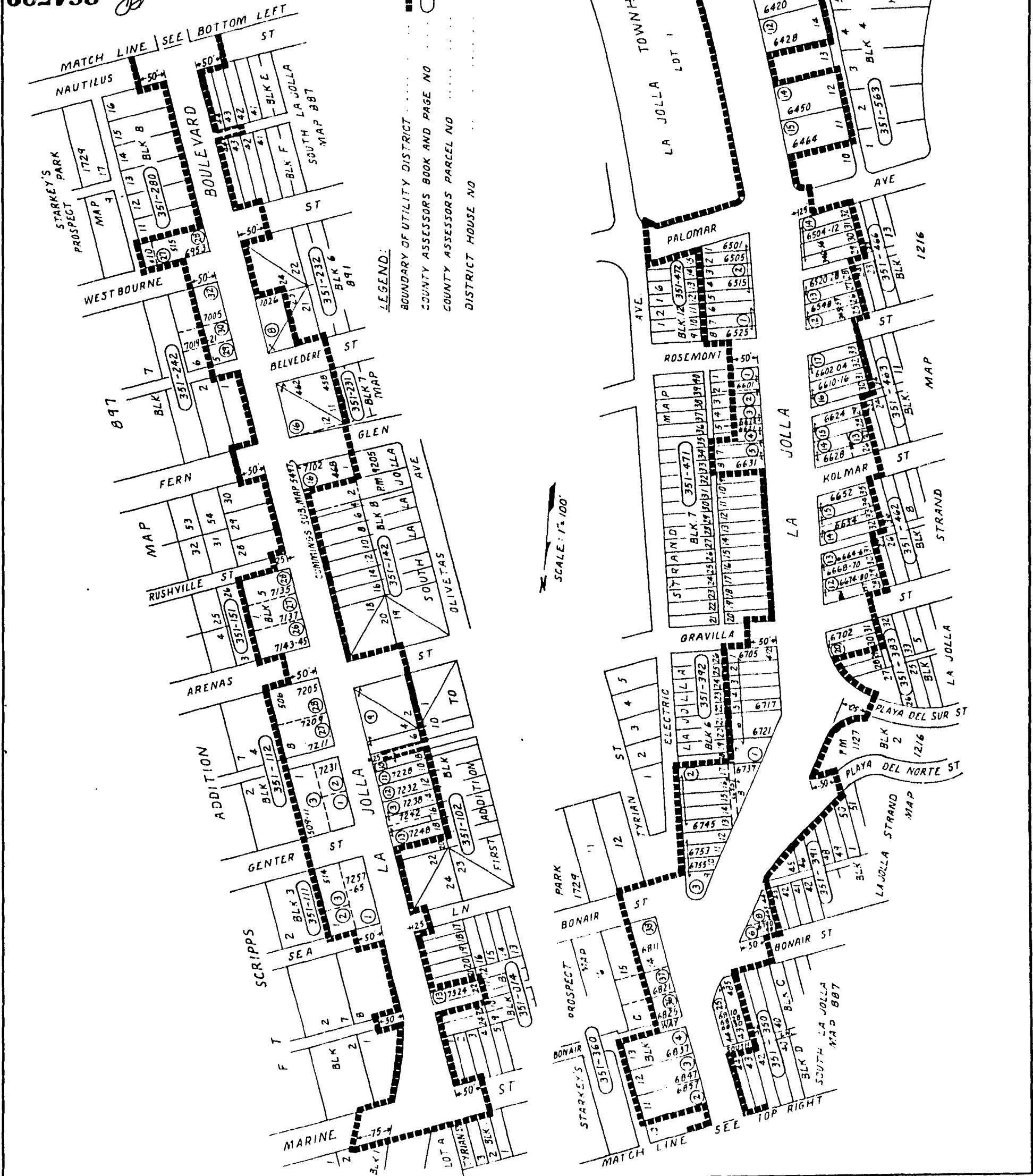

**LA JOLLA BOULEVARD
 (VIA DEL NORTE TO MARINE ST)
 UNDERGROUND UTILITY DISTRICT**

CITY OF SAN DIEGO, CALIFORNIA
 ENGINEERING DEPARTMENT
 SHEET 1 OF 1 SHEETS

NO. 118756

D.W. P. [Signature]

238 685

22459-D

R-264845

00026

330a

Passed and adopted by the Council of The City of San Diego on JAN 14 1986,
by the following vote:

Councilmen	Yeas	Nays	Not Present	Ineligible
Abbe Wolfsheimer	<input checked="" type="checkbox"/>	<input type="checkbox"/>	<input type="checkbox"/>	<input type="checkbox"/>
Bill Cleator	<input checked="" type="checkbox"/>	<input type="checkbox"/>	<input type="checkbox"/>	<input type="checkbox"/>
Gloria McColl	<input type="checkbox"/>	<input type="checkbox"/>	<input checked="" type="checkbox"/>	<input type="checkbox"/>
William Jones	<input checked="" type="checkbox"/>	<input type="checkbox"/>	<input type="checkbox"/>	<input type="checkbox"/>
Ed Struiksma	<input checked="" type="checkbox"/>	<input type="checkbox"/>	<input type="checkbox"/>	<input type="checkbox"/>
Mike Gotch	<input checked="" type="checkbox"/>	<input type="checkbox"/>	<input type="checkbox"/>	<input type="checkbox"/>
Judy McCarty	<input checked="" type="checkbox"/>	<input type="checkbox"/>	<input type="checkbox"/>	<input type="checkbox"/>
Uvaldo Martinez	<input checked="" type="checkbox"/>	<input type="checkbox"/>	<input type="checkbox"/>	<input type="checkbox"/>
Mayor	<input type="checkbox"/>	<input type="checkbox"/>	<input type="checkbox"/>	<input type="checkbox"/> VACANT

AUTHENTICATED BY:

ED STRUIKSMA
Deputy Mayor of The City of San Diego, California.

CHARLES G. ABDELNOUR
City Clerk of The City of San Diego, California.

(Seal)

By Ellen Board, Deputy.

Office of the City Clerk, San Diego, California

Resolution Number R-264845 Adopted JAN 14 1986