

( R-92-1380)

RESOLUTION NUMBER R- 279646

ADOPTED ON MAR 30 1992

BE IT RESOLVED, by the Council of The City of San Diego, that the setting aside of that portion of City-owned Lot 119 of Canyon Hills P.R.D., Map No. 11833, as more particularly described in Exhibit A, and as shown on Drawing No. 17878-B, both of which are attached hereto and by this reference incorporated herein, for public street purposes and for abutters rights of access, be, and the same is hereby approved; and the land therein set aside for public street purposes is hereby dedicated as and for a public street, and the same is hereby named MERCY ROAD.

BE IT FURTHER RESOLVED, that the City Clerk shall cause a certified copy of this resolution, attested by him under seal, to be recorded in the office of the County Recorder.

APPROVED: JOHN W. WITT, City Attorney

By

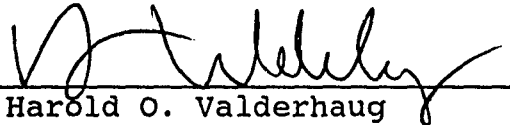
  
Harold O. Valderhaug  
Deputy City Attorney

HOV:ps  
03/12/92  
Or.Dept:Prop.  
Job:521091-1&2  
17878-B  
R-92-1380  
Form=r.deedr

EXHIBIT "A"

STREET DEDICATION - MERCY ROAD

That portion of Lot 119 of the Canyon Hills P.R.D., according to Map thereof No. 11833, filed in the Office of the Recorder of San Diego County on June 5, 1987, in the City of San Diego, County of San Diego, State of California being more particularly described as follows:

Beginning at the Northeast Corner of said Lot 119; thence along the Easterly line of said Lot 119 South 09°51'04" West (record South 09°49'52" West per said Map) 70.00 feet ; thence leaving said Easterly line North 58°53'57" West 98.87 feet; thence North 63°18'29" West 105.69 feet; thence North 79°33'44" West 20.81 feet; thence North 67°06'32" West 5.00 feet to the Easterly Right-of-Way line of Alemania Road as dedicated to the City of San Diego per said Map No. 11833, said point being on a non-tangent 123.00 foot radius curve concave Northwesterly, a radial line to said point bears South 67°06'32" East; thence along the Westerly and Northerly lines of said Lot 119, the following five (5) courses:

1. Northerly along the arc of said curve through a central angle of 04°00'28" a distance of 8.60 feet; thence
2. tangent to said curve North 18°53'00" East (North 18°53'24" East per said Map) 5.78 feet to the beginning of a tangent 22.00 foot radius curve concave Southeasterly; thence
3. Northeasterly along the arc of said curve through a central angle of 58°04'26" (58°04'33" per said Map) a distance of 22.30 feet; thence
4. leaving said curve on a non-tangent line South 75°10'58" East (North 75°10'33" West per said Map) 82.00 feet; thence
5. South 70°02'49" East 123.49 feet (South 70°02'51" East 123.47 feet per said Map) to the Point of Beginning.

(Containing 0.241 acres more or less.)

  
Robert G. Schoettmer  
L.S. 4324

W.O. 910574  
Dwg. 17878-B



11-SD-15  
M 16.2 - 17.5  
EA 105810  
CO-OP AGMT. 11-0399

R-279646

3/22

J-11519

MERCY ROAD  
ABUTTERS RIGHTS OF ACCESS SET ASIDE

Being a portion of Lot 119 of Canyon Hills P.R.D., according to Map thereof No. 11833 filed in the Office of the Recorder of San Diego County June 5, 1987, in the City of San Diego, County of San Diego, State of California, said abutters rights of access be set aside along the following line:

Beginning at the Northeast corner of said Lot 119; thence along the Easterly line of said Lot South 09°51'04" West (Record South 09°49'52" West) 70.00 feet to the TRUE POINT OF BEGINNING of the herein described line; thence leaving said Easterly line North 58°53'57" West 98.87 feet; thence North 63°18'29" West 105.69 feet to the terminus of the herein described line.

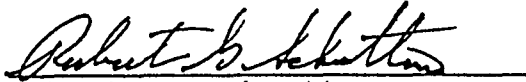
  
Robert G. Schoettmer  
L.S. 4324

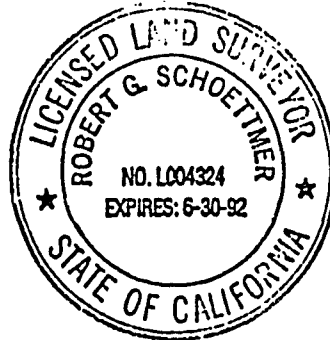

Dwg. 17878-B

11-SD-15  
M 16.2 - 17.5  
EA 105810  
CO-OP AGMT. 11-0399

R-279646  
EXHIBIT A

2-92

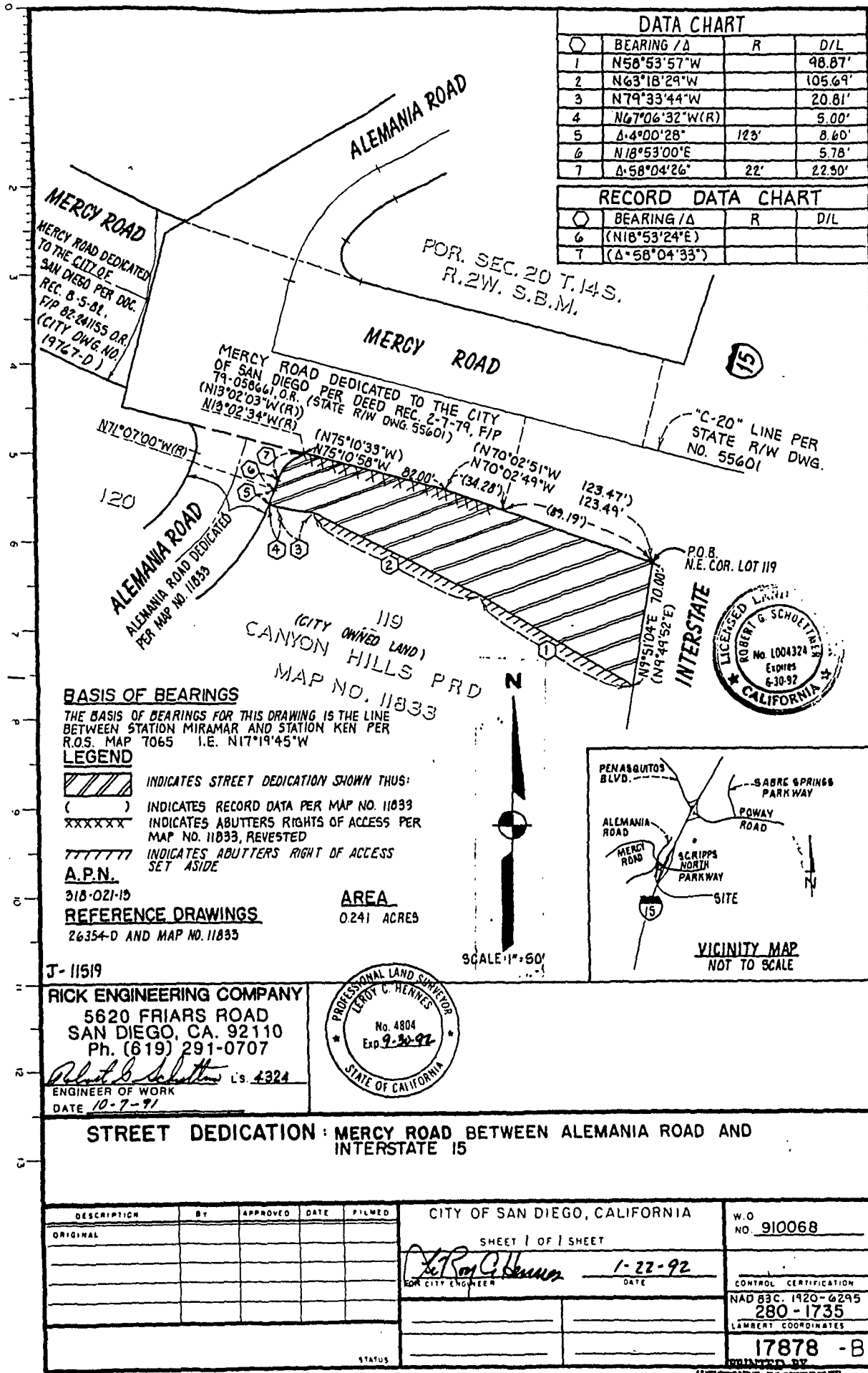

DATA CHART			
○	BEARING / Δ	R	D/L
1	N58°53'57"W		98.87'
2	N63°18'29"W		105.69'
3	N79°33'44"W		20.81'
4	N67°06'32"W(R)		5.00'
5	Δ-4°00'28"	123'	8.60'
6	N18°53'00"E		5.78'
7	Δ-58°04'26"	22'	22.50'

RECORD DATA CHART			
○	BEARING / Δ	R	D/L
6	(N18°53'24"E)		
7	(Δ-58°04'33")		

**BASIS OF BEARINGS**

THE BASIS OF BEARINGS FOR THIS DRAWING IS THE LINE BETWEEN STATION MIRAMAR AND STATION KEN PER R.O.S. MAP 7065 I.E. N17°19'45"W

**LEGEND**

- INDICATES STREET DEDICATION SHOWN THUS:
- INDICATES RECORD DATA PER MAP NO. 11033
- INDICATES ABUTTERS RIGHTS OF ACCESS PER MAP NO. 11033, REVESTED
- INDICATES ABUTTERS RIGHT OF ACCESS SET ASIDE

**A.P.N.**

918-021-19

**REFERENCE DRAWINGS**

26354-D AND MAP NO. 11033

**AREA**  
0.241 ACRES

J-11519  
**RICK ENGINEERING COMPANY**  
 5620 FRIARS ROAD  
 SAN DIEGO, CA. 92110  
 Ph. (619) 291-0707  
*Robert G. Schuttler* L.S. 4324  
 ENGINEER OF WORK  
 DATE 10-7-91



**STREET DEDICATION: MERCY ROAD BETWEEN ALEMANIA ROAD AND INTERSTATE 15**

CITY OF SAN DIEGO, CALIFORNIA					W.O. NO. 910068
SHEET 1 OF 1 SHEET					
<i>Leroy C. Hennessy</i> 1-27-92 DATE					CONTROL CERTIFICATION
					NAD 83 C. 1420-6295 280-1735 LAMBERT COORDINATES
STATUS					17878 - B

WESTSIDE BLUEPRINT  
 1111 30 1000  
 R-279646

123  
(a-b)

MAR 30 1992

Passed and adopted by the Council of The City of San Diego on.....  
by the following vote:

Council Members	Yeas	Nays	Not Present	Ineligible
Abbe Wolfsheimer	<input checked="" type="checkbox"/>	<input type="checkbox"/>	<input type="checkbox"/>	<input type="checkbox"/>
Ron Roberts	<input checked="" type="checkbox"/>	<input type="checkbox"/>	<input type="checkbox"/>	<input type="checkbox"/>
John Hartley	<input checked="" type="checkbox"/>	<input type="checkbox"/>	<input type="checkbox"/>	<input type="checkbox"/>
George Stevens	<input checked="" type="checkbox"/>	<input type="checkbox"/>	<input type="checkbox"/>	<input type="checkbox"/>
Tom Behr	<input checked="" type="checkbox"/>	<input type="checkbox"/>	<input type="checkbox"/>	<input type="checkbox"/>
Valerie Stallings	<input checked="" type="checkbox"/>	<input type="checkbox"/>	<input type="checkbox"/>	<input type="checkbox"/>
Judy McCarty	<input checked="" type="checkbox"/>	<input type="checkbox"/>	<input type="checkbox"/>	<input type="checkbox"/>
Bob Filner	<input checked="" type="checkbox"/>	<input type="checkbox"/>	<input type="checkbox"/>	<input type="checkbox"/>
Mayor Maureen O'Connor	<input checked="" type="checkbox"/>	<input type="checkbox"/>	<input type="checkbox"/>	<input type="checkbox"/>

AUTHENTICATED BY:

(Seal)

MAUREEN O'CONNOR  
Mayor of The City of San Diego, California.

CHARLES G. ABDELNOUR  
City Clerk of The City of San Diego, California.

By *Linda Legano*, Deputy.

Office of the City Clerk, San Diego, California

Resolution *R-279646*  
Number..... Adopted **MAR 30 1992**

RECEIVED

92 MAR 13 PM 3:10

CITY CLERKS OFFICE  
SAN DIEGO, CA

118