

(O-98-116)

ORDINANCE NUMBER O- **18504** (NEW SERIES)

ADOPTED ON **MAY 04 1998**

AN ORDINANCE CHANGING 4.13 ACRES LOCATED 5520 MOREHOUSE DRIVE, IN THE MIRA MESA COMMUNITY PLAN AREA, IN THE CITY OF SAN DIEGO, CALIFORNIA, FROM THE M-1B (MANUFACTURING) ZONE INTO THE M1 (MANUFACTURING) ZONE, AS DEFINED BY SAN DIEGO MUNICIPAL CODE SECTION 101.0437, AND REPEALING ORDINANCE NO. O-15315 (NEW SERIES), ADOPTED AUGUST 25, 1980, OF THE ORDINANCES OF THE CITY OF SAN DIEGO INsofar AS THE SAME CONFLICT(S) HEREWITH.

BE IT ORDAINED, by the Council of The City of San Diego, as follows:

Section 1. That 4.13 acres, located 5520 Morehouse Drive, in the Mira Mesa Community Plan area, in the City of San Diego, California, within the boundary of the district designated "M-1B" on Zone Map Drawing No. B-4088, filed in the office of the City Clerk as Document No. OO- **18504** be, and it is hereby incorporated into the M1 (Manufacturing) Zone, as such zone is described and defined by San Diego Municipal Code section 101.0437.

Section 2. That Ordinance No. O-15315 (New Series), adopted August 25, 1980, of the ordinances of The City of San Diego be, and it is hereby repealed insofar as the same conflicts herewith.

Section 3. This ordinance shall take effect and be in force on the thirtieth (30th) day from and after its passage, and no building permits for development inconsistent with the provisions of

this ordinance shall be issued unless application therefor was made prior to the date of adoption of this ordinance.

APPROVED: CASEY GWINN, City Attorney

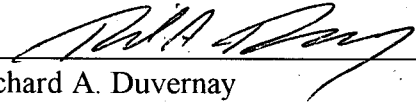
By 
Richard A. Duvernay
Deputy City Attorney

RAD:lc
04/07/98
Or. Dept. Dev. Svcs.
Case No. 96-7896
O-98-116
Form=inloto.frm



PROPOSED REZONING

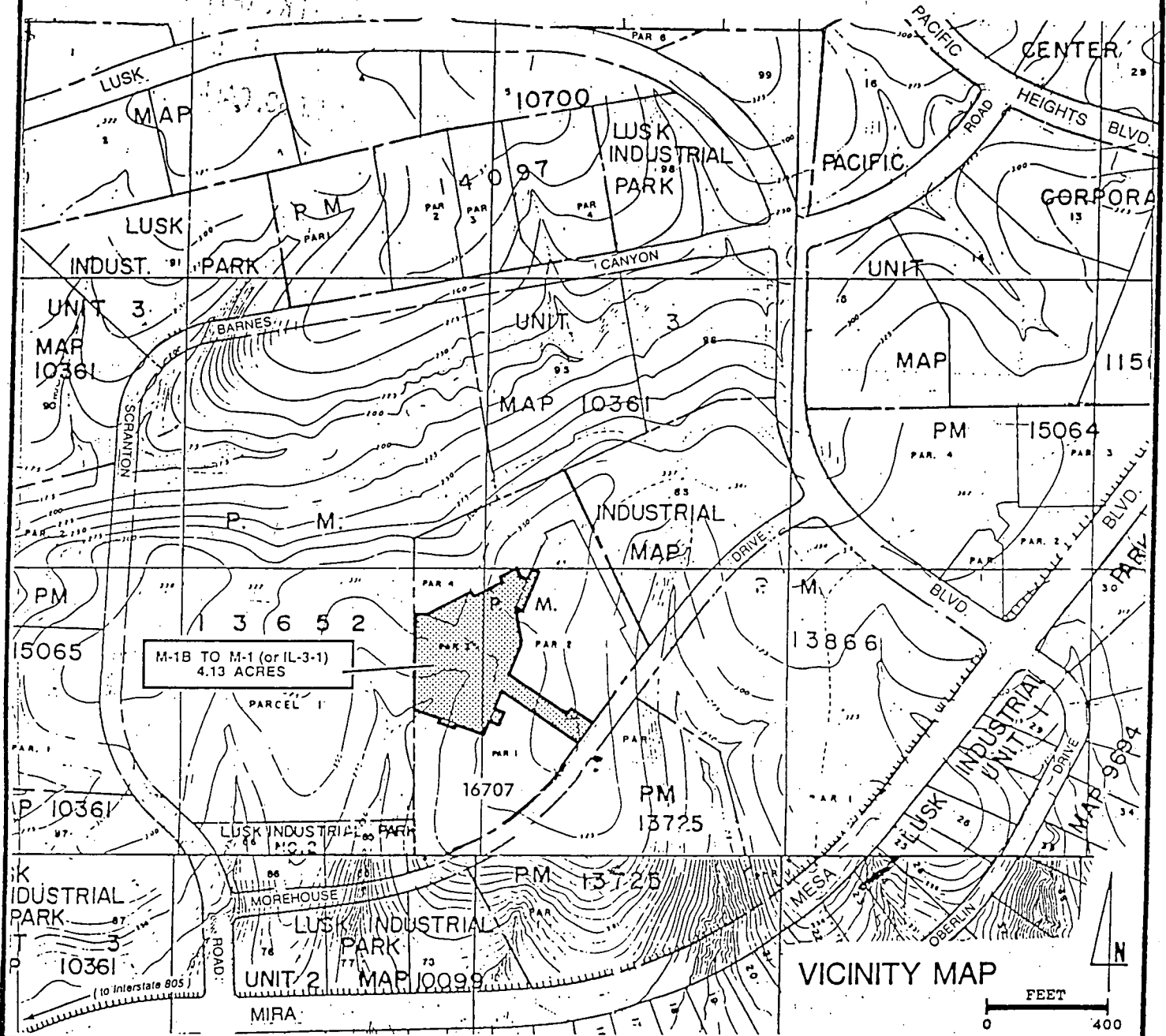

VICINITY MAP



Parcel 3 of PARCEL MAP 16707		CASE NO. 96-7896
ORDINANCE NO. _____	REQUEST M-1 (or IL-3-1)	<i>Ta. P. Alton</i> DEVELOPMENT SERVICES MANAGER
EFF. DATE ORD. _____	PLAN. COMM. RECOMMENDATION	
ZONING SUBJ. TO _____	CITY COUNCIL ACTION	B - 4088
BEFORE DATE _____		APN: 341-031-71
EFF. DATE ZONING _____		(266-1708) 1-14-98 bf. REV. 2-20-98 bf.
MAP NAME & NO. _____		

DOCUMENT NO. 00-18504

FILED MAY 04 1998

OFFICE OF THE CITY CLERK
SAN DIEGO, CALIFORNIA

0-18504