

RESOLUTION NUMBER R- 290728

ADOPTED ON SEP 15 1998

RESOLUTION ESTABLISHING AN UNDERGROUND
UTILITY DISTRICT TO BE KNOWN AND DENOMINATED
AS THE CCDC AREA 2 PHASE II (12TH AVENUE TO
17TH STREET AND MARKET STREET TO K STREET)
UNDERGROUND UTILITY DISTRICT.

WHEREAS, by Resolution No. R- 290560, a public hearing was called for on September 15, 1998 at the hour of 10:00 a.m. in the Council Chambers of the City Administration Building, 202 C Street, San Diego, California, to determine whether the public health, safety, or general welfare requires the removal of poles, overhead wires, and associated structures and the underground installation of wires and facilities for supplying electric, communication, community antenna television or similar or associated service within that certain area of the City of San Diego, including the described public rights-of-way, more particularly shown in the Legal Description attached hereto as Exhibit A and incorporated herein, and as more particularly shown in Drawing No. D-29401-D, entitled "CCDC AREA 2 PHASE II (12TH AVENUE TO 17TH STREET AND MARKET STREET TO K STREET) UNDERGROUND UTILITY DISTRICT," copies of which are on file in the office of the City Clerk as Document No. RR- 290560; and

WHEREAS, notice of such hearing has been given by the City Clerk to all affected property owners as defined in Chapter VI, Article 1, Division 5 of the San Diego Municipal Code, and the utilities concerned in the manner and for the time required by law; and

WHEREAS, such hearing has been duly and regularly held and all persons interested have been given an opportunity to be heard; NOW, THEREFORE,

BE IT RESOLVED, by the Council of the City of San Diego, as follows:

1. The City Council hereby finds and determines that the public health, safety, or general welfare require the removal of poles, overhead wires and associated overhead structures and the underground installation of wires and facilities for supplying electric, communication, community antenna television or similar or associated service within the area set forth above and that pursuant to Chapter VI, Article 1, Division 5 of the San Diego Municipal Code, the above-described area is hereby declared to be an underground utility district in the City of San Diego, and the maps and document referred to above are hereby incorporated as a part of this resolution.

2. The City Council shall by subsequent resolution fix the date on which the property in the district must be ready to receive underground service, and shall by subsequent resolution order the removal of all poles, overhead wires, and associated overhead structures, and the underground installation of wires and facilities for supplying electric, communication, community antenna television or similar or associated service.

3. The City Clerk is hereby instructed to notify all affected persons as defined in Chapter VI, Article 1, Division 5 of the San Diego Municipal Code, and all affected utility companies of the adoption of this resolution within fifteen days after date of adoption. The City Clerk shall further notify affected persons as defined in Chapter VI, Article 1, Division 5 of the San Diego Municipal Code of the necessity that if they desire to continue to receive electric, communication, community antenna television or similar or associated service they shall provide at their own expense all necessary facility changes on their premises so as to receive underground service from

the lines relocated underground of the supplying utility company subject to applicable rules, regulations, and tariffs of the respective utility company on file with the Public Utilities Commission of the State of California (as of the date of adoption of this resolution) and subject to all other applicable requirements of State law and City ordinances. The Clerk's notification shall be made in the manner provided in Chapter VI, Article 1, Division 5 of the San Diego Municipal Code.

APPROVED: CASEY GWINN, City Attorney

By



Thomas C. Zeleny
Deputy City Attorney

TCZ:mb
07/20/98
Or.Dept:Eng&CP
R-99-67
Form=uest.res

**GENERAL BOUNDARY DESCRIPTION FOR THE
CCDC - AREA 2- PHASE II
(12TH AVENUE TO 17TH STREET & MARKET STREET TO K STREET)
UNDERGROUND UTILITY DISTRICT**

The CCDC - AREA 2 - PHASE II (12TH AVENUE TO 17TH STREET & MARKET STREET TO K STREET) UNDERGROUND UTILITY DISTRICT shall be established to include the following described parcels:

Lot A-L of BLOCK 103, Lots A-L of BLOCK 104, Lots A-L of BLOCK 174, Lots A-L of BLOCK 106, Lots A-L of BLOCK 105, Lots A-F of BLOCK 173, Lots A-L of BLOCK 129, Lots A-L of BLOCK 130, Lots A-L of BLOCK 172 OF DB 13 PG 522-OFFICIAL MAP OF HORTONS ADDITION LOCKLING SAN DIEGO;

Portion Lot 4, Lots 1-6 of BLOCK 18, Lots 1-12 of BLOCK 17, Lots 1-12 of BLOCK 16, Lots 1-6 of BLOCK 15, Lots 1-12 of BLOCK 20, Lots 1-12 of BLOCK 21, Lots 1-6 of BLOCK 22, Lots 1-16 of BLOCK 36, Lots 1-12 of BLOCK 35, Lots 1-12 of BLOCK 34, Portion Lot 11, Lots 1 and 2 of BLOCK 39 of PLAN OF SHERMAN'S ADDITION TO SAN DIEGO MAP 856;

Parcels 1-6 of PARCEL MAP NO. 14511;

Portion Lots A-D, Lots M-P of BLOCK 33 of REMONDINO'S SUBDIVISION OF BLOCK 33 OF SHERMAN'S ADDITION TO SAN DIEGO MAP 53;

Lot 24 of BLOCK 38 of M. SHERMAN'S RESUBDIVISION OF BLOCK 38 SHERMAN'S ADDITION MAP NO. 1;

Said district shall also include the following public rights-of-way.

ISLAND AVENUE between the easterly line of 12TH AVENUE and a line parallel to and 100' feet east of the easterly line of 17TH STREET;

J STREET between the easterly line of 12TH AVENUE and a line parallel to and 100' feet east of the easterly line of 17TH STREET;

K STREET between the easterly line of 12TH AVENUE and a line parallel to and 100 +/- feet east of the westerly line of 17TH STREET.

THIRTEENTH STREET between the southerly line of K STREET and the southerly line of MARKET STREET;

FOURTEENTH STREET between the southerly line of K STREET and the southerly line of MARKET STREET;

FIFTEENTH STREET between the southerly line of K STREET and the southerly line of MARKET STREET;

SIXTEENTH STREET between the southerly line of K STREET and the southerly line of MARKET STREET;

SEVENTEENTH STREET between the southerly line of K STREET and the southerly line of MARKET STREET;

All as more particularly shown on City Engineer's Drawing No. 29401-D.

CCDC AREA 2 PHASE II (12TH AVENUE TO 17TH STREET AND MARKET STREET TO K STREET UNDERGROUND UTILITY DISTRICT

DOCUMENT NO. RL-290560
 FILED AUG 03 1998
 OFFICE OF THE CITY CLERK
 SAN DIEGO, CALIFORNIA

LEGEND:

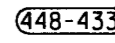
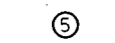
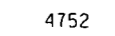
-  DISTRICT BOUNDARY
-  ASSESSOR'S BOOK & PAGE NO.
-  ASSESSOR'S PARCEL NO.
-  ADDRESS

RESOLUTION NO.: RL-290560
 DATE ADOPTED: AUG 03 1998

MARKET ST

MARKET ST

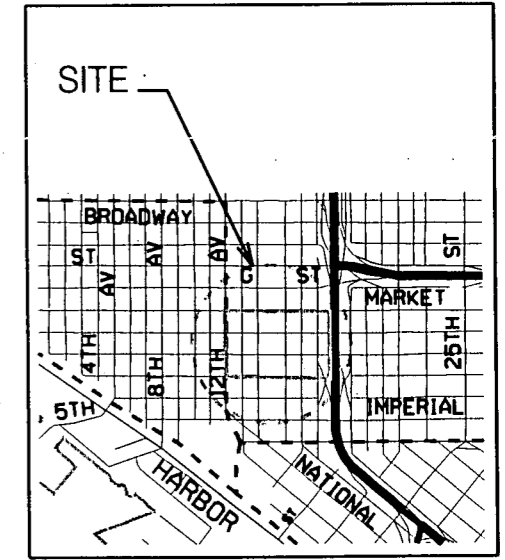
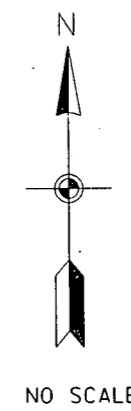
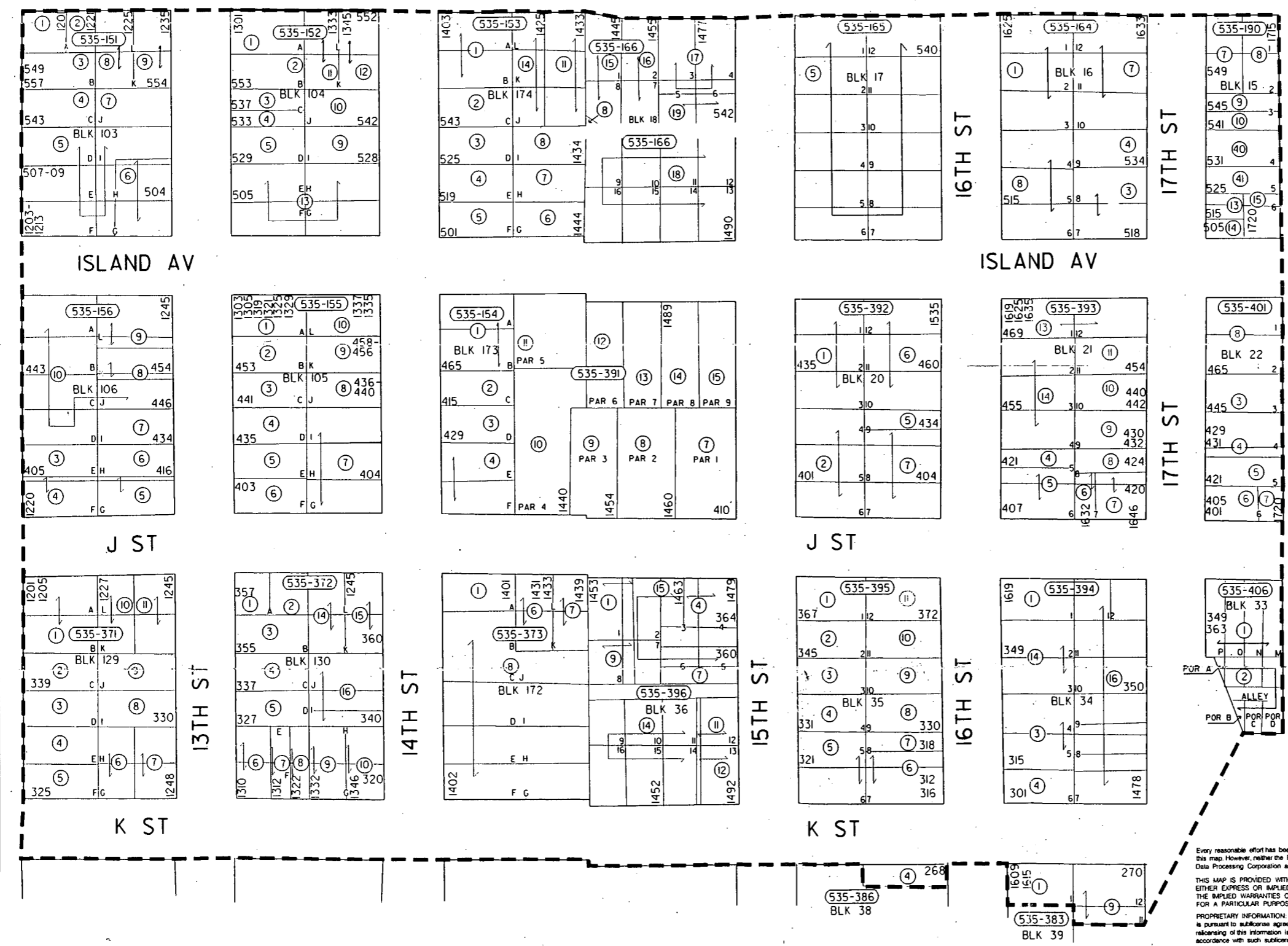

CCDC AREA 2 PHASE II (12TH AVE TO 17TH ST AND MARKET ST TO K ST) UNDERGROUND UTILITY DISTRICT

CITY OF SAN DIEGO, CALIFORNIA ENGINEERING AND DEVELOPMENT DEPARTMENT SHEET 1 OF 1 SHEETS		W.O. NO. 372978
FOR CITY ENGINEER	DATE	DIVISION HEAD
DESCRIPTION	BY	APPROVED DATE
FILE NAME: 07/06/98	EXY	
		DESIGN ENGINEER
		CONTROL CERTIFICATION
		198-1722
		LAMBERT COORDINATES
AS-BUILT	DATE STARTED	2940I-D
CONTRACTOR	DATE COMPLETED	
INSPECTOR		

Every reasonable effort has been made to assure the accuracy of this map. However, neither the RUIS participants nor San Diego Data Processing Corporation assume any liability arising from its use.

THIS MAP IS PROVIDED WITHOUT WARRANTY OF ANY KIND, EITHER EXPRESS OR IMPLIED, INCLUDING, BUT NOT LIMITED TO, THE IMPLIED WARRANTIES OF MERCHANTABILITY AND FITNESS FOR A PARTICULAR PURPOSE.

PROPRIETARY INFORMATION: The use of this information is pursuant to a sublicense agreement only. Any resale or retransmission of this information is prohibited, except in accordance with such sublicense agreements.

RL-290728