

RESOLUTION NUMBER R- 292789

ADOPTED ON FEB 22 2000

WHEREAS, Section 8330 et seq. of the California Streets and Highways Code provides a procedure for the summary vacation of public street easements by City Council resolution where the easement is no longer required; and

WHEREAS, the affected property owner has requested the vacation of the public street easement within, to unencumber this property and facilitate development of the site; and

WHEREAS, the City Council finds that:

(a) there is no present or prospective use for the public street easement either for the public street system, for which the right-of-way was originally acquired, or for any other public use of a like nature that can be anticipated in that the right-of-way is not needed for public street, bikeway, or open space purposes; and

(b) the public will benefit from the vacation through improved utilization of land; and

(c) the vacation is not inconsistent with the General Plan or an approved Community Plan; and

(d) the public street system for which the right-of-way was originally acquired will not be detrimentally affected by this vacation; NOW, THEREFORE,

BE IT RESOLVED, by the Council of The City of San Diego, as follows:

1. That the public street easement located within the Carmel Valley Community Plan Area, a portion of Mykonos Lane per Parcel Map No. 16284, as more particularly shown on Drawing No. 18728-B, and described in the legal description marked as Exhibit "A," on file in the office of

the City Clerk as Document No. RR- 292789-1, which is by this reference incorporated herein and made a part hereof, is ordered vacated.

2. That the City Clerk shall cause a certified copy of this resolution, attested by him under seal, to be recorded in the office of the County Recorder.

APPROVED: CASEY GWINN, City Attorney

By

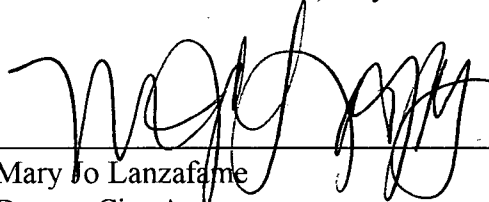

Mary Jo Lanzafame
Deputy City Attorney

MJL:pev
12/29/99
Or.Dept:PRD
SA:98-520
WO:930464
Dwg:18728-B
R-2000-777
Form=sumv.frm

LEGAL DESCRIPTION

W.O. # 930464

PARCEL "A" - STREET DEDICATION

That portion of Parcel 3 of Parcel Map No. 15120, filed in the Office of the County Recorder of San Diego County January 29, 1988, together with that portion of Parcel 4 of Parcel Map No. 16284, filed in the Office of the County Recorder of San Diego County November 8, 1990, all in the City of San Diego, County of San Diego, State of California, more particularly described as follows:

BEGINNING at the Northwest corner of Parcel 4 of said Parcel Map No. 16284, said point also being in the arc of a 45.00 foot radius curve concave Easterly in the Westerly line of the right-of-way of Mykonos Lane as dedicated to the public use per said Parcel Map No. 16284, a line radial to said point bears North $89^{\circ}26'24''$ West; thence leaving said westerly line of the right-of-way of Mykonos Lane, along the Easterly line of said Parcel 3 of said Parcel Map No. 15120, North $00^{\circ}33'36''$ East 45.00 feet to a point on the arc of a non-tangent 45.00 foot radius curve concave Southerly and Easterly, a line radial to said point bears North $00^{\circ}33'36''$ East; thence Westerly, Southwesterly, Southerly, Southeasterly, Easterly, and Northeasterly along the arc of said 45.00 foot radius curve through a central angle of $210^{\circ}00'00''$, a distance of 164.93 feet to a point in said Westerly line of the right-of-way of said Mykonos Lane, said point being on the arc of a non-tangent 45.00 foot radius curve concave Easterly, a line radial to said point bears South $30^{\circ}33'36''$ West; thence Northwesterly along the arc of said 45.00 foot radius curve on said Westerly line of Mykonos Lane through a central angle of $60^{\circ}00'00''$, a distance of 47.12 feet the **POINT OF BEGINNING**.

Said parcel of land contains 0.081 acre more or less.

This legal description was prepared by me or under my direction in conformance with the Land Surveyor's Act this August 9, 1999.

Signed Mary Acosta
Mary M. Acosta, PLS 6664
License Expiration Date: 06/30/2000

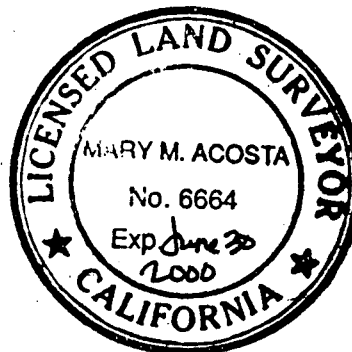

LEGAL DESCRIPTION
W.O. #930464

PARCEL "B" - STREET DEDICATION

That portion of Parcel 3 of Parcel Map No. 16284, filed in the Office of the County Recorder of San Diego County November 8, 1990, in the City of San Diego, County of San Diego, State of California, more particularly described as follows:

BEGINNING at the Northwest corner of Parcel 4 of said Parcel Map No. 16284, said point also being the Southwest corner of said Parcel 3 of said Parcel Map No. 16284, said point also being in the arc of a 45.00 foot radius curve concave Easterly in the Westerly line of the right-of-way of Mykonos Lane as dedicated to the public use per said Parcel Map No. 16284, a line radial to said point bears North 89°26'24" West; thence Northerly and Northeasterly along said Westerly line of the right-of-way and the arc of said curve through a central angle of 60°00'00", a distance of 47.12 feet to a point in the arc of a non-tangent a 45.00 foot radius curve concave Southerly, a line radial to said point bears North 30°33'36" East; thence Westerly along the arc of said 45.00 foot radius curve through a central angle of 30°00'00", a distance of 23.56 feet to a point in the Westerly line of said Parcel 3; thence along said Westerly line South 00°33'36" West 45.00 feet to the **POINT OF BEGINNING**.

Said parcel of land contains 0.008 acre more or less.

This legal description was prepared by me or under my direction in conformance with the Land Surveyor's Act this August 9, 1999.

Signed Mary Acosta
Mary M. Acosta, PLS 6664
License Expiration Date: 06/30/2000

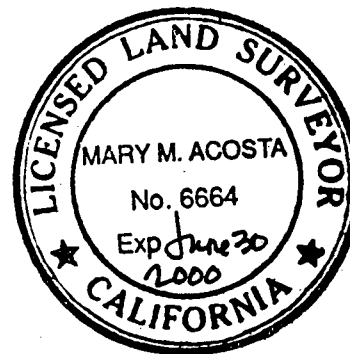

LEGAL DESCRIPTION

W.O. #930464

PARCEL "C" - STREET VACATION

That portion of Mykonos Lane as dedicated to the public use per Parcel Map No. 16284, filed in the Office of the County Recorder of San Diego County November 8, 1990, in the City of San Diego, County of San Diego, State of California, more particularly described as follows:

COMMENCING at the Northwest corner of Parcel 4 of said Parcel Map No. 16284, said point also being the Southwest corner of said Parcel 3 of said Parcel Map No. 16284, said point also being in the arc of a 45.00 foot radius curve concave Easterly in the Westerly line of the right-of-way of Mykonos Lane as dedicated to the public use per said Parcel Map No. 16284, a line radial to said point bears North 89°26'24" West; thence Northerly along said Westerly line of the right-of-way and the arc of said curve through a central angle of 60°00'00", a distance of 47.12 feet to THE TRUE POINT OF BEGINNING, a line radial to said point bears North 29°26'24" West; thence continuing Northeasterly along the arc of said curve and said right-of-way line through a central angle of 71°30'06" a distance of 56.16 feet to a point of reverse curve with a 20.00 foot radius curve concave Northeasterly, a line radial to said point bears South 42°03'42" West; thence continuing along said right-of-way line Southeasterly along the arc of said 20.00 foot radius curve through a central angle of 37°31'57", a distance of 13.10 feet to a point of cusp with a 530.00 foot radius curve concave Southerly, a line radial to said point bears North 04°31'45" East; thence leaving said right-of-way line of said Mykonos Lane, Westerly along the arc of said 530.00 foot radius curve through a central angle of 3°58'09", a distance of 36.72 feet; thence tangent to said curve North 89°26'24" West, 8.47 feet to the beginning point of a tangent 20.00 foot radius curve concave Northeasterly; thence Northwesterly along the arc of said 20.00 foot radius curve through a central angle of 39°42'54", a distance of 13.86 feet to a point of reverse curve with a 45.00 foot radius curve concave Southwesterly, a line radial to said point bears North 40°16'30" East; thence Northwesterly along the arc of said 45.00 foot radius curve through a central angle of 09°42'54", a distance of 7.63 feet to the TRUE POINT OF BEGINNING.

Said parcel of land contains 0.014 acre more or less.

This legal description was prepared by me or under my direction in conformance with the Land Surveyor's Act this August 9, 1999.

Signed Mary Acosta
Mary M. Acosta, PLS 6664
License Expiration Date: 06/30/2000

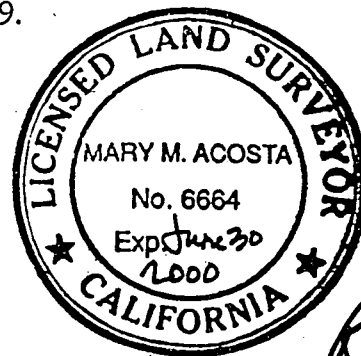

PAWO 1207-011-2
1207vacc.doc
18728-B

1
R. 292789

LEGAL DESCRIPTION

W.O. #930464

PARCEL "D" - STREET VACATION

That portion of Mykonos Lane as dedicated to the public use per Parcel Map No. 16284, filed in the Office of the County Recorder of San Diego County November 8, 1990, in the City of San Diego, County of San Diego, State of California, more particularly described as follows:

COMMENCING at the Northwest corner of Parcel 4 of said Parcel Map No. 16284, said point also being in the arc of a 45.00 foot radius curve concave Easterly in the Westerly line of the right-of-way of Mykonos Lane as dedicated to the public use per said Parcel Map No. 16284, a line radial to said point bears North 89°26'24" West; thence Southeasterly along said Westerly line of the right-of-way and the arc of said curve through a central angle of 60°00'00", a distance of 47.12 feet to the TRUE POINT OF BEGINNING, a line radial to said point bears South 30°33'36" West; thence continuing Southeasterly and Easterly along the arc of said curve and said right-of-way line through a central angle of 67°48'44", a distance of 53.26 feet a point of reverse curve with a 20.00 foot radius curve concave Southeasterly, a line radial to said point bears North 37°15'08" West; thence continuing along said right-of-way line Northeasterly along the arc of said curve through a central angle of 42°15'14", a distance of 14.75 feet to a point of cusp with a 470.00 foot radius curve concave Southerly, a line radial to said point bears North 5°00'06" East; thence leaving said right-of-way line of said Mykonos Lane, Westerly along the arc of said 470.00 foot radius curve through a central angle of 4°26'30", a distance of 36.44 feet; thence tangent to said curve North 89°26'24" West, 8.47 feet to the beginning point of a tangent 20.00 foot radius curve concave Southeasterly; thence Southwesterly along the arc of said 20.00 foot radius curve through a central angle of 39°42'54", a distance of 13.86 feet to a point of reverse curve with a 45.00 foot radius curve concave Northwesterly, a line radial to said point bears South 39°09'18" East; thence Southwesterly, along the arc of said 45.00 foot radius curve through a central angle of 9°42'54", a distance of 7.63 feet to a point in the Southerly line of the right-of-way of said Mykonos Lane and the TRUE POINT OF BEGINNING.

Said parcel of land contains 0.013 acre more or less.

This legal description was prepared by me or under my direction in conformance with the Land Surveyor's Act this August 9, 1999.

Signed Mary Acosta
Mary M. Acosta, PLS 6664
License Expiration Date: 06/30/2000



PAWO 1207-011-2
1207vacd.doc
18728-B

R- 292789

