

RESOLUTION NUMBER R- 293856
SEP 19 2000

ADOPTED ON _____

APPROVING PARCEL MAP - WO# 400486.

WHEREAS, Standard Pacific Corporation, the owner of the properties described below proposes to file a parcel map of subject properties being a lot line adjustment and consolidation of lots; and

WHEREAS, the owner seeks the vacation of portions of Ocean Ridge Way, Shorepointe Way, and certain open space easements; NOW, THEREFORE

BE IT RESOLVED, by the Council of the City of San Diego, that the Council finds that certain parcel map surveyed by George L. Benton, Registered Civil Engineer, titled "PARCEL MAP being a lot line adjustment and consolidation of lots 1 through 43, 53 and 54 of Torrey Surf Map No. 13878 filed in the office of the County Recorder of San Diego County November 24, 1999, in the City of San Diego, County of San Diego, State of California, together with portions of Ocean Ridge Way, Shorepointe Way and Fairwind Court as dedicated to public use; and Lot "A" of Carmel Estates Unit No. 2 Map No. 13958 filed in the office of the County Recorder of San Diego County April 18, 2000, in the City of San Diego, County of San Diego, State of California, together with a portion of Fairport Way as dedicated to public use" [the MAP], is made in the manner and form prescribed by law and conforms to the surrounding surveys; that the MAP and the subdivision of land shown thereon is approved and accepted; and the Council accepts on behalf of the public, the following: Ocean Ridge Way, Fairport Way and a portion of East Ocean Air Drive together with all appurtenances thereto and the streets and a portion of a

street are declared to be public streets and a portion of a public street and dedicated to the public use, as dedicated and shown on the MAP and subject to the conditions set forth on the MAP.

BE IT FURTHER RESOLVED, that portions of Ocean Ridge Way, Shorepointe Way, and portions of the open space easements as granted on Map 13878 are not shown on this map and are vacated pursuant to Section 66445(j) of the Subdivision Map Act.

BE IT FURTHER RESOLVED, that the City Clerk is authorized and directed to endorse upon the MAP, as and for the act of the Council, that the Council has approved the MAP including the above-mentioned street and easement vacation action.

BE IT FURTHER RESOLVED, that the City Clerk is directed to transmit a certified copy of this Resolution, with the MAP, attested by him under seal, to the County Recorder of the County of San Diego, California, to be recorded.

APPROVED: CASEY GWINN, City Attorney

By

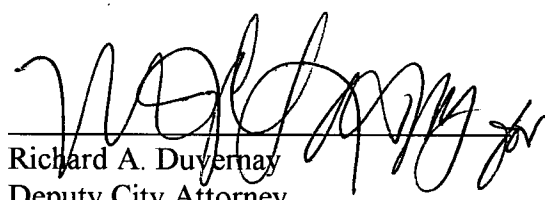
Richard A. Duvernay
Deputy City Attorney

RAD:lc
08/31/00
T.M.None
W.O.400486
Or.Dept:PDR
R-2001-358
Form=pmapr.frm

EXHIBIT "A"

TORREY SURF / CARMEL ESTATES UNIT NO. 2 RECORDED MAP EXHIBIT



 INDICATES PORTIONS OF RECORDED MAPS TO BE CONSOLIDATED IN THE PROPOSED PARCEL MAP.

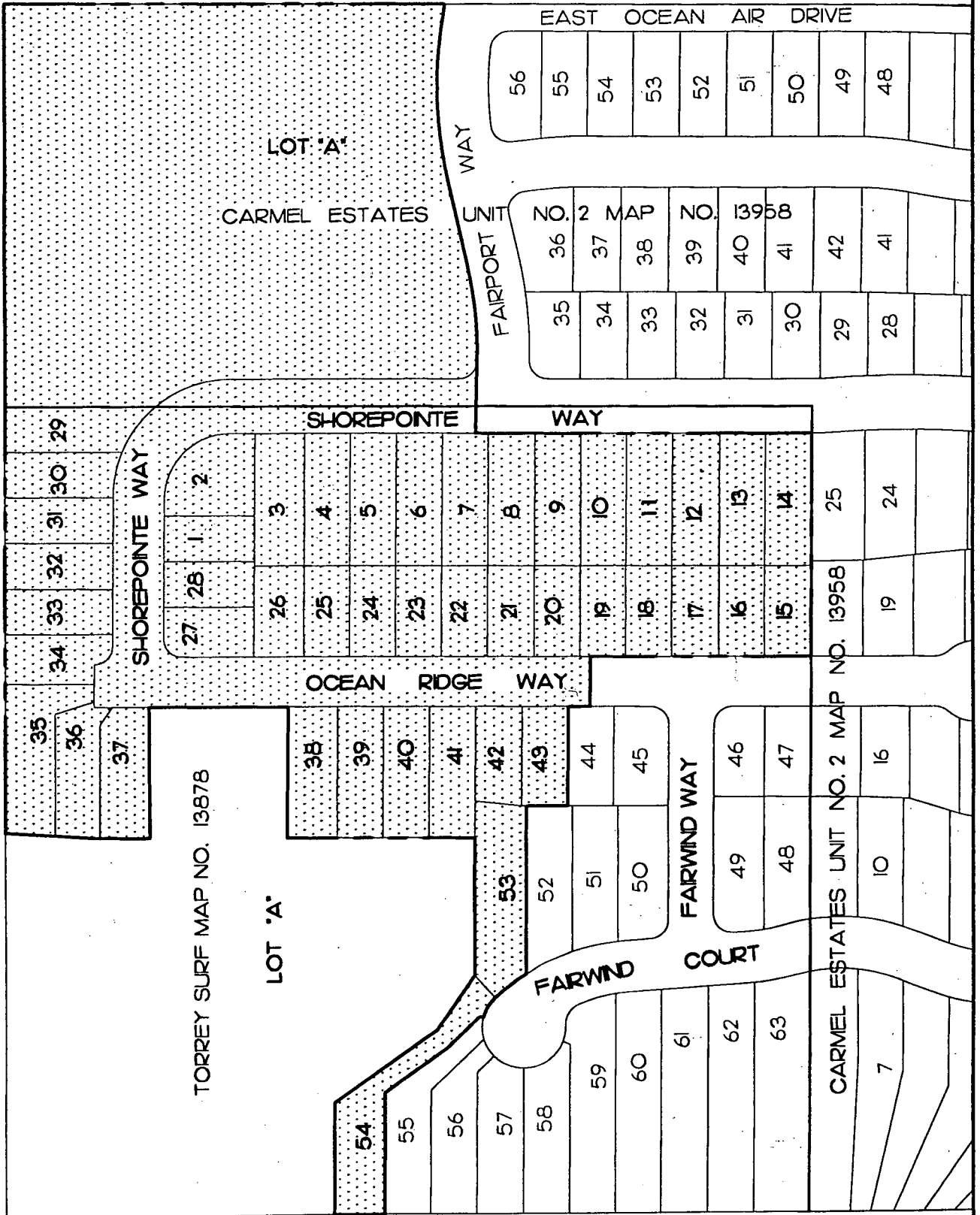

R-293856

EXHIBIT "B"

**TORREY SURF / CARMEL ESTATES UNIT NO. 2
STREET VACATION AND EASEMENT ABANDONMENT EXHIBIT**



INDICATES PORTIONS OF SHOREPONTE WAY AND OCEAN RIDGE WAY TO BE VACATED



INDICATES OPEN SPACE EASEMENT TO BE ABANDONED

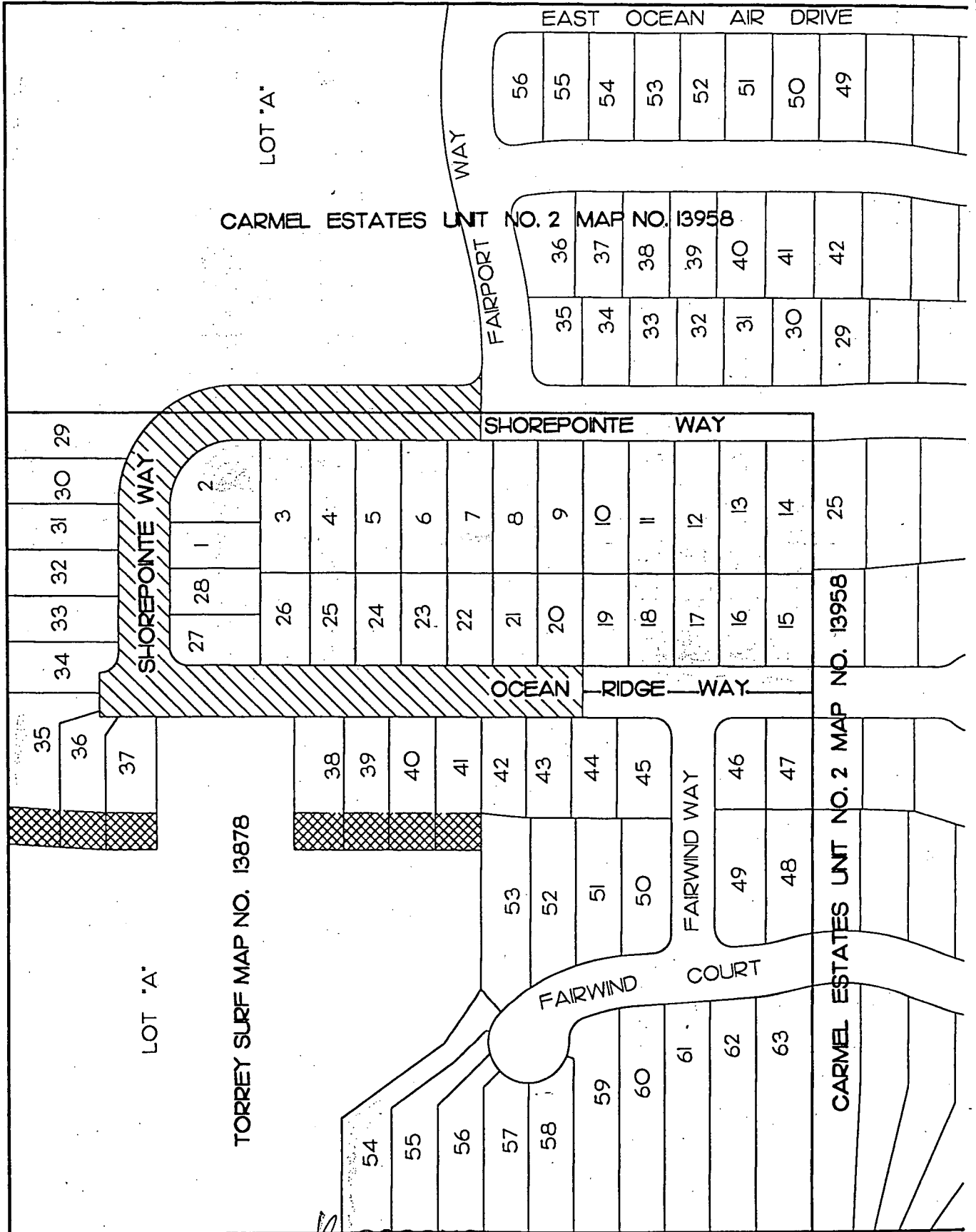
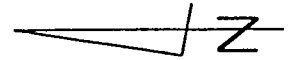

293855

EXHIBIT "C"

TORREY SURF / CARMEL ESTATES UNIT NO. 2 CONSOLIDATION & LOTLINE ADJUSTMENT PARCEL MAP EXHIBIT

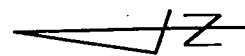

INDICATES DEDICATED FOR
STREET PURPOSES

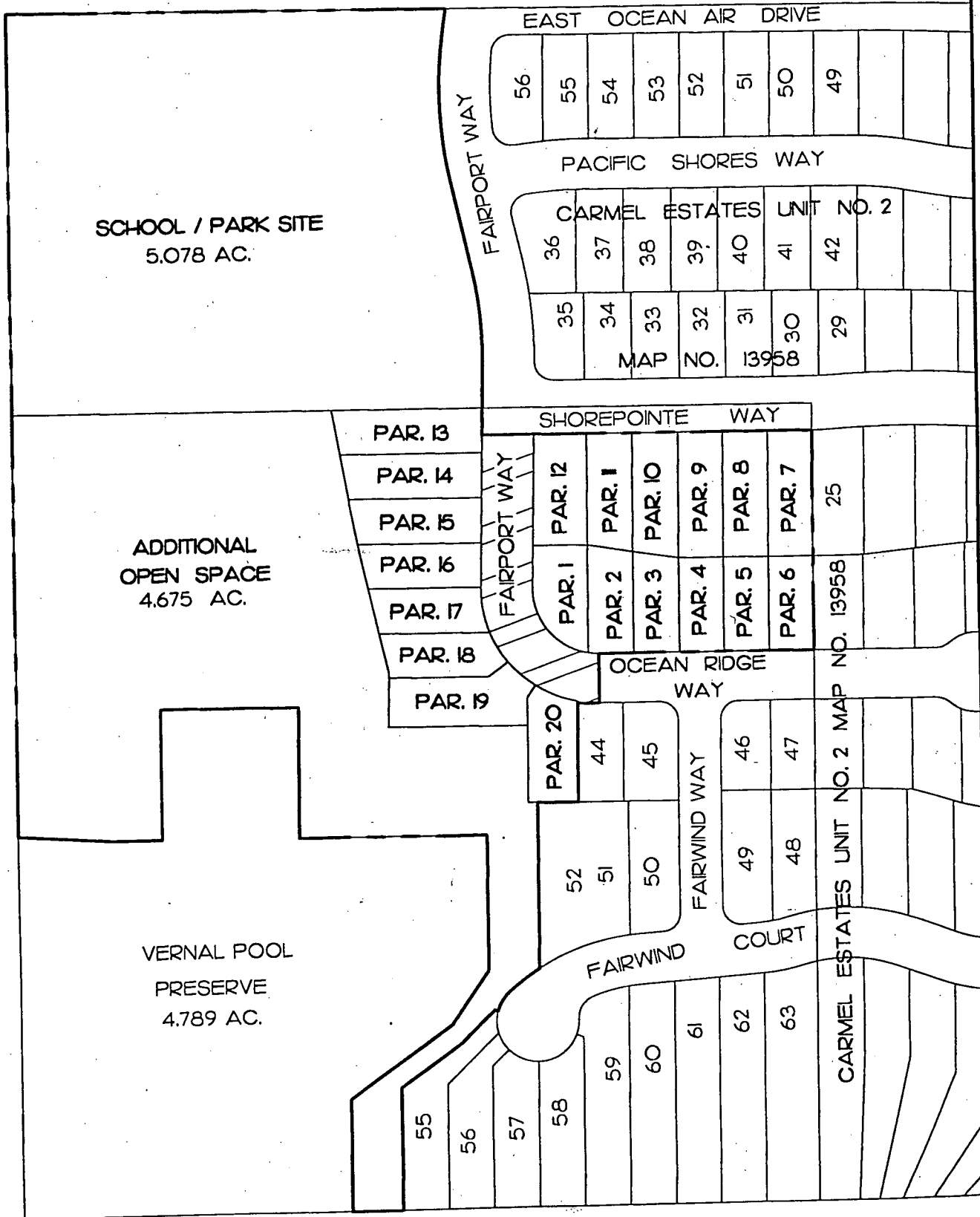

R-293856

W.O. 400486