

RESOLUTION NUMBER R- 296915

ADOPTED ON AUG 05 2002

WHEREAS, Section 8330 et seq. of the California Streets and Highways Code provides a procedure for the summary vacation of public service easements by City Council resolution where the easement is no longer required; and

WHEREAS, the affected property owner has requested the vacation of a building restricted easement in Parcel 22 of Map No. 18504, to unencumber his property and facilitate its transfer to San Diego Gas and Electric, who intend to construct a substation that will serve the public; and

WHEREAS, San Diego Gas and Electric require the property owner to transfer the property free of all encumbrances; and

WHEREAS, the City Council finds that:

(a) there is no present or prospective use for the building restricted easement either for which it was originally acquired, or for any other public use of a like nature that can be anticipated;

(b) the public will benefit from the vacation through improved utilization of land;

(c) the vacation is not inconsistent with the General Plan, an approved Community Plan, or Local Coastal Program; and

(d) the public service easement system for which the easement was originally acquired will not be detrimentally affected by this vacation; NOW, THEREFORE,

BE IT RESOLVED, by the Council of the City of San Diego, as follows:

1. That the building restricted easement located in Parcel 22 of Map No. 18504, as more particularly described in the legal description, attached hereto as Exhibit "A", and as shown on Drawing No. 19754-B, attached hereto as Exhibit "B", is ordered vacated.

2. That the City Engineer shall advise the City Clerk of the execution of the transfer deed by property owner to San Diego Gas and Electric, and the City Clerk shall then cause a certified copy of this resolution, with Exhibits "A" and "B", attested by him under seal, to be recorded in the Office of the County Recorder.

APPROVED: CASEY GWINN, City Attorney

By

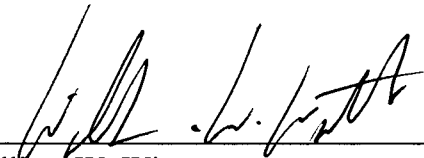

William W. Witt
Deputy City Attorney

WWW:cdk
07/19/02
07/25/02 COR. COPY
Orig.Dept.:Dev.Svcs.
W.O. 120101
Drawing Nos. 19754-B
R-2003-175

EXHIBIT "A"

VACATION OF A BUILDING RESTRICTED EASEMENT

Being all of Parcel 22 of Parcel Map No. 18504, in the City of San Diego, County of San Diego, State of California, according to Map thereof filed in the Office of the County Recorder of San Diego County July 18, 2000.

 5-30-02

Robert G. Schoettmer, L.S. 4324
License Expires 6/30/2004

W.O. No. 120101
Dwg. No. 19754-B
A No. 02-622

Jb/13504.001



R- 296915

EXHIBIT "B"

COUNTY OF SAN DIEGO

CITY OF SAN DIEGO

PCL 13

PARCEL MAP

NO. 18504

PCL 24

CAMINO DEL NORTE DEDICATED PER DEED
RECORDED 5-16-2000 AS DOC. NO. 2000-0253519
OF O.R. (CITY DWG NO. 28644-D)

CAMINO DEL NORTE

PARCEL "F"

PAR "C"

"NOT A
PART OF
PARCEL MAP NO. 18504"
POR. SEC. 30 (SEE DEED RECORDED
11-21-1968 AS FILE/PAGE NO. 204006 O.R.)

LEGEND

 INDICATES BUILDING RESTRICTED
EASEMENT GRANTED ON PARCEL
MAP NO 18504 VACATED, 1504 ACRES

ASSESSOR'S PARCEL NUMBERS

678-230-17

REFERENCE DRAWING

PARCEL MAP NO. 18504 . 28644-D

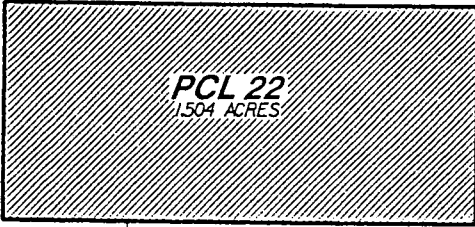

PCL 22
1504 ACRES

PARCEL MAP NO. 18504

PCL 21

PCL 23

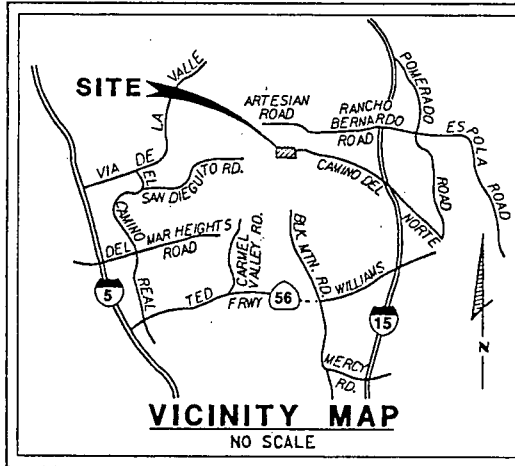
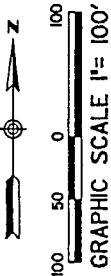

J-13504



RICK
ENGINEERING
COMPANY

Robert G. Schoettmer 7-2-2002
ROBERT G. SCHOETTNER, LS 4324 DATE

BUILDING RESTRICTED EASEMENT VACATION
IN PARCEL 22 OF PARCEL MAP NO. 18504

DESCRIPTION	BY	APPROVED	DATE	FILMED	CITY OF SAN DIEGO, CALIFORNIA	W.O. NO.
ORIGINAL	AEA		7-2-02		SHEET 1 OF 1 SHEET	120101 A 02-622
					<i>Robert G. Schoettmer</i> 6/28/02 FOR CITY ENGINEER DATE	CCS NAD 83 COORDINATES
						318-1729 LAMBERT COORDINATES
						19754 -B
					STATUS	

296915