

#333  
5/2/06

(R-2006-877)

RESOLUTION NUMBER R- 301416

DATE OF FINAL PASSAGE MAY 08 2006

A RESOLUTION CALLING FOR A PUBLIC HEARING TO DETERMINE WHETHER THE PUBLIC HEALTH, SAFETY, OR GENERAL WELFARE REQUIRES THE FORMATION OF UNDERGROUND UTILITY DISTRICTS

WHEREAS, Chapter VI, Article 1, Division 5 of the San Diego Municipal Code establishes a procedure for the creation of underground utility districts and requires as an initial step in such procedure the holding of a public hearing to determine whether the public health, safety, or general welfare requires removal of poles, overhead wires, and associated structures and the underground installation of wires and facilities for supplying electric, communication, community antenna television or similar or associated service in any such district; and

WHEREAS, it has been recommended that the following underground utility districts be formed:

- Waring Road/I-8 from Adobe Falls Road to Alvarado Canyon Road, as more fully described in the attachment to this resolution and more particularly shown on Drawing No. 33810-1-D
- La Jolla Mesa Drive from La Jolla Scenic South Drive to Muirlands Drive, as more fully described in the attachment to this resolution and more particularly shown on Drawing No. 33811-1-D
- K Street (Phase 1) from 19<sup>th</sup> Street to 24<sup>th</sup> Street, as more fully described in the attachment to this resolution and more particularly shown on Drawing No. 33817-1-D

- K Street (Phase 2) from 26<sup>th</sup> Street to 30<sup>th</sup> Street, as more fully described in the attachment to this resolution and more particularly shown on Drawing No. 33817-2-D

NOW THEREFORE, BE IT RESOLVED, by the Council of the City of San Diego [City Council], as follows:

1. Notice is hereby given that a public hearing will be held by the City Council on May 23, 2006 at the hour of 2:00 p.m., in the Council Chambers of the City Administration Building, 202 C Street, San Diego, California, to determine whether the public health, safety, or general welfare requires the removal of poles, overhead wires, and associated overhead structures and the underground installation of wires and facilities for supplying electric, communication, community antenna television or similar or associated service in the Districts described above.

2. At such hearing, all persons interested shall be given an opportunity to be heard and the hearing may be continued from time to time as may be determined by the City Council. The decision of the City Council as to the formation of the Districts as described above shall be final and conclusive.

3. The Mayor shall notify all affected persons as defined in Chapter VI, Article 1, Division 5 of the San Diego Municipal Code and each utility company concerned of the time and place of the hearing by following the procedure set forth in Chapter VI, Article 1, Division 5 of the San Diego Municipal Code.

APPROVED: MICHAEL J. AGUIRRE, City Attorney

By

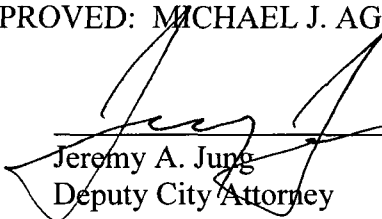
  
\_\_\_\_\_  
Jeremy A. Jung  
Deputy City Attorney

JAJ:cla

4/12/2006

Aud.Cert: N/A

R-2006-877

Attachments: Exhibits A, B, C, D (Legal Description), and E, F, G, and H (Maps)

I hereby certify that the foregoing Resolution was passed by the Council of the City of San Diego, at its meeting of MAY 02 2006.

ELIZABETH S. MALAND  
City Clerk

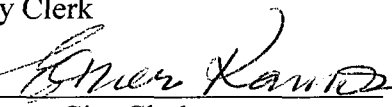
By   
\_\_\_\_\_  
Deputy City Clerk

Approved: 5-8-06  
(date)

  
\_\_\_\_\_  
JERRY SANDERS, Mayor

Vetoed: \_\_\_\_\_  
(date)

\_\_\_\_\_  
JERRY SANDERS, Mayor

GENERAL BOUNDARY DESCRIPTION FOR THE WARING ROAD/I-8  
(BOUNDED BY WARING GATEWAY TO ALLIED GARDENS)  
UNDERGROUND UTILITY DISTRICT

The WARING ROAD/I-8 (BOUNDED BY WARING GATEWAY TO ALLIED GARDENS) shall be established to include the following described parcels:

Portion of Lot 67 of Ranch Mission Referees Partition of Subdivision Map No. 330,  
Certificate of Correction 348

Said district shall also include the following public rights of way:

ALVARADO CANYON ROAD between a line parallel to the westerly line of portion of Lot 2 and to the easterly line of portion of Lot 1

ALVARADO CANYON ROAD a line parallel to the westerly line of MISSION GORGE PLACE to a line parallel to the westerly line of Parcel 1

MISSION GORGE PLACE a line parallel to the southerly line of ALVARADO CANYON ROAD and  $\pm 160$  feet north

WARING ROAD between a line parallel to and  $\pm 120$  feet south of the southerly line of HOWARD JOHNSON PLACE and a line parallel to the northeasterly line of Parcel 2

R- 301416

**EXHIBIT A**

GENERAL BOUNDARY DESCRIPTION FOR THE LA JOLLA MESA DRIVE  
(BOUNDED BY LA JOLLA SCENIC DRIVE SOUTH TO MUIRLANDS DRIVE)  
UNDERGROUND UTILITY DISTRICT

The LA JOLLA MESA DRIVE (BOUNDED BY LA JOLLA SCENIC DRIVE SOUTH TO MUIRLANDS DRIVE) shall be established to include the following described parcels:

Lot 1 of R. S. Subdivision of Subdivision Map No. 6280

Lots 1 thru 3 of Muirlands Acres Unit No. 4 of Subdivision Map No. 3609

Portion of Lot 10 of Muirlands Panorama of Subdivision Map No. 3329

Lots 1 thru 5 and Portion of Lot 8 in Block 1, Lots 1 and 9 in Block 3, Lot 1 in Block 4 of Muirlands Heights of Subdivision Map No. 3023

Portion of Block 13 of The Muirlands of Subdivision Map No. 2024

Portion of Lot 1774 of Map of Pueblo Lands of Miscellaneous Map No. 36

Parcels 1 and 2 of Parcel Map No. 17585

Parcels 1 and 2 of Parcel Map No. 15106

Said district shall also include the following public rights of way:

LA JOLLA MESA DRIVE between a line parallel to and  $\pm 100$  feet south of the southerly line of MUIRLANDS DRIVE and a line parallel to and  $\pm 40$  feet south of the southerly line of LA JOLLA SCENIC DRIVE SOUTH

LA JOLLA RANCHO ROAD between a line parallel to the northeasterly line of LA JOLLA MESA DRIVE to  $\pm 300$  feet east of LA JOLLA RANCHO ROAD

R 301416

**EXHIBIT B**

GENERAL BOUNDARY DESCRIPTION FOR THE K STREET PHASE 1  
(BOUNDED BY 19<sup>TH</sup> STREET TO 24<sup>TH</sup> STREET)  
UNDERGROUND UTILITY DISTRICT

The K STREET PHASE 1 (BOUNDED BY 19<sup>TH</sup> STREET TO 24<sup>TH</sup> STREET) shall be established to include the following described parcels:

Lot 1 and Portion of Lot 2 of Block 42 of Sherman's Addition Refiled of Map No. 856

Lots 1, 2, Portion of Lot 11 and Portion of 12 of Block 43 of Sherman's Addition Refiled of Map No. 856

Portion of Lot 6 of Block 30 of Sherman's Addition Refiled of Map No. 856

Lots 5, 6, and 7 of Block 29 of Sherman's Addition Refiled of Map No. 856

Lots 1 through 16 of Block 27 of Sherman's Addition Refiled of Map No. 856

Lots 1 through 16 of Block 28 of Sherman's Addition Refiled of Map No. 856

Portion of Blocks 10 and 11 of L W Kimballs Sub of Northwest one quarter of Pueblo Lands 1154 of Subdivision Map No. 56

Said district shall also include the following public rights of way:

K STREET between a line parallel to the easterly line of 19<sup>TH</sup> STREET and a line parallel to and ±50 feet east of a line parallel to the easterly line of 24<sup>TH</sup> STREET

R - 301416

**EXHIBIT C**

GENERAL BOUNDARY DESCRIPTION FOR THE K STREET PHASE 2  
(BOUNDED BY 26<sup>TH</sup> STREET TO 30<sup>TH</sup> STREET)  
UNDERGROUND UTILITY DISTRICT

The K STREET PHASE 2 (BOUNDED BY 26<sup>TH</sup> STREET TO 30<sup>TH</sup> STREET) shall be established to include the following described parcels:

Portion of Lots 1 through 4 and Lots 5 through 22 of Block 42 of Charles Hensley Subdivision of Deed Book 14-PG 274

Lots 25 through 46 of Grants Subdivision of Map No. 1020

Lots 1 and 2, portions of Lots 3 and 4 of Block 50 of Olmsted and Low's of Map No. 178

Lots 1 through 4, portion of Lots 46 through 48, and Lots 49, 50 of Block 51 of Olmsted and Low's of Map No. 178

Lots 1 through 4, portion of Lots 5,6, and Lots 7 through 24 of Block 13 of Hensley's Addition of Map No. 208

Portion of Lots 7 and 8, and Lot 9 of Block 20 of Hoitt's Addition Resubdivision of Block 12 of Map No. 554

Portion of Lots 1 through 4, and Lots 5 through 17 of Block 1 and Portion of Lots 1 through 4 of Block 6 of Reeds Central Addition Corrected Map of Subdivision Map No. 981

Lot 7 and portion of Lot 8 of Block 17 of Hoitt's Addition of Subdivision Map No. 29

Lots 5 through 24 of Block 79 of Powers Subdivision of Subdivision Map No. 190

Said district shall also include the following public rights of way:

K STREET between a line parallel to the easterly line of 26<sup>TH</sup> STREET and a line parallel to the westerly line of the south leg of 30<sup>TH</sup> STREET

27<sup>TH</sup> STREET between a line parallel to the northerly line and  $\pm 50$  feet north of K STREET and a line parallel to the southerly line and  $\pm 35$  feet south of K STREET

LANGLEY STREET between a line parallel to the northerly line and  $\pm 100$  feet north of K STREET

ALLEY 50 OF OLMSTED AND LOW'S ADDITION between a line parallel to and  $\pm 100$  feet north of the northerly line of K STREET

2- 301416

**EXHIBIT D**

ALLEY 51 OF OLMSTED AND LOW'S ADDITION between a line parallel to and  
±100 feet north of the northerly line of K STREET

DODSON WAY between a line parallel to and ±80 feet south of the southerly line of K  
STREET

R-301416



# WARING ROAD/I-8 (WARING GATEWAY - ALLIED GARDENS) UNDERGROUND UTILITY DISTRICT



### LEGEND

- PROJECT BOUNDARY
- PARCELS
- PROPOSED STREET LIGHT
- 123456 ASSESSOR'S BOOK & PAGE NO.
- 6 ASSESSOR'S PARCEL NO.
- 1234 ADDRESS

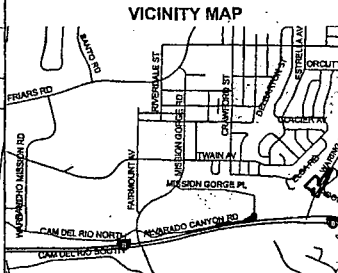
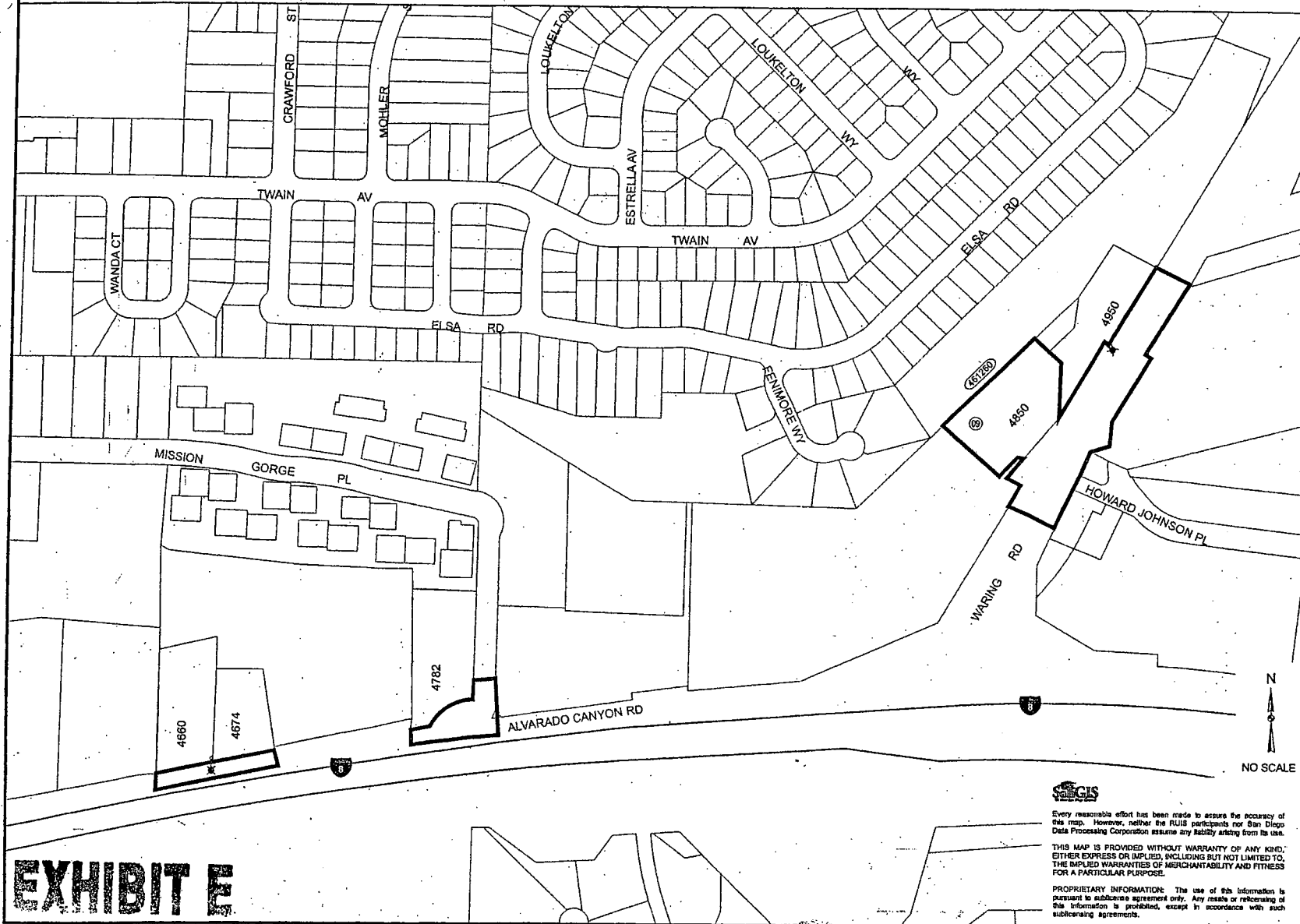

### WARING ROAD/I-8 (WARING GATEWAY TO ALLIED GARDENS) UNDERGROUND UTILITY DISTRICT

CITY OF SAN DIEGO, CALIFORNIA  
ENGINEERING AND CAPITAL PROJECTS DEPARTMENT  
SHEET 1 OF 1 SHEETS

<small>FOR CITY ENGINEER</small>	<small>DATE</small>	<small>DIVISION</small>
<small>DESCRIPTION</small>	<small>BY</small>	<small>APPROVED</small>
<small>FILE NO.</small>	<small>DATE</small>	<small>DATE</small>
<small>ISSUED</small>	<small>COM</small>	<small>DESIGN ENGINEER</small>
<small>APPROVED</small>		<small>CITY ENGINEER</small>
<small>DATE</small>	<small>DATE</small>	<small>DATE</small>
<small>CONTRACTOR</small>	<small>DATE STARTED</small>	<small>33810-</small>
<small>INSPECTOR</small>	<small>DATE COMPLETED</small>	

**EVERETT**  
EVERETT GIS

Every reasonable effort has been made to ensure the accuracy of this map. However, neither the RUIIS participants nor San Diego Data Processing Corporation assume any liability arising from its use.

THIS MAP IS PROVIDED WITHOUT WARRANTY OF ANY KIND, EITHER EXPRESS OR IMPLIED, INCLUDING BUT NOT LIMITED TO, THE IMPLIED WARRANTIES OF MERCHANTABILITY AND FITNESS FOR A PARTICULAR PURPOSE.

PROPRIETARY INFORMATION: The use of this information is restricted to the specific project only. Any resale or reworking of this information is prohibited, except in accordance with such subcontracting agreements.

# EXHIBIT E

301416

# LA JOLLA MESA DRIVE (LA JOLLA SCENIC DR S. TO MUIRLANDS DRIVE) UNDERGROUND UTILITY DISTRICT



### LEGEND

- PROJECT BOUNDARY
- PARCELS
- PROPOSED STREET LIGHT
- 123456 ASSESSOR'S BOOK & PAGE NO.
- 5 ASSESSOR'S PARCEL NO.
- 1234 ADDRESS

### VICINITY MAP

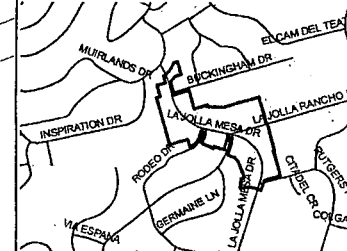

### LA JOLLA MESA DRIVE (LA JOLLA SCENIC DR S. TO MUIRLANDS DR) UNDERGROUND UTILITY DISTRICT

CITY OF SAN DIEGO, CALIFORNIA  
ENGINEERING AND CAPITAL PROJECTS DEPARTMENT  
SHEET 1 OF 1 (SHEET)

FOR CITY ENGINEER		DATE		REVISION
DESCRIPTION	BY	APPROVED	DATE	FILED
PLN NAME	DATE	CDM		DESIGN ENG
12/20/05				CONTRACT CERT
				238-161
				LAURENT COOK
AS-BUILT				
CONTRACTOR		DATE STARTED		33811-
INSPECTOR		DATE COMPLETED		



Every reasonable effort has been made to assure the accuracy of this map. However, neither the RUCS participants nor San Diego Data Processing Corporation assume any liability arising from its use.

**THIS MAP IS PROVIDED WITHOUT WARRANTY OF ANY KIND, EITHER EXPRESS OR IMPLIED, INCLUDING BUT NOT LIMITED TO, THE IMPLIED WARRANTIES OF MERCHANTABILITY AND FITNESS FOR A PARTICULAR PURPOSE.**

**PROPRIETARY INFORMATION:** The use of this information is pursuant to sublicense agreement only. Any resale or retransmission of this information is prohibited, except in accordance with such sublicense agreements.

# EXHIBIT F

301416



# K STREET PHASE II (26TH STREET TO 30TH STREET) UNDERGROUND UTILITY DISTRICT



ENGINEERING & CAPITAL PROJECTS

### LEGEND

- PROJECT BOUNDARY
- PARCELS
- PROPOSED STREET LIGHTS
- 123456 ASSESSOR'S BOOK & PAGE NO.
- 5 ASSESSOR'S PARCEL NO.
- 1234 ADDRESS

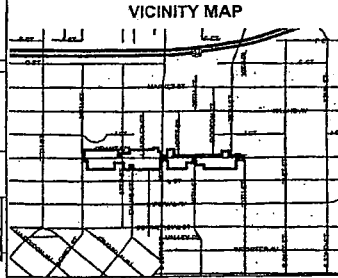
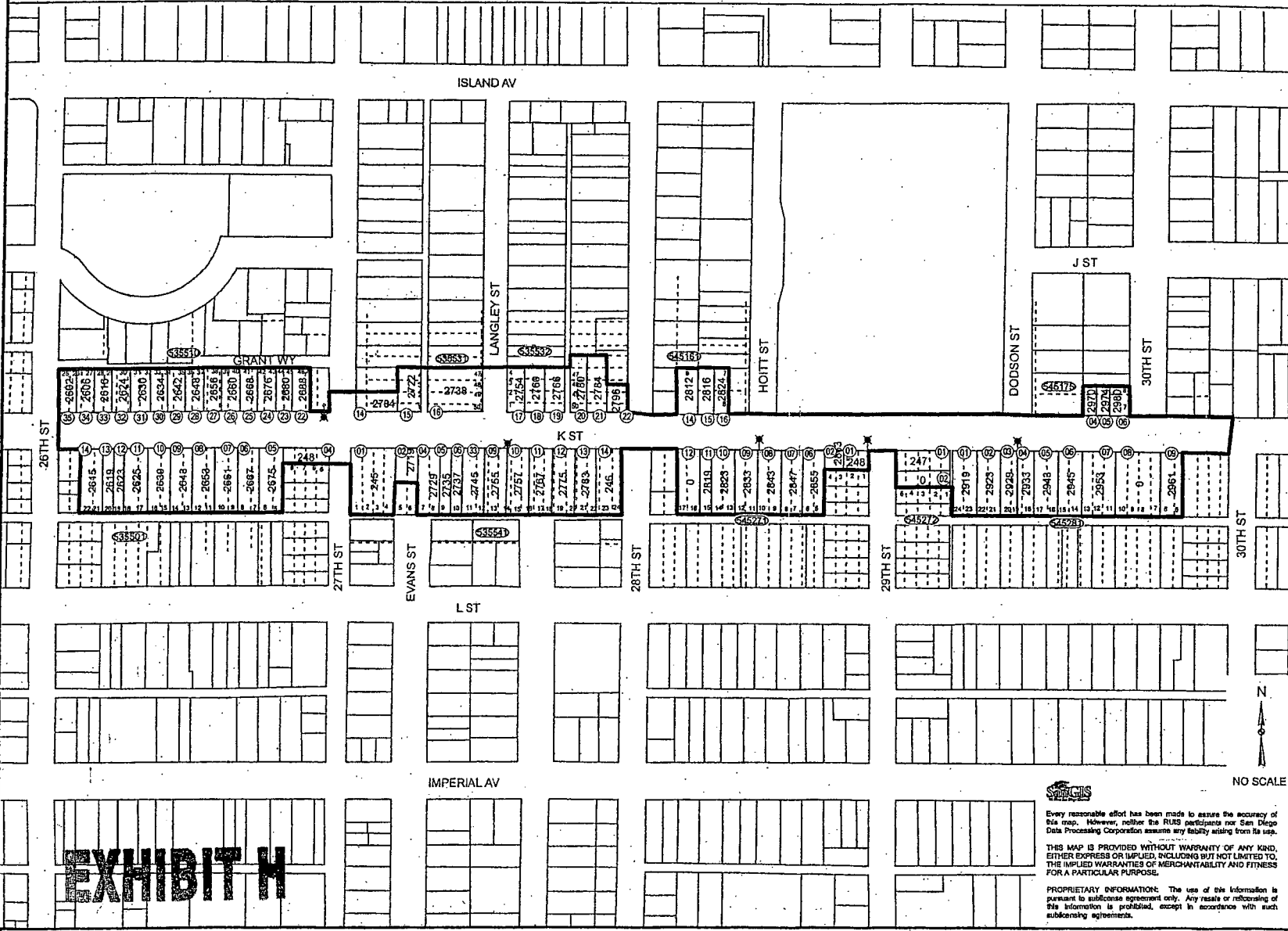

### K STREET PHASE II (26<sup>TH</sup> STREET TO 30<sup>TH</sup> STREET) UNDERGROUND UTILITY DISTRICT

CITY OF SAN DIEGO, CALIFORNIA  
ENGINEERING AND CAPITAL PROJECTS DEPARTMENT  
SHEET 1 OF 3 (SHEET)

DESIGN CITY ENGINEER		DATE		DESIGNER
DESCRIPTION	BY	APPROVED	DATE	FILED
DATE: 12/29/05	BY: CDM			
DESIGN ENGINEER				CONTROL CENTER
AS BUILT				TARGET DATE
CONTRACTOR	DATE STARTED	DATE COMPLETED		33817-2



Every reasonable effort has been made to ensure the accuracy of this map. However, neither the RUS participants nor San Diego Data Processing Corporation assume any liability arising from its use.

THIS MAP IS PROVIDED WITHOUT WARRANTY OF ANY KIND, EITHER EXPRESS OR IMPLIED, INCLUDING BUT NOT LIMITED TO, THE IMPLIED WARRANTIES OF MERCHANTABILITY AND FITNESS FOR A PARTICULAR PURPOSE.

PROPRIETARY INFORMATION: The use of this information is pursuant to sublicense agreement only. Any resale or retransferring of this information is prohibited, except in accordance with such sublicensing agreements.

NO SCALE

# EXHIBIT N

2-301416

MAY 02 2006

Passed by the Council of The City of San Diego on \_\_\_\_\_, by the following vote:

Council Members	Yeas	Nays	Not Present	Ineligible
Scott Peters	<input type="checkbox"/>	<input type="checkbox"/>	<input checked="" type="checkbox"/>	<input type="checkbox"/>
Kevin Faulconer	<input checked="" type="checkbox"/>	<input type="checkbox"/>	<input type="checkbox"/>	<input type="checkbox"/>
Toni Atkins	<input checked="" type="checkbox"/>	<input type="checkbox"/>	<input type="checkbox"/>	<input type="checkbox"/>
Anthony Young	<input checked="" type="checkbox"/>	<input type="checkbox"/>	<input type="checkbox"/>	<input type="checkbox"/>
Brian Maienschein	<input checked="" type="checkbox"/>	<input type="checkbox"/>	<input type="checkbox"/>	<input type="checkbox"/>
Donna Frye	<input checked="" type="checkbox"/>	<input type="checkbox"/>	<input type="checkbox"/>	<input type="checkbox"/>
Jim Madaffer	<input checked="" type="checkbox"/>	<input type="checkbox"/>	<input type="checkbox"/>	<input type="checkbox"/>
Ben Hueso	<input checked="" type="checkbox"/>	<input type="checkbox"/>	<input type="checkbox"/>	<input type="checkbox"/>

Date of final passage MAY 08 2006

AUTHENTICATED BY:

JERRY SANDERS  
Mayor of The City of San Diego, California.

(Seal)

ELIZABETH S. MALAND  
City Clerk of The City of San Diego, California.

By *Mary Cepeda*, Deputy

Office of the City Clerk, San Diego, California

Resolution Number R-301416