

RESOLUTION NUMBER R- 303776

DATE OF FINAL PASSAGE MAY 30 2008

RESOLUTION CALLING A PUBLIC HEARING TO DETERMINE WHETHER THE PUBLIC HEALTH, SAFETY OR GENERAL WELFARE REQUIRES THE FORMATION OF RESIDENTIAL PROJECT BLOCK 61 (BAY HO) SURCHARGE FUNDED UNDERGROUND UTILITY DISTRICT.

WHEREAS, Chapter VI, Article 1, Division 5 of the San Diego Municipal Code establishes a procedure for the creation of underground utility districts and requires as an initial step in such procedure the holding of a public hearing to determine whether the public health, safety or general welfare requires removal of poles, overhead wires and associated structures and the underground installation of wires and facilities for supplying electric, communication, community antenna television or similar or associated service in any such district; and

WHEREAS, Council Policy 600-8, "Underground Conversion of Utility Lines by Utility Company" defines the Council Policy for undergrounding utilities; and

WHEREAS, in accordance with Chapter VI, Article 1, Division 5 of the San Diego Municipal Code and Council Policy 600-8, it has been recommended that the following underground utility district [District] be formed:

- Portion Lot 1239 of PUEBLO LANDS, Map No. 36.
- Lots 1995 through 2039, Lots 2041 through 2123 & Lots 2128 through 2166 of Map CLAIREMONT UNIT NO. 10, Subdivision Map No. 2929.
- Lot 2531, Lots 2534 through 2568, Lots 2571 through 2605, Lots 2607 through 2632, Lots 2636 through 2688, Lots 2690 through 2705, Lots 2718 through 2726, Lots 2770 through 2772, Lots 2800 & 2801 & Lots 2835 through 2853 of Map CLAIREMONT UNIT NO. 12, Subdivision Map No. 2954.
- Portion Parcel 1 & Parcel 2 of Parcel Map 16201.

- Lots 3100 through 3108, portion Lot 3109, Lots 3074 through 3082, portion Lot 3083 of Map WEST CLAIREMONT UNIT NO. 1, Subdivision Map No. 3008.
- Lots 40 through 52, Lots 55 through 60 & Lots 68 through 83 of Map WEST CLAIREMONT UNIT NO. 1, Subdivision Map No. 5111.
- Lots 1 & 2 of Map RICE SUBDIVISION UNIT NO. 1, Subdivision Map No. 5720.
- Lot 1 of Map VIEW TERRACE, Subdivision Map No. 7054.
- Lots 1 through 4, portion Lot 5 & Lot 6 of Map STONEHAVEN, Subdivision Map No. 8387.
- Lots 5 & 6 of Map MORENA INDUSTRIAL CENTER, Subdivision Map No. 9707.
- Lots 1 through 3 of Map CANYON RIM, Subdivision Map No. 9223.

Said district shall also include the following public rights of way:

- JEMEZ DRIVE from its intersection with Hidalgo Ave. to its intersection with Pocahontas Ave.
- IDLEWILD WAY from its intersection with Hidalgo Ave. southeasterly to a line extending from the southeasterly corner of 3382 Idlewild Way and the northeasterly corner of 3383 Idlewild Way.
- HIDAS AVENUE from its intersection with Isleta Ave. southeasterly to its intersection with Jutland Dr.
- GUILITTOY AVENUE from its intersection with Isleta Ave. southeasterly to its intersection with Jutland Dr.
- GUILITTOY COURT
- HIDALGO AVENUE from a line +/- 100 feet south of Luna Ave. to its end at 4502 Hidalgo Ave.
- FAWN AVENUE
- JUTLAND PLACE
- ATWELL STREET
- ARCOLA AVENUE
- CAMINO CORALINO
- ISLETA AVENUE
- JUTLAND DRIVE from its intersection with Camino Coralino to a line extending Southeasterly from the Southwesterly corner of 4370 Jutland Dr.

- ARIANE DRIVE between a line extending southeasterly from the southeasterly corner of 2770 Ariane Dr. to a line extending southerly from the southerly corner of 2706 Ariane Dr.
- CLAIREMONT MESA BOULEVARD from its intersection with Luna Ave. easterly to a line +/- 165 feet westerly of Clairemont Dr.
- ALLEY south of Idlewild Way and north of Karok Ave. from Idlewild Way to its end at 4621 Jutland Dr.
- MORAGA AVENUE from its intersection with the Alley North of Clairemont Mesa Blvd. to a line +/- 100 feet north of Idlewild Way.
- ALLEY north of Jemez Dr. and south of Clairemont Mesa Blvd. from its intersection with Jutland Dr. east to its intersection with Moraga Ave.
- ALLEY north of Jemez Dr. and south of Clairemont Mesa Blvd. from its intersection with Moraga Ave. east to its intersection with Pocahontas Ave.
- KAROK AVENUE from its intersection with Idlewild Way to a line +/- 75 feet south of Idlewild Way.
- LA JUNTA AVENUE from its intersection with Idlewild Way to a line +/- 92 feet south of Idlewild Way.
- LUNA AVENUE from a line +/- 85 feet west of Jutland Dr. to a line +/- 20 feet east of Clairemont Mesa Blvd.
- POCAHONTAS AVENUE from its intersection with the Alley north of Clairemont Mesa Blvd. south to its intersection with the Alley north of Jemez Dr.

WHEREAS, Exhibit Attachment DISTRICT 6 BLOCK 61 UNDERGROUND UTILITY DISTRICT (Sheets 1 through 3), Map, and Exhibit Attachment GENERAL BOUNDRY DESCRIPTION FOR THE DISTRICT 6 BLOCK 61 UNDERGROUND UTILITY DISTRICT (Pages 1 through 3), Legal Description, depicts the above District with greater specificity; NOW, THEREFORE,

BE IT RESOLVED, by the Council of the City of San Diego, as follows:

1. Notice is hereby given that a public hearing will be held by the Council of the City of San Diego on JUN 17 2008, at the hour of 2.00 p.m in the Council Chambers of the City Administration Building, 202 C Street, San Diego, California, to determine

whether the public health, safety or general welfare requires the removal of poles, overhead wires and associated overhead structures and the underground installation of wires and facilities for supplying electric, communication, community antenna television or similar or associated service in the District described above.

2. At such hearing all persons interested shall be given an opportunity to be heard and said hearing may be continued from time to time as may be determined by the City Council. The decision of the City Council as to the formation of the District as described above shall be final and conclusive.

3. The City Clerk shall notify all affected persons as defined in Chapter VI, Article 1, Division 5 of the San Diego Municipal Code and each utility company concerned of the time and place of the hearing by following the procedure set forth in Chapter VI, Article 1, Division 5 of the San Diego Municipal Code.

BE IT FURTHER RESOLVED, that this activity is categorically exempt from CEQA Guidelines Section 15302(d), and Public Utilities Commission General Order 131-D dated August 11, 1995.

APPROVED: MICHAEL J. AGUIRRE, City Attorney

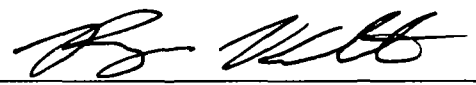
By 
Ryan Kohut
Deputy City Attorney

RK:cfq
04/16/08
Or.Dept:E&CP
R-2008-948

I hereby certify that the foregoing Resolution was passed by the Council of the City of San Diego, at this meeting of MAY 27 2008.

ELIZABETH S. MALAND
City Clerk

By *Aara Richardson*
Deputy City Clerk

Approved: 5-30-08
(date)

JSL
JERRY SANDERS, Mayor

Vetoed: _____
(date)

JERRY SANDERS, Mayor

**GENERAL BOUNDARY DESCRIPTION FOR THE DISTRICT 6
BLOCK 6I UNDERGROUND UTILITY DISTRICT**

The DISTRICT 6 BLOCK 6I UNDERGROUND UTILITY DISTRICT shall be established to include the following described parcels:

Portion Lot 1239 of PUEBLO LANDS, Map No. 36.

Lots 1995 through 2039, Lots 2041 through 2123 & Lots 2128 through 2166 of Map CLAIREMONT UNIT NO. 10, Subdivision Map No. 2929.

Lot 2531, Lots 2534 through 2568, Lots 2571 through 2605, Lots 2607 through 2632, Lots 2636 through 2688, Lots 2690 through 2705, Lots 2718 through 2726, Lots 2770 through 2772, Lots 2800 & 2801 & Lots 2835 through 2853 of Map CLAIREMONT UNIT NO. 12, Subdivision Map No. 2954.

Portion Parcel 1 & Parcel 2 of Parcel Map 16201.

Lots 3100 through 3108, portion Lot 3109, Lots 3074 through 3082, portion Lot 3083 of Map WEST CLAIREMONT UNIT NO. 1, Subdivision Map No. 3008.

Lots 40 through 52, Lots 55 through 60 & Lots 68 through 83 of Map WEST CLAIREMONT UNIT NO. 1, Subdivision Map No. 5111.

Lots 1 & 2 of Map RICE SUBDIVISION UNIT NO. 1, Subdivision Map No. 5720.

Lot 1 of Map VIEW TERRACE, Subdivision Map No. 7054.

Lots 1 through 4, portion Lot 5 & Lot 6 of Map STONEHAVEN, Subdivision Map No. 8387.

Lots 5 & 6 of Map MORENA INDUSTRIAL CENTER, Subdivision Map No. 9707.

Lots 1 through 3 of Map CANYON RIM, Subdivision Map No. 9223.

R- 303776

Said district shall also include the following public rights of way:

JEMEZ DRIVE from its intersection with Hidalgo Ave. to its intersection with Pocahontas Ave.

IDLEWILD WAY from its intersection with Hidalgo Ave. southeasterly to a line extending from the southeasterly corner of 3382 Idlewild Way and the northeasterly corner of 3383 Idlewild Way.

HIDAS AVENUE from its intersection with Isleta Ave. southeasterly to its intersection with Jutland Dr.

GUILTOY AVENUE from its intersection with Isleta Ave. southeasterly to its intersection with Jutland Dr.

GUILTOY COURT

HIDALGO AVENUE from a line +/- 100 feet south of Luna Ave. to its end at 4502 Hidalgo Ave.

FAWN AVENUE

JUTLAND PLACE

ATWELL STREET

ARCOLA AVENUE

CAMINO CORALINO

ISLETA AVENUE

JUTLAND DRIVE from its intersection with Camino Coralino to a line extending Southeasterly from the Southwesterly corner of 4370 Jutland Dr.

ARIANE DRIVE between a line extending southeasterly from the southeasterly corner of 2770 Ariane Dr. to a line extending southerly from the southerly corner of 2706 Ariane Dr.

CLAIREMONT MESA BOULEVARD from its intersection with Luna Ave. easterly to a line +/- 165 feet westerly of Clairemont Dr.

ALLEY south of Idlewild Way and north of Karok Ave. from Idlewild Way to its end at 4621 Jutland Dr.

R- 303776

MORAGA AVENUE from its intersection with the Alley North of Clairemont Mesa Blvd. to a line +/- 100 feet north of Idlewild Way.

ALLEY north of Jemez Dr. and south of Clairemont Mesa Blvd. from its intersection with Jutland Dr. east to its intersection with Moraga Ave.

ALLEY north of Jemez Dr. and south of Clairemont Mesa Blvd. from its intersection with Moraga Ave. east to its intersection with Pocahontas Ave.

KAROK AVENUE from its intersection with Idlewild Way to a line +/- 75 feet south of Idlewild Way.

LA JUNTA AVENUE from its intersection with Idlewild Way to a line +/- 92 feet south of Idlewild Way.

LUNA AVENUE from a line +/- 85 feet west of Jutland Dr. to a line +/- 20 feet east of Clairemont Mesa Blvd.

POCAHONTAS AVENUE from its intersection with the Alley north of Clairemont Mesa Blvd. south to its intersection with the Alley north of Jemez Dr.

R- 303776

DISTRICT 6 BLOCK 6 I UNDERGROUND UTILITY DISTRICT



ENGINEERING & CAPITAL PROJECTS

LEGEND

- PROJECT BOUNDARY
- PARCELS
- PROPOSED STREET LIGHTS
- JUTLAND DR PROJECT
- PREVIOUSLY UNDERGROUNDED UTILITY DISTRICT
- 125468 ASSESSOR'S BOOK & PAGE NO
- 1 ASSESSOR'S PARCEL NO
- 1224** ADDRESS

VICINITY MAP



DISTRICT 6 BLOCK 6I UNDERGROUND UTILITY DISTRICT

CITY OF SAN DIEGO CALIFORNIA ENGINEERING AND CAPITAL PROJECTS DEPARTMENT SHEET 1 OF 3 SHEETS					WO NO. 373104
SHEET NO.	OF	SHEETS	DATE	FILED	REVISIONS
1	1	1	1/15/10	1001208	SUBMITTALS
					CONTROL DRAWING
					242-1704 LATEST EDITIONS
SHEET TITLE					33906-1-D
CONTRACTOR					DATE STARTED
INSPECTOR					DATE COMPLETED

SDGPH
San Diego Gas & Electric

Every reasonable effort has been made to insure the accuracy of this map. However, neither the RUS professionals nor San Diego Data Processing Corporation assume any liability arising from its use.

THIS MAP IS PROVIDED WITHOUT WARRANTY OF ANY KIND EITHER EXPRESS OR IMPLIED INCLUDING BUT NOT LIMITED TO, THE IMPLIED WARRANTIES OF MERCHANTABILITY AND FITNESS FOR A PARTICULAR PURPOSE.

PROPRIETARY INFORMATION: The use of this information is permitted in subsequent agreement only. Any resale or retransmission of this information is prohibited, except in accordance with such subsequent agreement.



R-303776

DISTRICT 6 BLOCK 6I UNDERGROUND UTILITY DISTRICT

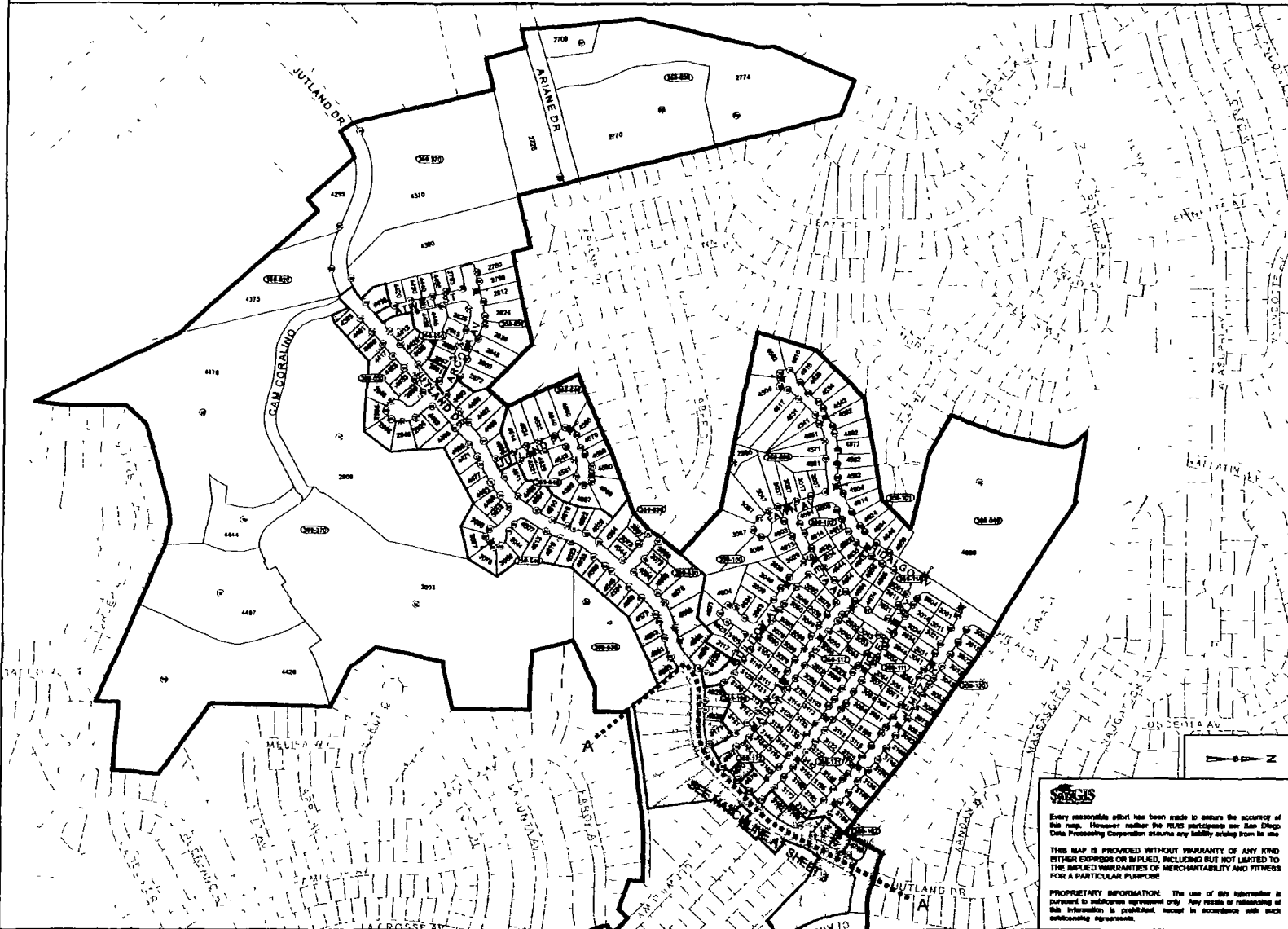

LEGEND

- PROJECT BOUNDARY
- PARCELS
- PROPOSED STREET LIGHTS
- JUTLAND DR PROJECT
- PREVIOUSLY UNDERGROUNDED UTILITY DISTRICT
- 123456 ASSESSOR'S BOOK & PAGE NO
- 6 ASSESSOR'S PARCEL NO
- 1234 ADDRESS

VICINITY MAP



DISTRICT 6 BLOCK 6I UNDERGROUND UTILITY DISTRICT

CITY OF SAN DIEGO CALIFORNIA ENGINEERING AND CAPITAL PROJECTS DEPARTMENT SHEET 1 OF 3 SHEETS					W/D NO. 373105
FOR CITY REVIEW					
REVISION	BY	APPROVED	DATE	FIELD	REVISION
10/22	SJS 09/15/05	AMS			SECTION EIGHTH
					CONTROL CENTER PLAN
					242-1704 UTILITY OCCUPANCY
DATE STARTED	DATE COMPLETED				
		33808-2-D			

CAUTION

Every reasonable effort has been made to ensure the accuracy of this map. However, neither the RUS participants nor San Diego Data Processing Corporation assume any liability arising from its use.

THIS MAP IS PROVIDED WITHOUT WARRANTY OF ANY KIND EITHER EXPRESS OR IMPLIED, INCLUDING BUT NOT LIMITED TO THE IMPLIED WARRANTIES OF MERCHANTABILITY AND FITNESS FOR A PARTICULAR PURPOSE.

PROPRIETARY INFORMATION: The use of this information is pursuant to a subscription agreement only. Any resale or retransmission of this information is prohibited, except in accordance with such subscription agreements.

R 303776

DISTRICT 6 BLOCK 6 I UNDERGROUND UTILITY DISTRICT



ENGINEERING & CAPITAL PROJECTS

LEGEND

- PROJECT BOUNDARY
- PARCELS
- PROPOSED STREET LIGHTS
- JUTLAND DR PROJECT
- PREVIOUSLY UNDERGROUNDED UTILITY DISTRICT
- 12345 ASSESSOR'S BOOK & PAGE NO
- 6 ASSESSOR'S PARCEL NO
- 1234** ADDRESS

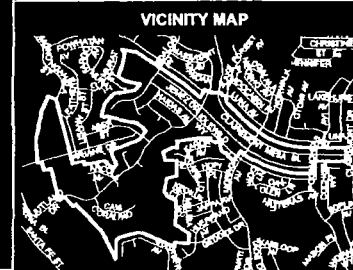

DISTRICT 6 BLOCK 6I UNDERGROUND UTILITY DISTRICT

CITY OF SAN DIEGO CALIFORNIA <small>ENGINEERING AND CAPITAL PROJECTS</small>		PROJECT NO.	373105
DATE	BY	APPROVED	DATE
12/15/2011	AMS		
COSTS ESTIMATED			242-1704
COSTS ESTIMATED			UNBID COST ESTIMATE
33806-3-D			

SEGIS

Every reasonable effort has been made to ensure the accuracy of this map. However, neither the RIBS participants nor San Diego Data Processing Corporation assume any liability arising from its use.

THIS MAP IS PROVIDED WITHOUT WARRANTY OF ANY KIND, EITHER EXPRESS OR IMPLIED, INCLUDING BUT NOT LIMITED TO, THE IMPLIED WARRANTIES OF MERCHANTABILITY AND FITNESS FOR A PARTICULAR PURPOSE.

PROPRIETARY INFORMATION: The use of this information is pursuant to a subscription agreement only. Any resale or retransmission of this information is prohibited, except in accordance with such subscription agreements.

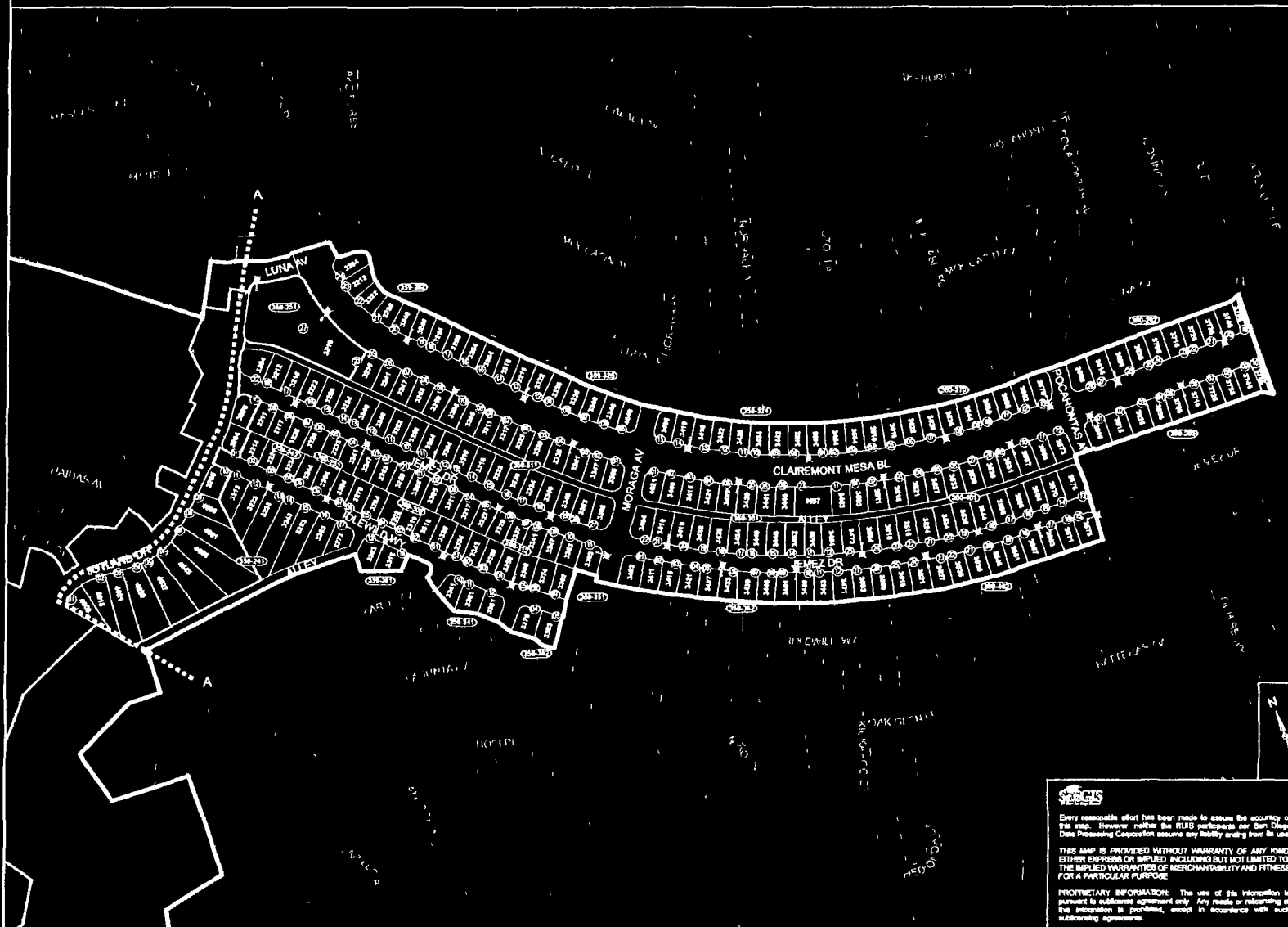

R. 303776