

RESOLUTION NUMBER R- 303861

DATE OF FINAL PASSAGE JUN 24 2008

A RESOLUTION ESTABLISHING AN UNDERGROUND UTILITY DISTRICT FOR RESIDENTIAL PROJECT BLOCK 61 (BAY HO) FINANCED THROUGH THE CITY OF SAN DIEGO UNDERGROUNDING SURCHARGE FUND.

WHEREAS, by Resolution No. R- 303776, a public hearing was called for on JUN 17, 2008, at the hour of 2:00 p.m. in the Council Chambers of the City Administration Building, 202 C Street, San Diego, California, to determine whether the public health, safety, or general welfare requires the removal of poles, overhead wires, and associated structures and the underground installation of wires and facilities for supplying electric, communication, community antenna television or similar or associated service within certain areas of the City of San Diego more particularly described as follows [the District]:

- Portion Lot 1239 of PUEBLO LANDS, Map No. 36.
- Lots 1995 through 2039, Lots 2041 through 2123 & Lots 2128 through 2166 of Map CLAIREMONT UNIT NO. 10, Subdivision Map No. 2929.
- Lot 2531, Lots 2534 through 2568, Lots 2571 through 2605, Lots 2607 through 2632, Lots 2636 through 2688, Lots 2690 through 2705, Lots 2718 through 2726, Lots 2770 through 2772, Lots 2800 & 2801 & Lots 2835 through 2853 of Map CLAIREMONT UNIT NO. 12, Subdivision Map No. 2954.
- Portion Parcel 1 & Parcel 2 of Parcel Map 16201.
- Lots 3100 through 3108, portion Lot 3109, Lots 3074 through 3082, portion Lot 3083 of Map WEST CLAIREMONT UNIT NO. 1, Subdivision Map No. 3008.
- Lots 40 through 52, Lots 55 through 60 & Lots 68 through 83 of Map WEST CLAIREMONT UNIT NO. 1, Subdivision Map No. 5111.
- Lots 1 & 2 of Map RICE SUBDIVISION UNIT NO. 1, Subdivision Map No. 5720.
- Lot 1 of Map VIEW TERRACE, Subdivision Map No. 7054.
- Lots 1 through 4, portion Lot 5 & Lot 6 of Map STONEHAVEN, Subdivision Map No. 8387.

- Lots 5 & 6 of Map MORENA INDUSTRIAL CENTER, Subdivision Map No. 9707.
- Lots 1 through 3 of Map CANYON RIM, Subdivision Map No. 9223.

Said district shall also include the following public rights of way:

- JEMEZ DRIVE from its intersection with Hidalgo Ave. to its intersection with Pocahontas Ave.
- IDLEWILD WAY from its intersection with Hidalgo Ave. southeasterly to a line extending from the southeasterly corner of 3382 Idlewild Way and the northeasterly corner of 3383 Idlewild Way.
- HIDAS AVENUE from its intersection with Isleta Ave. southeasterly to its intersection with Jutland Dr.
- GUILITTOY AVENUE from its intersection with Isleta Ave. southeasterly to its intersection with Jutland Dr.
- GUILITTOY COURT
- HIDALGO AVENUE from a line +/- 100 feet south of Luna Ave. to its end at 4502 Hidalgo Ave.
- FAWN AVENUE
- JUTLAND PLACE
- ATWELL STREET
- ARCOLA AVENUE
- CAMINO CORALINO
- ISLETA AVENUE
- JUTLAND DRIVE from its intersection with Camino Coralino to a line extending Southeasterly from the Southwesterly corner of 4370 Jutland Dr.
- ARIANE DRIVE between a line extending southeasterly from the southeasterly corner of 2770 Ariane Dr. to a line extending southerly from the southerly corner of 2706 Ariane Dr.
- CLAIREMONT MESA BOULEVARD from its intersection with Luna Ave. easterly to a line +/- 165 feet westerly of Clairemont Dr.
- ALLEY south of Idlewild Way and north of Karok Ave. from Idlewild Way to its end at 4621 Jutland Dr.
- MORAGA AVENUE from its intersection with the Alley North of Clairemont Mesa Blvd. to a line +/- 100 feet north of Idlewild Way.
- ALLEY north of Jemez Dr. and south of Clairemont Mesa Blvd. from its intersection with Jutland Dr. east to its intersection with Moraga Ave.

- ALLEY north of Jemez Dr. and south of Clairemont Mesa Blvd. from its intersection with Moraga Ave. east to its intersection with Pocahontas Ave.
- KAROK AVENUE from its intersection with Idlewild Way to a line +/- 75 feet south of Idlewild Way.
- LA JUNTA AVENUE from its intersection with Idlewild Way to a line +/- 92 feet south of Idlewild Way.
- LUNA AVENUE from a line +/- 85 feet west of Jutland Dr. to a line +/- 20 feet east of Clairemont Mesa Blvd.
- POCAHONTAS AVENUE from its intersection with the Alley north of Clairemont Mesa Blvd. south to its intersection with the Alley north of Jemez Dr.

WHEREAS, Exhibit Attachment DISTRICT 6 BLOCK 61 UNDERGROUND UTILITY DISTRICT (Sheets 1 through 3), Map, and Exhibit Attachment GENERAL BOUNDRY DESCRIPTION FOR THE DISTRICT 6 BLOCK 61 UNDERGROUND UTILITY DISTRICT (Pages 1 through 3), Legal Description, depicts the above District with greater specificity; and

WHEREAS, notice of such hearing has been given by the Mayor to all affected property owners as defined in Chapter VI, Article One, Division Five of the San Diego Municipal Code, and the utilities concerned in the manner and for the time required by law; and

WHEREAS, such hearing has been duly and regularly held and all persons interested have been given an opportunity to be heard; NOW, THEREFORE,

BE IT RESOLVED, by the Council of the City of San Diego, as follows:

1. The City Council hereby finds and determines that the public health, safety, or general welfare requires the removal of poles, overhead wires, and associated overhead structures and the underground installation of wires and facilities for supplying electric, communication, community antenna television or similar or associated service within the areas set forth above and that pursuant to Chapter VI, Article One, Division Five of the San Diego Municipal Code, the above areas are hereby declared to be underground utility districts in the

City of San Diego, and the maps and document referred to above are hereby incorporated as a part of this resolution.

2. The Mayor is hereby authorized to establish schedules for the underground conversion of all poles, overhead wires, and associated structures in said District.

3. The Mayor is hereby instructed to notify all affected persons as defined in Chapter VI, Article One, Division Five of the San Diego Municipal Code, and all affected utility companies of the adoption of this resolution within fifteen days after date of adoption. The Mayor shall further notify affected persons as defined in Chapter VI, Article One, Division Five of the San Diego Municipal Code of the necessity that if they desire to continue to receive electric, communication, community antenna television or similar or associated service, they shall permit the installation of all necessary facility changes on their premises, or provide such changes at their own expense, so as to receive underground service from the lines relocated underground of the supplying utility company subject to applicable rules, regulations, and tariffs of the respective utility company on file with the Public Utilities Commission of the State of California (as of the date of the adoption of this resolution) and subject to all other applicable requirements of State law and City ordinances. The Mayor's notification shall be in the manner provided in Chapter VI, Article One, Division Five of the San Diego Municipal Code.

BE IT FURTHER RESOLVED, that this activity is categorically exempt from CEQA Guidelines Section 15302(d), and Public Utilities Commission General Order 131-D dated August 11, 1995.

APPROVED: MICHAEL J. AGUIRRE, City Attorney

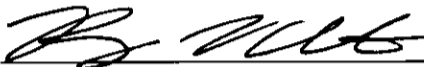
By 
Ryan Kohut
Deputy City Attorney

RK:cfq
04/16/08
Or.Dept:E&CP
R-2008-947

I hereby certify that the foregoing Resolution was passed by the Council of the City of San Diego, at this meeting of JUN 17 2008.

ELIZABETH S. MALAND
City Clerk

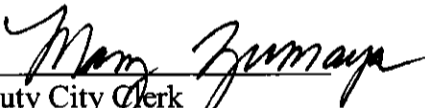
By 
Deputy City Clerk

Approved: 6-24-08
(date)

JERRY SANDERS, Mayor

Vetoed: _____
(date)

JERRY SANDERS, Mayor

**GENERAL BOUNDARY DESCRIPTION FOR THE DISTRICT 6
BLOCK 6I UNDERGROUND UTILITY DISTRICT**

The DISTRICT 6 BLOCK 6I UNDERGROUND UTILITY DISTRICT shall be established to include the following described parcels:

Portion Lot 1239 of PUEBLO LANDS, Map No. 36.

Lots 1995 through 2039, Lots 2041 through 2123 & Lots 2128 through 2166 of Map CLAIREMONT UNIT NO. 10, Subdivision Map No. 2929.

Lot 2531, Lots 2534 through 2568, Lots 2571 through 2605, Lots 2607 through 2632, Lots 2636 through 2688, Lots 2690 through 2705, Lots 2718 through 2726, Lots 2770 through 2772, Lots 2800 & 2801 & Lots 2835 through 2853 of Map CLAIREMONT UNIT NO. 12, Subdivision Map No. 2954.

Portion Parcel 1 & Parcel 2 of Parcel Map 16201.

Lots 3100 through 3108, portion Lot 3109, Lots 3074 through 3082, portion Lot 3083 of Map WEST CLAIREMONT UNIT NO. 1, Subdivision Map No. 3008.

Lots 40 through 52, Lots 55 through 60 & Lots 68 through 83 of Map WEST CLAIREMONT UNIT NO. 1, Subdivision Map No. 5111.

Lots 1 & 2 of Map RICE SUBDIVISION UNIT NO. 1, Subdivision Map No. 5720.

Lot 1 of Map VIEW TERRACE, Subdivision Map No. 7054.

Lots 1 through 4, portion Lot 5 & Lot 6 of Map STONEHAVEN, Subdivision Map No. 8387.

Lots 5 & 6 of Map MORENA INDUSTRIAL CENTER, Subdivision Map No. 9707.

Lots 1 through 3 of Map CANYON RIM, Subdivision Map No. 9223.

R-303861

Said district shall also include the following public rights of way:

JEMEZ DRIVE from its intersection with Hidalgo Ave. to its intersection with Pocahontas Ave.

IDLEWILD WAY from its intersection with Hidalgo Ave. southeasterly to a line extending from the southeasterly corner of 3382 Idlewild Way and the northeasterly corner of 3383 Idlewild Way.

HIDAS AVENUE from its intersection with Isleta Ave. southeasterly to its intersection with Jutland Dr.

GUILTOY AVENUE from its intersection with Isleta Ave. southeasterly to its intersection with Jutland Dr.

GUILTOY COURT

HIDALGO AVENUE from a line +/- 100 feet south of Luna Ave. to its end at 4502 Hidalgo Ave.

FAWN AVENUE

JUTLAND PLACE

ATWELL STREET

ARCOLA AVENUE

CAMINO CORALINO

ISLETA AVENUE

JUTLAND DRIVE from its intersection with Camino Coralino to a line extending Southeasterly from the Southwesterly corner of 4370 Jutland Dr.

ARIANE DRIVE between a line extending southeasterly from the southeasterly corner of 2770 Ariane Dr. to a line extending southerly from the southerly corner of 2706 Ariane Dr.

CLAIREMONT MESA BOULEVARD from its intersection with Luna Ave. easterly to a line +/- 165 feet westerly of Clairemont Dr.

ALLEY south of Idlewild Way and north of Karok Ave. from Idlewild Way to its end at 4621 Jutland Dr.

R- 303861

MORAGA AVENUE from its intersection with the Alley North of Clairemont Mesa Blvd. to a line +/- 100 feet north of Idlewild Way.

ALLEY north of Jemez Dr. and south of Clairemont Mesa Blvd. from its intersection with Jutland Dr. east to its intersection with Moraga Ave.

ALLEY north of Jemez Dr. and south of Clairemont Mesa Blvd. from its intersection with Moraga Ave. east to its intersection with Pocahontas Ave.

KAROK AVENUE from its intersection with Idlewild Way to a line +/- 75 feet south of Idlewild Way.

LA JUNTA AVENUE from its intersection with Idlewild Way to a line +/- 92 feet south of Idlewild Way.

LUNA AVENUE from a line +/- 85 feet west of Jutland Dr. to a line +/- 20 feet east of Clairemont Mesa Blvd.

POCAHONTAS AVENUE from its intersection with the Alley north of Clairemont Mesa Blvd. south to its intersection with the Alley north of Jemez Dr.

R- 303861

DISTRICT 6 BLOCK 6 I UNDERGROUND UTILITY DISTRICT

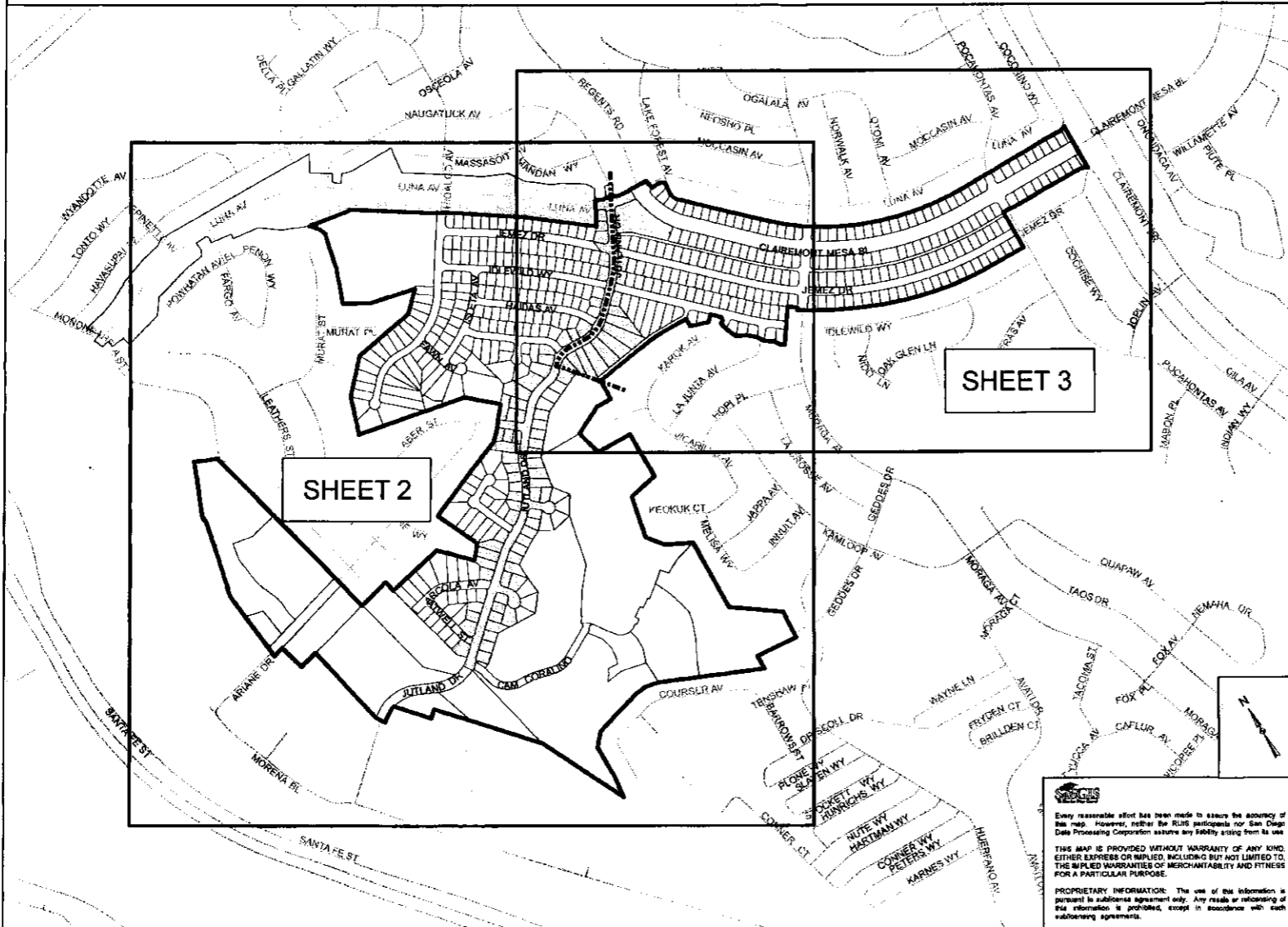

LEGEND

- PROJECT BOUNDARY
- PARCELS
- PROPOSED STREET LIGHTS
- JUTLAND DR PROJECT
- PREVIOUSLY UNDERGROUNDED UTILITY DISTRICT
- ASSESSOR'S BOOK & PAGE NO.
- ASSESSOR'S PARCEL NO.
- ADDRESS

VICINITY MAP



DISTRICT 6 BLOCK 6I UNDERGROUND UTILITY DISTRICT

CITY OF SAN DIEGO, CALIFORNIA ENGINEERING AND CAPITAL PROJECTS DEPARTMENT SHEET 1 OF 2 SHEETS		W/O NO. 373165
FOR CITY USE ONLY		DATE
DESCRIPTION	BY	APPROVED DATE FILED
DATE	DATE	
22/11/20	2/18	
CONTRACTOR'S NAME		242-1704 LAMBERT COORDINATOR
CONTRACTOR	DATE STARTED	33806-1-D
DIRECTION	DATE COMPLETED	

NOTES

Every reasonable effort has been made to ensure the accuracy of this map. However, neither the RLIS participants nor San Diego Data Processing Corporation assume any liability arising from its use.

THIS MAP IS PROVIDED WITHOUT WARRANTY OF ANY KIND, EITHER EXPRESS OR IMPLIED, INCLUDING BUT NOT LIMITED TO, THE IMPLIED WARRANTIES OF MERCHANTABILITY AND FITNESS FOR A PARTICULAR PURPOSE.

PROPRIETARY INFORMATION: The use of this information is pursuant to a subsurface agreement only. Any resale or retransmission of this information is prohibited, except in accordance with each subsurface agreement.

R 303861

DISTRICT 6 BLOCK 6 I UNDERGROUND UTILITY DISTRICT

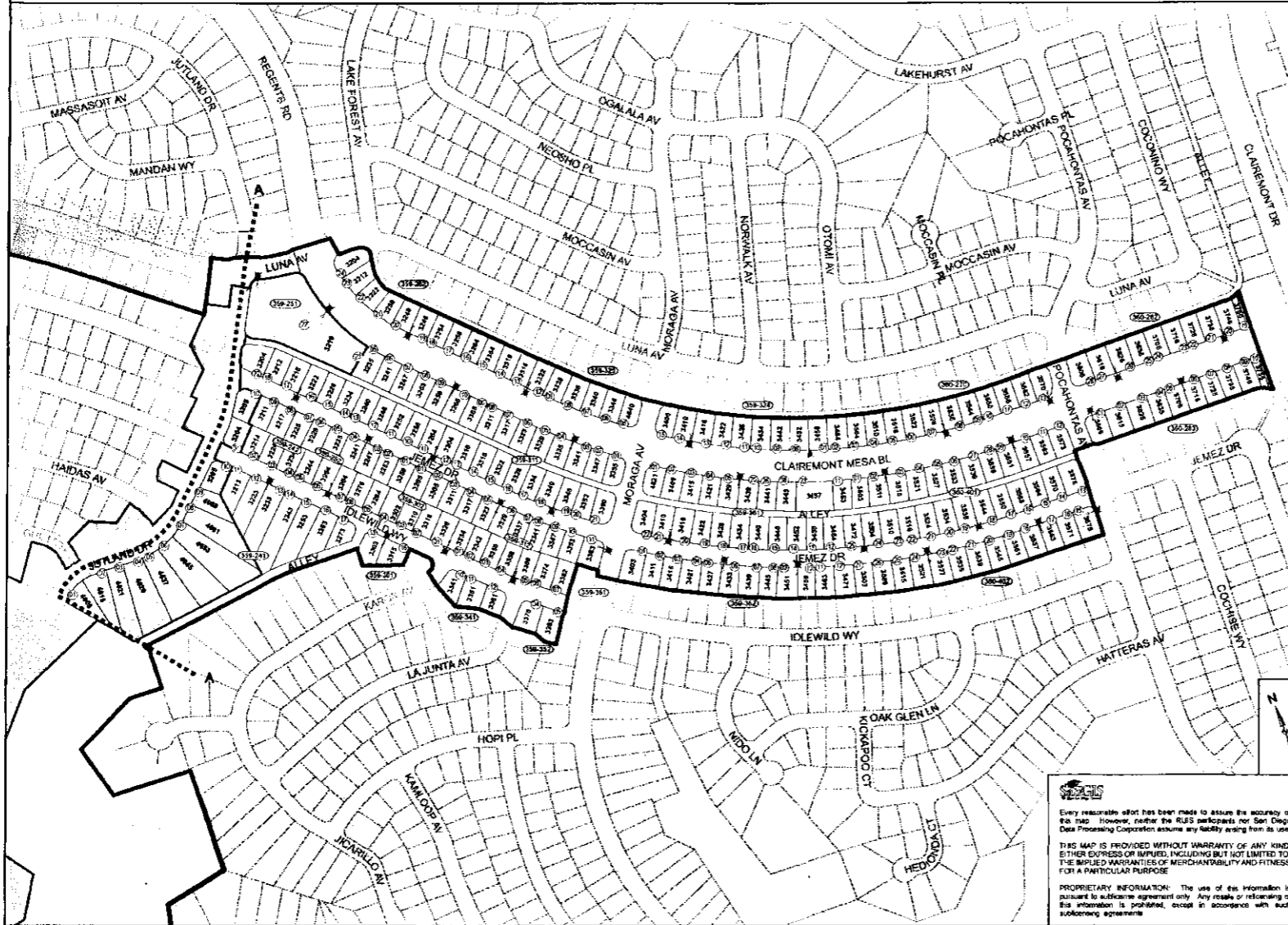

ENGINEERING & CAPITAL PROJECTS

LEGEND

- PROJECT BOUNDARY
- PARCELS
- PROPOSED STREET LIGHTS
- JUTLAND DR PROJECT
- PREVIOUSLY UNDERGROUNDED UTILITY DISTRICT
- 123456 ASSESSOR'S BOOK & PAGE NO.
- 5 ASSESSOR'S PARCEL NO.
- 1234 ADDRESS

VICINITY MAP

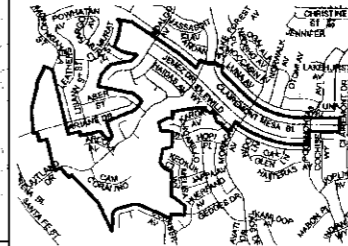

DISTRICT 6 BLOCK 6I UNDERGROUND UTILITY DISTRICT

CITY OF SAN DIEGO, CALIFORNIA ENGINEERING AND CAPITAL PROJECTS DEPARTMENT SHEET 1 OF 3 SHEETS				PROJECT NO. 373105	
FOR CITY'S USE ONLY	DATE	BY	APPROVED	DATE	PROJECT LEAD
DESCRIPTION					DESIGN ENGINEER
DATE	02-13-08	AMS			
					CONTRACT CERTIFICATION
					242-1704 COURTESY COORDINATOR
CONTRACT NO.					33806-3-D
DATE STARTED					DATE COMPLETED

Every reasonable effort has been made to assure the accuracy of this map. However, neither the RUS participants nor San Diego Data Processing Corporation assume any liability arising from its use.

THIS MAP IS PROVIDED WITHOUT WARRANTY OF ANY KIND, EITHER EXPRESS OR IMPLIED, INCLUDING BUT NOT LIMITED TO, THE IMPLIED WARRANTIES OF MERCHANTABILITY AND FITNESS FOR A PARTICULAR PURPOSE.

PROPRIETARY INFORMATION: The use of this information is pursuant to a license agreement only. Any resale or retransmission of this information is prohibited, except in accordance with such licensing agreements.

R 303861