

(A)
(R-2008-952)

339

6/17

RESOLUTION NUMBER R- 303863

DATE OF FINAL PASSAGE JUN 24 2008

A RESOLUTION ESTABLISHING AN UNDERGROUND UTILITY DISTRICT FOR RESIDENTIAL PROJECT BLOCK 2T (PACIFIC BEACH NORTH) FINANCED THROUGH THE CITY OF SAN DIEGO UNDERGROUNDING SURCHARGE FUND.

WHEREAS, by Resolution No. R- 303771, a public hearing was called for on JUN 17, 2008, at the hour of 2:00 p.m. in the Council Chambers of the City Administration Building, 202 C Street, San Diego, California, to determine whether the public health, safety, or general welfare requires the removal of poles, overhead wires, and associated structures and the underground installation of wires and facilities for supplying electric, communication, community antenna television or similar or associated service within certain areas of the City of San Diego more particularly described as follows [the District]:

- Portions Lots 1 & 2 of Map PUEBLO LOT 1783 PARTITION, Subdivision Map No. 839.
- Lots 1, 2 & 20 through 38 in Block 1; Lots 1 through 3, 37 & 38 in Block 2; Lots 17 through 33 in Block 3; Lots 33 through 48 in Block 4 of Map PACIFIC BEACH VISTA TRACT, Subdivision Map No. 916.
- Lots 4 through 12, portion Lots 29 & 30, Lots 31 through 37 in Block 9; Lots 4 through 12, portion 21, Lots 22 through 43 in Block 10; Lots 4 through 20 in Block 11; Lot 4 in Block 12; Lots 1 through 11 in Block 14 of Map MONTE VISTA TRACT, Subdivision Map No. 928.
- Lots 20 through 28, UNNUMBERED LOT, Lots 30 through 38 in Block 1; Lots 1 through 17, Lots 22 through 38 in Block 2; Lots 1 through 19 in Block 3; Northerly 50 feet of Lots 1 through 4, Lots 5 through 16, portion Lot 27, Lot 28 & the Southeasterly half of Lots 29 through 32 in Block 4; Lots 17 through 32 in Block 5 of Map BUENA VISTA TRACT, Subdivision Map No. 929.
- Portion Lots 32 & 33, Lots 65 through 90 in Block 3; portion Lot 33, Lots 65 through 77 in Block 4; Lots 78 & 79 in Block 5; Lots 75 through 80 in Block 6; Lots 1 through 4, portion Lots 37 through 40 in Block 9; Lots 1 through 4, Lots 37 through 40 in Block 10; Lots 1 through 4 in Block 11; Lots 1 through 4 in Block 12 of Map PACIFIC BEACH VISTA FIRST ADDITION, Subdivision Map No. 930.
- Parcels 1 & 2 of Parcel Map No. 10727

- Lots 16 through 18 in Block 22; portion Lots 13 through 15, Lot 16 & portion Lot 17 in Block 23; Lots 16 through 18 in Block 24; Lots 14 through 18 in Block 25; Lots 1 through 8 & portion Lot 9, & closed alley adjacent to & Southerly of said Lots 7 & 8 in Block 29; Lots 1 through 6 in Block 30; Lots 1 through 6 in Block 31; Lots 1 through 6 in Block 32; Lots 1 through 7 in Block 33 of Map BIRD ROCK ADDITION, Subdivision Map No. 1083.
- Parcel 2 of Parcel Map No. 18987.
- Lots 1 through 32 in Block 2; Lots 1 through 16 in Block 3 of Map SEA VIEW HEIGHTS, Subdivision Map No. 1125.
- Parcel 1 of Parcel Map No. 1641.
- Parcels 1 through 3 of Parcel Map No. 16941.
- Lots 1 through 13 of Map LA JOLLA VALLEY VISTA, Subdivision Map No. 3181.
- Lots 14 through 25 of Map LA JOLLA VALLEY VISTA UNIT NO. 2, Subdivision Map No. 3494.
- Lots 1& 2 of Map BELLEVUE TERRACE UNIT NO. 1, Subdivision Map No. 3593.
- Lots 6 through 11 of Map BELLEVUE TERRACE UNIT NO. 2, Subdivision Map No. 3675.
- Lots 1 through 36 of Map TRENTON TERRACE, Subdivision Map No. 4114.
- Lot 32 of Map LA JOLLA MESA VISTA NO. 2, Subdivision Map No. 4551.
- Lots 1 through 8 of Map HOLLY PACIFIC, Subdivision Map No. 4624.
- Lots 1 & 2 of Map MONARCH VIEWS, Subdivision Map No. 8776.
- Lots 124, 132 & the UNNAMED ALLEY between Lots 124 & 132 of Map LA JOLLA ALTA P.R.D. UNIT NO. 14 Subdivision Map No. 12900.

Said district shall also include the following public rights of way:

- VAN NUYS STREET
- VAN NUYS WAY
- VAN NUYS COURT
- VAN NUYS PLACE
- ARCHER STREET from its intersection with Cass St. to its intersection with Cardeno Dr. & from its intersection with La Jolla Mesa Dr. to the Alley west of La Jolla Mesa Dr.
- EVERT STREET from its intersection with Van Nuys St. to its intersection with Archer St.
- DAWES STREET between a line from the southeastern corner of 5284 Dawes St. & the southwestern corner of 5275 Dawes St. to its intersection with Archer St.

- CASS STREET from its intersection with Turquoise St. to its intersection with the Alley north of Van Nuys St.
- CANDLELIGHT DRIVE from its intersection with Van Nuys St. Northerly to its intersection with Candlelight Pl.
- CANDLELIGHT PLACE
- BELLEVUE PLACE
- ALLEY North of Van Nuys St. and South of Bellevue Pl. and Candlelight Pl. from its intersection with Cass St. west to its end at 704 Van Nuys St.
- ALLEY North of Archer St. and South of Van Nuys St. East from its intersection with Cass St. to 1142 Archer St. & from its intersection with La Jolla Mesa Dr. East to 704 Archer St.
- ALLEY South of Colima St. from its intersection with Bellevue Ave. west to its intersection with La Jolla Blvd.
- ALLEY East of La Jolla Mesa Dr. and west of La Jolla Hermosa from its intersection with Van Nuys St. south to Turquoise St.
- ALLEY South of Colima St. from its intersection with Van Nuys St. west to its intersection with La Jolla Hermosa Ave.
- BELLEVUE AVENUE from its intersection with Colima St. Northerly to its intersection with Bellevue Pl.
- BEAUMONT AVENUE from its intersection with Colima St. Southerly to the Alley South of Colima St.
- WAVERLY AVENUE from its intersection with Colima St. Southerly to the Alley South of Colima St.
- LA JOLLA BOULEVARD its intersection with Colima St. Southerly to its intersection with La Jolla Hermosa Ave.
- TURQUOISE STREET from its intersection with La Jolla Hermosa Ave. Easterly to the Alley east of La Jolla Hermosa Ave.
- COLIMA STREET from its intersection with La Jolla Blvd. Easterly to its intersection with La Jolla Mesa Dr.
- LA JOLLA MESA DRIVE from its intersection with Colima St. Southerly to its intersection with Turquoise St.
- LA JOLLA HERMOSA AVENUE from its intersection with Colima St. Southerly to its intersection with La Jolla Blvd.

WHEREAS, Exhibit Attachment DISTRICT 2 BLOCK 2T UNDERGROUND UTILITY

DISTRICT (Sheets 1 through 3), Map, and Exhibit Attachment GENERAL BOUNDRY

DESCRIPTION FOR THE DISTRICT 2 BLOCK 2T UNDERGROUND UTILITY DISTRICT
(Pages 1 to 4), Legal Description, depicts the above District with greater specificity; and

WHEREAS, notice of such hearing has been given by the Mayor to all affected property owners as defined in Chapter VI, Article One, Division Five of the San Diego Municipal Code, and the utilities concerned in the manner and for the time required by law; and

WHEREAS, such hearing has been duly and regularly held and all persons interested have been given an opportunity to be heard; NOW, THEREFORE,

BE IT RESOLVED, by the Council of the City of San Diego, as follows:

1. The City Council hereby finds and determines that the public health, safety, or general welfare requires the removal of poles, overhead wires, and associated overhead structures and the underground installation of wires and facilities for supplying electric, communication, community antenna television or similar or associated service within the areas set forth above and that pursuant to Chapter VI, Article One, Division Five of the San Diego Municipal Code, the above areas are hereby declared to be underground utility districts in the City of San Diego, and the maps and document referred to above are hereby incorporated as a part of this resolution.

2. The Mayor is hereby authorized to establish schedules for the underground conversion of all poles, overhead wires, and associates structures in said District.

3. The Mayor is hereby instructed to notify all affected persons as defined in Chapter VI, Article One, Division Five of the San Diego Municipal Code, and all affected utility companies of the adoption of this resolution within fifteen days after date of adoption. The Mayor shall further notify affected persons as defined in Chapter VI, Article One, Division Five of the San Diego Municipal Code of the necessity that if they desire to continue to receive electric, communication, community antenna television or similar or associated service, they

shall permit the installation of all necessary facility changes on their premises, or provide such changes at their own expense, so as to receive underground service from the lines relocated underground of the supplying utility company subject to applicable rules, regulations, and tariffs of the respective utility company on file with the Public Utilities Commission of the State of California (as of the date of the adoption of this resolution) and subject to all other applicable requirements of State law and City ordinances. The Mayor's notification shall be in the manner provided in Chapter VI, Article One, Division Five of the San Diego Municipal Code.

APPROVED: MICHAEL J. AGUIRRE, City Attorney

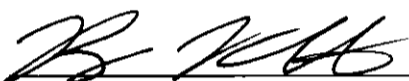
By 
Ryan Kohut
Deputy City Attorney

RK:cfq
04/16/08
Or.Dept:E&CP
R-2008-952

I hereby certify that the foregoing Resolution was passed by the Council of the City of San Diego, at this meeting of JUN 17 2008

ELIZABETH S. MALAND
City Clerk

By 
Deputy City Clerk

Approved: 6-24-08
(date)

JERRY SANDERS, Mayor

Vetoed: _____
(date)

JERRY SANDERS, Mayor

**GENERAL BOUNDARY DESCRIPTION FOR THE DISTRICT 2
BLOCK 2T UNDERGROUND UTILITY DISTRICT**

The DISTRICT 2 BLOCK 2T UNDERGROUND UTILITY DISTRICT shall be established to include the following described parcels:

Portions Lots 1 & 2 of Map PUEBLO LOT 1783 PARTITION, Subdivision Map No. 839.

Lots 1, 2 & 20 through 38 in Block 1; Lots 1 through 3, 37 & 38 in Block 2; Lots 17 through 33 in Block 3; Lots 33 through 48 in Block 4 of Map PACIFIC BEACH VISTA TRACT, Subdivision Map No. 916.

Lots 4 through 12, portion Lots 29 & 30, Lots 31 through 37 in Block 9; Lots 4 through 12, portion 21, Lots 22 through 43 in Block 10; Lots 4 through 20 in Block 11; Lot 4 in Block 12; Lots 1 through 11 in Block 14 of Map MONTE VISTA TRACT, Subdivision Map No. 928.

Lots 20 through 28, UNNUMBERED LOT, Lots 30 through 38 in Block 1; Lots 1 through 17, Lots 22 through 38 in Block 2; Lots 1 through 19 in Block 3; Northerly 50 feet of Lots 1 through 4, Lots 5 through 16, portion Lot 27, Lot 28 & the Southeasterly half of Lots 29 through 32 in Block 4; Lots 17 through 32 in Block 5 of Map BUENA VISTA TRACT, Subdivision Map No. 929.

Portion Lots 32 & 33, Lots 65 through 90 in Block 3; portion Lot 33, Lots 65 through 77 in Block 4; Lots 78 & 79 in Block 5; Lots 75 through 80 in Block 6; Lots 1 through 4, portion Lots 37 through 40 in Block 9; Lots 1 through 4, Lots 37 through 40 in Block 10; Lots 1 through 4 in Block 11; Lots 1 through 4 in Block 12 of Map PACIFIC BEACH VISTA FIRST ADDITION, Subdivision Map No. 930.

Parcels 1 & 2 of Parcel Map No. 10727

Lots 16 through 18 in Block 22; portion Lots 13 through 15, Lot 16 & portion Lot 17 in Block 23; Lots 16 through 18 in Block 24; Lots 14 through 18 in Block 25; Lots 1 through 8 & portion Lot 9, & closed alley adjacent to & Southerly of said Lots 7 & 8 in Block 29; Lots 1 through 6 in Block 30; Lots 1 through 6 in Block 31; Lots 1 through 6 in Block 32; Lots 1 through 7 in Block 33 of Map BIRD ROCK ADDITION, Subdivision Map No. 1083.

Parcel 2 of Parcel Map No. 18987.

Lots 1 through 32 in Block 2; Lots 1 through 16 in Block 3 of Map SEA VIEW HEIGHTS, Subdivision Map No. 1125.

R 303863

Parcel 1 of Parcel Map No. 1641.

Parcels 1 through 3 of Parcel Map No. 16941.

Lots 1 through 13 of Map LA JOLLA VALLEY VISTA, Subdivision Map No. 3181.

Lots 14 through 25 of Map LA JOLLA VALLEY VISTA UNIT NO. 2, Subdivision Map No. 3494.

Lots 1& 2 of Map BELLEVUE TERRACE UNIT NO. 1, Subdivision Map No. 3593.

Lots 6 through 11 of Map BELLEVUE TERRACE UNIT NO. 2, Subdivision Map No. 3675.

Lots 1 through 36 of Map TRENTON TERRACE, Subdivision Map No. 4114.

Lot 32 of Map LA JOLLA MESA VISTA NO. 2, Subdivision Map No. 4551.

Lots 1 through 8 of Map HOLLY PACIFIC, Subdivision Map No. 4624.

Lots 1 & 2 of Map MONARCH VIEWS, Subdivision Map No. 8776.

Lots 124, 132 & the UNNAMED ALLEY between Lots 124 & 132 of Map LA JOLLA ALTA P.R.D. UNIT NO. 14 Subdivision Map No. 12900.

Said district shall also include the following public rights of way:

VAN NUYS STREET

VAN NUYS WAY

VAN NUYS COURT

VAN NUYS PLACE

ARCHER STREET from its intersection with Cass St. to its intersection with Cardeno Dr. & from its intersection with La Jolla Mesa Dr. to the Alley west of La Jolla Mesa Dr.

EVERT STREET from its intersection with Van Nuys St. to its intersection with Archer St.

R- 303863

DAWES STREET between a line from the southeastern corner of 5284 Dawes St. & the southwestern corner of 5275 Dawes St. to its intersection with Archer St.

CASS STREET from its intersection with Turquoise St. to its intersection with the Alley north of Van Nuys St.

CANDLELIGHT DRIVE from its intersection with Van Nuys St. Northerly to its intersection with Candlelight Pl.

CANDLELIGHT PLACE

BELLEVUE PLACE

ALLEY North of Van Nuys St. and South of Bellevue Pl. and Candlelight Pl. from its intersection with Cass St. west to its end at 704 Van Nuys St.

ALLEY North of Archer St. and South of Van Nuys St. East from its intersection with Cass St. to 1142 Archer St. & from its intersection with La Jolla Mesa Dr. East to 704 Archer St.

ALLEY South of Colima St. from its intersection with Bellevue Ave. west to its intersection with La Jolla Blvd.

ALLEY East of La Jolla Mesa Dr. and west of La Jolla Hermosa from its intersection with Van Nuys St. south to Turquoise St.

ALLEY South of Colima St. from its intersection with Van Nuys St. west to its intersection with La Jolla Hermosa Ave.

BELLEVUE AVENUE from its intersection with Colima St. Northerly to its intersection with Bellevue Pl.

BEAUMONT AVENUE from its intersection with Colima St. Southerly to the Alley South of Colima St.

WAVERLY AVENUE from its intersection with Colima St. Southerly to the Alley South of Colima St.

LA JOLLA BOULEVARD its intersection with Colima St. Southerly to its intersection with La Jolla Hermosa Ave.

TURQUOISE STREET from its intersection with La Jolla Hermosa Ave. Easterly to the Alley east of La Jolla Hermosa Ave.

R 303863

COLIMA STREET from its intersection with La Jolla Blvd. Easterly to its intersection with La Jolla Mesa Dr.

LA JOLLA MESA DRIVE from its intersection with Colima St. Southerly to its intersection with Turquoise St.

LA JOLLA HERMOSA AVENUE from its intersection with Colima St. Southerly to its intersection with La Jolla Blvd.

R-303863

DISTRICT 2 BLOCK 2T UNDERGROUND UTILITY DISTRICT

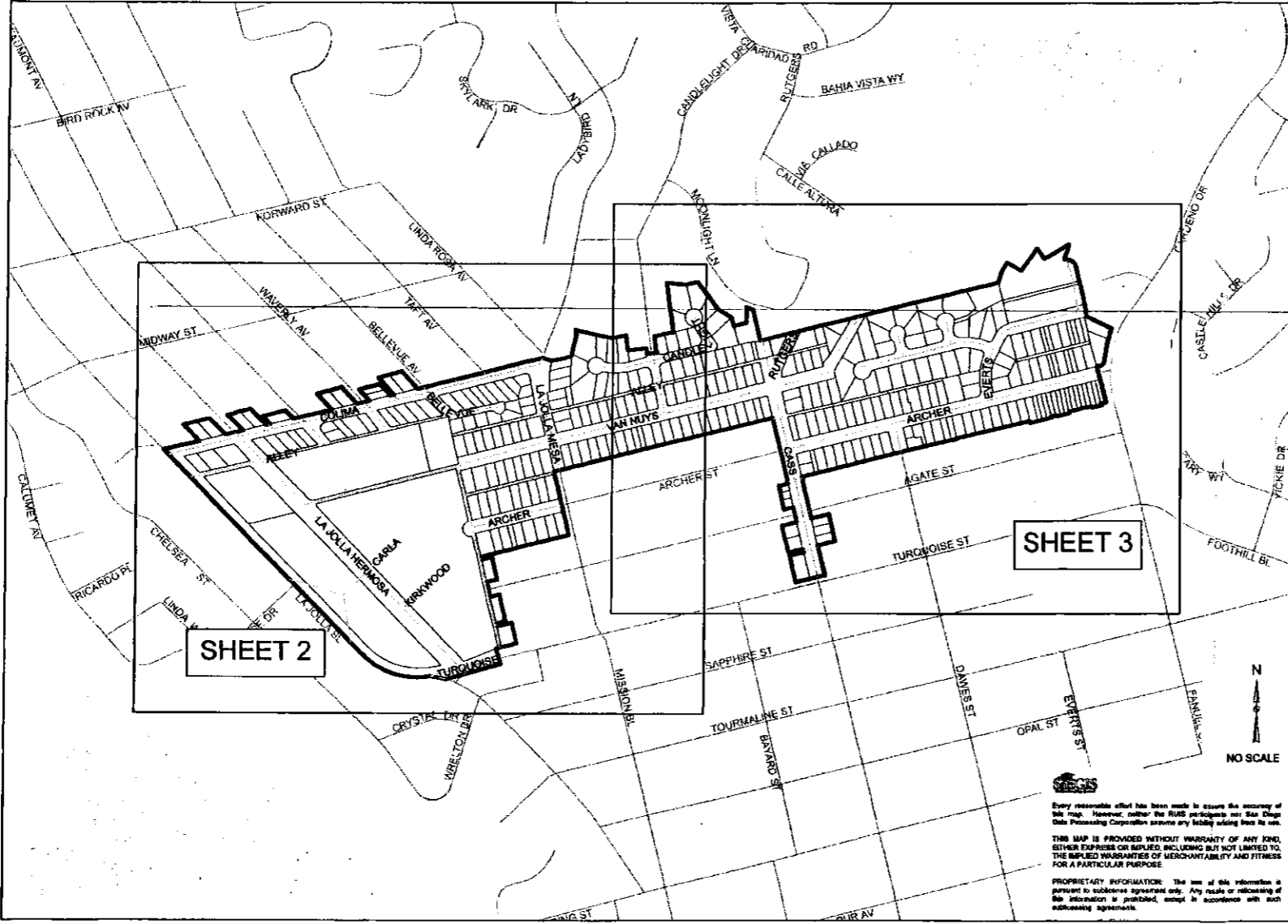

LEGEND

- DISTRICT BOUNDARY
- PARCELS
- PROPOSED STREET LIGHTS
- ASSESSOR'S BOOK & PAGE NO.
- ASSESSOR'S PARCEL NO.
- ADDRESS

VICINITY MAP

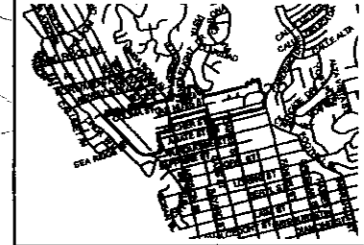

DISTRICT 2 BLOCK 2T UNDERGROUND UTILITY DISTRICT

CITY OF SAN DIEGO, CALIFORNIA ENGINEERING AND CAPITAL PROJECTS DEPARTMENT DISTRICT OF 3 DISTRICTS				WFO NO. 373101
DATE	BY	APPROVED	DATE	PLUMB
12/2/07	AMS			
<small>Every reasonable effort has been made to ensure the accuracy of this map. However, neither the PUES participants nor San Diego Data Processing Corporation assume any liability arising from its use.</small>				<small>ISSUED ENGINEER</small> <small>238-1989</small> <small>LAMBERT COMMUNITIES</small>
<small>THIS MAP IS PROVIDED WITHOUT WARRANTY OF ANY KIND, EITHER EXPRESS OR IMPLIED, INCLUDING BUT NOT LIMITED TO, THE IMPLIED WARRANTIES OF MERCHANTABILITY AND FITNESS FOR A PARTICULAR PURPOSE.</small>				<small>33803-1-D</small>
<small>PROPRIETARY INFORMATION: The use of this information is limited to the specific project and site only. Any reuse or release of this information is prohibited, except in accordance with such publishing agreements.</small>				
CONTRACTOR	DATE STARTED	DATE COMPLETED		

R 303863

DISTRICT 2 BLOCK 2T UNDERGROUND UTILITY DISTRICT

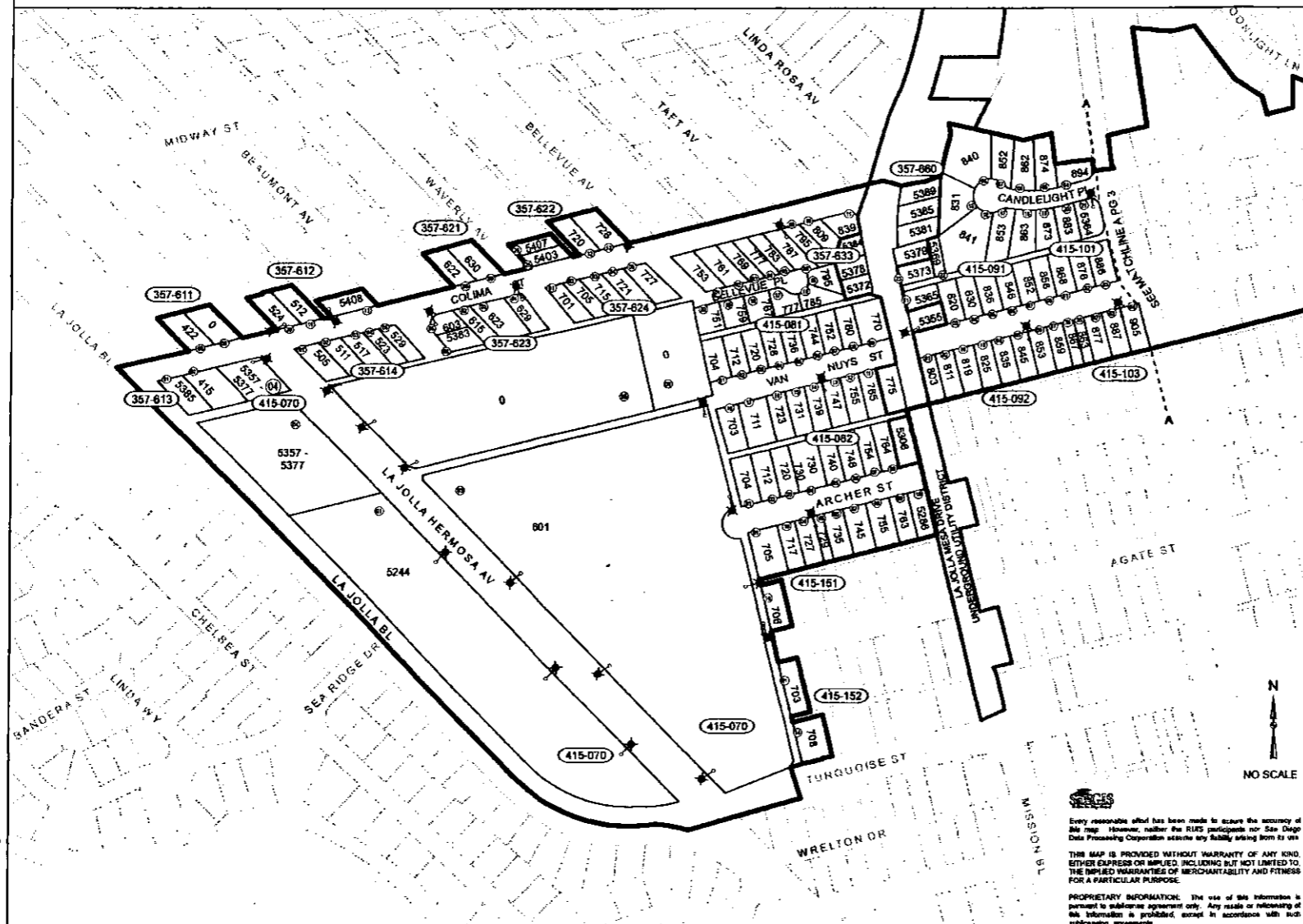

LEGEND

- DISTRICT BOUNDARY
- PARCELS
- PROPOSED STREET LIGHTS
- ASSESSOR'S BOOK & PAGE NO.
- ASSESSOR'S PARCEL NO.
- 1234 ADDRESS

VICINITY MAP

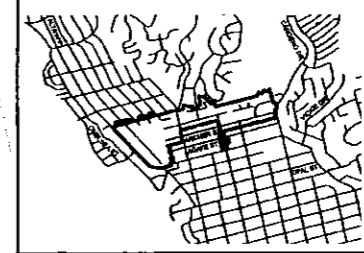

DISTRICT 2 BLOCK 2T UNDERGROUND UTILITY DISTRICT

CITY OF SAN DIEGO, CALIFORNIA ENGINEERING AND CAPITAL PROJECTS DEPARTMENT DISTRICT 2 MAP SECTION		PROJECT NO. 373101
DATE PREPARED	BY	DATE
DATE CHECKED	BY	DATE
DATE APPROVED	BY	DATE
DATE REVISION	BY	DATE
PROJECT NO.		238-1689
PROJECT NAME		33803-2-D

NOTES

Every reasonable effort has been made to secure the accuracy of this map. However, neither the RISE participants nor San Diego Data Processing Corporation assume any liability arising from its use.

THIS MAP IS PROVIDED WITHOUT WARRANTY OF ANY KIND, EITHER EXPRESS OR IMPLIED, INCLUDING BUT NOT LIMITED TO, THE IMPLIED WARRANTIES OF MERCHANTABILITY AND FITNESS FOR A PARTICULAR PURPOSE.

PROPRIETARY INFORMATION: The use of this information is permitted in accordance with the agreement only. Any resale or information of this information is prohibited, except in accordance with such subcontracting agreements.

R-303863

DISTRICT 2 BLOCK 2T UNDERGROUND UTILITY DISTRICT

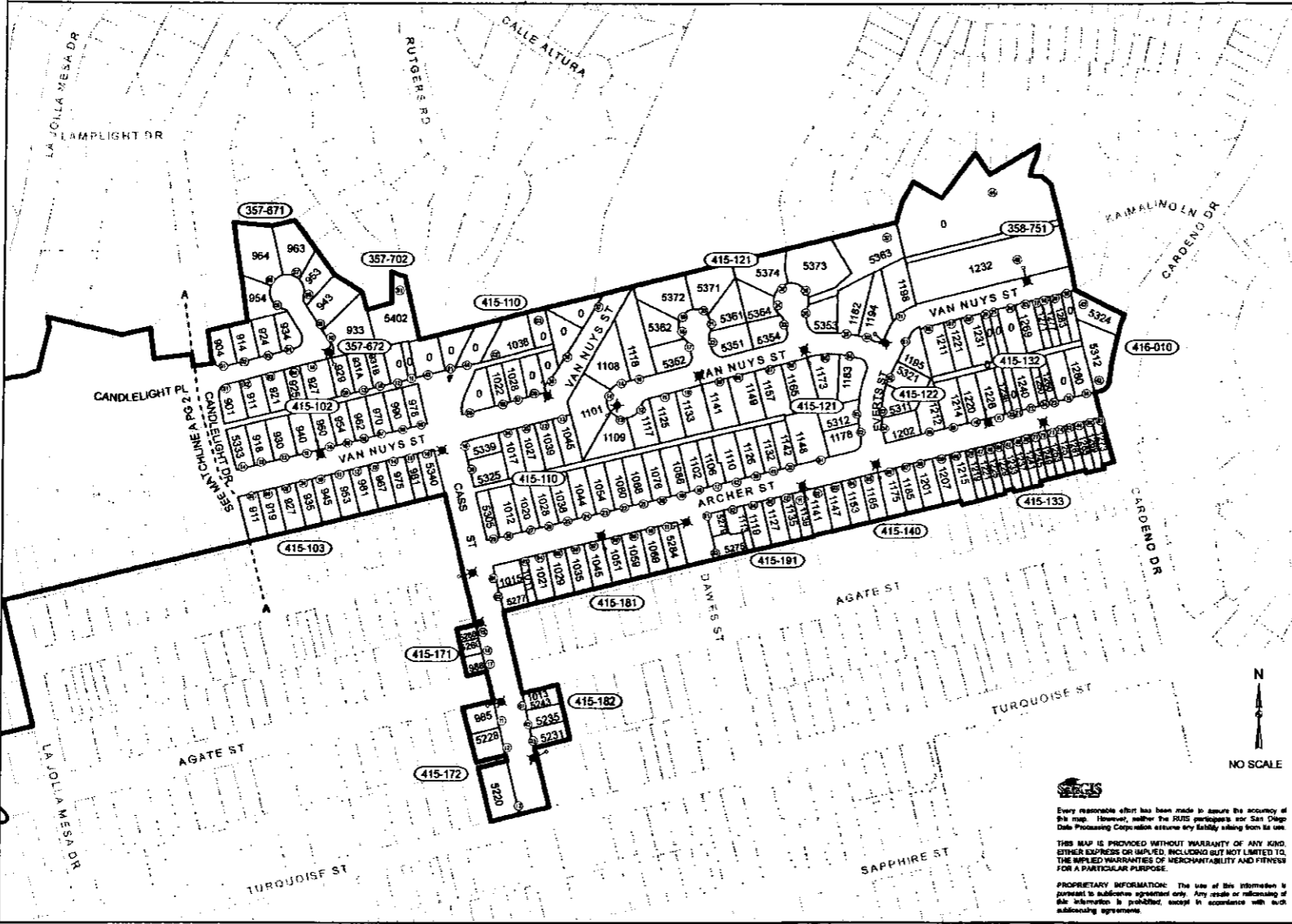

LEGEND

- DISTRICT BOUNDARY
- PARCELS
- EXISTING POLE
- PROPOSED STREET LIGHTS
- ASSESSOR'S BOOK & PAGE NO.
- ASSESSOR'S PARCEL NO.
- 1234 ADDRESS

VICINITY MAP

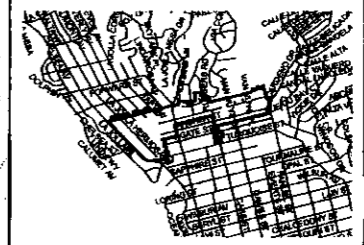

DISTRICT 2 BLOCK 2T UNDERGROUND UTILITY DISTRICT

CITY OF SAN DIEGO, CALIFORNIA ENGINEERING AND CAPITAL PROJECTS DEPARTMENT DISTRICT 2T'S SUBJECT		W.D. NO. 373101
DATE OF PREPARATION	DATE	PROJECT NO.
DESCRIPTION	BY	APPROVED
DATE	DATE	DATE
CONTRACTOR		DATE STARTED
SUPERVISOR		DATE COMPLETED
		33803-3-D

Every reasonable effort has been made to assure the accuracy of this map. However, neither the RUS participants nor San Diego Date Processing Corporation assume any liability arising from its use.

THIS MAP IS PROVIDED WITHOUT WARRANTY OF ANY KIND, EITHER EXPRESS OR IMPLIED, INCLUDING BUT NOT LIMITED TO, THE IMPLIED WARRANTIES OF MERCHANTABILITY AND FITNESS FOR A PARTICULAR PURPOSE.

PROPRIETARY INFORMATION: The use of this information is provided to addressee agreement only. Any resale or retransmission of this information is prohibited, except in accordance with such addressee agreements.

R- 303863