

(B)  
(R-2008-954)

339  
6/17

RESOLUTION NUMBER R- 303864

DATE OF FINAL PASSAGE JUN 24 2008

BE IT RESOLVED, by the Council of the City of San Diego [Council], that the Mitigated Negative Declaration, Project No. 139587, 139592, and 139593 dated APR 28, 2008 [MND], which is on file in the office of the City Clerk, has been completed in compliance with the California Environmental Quality Act of 1970 [CEQA] (Cal. Pub. Resources C. section 21000 et seq.), as amended, and the State guidelines thereto (Cal. Code of Regs., tit. 14, ch. 3), that the MND reflects the independent judgment of the City of San Diego as Lead Agency, and that the information in the MND, together with any comments received during the public review process, has been reviewed and considered by this Council in connection with the approval of the creation of the following underground utility districts (Residential Project Block 2T - Pacific Beach North):

- Portions Lots 1 & 2 of Map PUEBLO LOT 1783 PARTITION, Subdivision Map No. 839.
- Lots 1, 2 & 20 through 38 in Block 1; Lots 1 through 3, 37 & 38 in Block 2; Lots 17 through 33 in Block 3; Lots 33 through 48 in Block 4 of Map PACIFIC BEACH VISTA TRACT, Subdivision Map No. 916.
- Lots 4 through 12, portion Lots 29 & 30, Lots 31 through 37 in Block 9; Lots 4 through 12, portion 21, Lots 22 through 43 in Block 10; Lots 4 through 20 in Block 11; Lot 4 in Block 12; Lots 1 through 11 in Block 14 of Map MONTE VISTA TRACT, Subdivision Map No. 928.
- Lots 20 through 28, UNNUMBERED LOT, Lots 30 through 38 in Block 1; Lots 1 through 17, Lots 22 through 38 in Block 2; Lots 1 through 19 in Block 3; Northerly 50 feet of Lots 1 through 4, Lots 5 through 16, portion Lot 27, Lot 28 & the Southeasterly half of Lots 29 through 32 in Block 4; Lots 17 through 32 in Block 5 of Map BUENA VISTA TRACT, Subdivision Map No. 929.
- Portion Lots 32 & 33, Lots 65 through 90 in Block 3; portion Lot 33, Lots 65 through 77 in Block 4; Lots 78 & 79 in Block 5; Lots 75 through 80 in Block 6; Lots 1 through 4, portion Lots 37 through 40 in Block 9; Lots 1 through 4, Lots 37 through 40 in Block 10; Lots 1 through 4 in Block 11; Lots 1 through 4 in Block 12 of Map PACIFIC BEACH VISTA FIRST ADDITION, Subdivision Map No. 930.

- Parcels 1 & 2 of Parcel Map No. 10727
- Lots 16 through 18 in Block 22; portion Lots 13 through 15, Lot 16 & portion Lot 17 in Block 23; Lots 16 through 18 in Block 24; Lots 14 through 18 in Block 25; Lots 1 through 8 & portion Lot 9, & closed alley adjacent to & Southerly of said Lots 7 & 8 in Block 29; Lots 1 through 6 in Block 30; Lots 1 through 6 in Block 31; Lots 1 through 6 in Block 32; Lots 1 through 7 in Block 33 of Map BIRD ROCK ADDITION, Subdivision Map No. 1083.
- Parcel 2 of Parcel Map No. 18987.
- Lots 1 through 32 in Block 2; Lots 1 through 16 in Block 3 of Map SEA VIEW HEIGHTS, Subdivision Map No. 1125.
- Parcel 1 of Parcel Map No. 1641.
- Parcels 1 through 3 of Parcel Map No. 16941.
- Lots 1 through 13 of Map LA JOLLA VALLEY VISTA, Subdivision Map No. 3181.
- Lots 14 through 25 of Map LA JOLLA VALLEY VISTA UNIT NO. 2, Subdivision Map No. 3494.
- Lots 1 & 2 of Map BELLEVUE TERRACE UNIT NO. 1, Subdivision Map No. 3593.
- Lots 6 through 11 of Map BELLEVUE TERRACE UNIT NO. 2, Subdivision Map No. 3675.
- Lots 1 through 36 of Map TRENTON TERRACE, Subdivision Map No. 4114.
- Lot 32 of Map LA JOLLA MESA VISTA NO. 2, Subdivision Map No. 4551.
- Lots 1 through 8 of Map HOLLY PACIFIC, Subdivision Map No. 4624.
- Lots 1 & 2 of Map MONARCH VIEWS, Subdivision Map No. 8776.
- Lots 124, 132 & the UNNAMED ALLEY between Lots 124 & 132 of Map LA JOLLA ALTA P.R.D. UNIT NO. 14 Subdivision Map No. 12900.

Said district shall also include the following public rights of way:

- VAN NUYS STREET
- VAN NUYS WAY
- VAN NUYS COURT
- VAN NUYS PLACE
- ARCHER STREET from its intersection with Cass St. to its intersection with Cardeno Dr. & from its intersection with La Jolla Mesa Dr. to the Alley west of La Jolla Mesa Dr.
- EVERT STREET from its intersection with Van Nuys St. to its intersection with Archer St.

- DAWES STREET between a line from the southeastern corner of 5284 Dawes St. & the southwestern corner of 5275 Dawes St. to its intersection with Archer St.
- CASS STREET from its intersection with Turquoise St. to its intersection with the Alley north of Van Nuys St.
- CANDLELIGHT DRIVE from its intersection with Van Nuys St. Northerly to its intersection with Candlelight Pl.
- CANDLELIGHT PLACE
- BELLEVUE PLACE
- ALLEY North of Van Nuys St. and South of Bellevue Pl. and Candlelight Pl. from its intersection with Cass St. west to its end at 704 Van Nuys St.
- ALLEY North of Archer St. and South of Van Nuys St. East from its intersection with Cass St. to 1142 Archer St. & from its intersection with La Jolla Mesa Dr. East to 704 Archer St.
- ALLEY South of Colima St. from its intersection with Bellevue Ave. west to its intersection with La Jolla Blvd.
- ALLEY East of La Jolla Mesa Dr. and west of La Jolla Hermosa from its intersection with Van Nuys St. south to Turquoise St.
- ALLEY South of Colima St. from its intersection with Van Nuys St. west to its intersection with La Jolla Hermosa Ave.
- BELLEVUE AVENUE from its intersection with Colima St. Northerly to its intersection with Bellevue Pl.
- BEAUMONT AVENUE from its intersection with Colima St. Southerly to the Alley South of Colima St.
- WAVERLY AVENUE from its intersection with Colima St. Southerly to the Alley South of Colima St.
- LA JOLLA BOULEVARD its intersection with Colima St. Southerly to its intersection with La Jolla Hermosa Ave.
- TURQUOISE STREET from its intersection with La Jolla Hermosa Ave. Easterly to the Alley east of La Jolla Hermosa Ave.
- COLIMA STREET from its intersection with La Jolla Blvd. Easterly to its intersection with La Jolla Mesa Dr.
- LA JOLLA MESA DRIVE from its intersection with Colima St. Southerly to its intersection with Turquoise St.
- LA JOLLA HERMOSA AVENUE from its intersection with Colima St. Southerly to its intersection with La Jolla Blvd.

BE IT FURTHER RESOLVED, that the Council adopts the Mitigation Monitoring and Reporting Program, or alterations to implement the changes to the project as required by this

body in order to mitigate or avoid significant effects on the environment, a copy of which is attached hereto and incorporated herein by reference, pursuant to California Public Resources Code section 21081.6.

BE IT FURTHER RESOLVED, that the City Clerk is directed to file a Notice of Determination with the Clerk of the Board of Supervisors for the County of San Diego regarding the above projects.

APPROVED: MICHAEL J. AGUIRRE, City Attorney

By   
Ryan Kohut  
Deputy City Attorney

RK:cfq  
04/16/08  
Or.Dept:E&CP  
R-2008-954

I hereby certify that the foregoing Resolution was passed by the Council of the City of San Diego, at this meeting of JUN 17 2008.

ELIZABETH S. MALAND  
City Clerk

By   
Deputy City Clerk

Approved: 6-24-08  
(date)

  
JERRY SANDERS, Mayor

Vetoed: \_\_\_\_\_  
(date)

\_\_\_\_\_  
JERRY SANDERS, Mayor

**GENERAL BOUNDARY DESCRIPTION FOR THE DISTRICT 2  
BLOCK 2T UNDERGROUND UTILITY DISTRICT**

The DISTRICT 2 BLOCK 2T UNDERGROUND UTILITY DISTRICT shall be established to include the following described parcels:

Portions Lots 1 & 2 of Map PUEBLO LOT 1783 PARTITION, Subdivision Map No. 839.

Lots 1, 2 & 20 through 38 in Block 1; Lots 1 through 3, 37 & 38 in Block 2; Lots 17 through 33 in Block 3; Lots 33 through 48 in Block 4 of Map PACIFIC BEACH VISTA TRACT, Subdivision Map No. 916.

Lots 4 through 12, portion Lots 29 & 30, Lots 31 through 37 in Block 9; Lots 4 through 12, portion 21, Lots 22 through 43 in Block 10; Lots 4 through 20 in Block 11; Lot 4 in Block 12; Lots 1 through 11 in Block 14 of Map MONTE VISTA TRACT, Subdivision Map No. 928.

Lots 20 through 28, UNNUMBERED LOT, Lots 30 through 38 in Block 1; Lots 1 through 17, Lots 22 through 38 in Block 2; Lots 1 through 19 in Block 3; Northerly 50 feet of Lots 1 through 4, Lots 5 through 16, portion Lot 27, Lot 28 & the Southeasterly half of Lots 29 through 32 in Block 4; Lots 17 through 32 in Block 5 of Map BUENA VISTA TRACT, Subdivision Map No. 929.

Portion Lots 32 & 33, Lots 65 through 90 in Block 3; portion Lot 33, Lots 65 through 77 in Block 4; Lots 78 & 79 in Block 5; Lots 75 through 80 in Block 6; Lots 1 through 4, portion Lots 37 through 40 in Block 9; Lots 1 through 4, Lots 37 through 40 in Block 10; Lots 1 through 4 in Block 11; Lots 1 through 4 in Block 12 of Map PACIFIC BEACH VISTA FIRST ADDITION, Subdivision Map No. 930.

Parcels 1 & 2 of Parcel Map No. 10727

Lots 16 through 18 in Block 22; portion Lots 13 through 15, Lot 16 & portion Lot 17 in Block 23; Lots 16 through 18 in Block 24; Lots 14 through 18 in Block 25; Lots 1 through 8 & portion Lot 9, & closed alley adjacent to & Southerly of said Lots 7 & 8 in Block 29; Lots 1 through 6 in Block 30; Lots 1 through 6 in Block 31; Lots 1 through 6 in Block 32; Lots 1 through 7 in Block 33 of Map BIRD ROCK ADDITION, Subdivision Map No. 1083.

Parcel 2 of Parcel Map No. 18987.

Lots 1 through 32 in Block 2; Lots 1 through 16 in Block 3 of Map SEA VIEW HEIGHTS, Subdivision Map No. 1125.

R. 303864

Parcel 1 of Parcel Map No. 1641.

Parcels 1 through 3 of Parcel Map No. 16941.

Lots 1 through 13 of Map LA JOLLA VALLEY VISTA, Subdivision Map No. 3181.

Lots 14 through 25 of Map LA JOLLA VALLEY VISTA UNIT NO. 2, Subdivision Map No. 3494.

Lots 1& 2 of Map BELLEVUE TERRACE UNIT NO. 1, Subdivision Map No. 3593.

Lots 6 through 11 of Map BELLEVUE TERRACE UNIT NO. 2, Subdivision Map No. 3675.

Lots 1 through 36 of Map TRENTON TERRACE, Subdivision Map No. 4114.

Lot 32 of Map LA JOLLA MESA VISTA NO. 2, Subdivision Map No. 4551.

Lots 1 through 8 of Map HOLLY PACIFIC, Subdivision Map No. 4624.

Lots 1 & 2 of Map MONARCH VIEWS, Subdivision Map No. 8776.

Lots 124, 132 & the UNNAMED ALLEY between Lots 124 & 132 of Map LA JOLLA ALTA P.R.D. UNIT NO. 14 Subdivision Map No. 12900.

Said district shall also include the following public rights of way:

VAN NUYS STREET

VAN NUYS WAY

VAN NUYS COURT

VAN NUYS PLACE

ARCHER STREET from its intersection with Cass St. to its intersection with Cardeno Dr. & from its intersection with La Jolla Mesa Dr. to the Alley west of La Jolla Mesa Dr.

EVERT STREET from its intersection with Van Nuys St. to its intersection with Archer St.

R. 303864

**DAWES STREET** between a line from the southeastern corner of 5284 Dawes St. & the southwestern corner of 5275 Dawes St. to its intersection with Archer St.

**CASS STREET** from its intersection with Turquoise St. to its intersection with the Alley north of Van Nuys St.

**CANDLELIGHT DRIVE** from its intersection with Van Nuys St. Northerly to its intersection with Candlelight Pl.

**CANDLELIGHT PLACE**

**BELLEVUE PLACE**

**ALLEY** North of Van Nuys St. and South of Bellevue Pl. and Candlelight Pl. from its intersection with Cass St. west to its end at 704 Van Nuys St.

**ALLEY** North of Archer St. and South of Van Nuys St. East from its intersection with Cass St. to 1142 Archer St. & from its intersection with La Jolla Mesa Dr. East to 704 Archer St.

**ALLEY** South of Colima St. from its intersection with Bellevue Ave. west to its intersection with La Jolla Blvd.

**ALLEY** East of La Jolla Mesa Dr. and west of La Jolla Hermosa from its intersection with Van Nuys St. south to Turquoise St.

**ALLEY** South of Colima St. from its intersection with Van Nuys St. west to its intersection with La Jolla Hermosa Ave.

**BELLEVUE AVENUE** from its intersection with Colima St. Northerly to its intersection with Bellevue Pl.

**BEAUMONT AVENUE** from its intersection with Colima St. Southerly to the Alley South of Colima St.

**WAVERLY AVENUE** from its intersection with Colima St. Southerly to the Alley South of Colima St.

**LA JOLLA BOULEVARD** its intersection with Colima St. Southerly to its intersection with La Jolla Hermosa Ave.

**TURQUOISE STREET** from its intersection with La Jolla Hermosa Ave. Easterly to the Alley east of La Jolla Hermosa Ave.

R. 303864

**COLIMA STREET** from its intersection with La Jolla Blvd. Easterly to its intersection with La Jolla Mesa Dr.

**LA JOLLA MESA DRIVE** from its intersection with Colima St. Southerly to its intersection with Turquoise St.

**LA JOLLA HERMOSA AVENUE** from its intersection with Colima St. Southerly to its intersection with La Jolla Blvd.

R. 303864





# DISTRICT 2 BLOCK 2T UNDERGROUND UTILITY DISTRICT

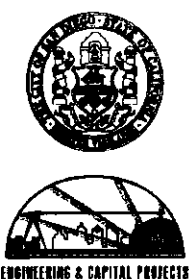
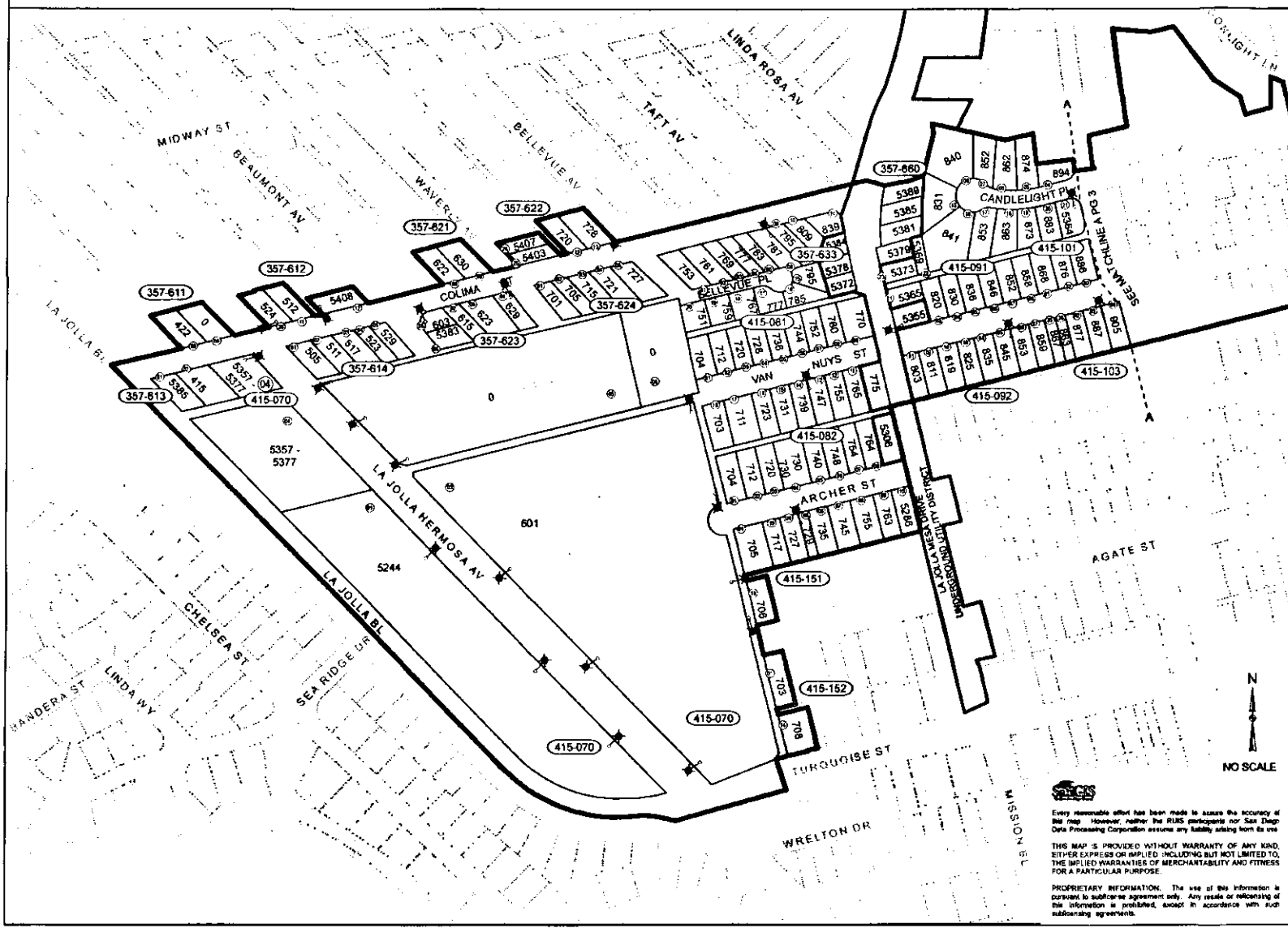

### LEGEND

- DISTRICT BOUNDARY
- PARCELS
- PROPOSED STREET LIGHTS
- ASSESSOR'S BOOK & PAGE NO.
- ASSESSOR'S PARCEL NO.
- ADDRESS

### VICINITY MAP

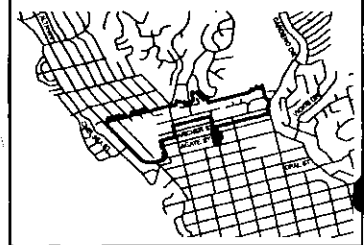

### DISTRICT 2 BLOCK 2T UNDERGROUND UTILITY DISTRICT

CITY OF SAN DIEGO, CALIFORNIA		WFO NO.
ENGINEER AND CAPITAL PROJECTS DEPARTMENT		373101
PROJECT NO. 170401		DATE COMPLETED
DESIGNED BY	APPROVED BY	DATE
DRAWN BY	DATE	PLANNED
CONTRACTOR		DATE COMPLETED
SUPERVISOR		DATE COMPLETED
PROJECT NO. 170401		33803-2-D

Every reasonable effort has been made to assure the accuracy of this map. However, neither the RUCS participants nor San Diego Data Processing Corporation assume any liability relating to its use.

THIS MAP IS PROVIDED WITHOUT WARRANTY OF ANY KIND, EITHER EXPRESS OR IMPLIED INCLUDING BUT NOT LIMITED TO, THE IMPLIED WARRANTIES OF MERCHANTABILITY AND FITNESS FOR A PARTICULAR PURPOSE.

PROPRIETARY INFORMATION: The use of this information is restricted to the purpose for which it was prepared. Any resale or retransmission of this information is prohibited, except in accordance with such authorizing agreements.

R- 303864

# DISTRICT 2 BLOCK 2T UNDERGROUND UTILITY DISTRICT

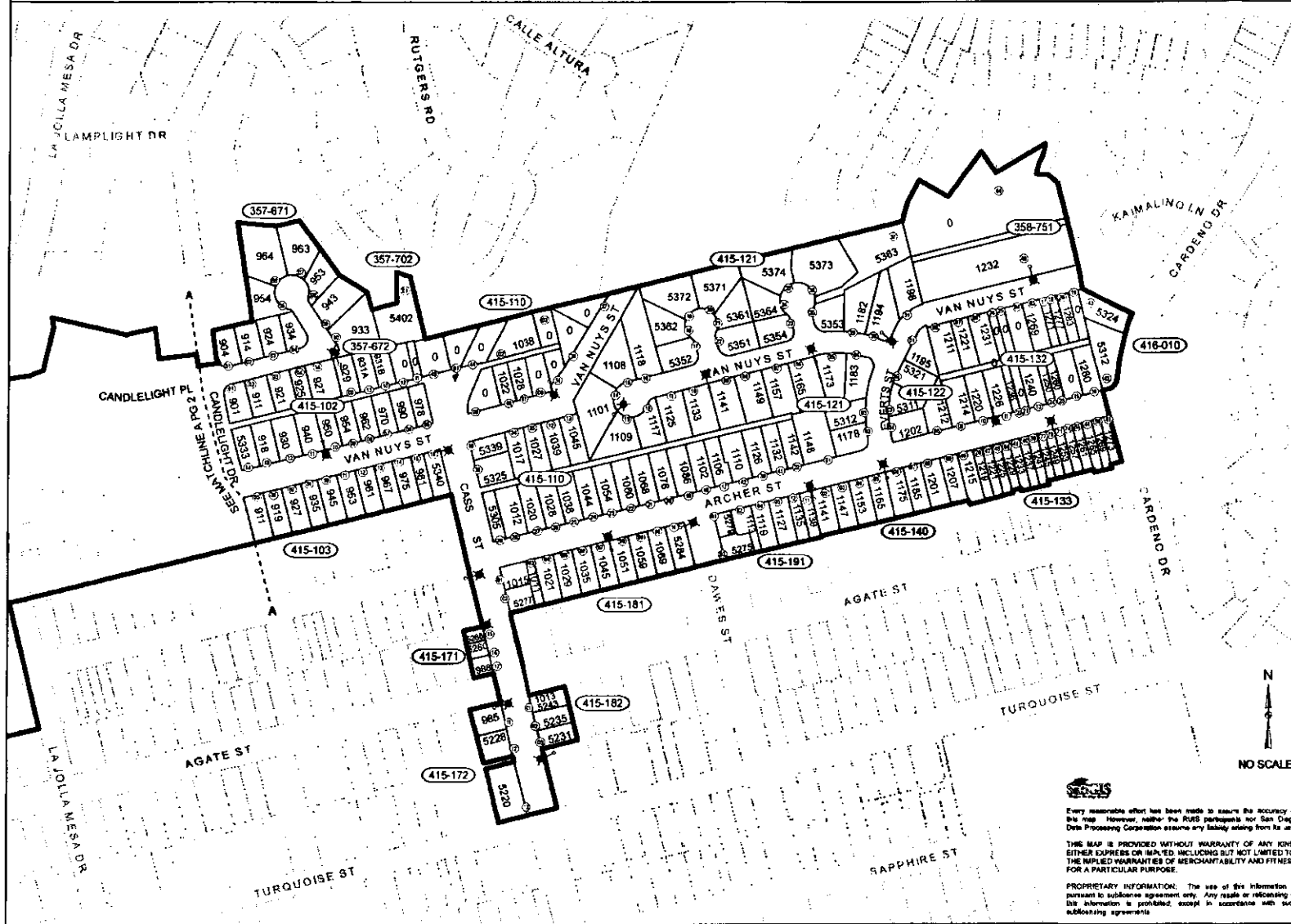

### LEGEND

- DISTRICT BOUNDARY
- PARCELS
- EXISTING POLE
- PROPOSED STREET LIGHTS
- ASSESSOR'S BOOK & PAGE NO.
- ASSESSOR'S PARCEL NO.
- 1234 ADDRESS

### VICINITY MAP

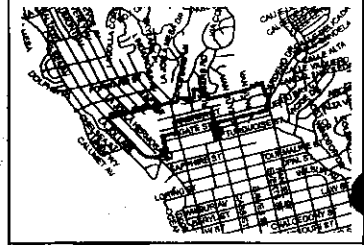

### DISTRICT 2 BLOCK 2T UNDERGROUND UTILITY DISTRICT

CITY OF SAN DIEGO, CALIFORNIA ENGINEERING AND CAPITAL PROJECTS DEPARTMENT SHEET 1 OF 3 SHEETS		FIELD NO. 372101
DATE	BY	APPROVED
12/02/07	AMS	[Signature]
DESIGNED BY		236-1889
DRAWN BY		33803-3-D
CONTRACT NO.	DATE STARTED	DATE COMPLETED

Every reasonable effort has been made to ensure the accuracy of this map. However, neither the RUS participants nor San Diego Data Processing Corporation assume any liability arising from its use.

THIS MAP IS PROVIDED WITHOUT WARRANTY OF ANY KIND, EITHER EXPRESS OR IMPLIED, INCLUDING BUT NOT LIMITED TO, THE IMPLIED WARRANTIES OF MERCHANTABILITY AND FITNESS FOR A PARTICULAR PURPOSE.

PROPRIETARY INFORMATION: The use of this information is pursuant to subsurface agreement only. Any resale or retransmission of this information is prohibited, except in accordance with such subsurface agreements.

R- 303864