

ORDINANCE NUMBER O- 20361 (NEW SERIES)

DATE OF FINAL PASSAGE APR 11 2014

AN ORDINANCE AMENDING CHAPTER 13, ARTICLE 1, DIVISION 5 OF THE SAN DIEGO MUNICIPAL CODE BY AMENDING SECTION 131.0531; AMENDING CHAPTER 13, ARTICLE 1, DIVISION 6 BY AMENDING SECTIONS 131.0602, 131.0622, 131.0623, 131.0631, 131.0643, AND 131.0665 AND ADDING SECTION 131.0606; AMENDING CHAPTER 13, ARTICLE 2, DIVISION 14 BY AMENDING SECTION 132.1402, RETITLING DIAGRAM 132-14A FROM COLLEGE AREA COMMUNITY PLAN IMPLEMENTATION OVERLAY ZONE TO CLAIREMONT MESA COMMUNITY PLAN IMPLEMENTATION OVERLAY ZONE, DELETING DIAGRAM 132-14B TITLED COLLEGE AREA COMMUNITY PLAN IMPLEMENTATION OVERLAY ZONE, AND ADDING A NEW DIAGRAM 132-14B TITLED OTAY MESA COMMUNITY PLAN IMPLEMENTATION OVERLAY ZONE; AMENDING CHAPTER 14, ARTICLE 2, DIVISION 5 BY AMENDING SECTION 142.0530; AMENDING CHAPTER 15, ARTICLE 17, DIVISION 1 BY REPEALING SECTIONS 1517.0101, 1517.0102, 1517.0103, AND 1517.0104; AMENDING CHAPTER 15, ARTICLE 17, DIVISION 2 BY REPEALING SECTIONS 1517.0201, 1517.0202, 1517.0203, 1517.0204, AND 1517.0205; AMENDING CHAPTER 15, ARTICLE 17, DIVISION 3 BY REPEALING SECTIONS 1517.0301, 1517.0302, 1517.0303, 1517.0304, 1517.0305, AND 1517.0306; AMENDING CHAPTER 15, ARTICLE 17, DIVISION 4 BY REPEALING SECTIONS 1517.0401, 1517.0402, 1517.0403, AND 1517.0404, RELATING TO THE OTAY MESA COMMUNITY PLAN UPDATE AND MAKING CORRECTIONS TO THE COMMUNITY PLAN IMPLEMENTATION OVERLAY ZONE DIAGRAMS.

WHEREAS, the Otay Mesa community is located in the City of San Diego bounded by the Otay River Valley and the City of Chula Vista on the north, an unincorporated area of San Diego County to the east, the International Border and the City of Tijuana on the south, and

Interstate 805 (I-805) on the west, and its planning area encompasses approximately 9,300 acres;
and

WHEREAS, the Otay Mesa Community Plan was adopted in 1981 and the Otay Mesa Development District was established in 1984; and

WHEREAS, the Otay Mesa community developed historically with residential communities in the western portion, and with warehousing, distribution, truck depots, and customs brokerages in the eastern portion in a manner that resulted in an incomplete circulation grid; and

WHEREAS, the City sought to address the changing characteristics of industry, the need for more housing, the need for more middle income jobs, and a better understanding of the transportation-land use connection through a comprehensive plan and code update; and

WHEREAS, the City's efforts have included consultation with residents, business and property owners, and other community stakeholders; and

WHEREAS, changes to the Land Development Code of the San Diego Municipal Code are required to implement those changes; NOW, THEREFORE,

BE IT ORDAINED, by the Council of the City of San Diego, as follows:

Section 1. That Chapter 13, Article 1, Division 5 of the San Diego Municipal Code is amended by amending section 131.0531, to read as follows:

§131.0531 Development Regulations Tables of Commercial Zones

The following development regulations apply in each of the commercial zones as shown in Tables 131-05C, 131-05D, and 131-05E.

(a) CN Zones

Table 131-05C
Development Regulations of CN Zones

Development Regulations [See Section 131.0530 for Development Regulations of Commercial Zones]	Zone Designator	Zones		
		1st & 2nd >>	CN-	
	3rd >>	1-	1-	1-
	4th >>	1	2	3
Max permitted residential density⁽¹⁾ through Max structure height (ft)		[No change in text.]		
Max floor area ratio		1.0 ^(3,4)	1.0 ^(3,4)	1.0 ^(3,4)
<i>Floor Area Ratio</i> bonus for mixed use/ Minimum percentage of bonus required for residential use [See Section 131.0546(a)]		[No change in text.]		
Pedestrian paths [See Section 131.0550] through Loading Dock and Overhead Door Screening Regulations [See Section 142.1030]		[No change in text.]		

Footnotes for Table 131-05C

1 through 3 [No change in text.]

4 Within the Otay Mesa Community Plan area, the maximum *floor area ratio* is 0.30.

(b) CR, CO, CV, and CP Zones

Table 131-05D
Development Regulations of CR, CO, CV, CP Zones

Development Regulations [See Section 131.0530 for Development Regulations of Commercial Zones]	Zone Designator	Zones							
		1st & 2nd >>	CR-		CO-		CV-		CP-
	3rd >>	1-	2-	1-		1-		1-	
	4th >>	1		1	2		1	2	1
Max permitted residential density⁽¹⁾ through Min lot coverage (%)		[No change in text.]							
Max floor area ratio		1.0 ^(4,5)	0.75 ^(4,5)	1.5 ^(4,5)	2.0 ^(4,5)	2.0 ^(4,5)	1.0 ^(4,5)		
<i>Floor Area Ratio</i> bonus for mixed use/ Minimum percentage of bonus required for residential use [See Section 131.0546(a)]		[No change in text.]							
<i>Floor Area Ratio</i> bonus for child care [See Section 131.0546(b)]		applies	--	applies	--	--	--		
Pedestrian paths [See Section 131.0550] through Loading Dock and Overhead Door Screening Regulations [See Section 142.1030]		[No change in text.]							

Footnotes for Table 131-05D

1 through 4 [No change in text.]

5 Within the Otay Mesa Community Plan area, the maximum *floor area ratio* is 0.30.

(c) CC Zones

**Table 131-05E
Development Regulations of CC Zones**

Development Regulation [See Section 131.0530 for Development Regulations of Commercial Zones]	Zone Designator	Zones																	
	1st & 2nd >>	CC-																	
	3rd >>	1-	2-	4-	5-	1-	2-	4-	5-	1-	2-	4-	5-	3-	4-	5-	3-	4-	5-
	4th >>	1			2			3			4			5					
Max permitted residential density⁽¹⁾ through Lot dimensions, Max Lot Depth (ft)		[No change in text.]																	
Setback requirements																			
Min Front <i>setback</i> (ft) through Min <i>lot coverage</i> (%)		[No change in text.]																	
Max floor area ratio		0.75 ^(4,5)			2.0 ^(4,5)			0.75 ^(4,5)			1.0 ^(4,5)			2.0 ^(4,5)					
<i>Floor Area Ratio</i> bonus for mixed use/ Minimum percentage of bonus required for residential use [See Section 131.0546(a)]		[No change in text.]																	
Pedestrian paths [See Section 131.0550] through Loading Dock and Overhead Door Screening Regulations [See Section 142.1030]		[No change in text.]																	

Footnotes for Table 131-05E

1 through 4 [No change in text.]

5 Within the Otay Mesa Community Plan area, the maximum *floor area ratio* is 0.30.

Section 2. That Chapter 13, Article 1, Division 6 of the San Diego Municipal Code is amended by amending sections 131.0602, 131.0622, 131.0623, 131.0631, 131.0643, and 131.0665 and adding section 131.0606, to read as follows:

§131.0602 Purpose of the IP (Industrial--Park) Zones

- (a) [No change in text.]
- (b) The IP zones are differentiated based on the uses allowed as follows:

- IP-1-1 allows research and development uses with some limited manufacturing;
- IP-2-1 allows a mix of light industrial and office uses;
- IP-3-1 allows for research and development, office, and residential uses.

§131.0606 Purpose of the IBT (International--Business and Trade) Zone

The purpose of the IBT zone is to provide for a wide variety of base sector industrial and office uses. It is intended to apply in portions of communities adjacent to the international border, other ports of entry, and areas in transition to higher intensity industries.

§131.0622 Use Regulations Table for Industrial Zones

The uses allowed in the industrial zones are shown in Table 131-06B.

Legend for Table 131-06B

[No change in text.]

**Table 131-06B
Use Regulations for Industrial Zones**

Use Categories/ Subcategories [See Section 131.0112 for an explanation and descriptions of the Use Categories, Subcategories, and Separately Regulated Uses]	Zone Designator	Zones									
	1st & 2nd >>	IP-			IL-			IH-		IS-	IBT-
	3rd >>>	1-	2-	3-	1-	2-	3-	1-	2-	1-	1-
	4th >>>	1	1	1	1	1	1	1	1	1	1
Open Space											
Active Recreation	P	P	P	-	P	P	-	P	P	-	
Passive Recreation	P	P	P	-	-	-	-	-	-	-	
Natural Resources Preservation	-	-	-	-	-	-	-	-	-	-	
Park Maintenance Facilities	-	-	-	-	-	-	-	-	-	-	
Agriculture											
Agricultural Processing	-	-	-	-	-	-	-	-	-	-	
Aquaculture Facilities	-	-	-	P	P	P	P	P	P	-	
Dairies	-	-	-	-	-	-	-	-	-	-	

Use Categories/ Subcategories [See Section 131.0112 for an explanation and descriptions of the Use Categories, Subcategories, and Separately Regulated Uses]	Zone	Zones									
	Designator	IP-			IL-			IH-		IS-	IBT-
	1st & 2nd >>	1-	2-	3-	1-	2-	3-	1-	2-	1-	1-
	3rd >>	1	1	1	1	1	1	1	1	1	1
4th >>	1	1	1	1	1	1	1	1	1	1	
Horticulture Nurseries & Greenhouses	-	-	-	P	-	P	P	P	P	-	-
Raising & Harvesting of Crops	-	-	-	P	-	P	P	P	P	-	-
Raising, Maintaining & Keeping of Animals	-	-	-	-	-	-	-	-	-	-	-
Separately Regulated Agriculture Uses											
Agricultural Equipment Repair Shops	-	-	-	P	P	P	P	P	P	P	-
Commercial Stables	-	-	-	-	-	-	-	-	-	-	-
Community Gardens	-	-	-	N	N	N	N	N	N	N	-
Equestrian Show & Exhibition Facilities	-	-	-	-	-	-	-	-	-	-	-
Open Air Markets for the Sale of Agriculture-related Products & Flowers	-	-	-	-	-	-	-	-	-	-	-
Residential											
<i>Mobilehome Parks</i>	-	-	-	-	-	-	-	-	-	-	-
<i>Multiple Dwelling Units</i>	-	-	P ⁽¹⁷⁾	-	-	-	-	-	-	-	-
<i>Rooming House</i> [See Section 131.0112(a)(3)(A)]	-	-	-	-	-	-	-	-	-	-	-
<i>Single Dwelling Units</i>	-	-	-	-	-	-	-	-	-	-	-
Separately Regulated Residential Uses											
<i>Boarder & Lodger Accommodations</i>	-	-	-	-	-	-	-	-	-	-	-
Companion Units	-	-	-	-	-	-	-	-	-	-	-
Employee Housing:											
6 or Fewer Employees	-	-	-	-	-	-	-	-	-	-	-
12 or Fewer Employees	-	-	-	-	-	-	-	-	-	-	-
Greater than 12 Employees	-	-	-	-	-	-	-	-	-	-	-
Fraternities, Sororities and Student Dormitories	-	-	-	-	-	-	-	-	-	-	-
Garage, Yard, & Estate Sales	-	-	-	-	-	-	-	-	-	-	-
Guest Quarters	-	-	-	-	-	-	-	-	-	-	-
Home Occupations	-	-	L	-	-	-	-	-	-	-	-
Housing for Senior Citizens	-	-	L	-	-	-	-	-	-	-	-
Live/Work Quarters	-	-	-	-	-	-	-	-	-	L	-
Residential Care Facilities:											
6 or Fewer Persons	-	-	L	-	-	-	-	-	-	-	-
7 or More Persons	-	-	L	-	-	-	-	-	-	-	-
Transitional Housing:											
6 or Fewer Persons	-	-	L	-	-	-	-	-	-	-	-
7 or More Persons	-	-	C	-	-	-	-	-	-	-	-
Watchkeeper Quarters	L	L	L	L	L	L	L	L	L	L	L
Institutional											
<i>Churches & Places of Religious Assembly</i>	-	-	-	-	P ^(11,16)	P ⁽¹⁶⁾	-	-	P ^(12,16)	-	-
Separately Regulated Institutional Uses											
Airports	C	C	C	C	C	C	C	C	C	C	C
Botanical Gardens & Arboretums	-	-	-	-	-	-	-	-	-	-	-
Cemeteries, Mausoleums, Crematories	C	C	C	C	C	C	C	C	C	C	-

Use Categories/ Subcategories [See Section 131.0112 for an explanation and descriptions of the Use Categories, Subcategories, and Separately Regulated Uses]	Zone	Zones									
	Designator	IP-			IL-			IH-		IS-	IBT-
	1st & 2nd >>	1-	2-	3-	1-	2-	3-	1-	2-	1-	1-
	3rd >>>	1	1	1	1	1	1	1	1	1	1
4th >>>	1	1	1	1	1	1	1	1	1	1	
Correctional Placement Centers	C	C	C	C	C	C	C	C	C	C	-
Educational Facilities:											
Kindergarten through Grade 12	-	C	-	-	C	C	-	-	C	-	
Colleges / Universities	C	C	C	-	C	C	-	C	C	C	
Vocational / Trade School	-	-	-	-	L	L	-	L	L	L	
Energy Generation & Distribution Facilities	C	C	C	P	C	P	P	P	C	-	
Exhibit Halls & Convention Facilities	-	C	-	C	C	C	C	C	C	C	
Flood Control Facilities	L	L	L	L	L	L	L	L	L	L	
Historical Buildings Used for Purposes Not Otherwise Allowed	C	C	C	C	C	C	C	C	C	C	
Homeless Facilities:											
Congregate Meal Facilities	-	C	-	-	C	C	-	C	C	-	
Emergency Shelters	-	C	-	-	C	C	-	C	C	-	
Homeless Day Centers	-	C	-	-	C	C	-	C	C	-	
Hospitals, Intermediate Care Facilities & Nursing Facilities	C	C	C	-	C	C	-	C	C	-	
Interpretive Centers	-	-	-	-	-	-	-	-	-	-	
Museums	-	-	-	-	-	-	-	-	-	-	
Major Transmission, Relay, or Communications Switching Stations	C	C	C	C	C	C	P	C	C	C	
Satellite Antennas	L	L	L	L	L	L	L	L	L	L	
Social Service Institutions	C	C	C	C	C	C	-	-	C	-	
Wireless communication facility:											
Wireless communication facility in the public right-of-way with subterranean equipment adjacent to a non-residential use	L	L	L	L	L	L	L	L	L	L	
Wireless communication facility in the public right-of-way with subterranean equipment adjacent to a residential use	N	N	N	N	N	N	N	N	N	N	
Wireless communication facility in the public right-of-way with above ground equipment	C	C	C	C	C	C	C	C	C	C	
Wireless communication facility outside the public right-of-way	L	L	L	L	L	L	L	L	L	L	
Retail Sales											
Building Supplies & Equipment	-	-	-	p ^(6,15)	p ⁽¹⁵⁾	p ⁽¹⁵⁾	-	p ^(6,15)	p ⁽¹⁵⁾	-	
Food, Beverages and Groceries	-	-	-	-	-	p ⁽¹⁵⁾	-	-	-	-	
Consumer Goods, Furniture, Appliances, Equipment	-	-	-	-	p ^(2,15)	p ⁽¹⁵⁾	-	-	p ^(3,15)	-	
Pets & Pet Supplies	-	-	-	-	-	p ⁽¹⁵⁾	-	-	-	-	
Sundries, Pharmaceuticals, & Convenience Sales	-	p ^(5,15)	p ^(5,15)	p ^(5,15)	p ^(5,15)	p ⁽¹⁵⁾	p ^(5,15)	p ^(5,15)	p ^(4,15)	-	

Use Categories/ Subcategories [See Section 131.0112 for an explanation and descriptions of the Use Categories, Subcategories, and Separately Regulated Uses]	Zone Designator	Zones									
	1st & 2nd >>	IP-			IL-			IH-		IS-	IBT-
	3rd >>	1-	2-	3-	1-	2-	3-	1-	2-	1-	1-
	4th >>	1	1	1	1	1	1	1	1	1	1
Wearing Apparel & Accessories	-	-	-	-	-	P ^(3,15)	P ^(3,15)	-	-	P ^(3,15)	-
Separately Regulated Retail Sales Uses											
Agriculture Related Supplies & Equipment	-	-	-	-	-	P	P	P	P	P	-
Alcoholic Beverage Outlets	-	-	-	-	-	-	L	-	-	-	-
Farmers' Markets											
Weekly Farmers' Market	-	-	-	-	-	-	L	-	-	-	-
Daily Farmers' Market Stands	-	-	-	-	-	-	L	-	-	-	-
Plant Nurseries	-	-	-	-	-	-	P	-	P	P	-
Retail Farms	-	-	-	-	-	-	L	-	-	-	-
Swap Meets & Other Large Outdoor Retail Facilities	-	-	-	C	C	C	C	C	C	C	-
Commercial Services											
Building Services	-	-	-	P	P	P	P	-	P	P	P
Business Support	-	P ⁽⁸⁾	P ⁽⁸⁾	P ⁽⁸⁾	P ⁽⁸⁾	P	P	-	P ⁽⁸⁾	P	P ⁽⁸⁾
Eating & Drinking Establishments	-	P ⁽⁷⁾	P ⁽⁷⁾	P ⁽⁷⁾	P ⁽⁷⁾	P ⁽⁷⁾	P	-	P ⁽⁷⁾	P ⁽⁴⁾	P ⁽⁷⁾
Financial Institutions	-	P	-	-	-	P	P	-	-	P	P
Funeral & Mortuary Services	-	-	-	-	-	P	P	-	P	-	-
Instructional Studios	-	-	-	-	-	-	P ⁽¹⁶⁾	-	-	-	-
Maintenance & Repair	-	-	-	P	P	P	P	-	-	P	P
Off-site Services	-	P	-	P	P	P	P	-	P	P	P
Personal Services	-	-	-	-	-	P ⁽⁹⁾	P ⁽⁹⁾	-	-	-	-
Assembly & Entertainment	-	-	-	-	-	P ^(11,16)	P ⁽¹⁶⁾	-	-	P ^(12,16)	-
Radio & Television Studios	-	P	-	P	P	P	P	-	P	P	P
Visitor Accommodations	-	-	-	-	-	-	-	-	-	-	-
Separately Regulated Commercial Services Uses											
Adult Entertainment Establishments:											
Adult Book Store	-	-	-	-	-	L	L	-	L	L	-
Adult Cabaret	-	-	-	-	-	-	L	-	-	-	-
Adult Drive-in Theater	-	-	-	-	-	L	L	-	-	-	-
Adult Mini-Motion Picture Theater	-	-	-	-	-	L	L	-	-	L	-
Adult Model Studio	-	-	-	-	-	L	L	-	-	-	-
Adult Motel	-	-	-	-	-	-	-	-	-	-	-
Adult Motion Picture Theater	-	-	-	-	-	L	L	-	-	L	-
Adult Peep Show Theater	-	-	-	-	-	L	L	-	-	L	-
Adult Theater	-	-	-	-	-	L	L	-	-	L	-
Body Painting Studio	-	-	-	-	-	L	L	-	-	-	-
Massage Establishment	-	-	-	-	-	-	L	-	-	-	-
Sexual Encounter Establishment	-	-	-	-	-	-	-	-	-	-	-
Bed & Breakfast Establishments:											
1-2 Guest Rooms	-	-	-	-	-	-	-	-	-	-	-
3-5 Guest Rooms	-	-	-	-	-	-	-	-	-	-	-

Use Categories/ Subcategories [See Section 131.0112 for an explanation and descriptions of the Use Categories, Subcategories, and Separately Regulated Uses]	Zone	Zones									
	Designator	IP-			II-			IH-		IS-	IBT-
	1st & 2nd >>	1-	2-	3-	1-	2-	3-	1-	2-	1-	1-
	3rd >>>	1	1	1	1	1	1	1	1	1	1
6+ Guest Rooms		-	-	-	-	-	-	-	-	-	-
Boarding Kennels/Pet Day Care Facilities		-	N	-	N	L	L	N	N	N	N
Camping Parks		-	-	-	-	-	-	-	-	-	-
<i>Child Care Facilities:</i>											
Child Care Centers		L	L	L	-	L	L	-	L	L	L
Large Family Child Care Homes		-	-	L	-	-	-	-	-	-	-
Small Family Child Care Homes		-	-	L	-	-	-	-	-	-	-
Eating and Drinking Establishments Abutting Residentially Zoned Property		-	-	-	-	-	L	-	-	-	-
Fairgrounds		-	C	-	C	C	C	C	C	C	-
Golf Courses, Driving Ranges, and Pitch & Putt Courses		-	C	-	C	C	C	C	C	C	-
Helicopter Landing Facilities		C	C	C	C	C	C	C	C	C	C
Massage Establishments, Specialized Practice		-	-	-	-	-	L	-	-	-	-
<i>Medical Marijuana Consumer Cooperatives</i>		-	-	-	-	-	C	-	-	C	C
Mobile Food Trucks		P	P	P	P	P	P	P	P	P	P
Nightclubs & Bars over 5,000 square feet in size		-	-	-	-	-	-	-	-	-	-
<i>Parking Facilities as a Primary Use:</i>											
Permanent Parking Facilities		C	C	C	P	C	P	P	P	C	C
Temporary Parking Facilities		C	C	C	N	C	N	N	N	C	N
Private Clubs, Lodges and Fraternal Organizations		-	C	-	C	C	C	C	C	C	C
Privately Operated, Outdoor Recreation Facilities over 40,000 square feet in size ⁽¹³⁾		C	C	C	C	C	C	C	C	C	-
<i>Pushcarts:</i>											
Pushcarts on Private Property		L	L	L	L	L	L	L	L	L	L
Pushcarts in Public Right-of-Way		N	N	N	N	N	N	N	N	N	N
<i>Recycling Facilities:</i>											
Large Collection Facility		L	N	L	N	N	N	L	L	N	N
Small Collection Facility		L	L	L	L	L	L	L	L	L	L
Large Construction & Demolition Debris <i>Recycling Facility</i>		-	-	-	N	-	C	C	N	-	C
Small Construction & Demolition Debris <i>Recycling Facility</i>		-	-	-	N	-	C	N	N	-	C
Drop-off Facility		L	L	L	L	L	L	L	L	L	L
Green Materials Composting Facility		-	-	-	N	-	N	N	N	-	N
Mixed Organic Composting Facility		-	-	-	C	-	C	N	N	-	C
Large Processing Facility Accepting at Least 98% of Total Annual Weight of Recyclables from Commercial & Industrial Traffic		-	C	-	L	L	L	L	L	C	L
Large Processing Facility Accepting All Types of Traffic		-	C	-	N	N	N	N	N	C	L

Use Categories/ Subcategories [See Section 131.0112 for an explanation and descriptions of the Use Categories, Subcategories, and Separately Regulated Uses]	Zone Designator	Zones									
	1st & 2nd >>	IP-			IL-			IH-		IS-	IBT-
	3rd >>	1-	2-	3-	1-	2-	3-	1-	2-	1-	1-
	4th >>	1	1	1	1	1	1	1	1	1	1
Small Processing Facility Accepting at Least 98% of Total Annual Weight of Recyclables From Commercial & Industrial Traffic	-	N	-	L	L	L	L	L	N	L	
Small Processing Facility Accepting All Types of Traffic	-	N	-	N	N	N	N	N	N	N	
Reverse Vending Machines	L	L	L	L	L	L	L	L	L	L	
Tire Processing Facility	-	-	-	C	-	C	C	C	-	-	
Sidewalk Cafes	-	L	-	L	L	L	-	L	L	L	
Theaters that are outdoor or over 5,000 square feet in size	-	C	-	-	C	C	-	C	-	-	
Sports Arenas & Stadiums	-	C	-	-	C	C	-	C	-	-	
Urgent Care Facilities	-	L	-	-	L	P	-	L	L	-	
Veterinary Clinics & Animal Hospitals	-	N	-	N	L	L	N	N	N	N	
Zoological Parks	-	-	-	-	-	-	-	-	-	-	
Offices											
Business & Professional	-	P	P	-	P	P	-	-	P	P	
Government	-	P	P	-	P	P	-	P	P	P	
Medical, Dental, & Health Practitioner	-	-	-	-	P	P	-	-	P	P	
Regional & Corporate Headquarters	P ⁽¹⁾	P	P ⁽¹⁾	P ⁽¹⁾	P	P	-	P ⁽¹⁴⁾	P	P ⁽¹⁾	
Separately Regulated Office Uses											
Real Estate Sales Offices & Model Homes	-	-	-	-	-	-	-	-	-	-	
<i>Sex Offender Treatment and Counseling Facilities</i>	-	L	-	-	L	L	-	-	L	-	
Vehicle & Vehicular Equipment Sales & Service											
Commercial Vehicle Repair & Maintenance	-	-	-	P	P	P	P	P	P	P	
Commercial Vehicle Sales & Rentals	-	-	-	P	P	P	P	P	P	-	
Personal Vehicle Repair & Maintenance	-	-	-	P	P	P	-	-	P	-	
Personal Vehicle Sales & Rentals	-	-	-	P	P	P	-	P	P	-	
Vehicle Equipment & Supplies Sales & Rentals	-	-	-	P	-	P	P	P	P	-	
Separately Regulated Vehicle & Vehicular Equipment Sales & Service Uses											
Automobile Service Stations	L	L	L	L	L	L	L	L	L	C	
Outdoor Storage & Display of New, Unregistered Motor Vehicles as a <i>primary use</i>	-	-	-	P	P	P	P	P	P	P	
Wholesale, Distribution, Storage											
Equipment & Materials Storage Yards	-	-	-	P	P	P	P	P	P	P	
Moving & Storage Facilities	-	-	-	P	P	P	P	P	P	-	
Warehouses	-	-	-	P	P	P	P	P	P	P	
Wholesale Distribution	-	P	-	P	P	P	P	P	P	P	
Separately Regulated Wholesale, Distribution, and Storage Uses											

Use Categories/ Subcategories [See Section 131.0112 for an explanation and descriptions of the Use Categories, Subcategories, and Separately Regulated Uses]	Zone Designator	Zones									
	1st & 2nd >>	IP-			IL-			IH-		IS-	IBT-
	3rd >>	1-	2-	3-	1-	2-	3-	1-	2-	1-	1-
	4th >>	1	1	1	1	1	1	1	1	1	1
Impound Storage Yards	-	-	-	P	P	P	P	P	P	P	-
Junk Yards	-	-	-	C	C	C	C	C	C	C	-
Temporary Construction Storage Yards Located off-site	L	L	L	L	L	L	L	L	L	L	L
Industrial											
Heavy Manufacturing	-	-	-	-	-	-	P	P	-	-	-
Light Manufacturing	P ⁽¹⁰⁾	P	P ⁽¹⁰⁾	P	P	P	P	P	P	P	P
Marine Industry	-	-	-	P	P	P	P	P	P	P	P
Research & Development	P	P	P	P	P	P	P	P	P	P	P
Trucking & Transportation Terminals	-	-	-	P	-	P	P	P	P	P	P
Separately Regulated Industrial Uses											
Hazardous Waste Research Facility	C	C	C	C	C	C	C	C	C	C	C
Hazardous Waste Treatment Facility	C	C	C	C	C	C	C	C	C	C	-
Marine Related Uses Within the Coastal Overlay Zone	-	-	-	P	P	P	P	P	P	P	P
Mining and Extractive Industries	-	C	-	C	C	C	C	C	C	C	-
Newspaper Publishing Plants	C	P	C	P	P	P	P	P	P	P	P
Processing & Packaging of Plant Products & Animal By-products Grown Off-premises	-	-	-	P	P	P	P	P	P	P	P
Very Heavy Industrial Uses	-	-	-	-	-	-	C	C	-	-	-
Wrecking & Dismantling of Motor Vehicles	-	-	-	C	C	C	P	C	C	C	-
Signs											
Allowable Signs	P	P	P	P	P	P	P	P	P	P	P
Separately Regulated Signs Uses											
Community Entry Signs	L	L	L	L	L	L	L	L	L	L	L
Neighborhood Identification Signs	-	-	-	-	-	-	-	-	-	-	-
Comprehensive Sign Program	N	N	N	N	N	N	N	N	N	N	N
Revolving Projecting Signs	N	N	N	N	N	N	N	N	N	N	N
Signs with Automatic Changing Copy	N	N	N	N	N	N	N	N	N	N	N
Theater Marquees	-	-	-	-	N	N	-	-	-	-	-

Footnotes for Table 131-06B

1 through 16 [No change in text.]

17 See Section 131.0623(i).

§131.0623 Additional Use Regulations of Industrial Zones

The additional use regulations identified in this section are applicable to uses where indicated in Table 131-06B.

(a) through (d) [No change in text.]

(e) Light manufacturing and assembly uses in the IP-1-1 and the IP-3-1 zones are limited to the following:

(1) through (7) [No change in text.]

(f) through (i) [No change in text.]

(j) Residential uses in the IP-3-1 zone are permitted subject to the following:

(A) Residential *development* is permitted in accordance with the Business Park - Residential Permitted CPIOZ of the applicable community plan;

(B) Residential *development* comprises no more than 49 percent of the total *lot* area within the Business Park - Residential Permitted CPIOZ; and

(C) Residential *development* complies with the *development* regulations of the residential zone identified in the Business Park - Residential Permitted CPIOZ of the applicable community plan, except that the *lot* area, *lot* dimensions, *floor area ratio*, and *setback* requirements of the IP-3-1 zone shall apply.

§131.0631 Development Regulations Table for Industrial Zones

The following development regulations apply in the industrial zones as shown in Table 131-06C.

Table 131-06C
Development Regulations for Industrial Zones

Development Regulations [See Section 131.0630 for Development Regulations of Industrial Zones]	Zone Designator	Zones									
	1st & 2nd >>	IP-			IL-			IH-		IS-	IBT-
	3rd >>	1-	2-	3-	1-	2-	3-	1-	2-	1-	1-
4th >>	1	1			1			1	1	1	
Max permitted residential density ⁽¹⁰⁾		1,000	-	-	-	-	-	-	-	-	
Supplemental residential regulations [see Section 131.0623(i)]		applies	-	-	-	-	-	-	-	-	
Lot Area											
Min Lot Area (sf)		40,000	15,000 ⁽¹⁾			30,000		10,000	40,000		
Max Lot Area (sf)		-	-			-		15,000	-		
Min Lot Dimensions											
Lot Width (ft)		100	75			100		50	100		
Street Frontage (ft)		100 ⁽²⁾	75			100		50	100 ⁽²⁾		
Lot Depth (ft)		200	100			150		100	200		
Setback Requirements											
Min Front Setback (ft)		20 ⁽³⁾	15 ⁽³⁾			20 ⁽³⁾		10	20 ⁽³⁾		
Std Front Setback (ft) [See Section 131.0643(b)]		25 ⁽³⁾	20 ⁽³⁾			25 ⁽³⁾			25 ⁽³⁾		
Min Side Setback (ft)		15	10			15		5/0 ⁽⁸⁾	15		
Min Street Side Setback (ft) Std Street Side Setback (ft)		20 ⁽⁴⁾	15 ^{(4),(5)} 20 ^{(4),(5)}			20 ^{(4),(5)} 25 ^{(4),(5)}		10 ⁽⁹⁾	20 ⁽⁴⁾		
Min Side Setback Abutting Residential (ft)		30	25			30		10	30		
Min Rear Setback (ft) Std Rear Setback (ft)		25	0 ⁽⁶⁾ 15 ⁽⁶⁾			20		10	25		
Min Rear Setback Abutting Residential (ft)		50	25			30		15	50		
Max Structure Height [See Section 131.0644]		-	-			-		-	-		
Max Floor Area Ratio		2.0 ⁽⁷⁾⁽¹¹⁾	2.0 ⁽⁷⁾⁽¹¹⁾			2.0 ⁽¹¹⁾		2.0 ⁽¹¹⁾	2.0 ⁽⁷⁾⁽¹¹⁾		
Street Wall Requirements [See Section 142.1030]		-	applies			applies		-	-		
Outdoor Amenities [See Section 131.0665]		applies	applies			applies		-	applies		
Refuse and Recyclable Material Storage [See Section 142.0805]		applies	applies			applies		applies	applies		
Loading Dock and Overhead Door Screening Regulations [See Section 142.1030]		applies	applies			applies		applies	applies		

Footnotes for Table 131-06C

1 through 9 [No change in text.]

10 One dwelling unit per specified minimum square feet of lot area as determined in accordance with Section 113.0222.

11 Within the Otay Mesa Community Plan area, the maximum floor area ratio is 0.50 unless a final map has been recorded prior to [INSERT the effective date of this ordinance]. This restriction does not apply to residential development in accordance with Section 131.0623(i).

§131.0643 **Setback Requirements in Industrial Zones**

- (a) *Front Setback* in the IP, IL, IH, and IBT Zones. Up to 50 percent of the length of the *building facade* may observe the minimum *front setback* provided the remaining percentage observes the standard *front setback*. This may occur on a floor-by-floor basis. See Diagram 131-06A.

Diagram 131-06A

Front Setback in the IP, IL, and IH Zones

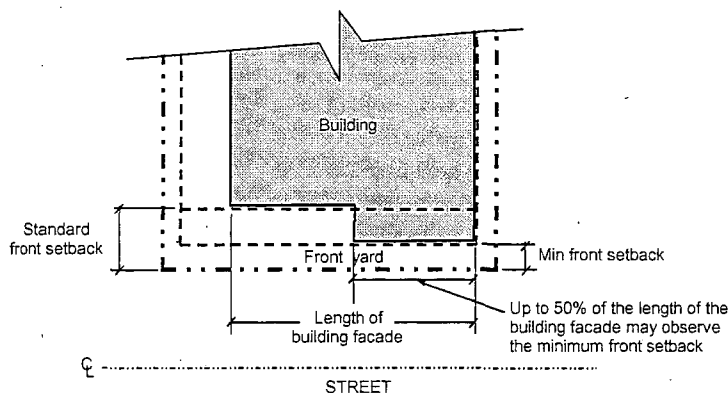

- (b) [No change in text.]
- (c) *Parking Encroachment* in Street Side Yard of IP, IL, IH, and IBT Zones. Parking may encroach up to 5 feet into the required standard street side yard of the IP, IL, and IH zones, but may not be covered or enclosed.
- (d) [No change in text.]
- (e) *Standard/Minimum Street Side Setback* in the IL, IH, and IBT Zones. Up to 50 percent of the length of the *street side building facade* may observe the minimum *street side setback* provided the remaining percentage observes the standard *street side setback*. This may occur on a floor-by-floor basis.

(f) through (g) [No change in text.]

§131.0665 Outdoor Amenities in Industrial Zones

In the IP, IL, IH, and IBT zones, *development* on a *premises* that exceeds 10 acres in area shall include an outdoor eating and/or recreational facility. The outdoor amenity shall be at least 2,000 square feet in total area and shall be developed as usable space.

Section 3. That Chapter 13, Article 2, Division 14 of the San Diego Municipal Code is amended by amending section 132.01402, retitling Diagram 132-14A from College Area Community Plan Implementation Overlay Zone to Clairemont Mesa Community Plan Implementation Overlay Zone, deleting Diagram 132-14B titled College Area Community Plan Implementation Overlay Zone, and adding a new Diagram 132-14B titled Otay Mesa Community Plan Implementation Overlay Zone, to read as follows:

§132.1402 Where the Community Plan Implementation Overlay Zone Applies

- (a) This overlay zone applies to properties that are identified in a community plan as areas requiring supplemental development regulations or processing of a *development permit* and that have been incorporated by ordinance into this overlay zone. Table 132-14A lists the community plan areas in which this overlay zone has been applied and the corresponding rezone maps that indicate which properties are within the boundaries of the overlay zone. These maps are filed in the office of the City Clerk. The properties within this overlay zone are shown generally on Diagrams 132-14A through 132-14M.

Table 132-14A

Community Plans with Property in the Community Plan Implementation Overlay Zone

Community Plan	Map Number Showing Boundaries of CPIOZ Area
Clairemont Mesa (See Diagram 132-14A)	C-771.1, B-3951
Linda Vista (See Diagram 132-14C)	C-750
Midway/Pacific Highway Corridor (See Diagram 132-14D)	C-782
Navajo (See Diagram 132-14E)	C-954
Otay Mesa (See Diagram 132-14B)	C-956, B-4300
Pacific Beach (See Diagram 132-14F)	B-37371, B-3857
Peninsula (See Diagram 132-14G)	C-744, C-781
Rancho Bernardo (See Diagram 132-14H)	C-773.1
Rancho Penasquitos (See Diagram 132-14I)	B-4025
Skyline Paradise Hills (See Diagram 132-14L)	B-4272
Southeastern San Diego (See Diagram 132-14M)	B-4272
University (See Diagram 132-14J)	C-725, C-751.2
Uptown (See Diagram 132-14K)	C-780.2

(b) [No change in text.]

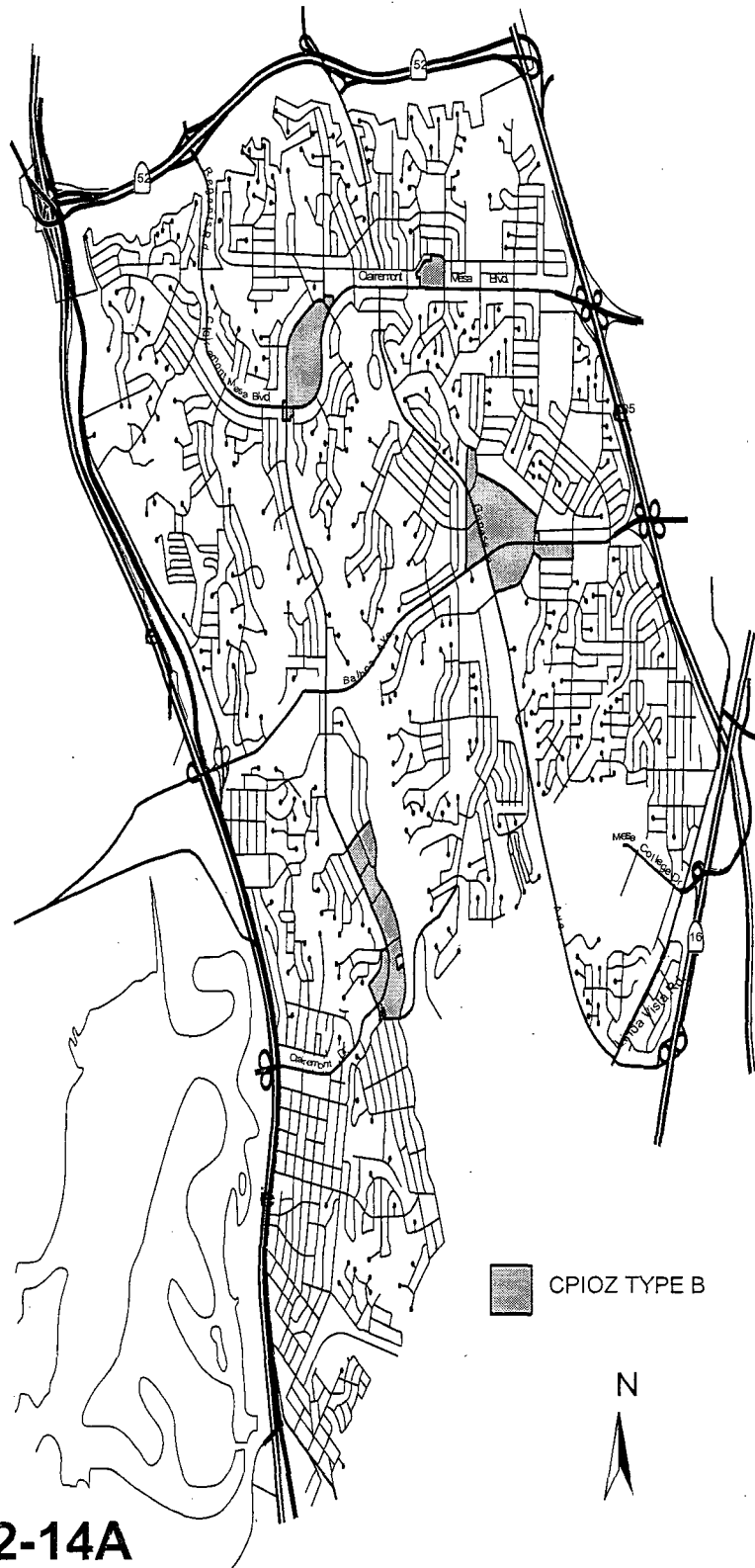

DIAGRAM 132-14A

Clairemont Mesa Community Plan Implementation Overlay Zone

This is a reproduction of Map Nos. C-771.1 & B-3951 for illustration purposes only.

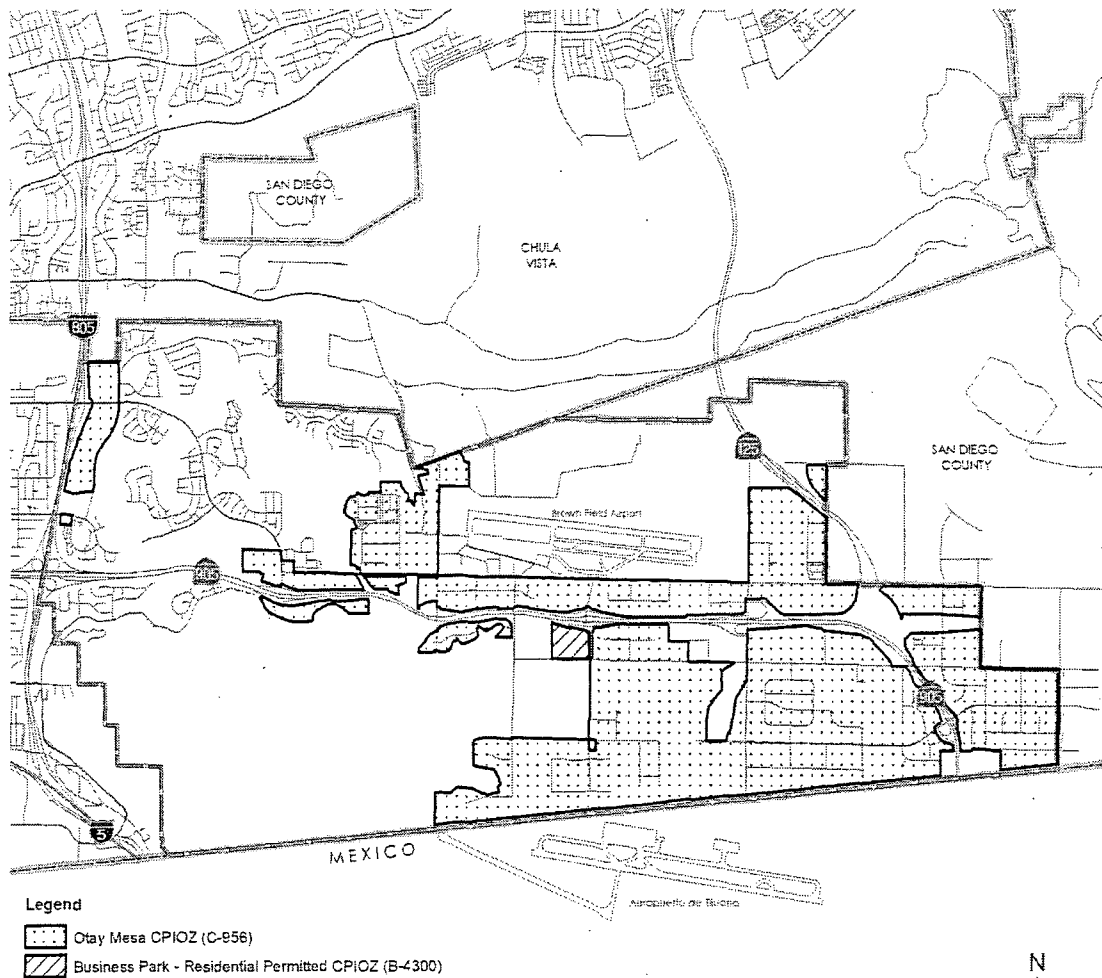

DIAGRAM 132-14B

Otay Mesa Community Plan Implementation Overlay Zone

This is a reproduction of Map Nos. B-4300 & C-956 for illustration purposes only.

Section 4. That Chapter 14, Article 2, Division 5 of the San Diego Municipal Code is amended by amending section 142.0530, to read as follows:

§142.0530 Nonresidential Uses — Parking Ratios

- (a) Retail Sales, Commercial Services, and Mixed-Use Development. Table 142-05E establishes the ratio of required parking spaces to building *floor* area in the commercial zones, industrial zones, and planned districts shown, for retail sales uses and for those commercial service uses that are not covered by Table 142-05F or 142-05G. Table 142-05E also establishes the required parking ratios for mixed-use developments in a single *structure* that include an allowed use from at least two of the following use categories: (1) retail sales, (2) commercial services, and (3) offices.

Table 142-05E
Parking Ratios for Retail Sales, Commercial Services, and Mixed-Use Development

Zone	Parking Spaces Required per 1,000 Square Feet of <i>Floor Area</i> Unless Otherwise Noted (<i>Floor Area</i> Includes <i>Gross Floor Area</i> plus below <i>Grade Floor Area</i> and Excludes <i>Floor Area</i> Devoted to Parking)		
	Required Automobile Parking Spaces ⁽¹⁾		
	Minimum Required Outside a <i>Transit Area</i>	Minimum Required Within a <i>Transit Area</i> ⁽²⁾	Maximum Permitted
Commercial Zones [No change in text.]			
Industrial Zones			
IH-1-1 through IS-1-1	[No change in text.]		
IBT-1-1	5.0	4.3	6.5
Planned Districts			
Carmel Valley through Mission Valley: Except CV	[No change in text.]		
Old Town through West Lewis Street	[No change in text.]		

Footnotes For Table 142-05E [No change in text.]

- (b) Eating and Drinking Establishments. Table 142-05F establishes the required ratio of parking spaces to building *floor area* in the commercial zones, industrial zones, and planned districts shown, for eating and drinking establishments that are the *primary use* on a *premises*.

Table 142-05F
Parking Ratios for Eating and Drinking Establishments

Zone	Parking Spaces Required per 1,000 Square Feet of Eating and Drinking Establishment ⁽¹⁾ Floor Area Unless Otherwise Noted (Floor Area Includes Gross Floor Area plus below Grade Floor Area and Excludes Floor Area Devoted to Parking)		
	Required Automobile Parking Spaces ⁽²⁾		
	Minimum Required Outside a Transit Area	Minimum Required Within a Transit Area ⁽³⁾	Maximum Permitted
Commercial Zones	[No change in text.]		
Industrial Zones			
IH-1-1 through IS-1-1	[No change in text.]		
IBT-1-1	15.0	12.8	25.0
Planned Districts			
Carmel Valley through Mission Valley: Except CV	[No change in text.]		
Old Town through West Lewis Street	[No change in text.]		

Footnotes For Table 142-05F [No change in text.]

Section 5. That Chapter 15, Article 17, Division 1 of the San Diego Municipal Code is amended by repealing sections 1517.0101, 1517.0102, 1517.0103, and 1517.0104; Chapter 15, Article 17, Division 2 is amended by repealing sections 1517.0201, 1517.0202, 1517.0203, 1517.0204, and 1517.0205; Chapter 15, Article 17, Division 3 is amended by repealing sections 1517.0301, 1517.0302, 1517.0303, 1517.0304, 1517.0305, and 1517.0306; Chapter 15, Article 17, Division 4 is amended by repealing sections 1517.0401, 1517.0402, 1517.0403, and 1517.0404.

Section 6. That a full reading of this ordinance is dispensed with prior to its passage, a written or printed copy having been made available to the City Council and the public prior to the day of its passage.

Section 7. That prior to becoming effective, this ordinance shall be submitted to the San Diego County Regional Airport Authority (SDCRAA) for a consistency determination.

That if the SDCRAA finds this ordinance consistent with the Airport Land Use Compatibility Plans (ALUCP) for San Diego International Airport, Marine Corps Air Station (MCAS) Miramar, Gillespie Field, Montgomery Field, and Brown Field Airports (collectively, Airports), this ordinance shall take effect and be in force on the thirtieth day from and after the finding of consistency, except that the provisions of this ordinance inside the Coastal Overlay Zone, which are subject to California Coastal Commission jurisdiction as a City of San Diego Local Coastal Program amendment shall not take effect until the date the California Coastal Commission unconditionally certifies those provisions as a local coastal program amendment.

That if the SDCRAA determines that this ordinance is inconsistent or conditionally consistent, subject to proposed modifications, with the ALUCPs for the Airports, the ordinance shall be submitted to the City Council for reconsideration.

That if the SDCRAA determines that this ordinance is conditionally consistent with the ALUCPs for the Airports, but that consistency is subject to proposed modifications, the City Council may amend this ordinance to accept the proposed modifications, and this ordinance as amended shall take effect and be in force on the thirtieth day from and after its final passage, except that the provisions of this ordinance as amended inside the Coastal Overlay Zone, which are subject to California Coastal Commission jurisdiction as a City of San Diego Local Coastal

Program amendment shall not take effect until the date the California Coastal Commission unconditionally certifies those provisions as a local coastal program amendment.

That a proposed decision by the City Council to overrule a determination of inconsistency or to reject the proposed modifications for a finding of conditional consistency shall include the findings required pursuant to Public Utilities Code section 21670 and require a two-thirds vote; the proposed decision and findings shall be forwarded to the SDCRAA, California Department of Transportation, Division of Aeronautics, and the airport operators for the Airports; and the City Council shall hold a second hearing not less than 45 days from the date the proposed decision and findings were provided, at which hearing any comments submitted by the public agencies shall be considered and any a final decision to overrule a determination of inconsistency shall require a two-thirds vote.

Section 8. That no permits shall be issued for development that is inconsistent with the provisions of this ordinance unless complete applications for such permits are submitted to the City prior to the date on which the applicable provisions of this ordinance become effective, which date is determined in accordance with Section 6, above.

Section 9. That if Ordinance No. O-20312, available for review at the Office of the City Clerk, which amended the San Diego Municipal Code relating to the Barrio Logan Community Plan Update, and which will be, at the time of this Ordinance's anticipated effective date, suspended, is made effective upon a vote of the People at the Citywide Primary Election to be

held on June 3, 2014, the City Clerk shall publish those code amendments, notwithstanding that those amendments are not reflected in this Ordinance.

APPROVED: JAN I. GOLDSMITH, City Attorney

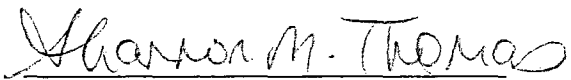
By 
Shannon M. Thomas
Deputy City Attorney

SMT:als
02/19/14
09/11/14 Cor.Copy
09/23/14 Cor.Copy.1
Or.Dept:DSD
Doc. No. 682164_4

I hereby certify that the foregoing Ordinance was passed by the Council of the City of San Diego, at this meeting of _____.

ELIZABETH S. MALAND
City Clerk

By _____
Deputy City Clerk

Approved: _____
(date)

KEVIN L. FAULCONER, Mayor

Vetoed: _____
(date)

KEVIN L. FAULCONER, Mayor

(See attached memo and signature page.)

Use Categories/ Subcategories [See Section 131.0112 for an explanation and descriptions of the Use Categories, Subcategories, and Separately Regulated Uses]	Zone Designator	Zones									
	1st & 2nd >>	IP-			IL-			IH-		IS-	IBT-
	3rd >>	1-	2-	3-	1-	2-	3-	1-	2-	1-	1-
	4th >>	1	1	1	1	1	1	1	1	1	1
Separately Regulated Agriculture Uses											
Agricultural Equipment Repair Shops	-	-	-	P	P	P	P	P	P	P	-
Commercial Stables	-	-	-	-	-	-	-	-	-	-	-
Community Gardens	-	-	-	N	N	N	N	N	N	N	-
Equestrian Show & Exhibition Facilities	-	-	-	-	-	-	-	-	-	-	-
Open Air Markets for the Sale of Agriculture- related Products & Flowers	-	-	-	-	-	-	-	-	-	-	-
Residential											
<i>Mobilehome Parks</i>	-	-	-	-	-	-	-	-	-	-	-
<i>Multiple Dwelling Units</i>	-	-	P ⁽¹⁷⁾	-	-	-	-	-	-	-	-
<i>Rooming House</i> [See Section 131.0112(a)(3)(A)]	-	-	-	-	-	-	-	-	-	-	-
<i>Single Dwelling Units</i>	-	-	-	-	-	-	-	-	-	-	-
Separately Regulated Residential Uses											
<i>Boarder & Lodger Accommodations</i>	-	-	-	-	-	-	-	-	-	-	-
Companion Units	-	-	-	-	-	-	-	-	-	-	-
Employee Housing:											
6 or Fewer Employees	-	-	-	-	-	-	-	-	-	-	-
12 or Fewer Employees	-	-	-	-	-	-	-	-	-	-	-
Greater than 12 Employees	-	-	-	-	-	-	-	-	-	-	-
Fraternities, Sororities and Student Dormitories	-	-	-	-	-	-	-	-	-	-	-
Garage, Yard, & Estate Sales	-	-	-	-	-	-	-	-	-	-	-
Guest Quarters	-	-	-	-	-	-	-	-	-	-	-
Home Occupations	-	-	L	-	-	-	-	-	-	-	-
Housing for Senior Citizens	-	-	L	-	-	-	-	-	-	-	-
Live/Work Quarters	-	-	-	-	-	-	-	-	-	L	-
Residential Care Facilities:											
6 or Fewer Persons	-	-	L	-	-	-	-	-	-	-	-
7 or More Persons	-	-	L	-	-	-	-	-	-	-	-
Transitional Housing:											
6 or Fewer Persons	-	-	L	-	-	-	-	-	-	-	-
7 or More Persons	-	-	C	-	-	-	-	-	-	-	-
Watchkeeper Quarters	L	L	L	L	L	L	L	L	L	L	L
Institutional											
<i>Churches & Places of Religious Assembly</i>	-	-	-	-	P ^(11,16)	P ⁽¹⁶⁾	-	-	-	P ^(12,16)	-
Separately Regulated Institutional Uses											
Airports	C	C	C	C	C	C	C	C	C	C	C
Botanical Gardens & Arboretums	-	-	-	-	-	-	-	-	-	-	-
Cemeteries, Mausoleums, Crematories	C	C	C	C	C	C	C	C	C	C	-
Correctional Placement Centers	C	C	C	C	C	C	C	C	C	C	-
Educational Facilities:											
Kindergarten through Grade 12	-	C	-	-	C	C	-	-	C	C	-
Colleges / Universities	C	C	C	-	C	C	-	C	C	C	C
Vocational / Trade School	-	-	-	-	L	L	-	L	L	L	L

Use Categories/ Subcategories [See Section 131.0112 for an explanation and descriptions of the Use Categories, Subcategories, and Separately Regulated Uses]	Zone	Zones									
	Designator	IP-			IL-			IH-		IS-	IBT-
	1st & 2nd >>	1-	2-	3-	1-	2-	3-	1-	2-	1-	1-
	3rd >>>	1-	2-	3-	1-	2-	3-	1-	2-	1-	1-
4th >>>	1	1	1	1	1	1	1	1	1	1	
Energy Generation & Distribution Facilities	C	C	C	P	C	P	P	P	C	-	
Exhibit Halls & Convention Facilities	-	C	-	C	C	C	C	C	C	C	
Flood Control Facilities	L	L	L	L	L	L	L	L	L	L	
Historical Buildings Used for Purposes Not Otherwise Allowed	C	C	C	C	C	C	C	C	C	C	
Homeless Facilities:											
Congregate Meal Facilities	-	C	-	-	C	C	-	C	C	-	
Emergency Shelters	-	C	-	-	C	C	-	C	C	-	
Homeless Day Centers	-	C	-	-	C	C	-	C	C	-	
Hospitals, Intermediate Care Facilities & Nursing Facilities	C	C	C	-	C	C	-	C	C	-	
Interpretive Centers	-	-	-	-	-	-	-	-	-	-	
Museums	-	-	-	-	-	-	-	-	-	-	
Major Transmission, Relay, or Communications Switching Stations	C	C	C	C	C	C	P	C	C	C	
Satellite Antennas	L	L	L	L	L	L	L	L	L	L	
Social Service Institutions	C	C	C	C	C	C	-	-	C	-	
Wireless communication facility:											
Wireless communication facility in the public right-of-way with subterranean equipment adjacent to a non-residential use	L	L	L	L	L	L	L	L	L	L	
Wireless communication facility in the public right-of-way with subterranean equipment adjacent to a residential use	N	N	N	N	N	N	N	N	N	N	
Wireless communication facility in the public right-of-way with above ground equipment	C	C	C	C	C	C	C	C	C	C	
Wireless communication facility outside the public right-of-way	L	L	L	L	L	L	L	L	L	L	
Retail Sales											
Building Supplies & Equipment	-	-	-	P ^(6,15)	P ⁽¹⁵⁾	P ⁽¹⁵⁾	-	P ^(6,15)	P ⁽¹⁵⁾	-	
Food, Beverages and Groceries	-	-	-	-	-	P ⁽¹⁵⁾	-	-	-	-	
Consumer Goods, Furniture, Appliances, Equipment	-	-	-	-	P ^(2,15)	P ⁽¹⁵⁾	-	-	P ^(3,15)	-	
Pets & Pet Supplies	-	-	-	-	-	P ⁽¹⁵⁾	-	-	-	-	
Sundries, Pharmaceuticals, & Convenience Sales	-	P ^(5,15)	P ^(5,15)	P ^(5,15)	P ^(5,15)	P ⁽¹⁵⁾	P ^(5,15)	P ^(5,15)	P ^(4,15)	-	
Wearing Apparel & Accessories	-	-	-	-	P ^(3,15)	P ^(3,15)	-	-	P ^(3,15)	-	
Separately Regulated Retail Sales Uses											
Agriculture Related Supplies & Equipment	-	-	-	-	P	P	P	P	P	-	
Alcoholic Beverage Outlets	-	-	-	-	-	L	-	-	-	-	
Farmers' Markets											
Weekly Farmers' Market	-	-	-	-	-	L	-	-	-	-	
Daily Farmers' Market Stands	-	-	-	-	-	L	-	-	-	-	
Plant Nurseries	-	-	-	-	-	P	-	P	P	-	

Use Categories/ Subcategories [See Section 131.0112 for an explanation and descriptions of the Use Categories, Subcategories, and Separately Regulated Uses]	Zone Designator	Zones									
	1st & 2nd >>	IP-			IL-			IH-		IS-	IBT-
	3rd >>	1-	2-	3-	1-	2-	3-	1-	2-	1-	1-
	4th >>	1	1	1	1	1	1	1	1	1	1
Retail Farms		-	-	-	-	-	L	-	-	-	-
Swap Meets & Other Large Outdoor Retail Facilities		-	-	-	C	C	C	C	C	C	-
Commercial Services											
Building Services		-	-	-	P	P	P	-	P	P	P
Business Support		-	P ⁽⁸⁾	P ⁽⁸⁾	P ⁽⁸⁾	P	P	-	P ⁽⁸⁾	P	P ⁽⁸⁾
Eating & Drinking Establishments		-	P ⁽⁷⁾	P ⁽⁷⁾	P ⁽⁷⁾	P ⁽⁷⁾	P	-	P ⁽⁷⁾	P ⁽⁴⁾	P ⁽⁷⁾
Financial Institutions		-	P	-	-	P	P	-	-	P	P
Funeral & Mortuary Services		-	-	-	-	P	P	-	P	-	-
Instructional Studios		-	-	-	-	-	P ⁽¹⁶⁾	-	-	-	-
Maintenance & Repair		-	-	-	P	P	P	-	-	P	P
Off-site Services		-	P	-	P	P	P	-	P	P	P
Personal Services		-	-	-	-	P ⁽⁹⁾	P ⁽⁹⁾	-	-	-	-
Assembly & Entertainment		-	-	-	-	P ^(11,16)	P ⁽¹⁶⁾	-	-	P ^(12,16)	-
Radio & Television Studios		-	P	-	P	P	P	-	P	P	P
Visitor Accommodations		-	-	-	-	-	-	-	-	-	-
Separately Regulated Commercial Services Uses											
Adult Entertainment Establishments:											
Adult Book Store		-	-	-	-	L	L	-	L	L	-
Adult Cabaret		-	-	-	-	-	L	-	-	-	-
Adult Drive-in Theater		-	-	-	-	L	L	-	-	-	-
Adult Mini-Motion Picture Theater		-	-	-	-	L	L	-	-	L	-
Adult Model Studio		-	-	-	-	L	L	-	-	-	-
Adult Motel		-	-	-	-	-	-	-	-	-	-
Adult Motion Picture Theater		-	-	-	-	L	L	-	-	L	-
Adult Peep Show Theater		-	-	-	-	L	L	-	-	L	-
Adult Theater		-	-	-	-	L	L	-	-	L	-
Body Painting Studio		-	-	-	-	L	L	-	-	-	-
Massage Establishment		-	-	-	-	-	L	-	-	-	-
Sexual Encounter Establishment		-	-	-	-	-	-	-	-	-	-
Bed & Breakfast Establishments:											
1-2 Guest Rooms		-	-	-	-	-	-	-	-	-	-
3-5 Guest Rooms		-	-	-	-	-	-	-	-	-	-
6+ Guest Rooms		-	-	-	-	-	-	-	-	-	-
Boarding Kennels/Pet Day Care Facilities		-	N	-	N	L	L	N	N	N	N
Camping Parks		-	-	-	-	-	-	-	-	-	-
Child Care Facilities:											
Child Care Centers		L	L	L	-	L	L	-	L	L	L
Large Family Child Care Homes		-	-	L	-	-	-	-	-	-	-
Small Family Child Care Homes		-	-	L	-	-	-	-	-	-	-
Eating and Drinking Establishments Abutting Residentially Zoned Property		-	-	-	-	-	L	-	-	-	-
Fairgrounds		-	C	-	C	C	C	C	C	C	-

Use Categories/ Subcategories [See Section 131.0112 for an explanation and descriptions of the Use Categories, Subcategories, and Separately Regulated Uses]	Zone	Zones									
	Designator	IP-			IL-			IH-		IS-	IBT-
	1st & 2nd >>	1-	2-	3-	1-	2-	3-	1-	2-	1-	1-
	3rd >>>	1	1	1	1	1	1	1	1	1	1
4th >>>	1	1	1	1	1	1	1	1	1	1	
Golf Courses, Driving Ranges, and Pitch & Putt Courses	-	C	-	C	C	C	C	C	C	C	-
Helicopter Landing Facilities	C	C	C	C	C	C	C	C	C	C	C
Massage Establishments, Specialized Practice	-	-	-	-	-	-	L	-	-	-	-
Medical Marijuana Consumer Cooperatives	-	-	-	-	-	-	C	-	-	C	C
Mobile Food Trucks	P	P	P	P	P	P	P	P	P	P	P
Nightclubs & Bars over 5,000 square feet in size	-	-	-	-	-	-	-	-	-	-	-
Parking Facilities as a <i>Primary Use</i> :											
Permanent Parking Facilities	C	C	C	P	C	P	P	P	P	C	C
Temporary Parking Facilities	C	C	C	N	C	N	N	N	N	C	N
Private Clubs, Lodges and Fraternal Organizations	-	C	-	C	C	C	C	C	C	C	C
Privately Operated, Outdoor Recreation Facilities over 40,000 square feet in size ⁽¹³⁾	C	C	C	C	C	C	C	C	C	C	-
Pushcarts:											
Pushcarts on Private Property	L	L	L	L	L	L	L	L	L	L	L
Pushcarts in Public Right-of-Way	N	N	N	N	N	N	N	N	N	N	N
Recycling Facilities:											
Large Collection Facility	L	N	L	N	N	N	N	L	L	N	N
Small Collection Facility	L	L	L	L	L	L	L	L	L	L	L
Large Construction & Demolition Debris Recycling Facility	-	-	-	N	-	C	C	N	-	-	C
Small Construction & Demolition Debris Recycling Facility	-	-	-	N	-	C	N	N	-	-	C
Drop-off Facility	L	L	L	L	L	L	L	L	L	L	L
Green Materials Composting Facility	-	-	-	N	-	N	N	N	N	-	N
Mixed Organic Composting Facility	-	-	-	C	-	C	N	N	-	-	C
Large Processing Facility Accepting at Least 98% of Total Annual Weight of Recyclables from Commercial & Industrial Traffic	-	C	-	L	L	L	L	L	L	C	L
Large Processing Facility Accepting All Types of Traffic	-	C	-	N	N	N	N	N	N	C	L
Small Processing Facility Accepting at Least 98% of Total Annual Weight of Recyclables From Commercial & Industrial Traffic	-	N	-	L	L	L	L	L	L	N	L
Small Processing Facility Accepting All Types of Traffic	-	N	-	N	N	N	N	N	N	N	N
Reverse Vending Machines	L	L	L	L	L	L	L	L	L	L	L
Tire Processing Facility	-	-	-	C	-	C	C	C	C	-	-
Sidewalk Cafes	-	L	-	L	L	L	-	L	L	L	L
Theaters that are outdoor or over 5,000 square feet in size	-	C	-	-	C	C	-	C	-	-	-
Sports Arenas & Stadiums	-	C	-	-	C	C	-	C	-	-	-

Use Categories/ Subcategories [See Section 131.0112 for an explanation and descriptions of the Use Categories, Subcategories, and Separately Regulated Uses]	Zone	Zones									
	Designator	IP-			IL-			IH-		IS-	IBT-
	1st & 2nd>>	1-	2-	3-	1-	2-	3-	1-	2-	1-	1-
	3rd >>>	1	1	1	1	1	1	1	1	1	1
4th >>>	1	1	1	1	1	1	1	1	1	1	
Mining and Extractive Industries	-	C	-	C	C	C	C	C	C	C	-
Newspaper Publishing Plants	C	P	C	P	P	P	P	P	P	P	P
Processing & Packaging of Plant Products & Animal By-products Grown Off-premises	-	-	-	P	P	P	P	P	P	P	P
Very Heavy Industrial Uses	-	-	-	-	-	-	C	C	-	-	-
Wrecking & Dismantling of Motor Vehicles	-	-	-	C	C	C	P	C	C	C	-
Signs											
Allowable Signs	P	P	P	P	P	P	P	P	P	P	P
Separately Regulated Signs Uses											
Community Entry Signs	L	L	L	L	L	L	L	L	L	L	L
Neighborhood Identification Signs	-	-	-	-	-	-	-	-	-	-	-
Comprehensive Sign Program	N	N	N	N	N	N	N	N	N	N	N
Revolving Projecting Signs	N	N	N	N	N	N	N	N	N	N	N
Signs with Automatic Changing Copy	N	N	N	N	N	N	N	N	N	N	N
Theater Marquees	-	-	-	-	N	N	-	-	-	-	-

Footnotes for Table 131-06B

1 through 16 [No change in text.]

17 See Section 131.0623(i).

SMT:als

Doc. No. 867828

I hereby certify that the foregoing Ordinance was passed by the Council of the City of San Diego, at this meeting of ~~MAR 25 2014~~.

ELIZABETH S. MALAND
City Clerk

By Karin Cushe
Deputy City Clerk

Approved: 4/10/14
(date)

KEVIN L. FAULCONER, Mayor

Vetoed: _____
(date)

KEVIN L. FAULCONER, Mayor

STRIKEOUT ORDINANCE

OLD LANGUAGE: ~~Struck-Out~~

NEW LANGUAGE: Double Underline

ORDINANCE NUMBER O- _____ (NEW SERIES)

DATE OF FINAL PASSAGE _____

AN ORDINANCE AMENDING CHAPTER 13, ARTICLE 1, DIVISION 5 OF THE SAN DIEGO MUNICIPAL CODE BY AMENDING SECTION 131.0531; AMENDING CHAPTER 13, ARTICLE 1, DIVISION 6 BY AMENDING SECTIONS 131.0602, 131.0622, 131.0623, 131.0631, 131.0643, AND 131.0665 AND ADDING SECTION 131.0606; AMENDING CHAPTER 13, ARTICLE 2, DIVISION 14 BY AMENDING SECTION 132.1402, RETITLING DIAGRAM 132-14A FROM COLLEGE AREA COMMUNITY PLAN IMPLEMENTATION OVERLAY ZONE TO CLAIREMONT MESA COMMUNITY PLAN IMPLEMENTATION OVERLAY ZONE, DELETING DIAGRAM 132-14B TITLED COLLEGE AREA COMMUNITY PLAN IMPLEMENTATION OVERLAY ZONE, AND ADDING A NEW DIAGRAM 132-14B TITLED OTAY MESA COMMUNITY PLAN IMPLEMENTATION OVERLAY ZONE; AMENDING CHAPTER 14, ARTICLE 2, DIVISION 5 BY AMENDING SECTION 142.0530; AMENDING CHAPTER 15, ARTICLE 17, DIVISION 1 BY REPEALING SECTIONS 1517.0101, 1517.0102, 1517.0103, AND 1517.0104; AMENDING CHAPTER 15, ARTICLE 17, DIVISION 2 BY REPEALING SECTIONS 1517.0201, 1517.0202, 1517.0203, 1517.0204, AND 1517.0205; AMENDING CHAPTER 15, ARTICLE 17, DIVISION 3 BY REPEALING SECTIONS 1517.0301, 1517.0302, 1517.0303, 1517.0304, 1517.0305, AND 1517.0306; AMENDING CHAPTER 15, ARTICLE 17, DIVISION 4 BY REPEALING SECTIONS 1517.0401, 1517.0402, 1517.0403, AND 1517.0404, RELATING TO THE OTAY MESA COMMUNITY PLAN UPDATE AND MAKING CORRECTIONS TO THE COMMUNITY PLAN IMPLEMENTATION OVERLAY ZONE DIAGRAMS.

§131.0531 Development Regulations Tables of Commercial Zones

The following development regulations apply in each of the commercial zones as shown in Tables 131-05C, 131-05D, and 131-05E.

(a) CN Zones

Table 131-05C
Development Regulations of CN Zones

Development Regulations [See Section 131.0530 for Development Regulations of Commercial Zones]	Zone Designator	Zones		
		1st & 2nd >>	CN-	
	3rd >>	1-	1-	1-
	4th >>	1	2	3
Max permitted residential density⁽¹⁾ through Max structure height (ft)		[No change in text.]		
Max floor area ratio		1.0 ^(3,4)	1.0 ^(3,4)	1.0 ^(3,4)
<i>Floor Area Ratio</i> bonus for mixed use/ Minimum percentage of bonus required for residential use [See Section 131.0546(a)]		[No change in text.]		
Pedestrian paths [See Section 131.0550] through Loading Dock and Overhead Door Screening Regulations [See Section 142.1030]		[No change in text.]		

Footnotes for Table 131-05C

1 through 3 [No change in text.]

4 Within the Otav Mesa Community Plan area, the maximum floor area ratio is 0.30.

(b) CR, CO, CV, and CP Zones

Table 131-05D
Development Regulations of CR, CO, CV, CP Zones

Development Regulations [See Section 131.0530 for Development Regulations of Commercial Zones]	Zone Designator	Zones					
	1st & 2nd >> 3rd >> 4th >>	CR-		CO-	CV-		CP-
		1-	2-	1-	1-		1-
		1		1	2	1	2
Max permitted residential density⁽¹⁾ through Min lot coverage (%)		[No change in text.]					
Max floor area ratio		1.0 ^(4,5)	0.75 ^(4,5)	1.5 ^(4,5)	2.0 ^(4,5)	2.0 ^(4,5)	1.0 ^(4,5)
<i>Floor Area Ratio</i> bonus for mixed use/ Minimum percentage of bonus required for residential use [See Section 131.0546(a)]		[No change in text.]					
<i>Floor Area Ratio</i> bonus for child care. [See Section 131.0546(b)]		applies	--	applies	--	--	--
Pedestrian paths [See Section 131.0550] through Loading Dock and Overhead Door Screening Regulations [See Section 142.1030]		[No change in text.]					

Footnotes for Table 131-05D

1 through 4 [No change in text.]

5 Within the Otay Mesa Community Plan area, the maximum floor area ratio is 0.30.

(c) CC Zones

Table 131-05E
Development Regulations of CC Zones

Development Regulation [See Section 131.0530 for Development Regulations of Commercial Zones]	Zone Designator	Zones									
	1st & 2nd >>	CC-									
	3rd >>	1-2-4-5-	1-2-4-5-	1-2-4-5-	1-2-4-5-3-	4-5-	3-4-	5-	3-4-	5-	
	4th >>	1	2	3	4	5					
Max permitted residential density <u>density</u> (¹) through Lot <u>Lot</u> dimensions, Max Lot <u>Lot</u> Depth (ft)		[No change in text.]									
Setback requirements											
Min Front <i>setback</i> (ft) through Min <i>lot coverage</i> (%)		[No change in text.]									
Max floor area ratio		0.75 ^(4,5)	2.0 ^(4,5)	0.75 ^(4,5)	1.0 ^(4,5)	2.0 ^(4,5)					
<i>Floor Area Ratio</i> bonus for mixed use/ Minimum percentage of bonus required for residential use [See Section 131.0546(a)]		[No change in text.]									
Pedestrian paths [See Section 131.0550] through Loading Dock and Overhead Door Screening Regulations [See Section 142.1030]		[No change in text.]									

Footnotes for Table 131-05E

1 through 4 [No change in text.]

5 Within the Otay Mesa Community Plan area, the maximum *floor area ratio* is 0.30.

§131.0602 Purpose of the IP (Industrial--Park) Zones

(a) [No change in text.]

(b) The IP zones are differentiated based on the uses allowed as follows:

- IP-1-1 allows research and development uses with some limited manufacturing;
- IP-2-1 allows a mix of light industrial and office uses;
- IP-3-1 allows for research and development, office, and residential uses.

§131.0606 Purpose of the IBT (International--Business and Trade) Zone

The purpose of the IBT zone is to provide for a wide variety of base sector industrial and office uses. It is intended to apply in portions of communities adjacent to the international border, other ports of entry, and areas in transition to higher intensity industries.

§131.0622 Use Regulations Table for Industrial Zones

The uses allowed in the industrial zones are shown in Table 131-06B.

Legend for Table 131-06B

[No change in text.]

**Table 131-06B
Use Regulations for Industrial Zones**

Use Categories/ Subcategories [See Section 131.0112 for an explanation and descriptions of the Use Categories, Subcategories, and Separately Regulated Uses]	Zone Designator		Zones									
	1st & 2nd >>		IP-			IL-			IH-		IS-	IBT-
	3rd >>>		1-	2-	<u>3-</u>	1-	2-	3-	1-	2-	1-	<u>1-</u>
	4th >>>		1	1	<u>1</u>	1	1	1	1	1	1	<u>1</u>
Open Space												
Active Recreation	P	P	<u>P</u>	-	P	P	-	P	P	-	-	
Passive Recreation	P	P	<u>P</u>	-	-	-	-	-	-	-	-	
Natural Resources Preservation	-	-	-	-	-	-	-	-	-	-	-	
Park Maintenance Facilities	-	-	-	-	-	-	-	-	-	-	-	
Agriculture												
Agricultural Processing	-	-	-	-	-	-	-	-	-	-	-	
Aquaculture Facilities	-	-	-	P	P	P	P	P	P	P	-	
Dairies	-	-	-	-	-	-	-	-	-	-	-	
Horticulture Nurseries & Greenhouses	-	-	-	P	-	P	P	P	P	-	-	
Raising & Harvesting of Crops	-	-	-	P	-	P	P	P	P	-	-	
Raising, Maintaining & Keeping of Animals	-	-	-	-	-	-	-	-	-	-	-	
Separately Regulated Agriculture Uses												
Agricultural Equipment Repair Shops	-	-	-	P	P	P	P	P	P	P	-	
Commercial Stables	-	-	-	-	-	-	-	-	-	-	-	
Community Gardens	-	-	-	N	N	N	N	N	N	N	-	
Equestrian Show & Exhibition Facilities	-	-	-	-	-	-	-	-	-	-	-	
Open Air Markets for the Sale of Agriculture-related Products & Flowers	-	-	-	-	-	-	-	-	-	-	-	
Residential												
Mobilehome Parks	-	-	-	-	-	-	-	-	-	-	-	

Use Categories/ Subcategories [See Section 131.0112 for an explanation and descriptions of the Use Categories, Subcategories, and Separately Regulated Uses]	Zone		Zones									
	Designator		IP-			IL-			IH-		IS-	IBT-
	1st & 2nd >	>	1-	2-	<u>3-</u>	1-	2-	3-	1-	2-	1-	<u>1-</u>
	3rd >>	>>	1	1	<u>1</u>	1	1	1	1	1	1	<u>1</u>
<i>Multiple Dwelling Units</i>	-	-			<u>P⁽¹⁷⁾</u>	-	-	-	-	-	-	-
<i>Rooming House</i> [See Section 131.0112(a)(3)(A)]	-	-			<u>■</u>	-	-	-	-	-	-	-
<i>Single Dwelling Units</i>	-	-			<u>■</u>	-	-	-	-	-	-	-
Separately Regulated Residential Uses												
<i>Boarder & Lodger Accommodations</i>	-	-			<u>■</u>	-	-	-	-	-	-	-
Companion Units	-	-			<u>■</u>	-	-	-	-	-	-	-
Employee Housing:												
6 or Fewer Employees	-	-			<u>■</u>	-	-	-	-	-	-	-
12 or Fewer Employees	-	-			<u>■</u>	-	-	-	-	-	-	-
Greater than 12 Employees	-	-			<u>■</u>	-	-	-	-	-	-	-
Fraternities, Sororities and Student Dormitories	-	-			<u>■</u>	-	-	-	-	-	-	-
Garage, Yard, & Estate Sales	-	-			<u>■</u>	-	-	-	-	-	-	-
Guest Quarters	-	-			<u>■</u>	-	-	-	-	-	-	-
Home Occupations	-	-			<u>L</u>	-	-	-	-	-	-	-
Housing for Senior Citizens	-	-			<u>L</u>	-	-	-	-	-	-	-
Live/Work Quarters	-	-			<u>■</u>	-	-	-	-	-	L	-
Residential Care Facilities:												
6 or Fewer Persons	-	-			<u>L</u>	-	-	-	-	-	-	-
7 or More Persons	-	-			<u>L</u>	-	-	-	-	-	-	-
Transitional Housing:												
6 or Fewer Persons	-	-			<u>L</u>	-	-	-	-	-	-	-
7 or More Persons	-	-			<u>C</u>	-	-	-	-	-	-	-
Watchkeeper Quarters	L	L			<u>L</u>	L	L	L	L	L	L	<u>L</u>
Institutional												
<i>Churches & Places of Religious Assembly</i>	-	-			<u>■</u>	-	P ^(11,16)	P ⁽¹⁶⁾	-	-	P ^(12,16)	-
Separately Regulated Institutional Uses												
Airports	C	C			<u>C</u>	C	C	C	C	C	C	<u>C</u>
Botanical Gardens & Arboretums	-	-			<u>■</u>	-	-	-	-	-	-	-
Cemeteries, Mausoleums, Crematories	C	C			<u>C</u>	C	C	C	C	C	C	-
Correctional Placement Centers	C	C			<u>C</u>	C	C	C	C	C	C	-
Educational Facilities:												
Kindergarten through Grade 12	-	C			<u>■</u>	-	C	C	-	-	C	-
Colleges / Universities	C	C			<u>C</u>	-	C	C	-	C	C	<u>C</u>
Vocational / Trade School	-	-			<u>■</u>	-	L	L	-	L	L	<u>L</u>
Energy Generation & Distribution Facilities	C	C			<u>C</u>	P	C	P	P	P	C	-

Use Categories/ Subcategories [See Section 131.0112 for an explanation and descriptions of the Use Categories, Subcategories, and Separately Regulated Uses]	Zone	Zones									
	Designator	IP-			IL-			IH-		IS-	IBT-
	1st & 2nd >>	1-	2-	<u>3-</u>	1-	2-	3-	1-	2-	1-	<u>1-</u>
	3rd >>>	1	1	<u>1</u>	1	1	1	1	1	1	<u>1</u>
Exhibit Halls & Convention Facilities	-	C	-	C	C	C	C	C	C	C	<u>C</u>
Flood Control Facilities	L	L	<u>L</u>	L	L	L	L	L	L	L	<u>L</u>
Historical Buildings Used for Purposes Not Otherwise Allowed	C	C	<u>C</u>	C	C	C	C	C	C	C	<u>C</u>
Homeless Facilities:											
Congregate Meal Facilities	-	C	-	-	C	C	-	C	C	C	-
Emergency Shelters	-	C	-	-	C	C	-	C	C	C	-
Homeless Day Centers	-	C	-	-	C	C	-	C	C	C	-
Hospitals, Intermediate Care Facilities & Nursing Facilities	C	C	<u>C</u>	-	C	C	-	C	C	C	-
Interpretive Centers	-	-	-	-	-	-	-	-	-	-	-
Museums	-	-	-	-	-	-	-	-	-	-	-
Major Transmission, Relay, or Communications Switching Stations	C	C	<u>C</u>	C	C	C	P	C	C	C	<u>C</u>
Satellite Antennas	L	L	<u>L</u>	L	L	L	L	L	L	L	<u>L</u>
Social Service Institutions	C	C	<u>C</u>	C	C	C	-	-	C	-	-
Wireless communication facility:											
Wireless communication facility in the public right-of-way with subterranean equipment adjacent to a non-residential use	L	L	<u>L</u>	L	L	L	L	L	L	L	<u>L</u>
Wireless communication facility in the public right-of-way with subterranean equipment adjacent to a residential use	N	N	<u>N</u>	N	N	N	N	N	N	N	<u>N</u>
Wireless communication facility in the public right-of-way with above ground equipment	C	C	<u>C</u>	C	C	C	C	C	C	C	<u>C</u>
Wireless communication facility outside the public right-of-way	L	L	<u>L</u>	L	L	L	L	L	L	L	<u>L</u>
Retail Sales											
Building Supplies & Equipment	-	-	-	P ^(6,15)	P ⁽¹⁵⁾	P ⁽¹⁵⁾	-	P ^(6,15)	P ⁽¹⁵⁾	-	-
Food, Beverages and Groceries	-	-	-	-	-	P ⁽¹⁵⁾	-	-	-	-	-
Consumer Goods, Furniture, Appliances, Equipment	-	-	-	-	P ^(2,15)	P ⁽¹⁵⁾	-	-	P ^(3,15)	-	-
Pets & Pet Supplies	-	-	-	-	-	P ⁽¹⁵⁾	-	-	-	-	-
Sundries, Pharmaceuticals, & Convenience Sales	-	P ^(5,15)	<u>P^(5,15)</u>	P ^(5,15)	P ^(5,15)	P ⁽¹⁵⁾	P ^(5,15)	P ^(5,15)	P ^(4,15)	-	-
Wearing Apparel & Accessories	-	-	-	-	P ^(3,15)	P ^(3,15)	-	-	P ^(3,15)	-	-
Separately Regulated Retail Sales Uses											
Agriculture Related Supplies & Equipment	-	-	-	-	P	P	P	P	P	P	-
Alcoholic Beverage Outlets	-	-	-	-	-	L	-	-	-	-	-
Farmers' Markets											
Weekly Farmers' Market	-	-	-	-	-	L	-	-	-	-	-
Daily Farmers' Market Stands	-	-	-	-	-	L	-	-	-	-	-
Plant Nurseries	-	-	-	-	-	P	-	P	P	-	-

Use Categories/ Subcategories [See Section 131.0112 for an explanation and descriptions of the Use Categories, Subcategories, and Separately Regulated Uses]	Zone	Zones									
	Designator	IP-			IL-			IH-		IS-	IBT-
	1st & 2nd >	1-	2-	<u>3-</u>	1-	2-	3-	1-	2-	1-	<u>1-</u>
	3rd >>	1	1	<u>1</u>	1	1	1	1	1	1	<u>1</u>
4th >>	1	1	<u>1</u>	1	1	1	1	1	1	<u>1</u>	
Retail Farms	-	-	-	-	-	L	-	-	-	-	
Swap Meets & Other Large Outdoor Retail Facilities	-	-	-	C	C	C	C	C	C	C	
Commercial Services											
Building Services	-	-	-	P	P	P	-	P	P	<u>P</u>	
Business Support	-	P ⁽⁸⁾	<u>P⁽⁸⁾</u>	P ⁽⁸⁾	P	P	-	P ⁽⁸⁾	P	<u>P⁽⁸⁾</u>	
Eating & Drinking Establishments	-	P ⁽⁷⁾	<u>P⁽⁷⁾</u>	P ⁽⁷⁾	P ⁽⁷⁾	P	-	P ⁽⁷⁾	P ⁽⁴⁾	<u>P⁽⁷⁾</u>	
Financial Institutions	-	P	-	-	P	P	-	-	P	<u>P</u>	
Funeral & Mortuary Services	-	-	-	-	P	P	-	P	-	-	
Instructional Studios	-	-	-	-	-	P ⁽¹⁶⁾	-	-	-	-	
Maintenance & Repair	-	-	-	P	P	P	-	-	P	<u>P</u>	
Off-site Services	-	P	-	P	P	P	-	P	P	<u>P</u>	
Personal Services	-	-	-	-	P ⁽⁹⁾	P ⁽⁹⁾	-	-	-	-	
Assembly & Entertainment	-	-	-	-	P ^(11,16)	P ⁽¹⁶⁾	-	-	P ^(12,16)	-	
Radio & Television Studios	-	P	-	P	P	P	-	P	P	<u>P</u>	
Visitor Accommodations	-	-	-	-	-	-	-	-	-	-	
Separately Regulated Commercial Services Uses											
Adult Entertainment Establishments:											
Adult Book Store	-	-	-	-	L	L	-	L	L	-	
Adult Cabaret	-	-	-	-	-	L	-	-	-	-	
Adult Drive-in Theater	-	-	-	-	L	L	-	-	-	-	
Adult Mini-Motion Picture Theater	-	-	-	-	L	L	-	-	L	-	
Adult Model Studio	-	-	-	-	L	L	-	-	-	-	
Adult Motel	-	-	-	-	-	-	-	-	-	-	
Adult Motion Picture Theater	-	-	-	-	L	L	-	-	L	-	
Adult Peep Show Theater	-	-	-	-	L	L	-	-	L	-	
Adult Theater	-	-	-	-	L	L	-	-	L	-	
Body Painting Studio	-	-	-	-	L	L	-	-	-	-	
Massage Establishment	-	-	-	-	-	L	-	-	-	-	
Sexual Encounter Establishment	-	-	-	-	-	-	-	-	-	-	
Bed & Breakfast Establishments:											
1-2 Guest Rooms	-	-	-	-	-	-	-	-	-	-	
3-5 Guest Rooms	-	-	-	-	-	-	-	-	-	-	
6+ Guest Rooms	-	-	-	-	-	-	-	-	-	-	
Boarding Kennels/Pet Day Care Facilities	-	N	-	N	L	L	N	N	N	<u>N</u>	
Camping Parks	-	-	-	-	-	-	-	-	-	-	
Child Care Facilities:											
Child Care Centers	L	L	<u>L</u>	-	L	L	-	L	L	<u>L</u>	
Large Family Child Care Homes	-	-	<u>L</u>	-	-	-	-	-	-	-	
Small Family Child Care Homes	-	-	<u>L</u>	-	-	-	-	-	-	-	
Eating and Drinking Establishments Abutting Residentially Zoned Property	-	-	-	-	-	L	-	-	-	-	

Use Categories/ Subcategories [See Section 131.0112 for an explanation and descriptions of the Use Categories, Subcategories, and Separately Regulated Uses]	Zone		Zones									
	Designator		IP-			IL-			IH-		IS-	IBT-
	1st & 2nd >>	>>	1-	2-	<u>3-</u>	1-	2-	3-	1-	2-	1-	<u>1-</u>
	3rd >>>	>>>	1	1	<u>1</u>	1	1	1	1	1	1	<u>1</u>
Fairgrounds	-	C	=	C	C	C	C	C	C	C	=	
Golf Courses, Driving Ranges, and Pitch & Putt Courses	-	C	=	C	C	C	C	C	C	C	=	
Helicopter Landing Facilities	C	C	<u>C</u>	C	C	C	C	C	C	C	<u>C</u>	
Massage Establishments, Specialized Practice	-	-	=	-	-	L	-	-	-	-	=	
Medical Marijuana Consumer Cooperatives	-	-	=	-	-	C	-	-	C	<u>C</u>		
Mobile Food Trucks	P	P	<u>P</u>	P	P	P	P	P	P	P	<u>P</u>	
Nightclubs & Bars over 5,000 square feet in size	-	-	=	-	-	-	-	-	-	-	=	
Parking Facilities as a <i>Primary Use</i> :												
Permanent Parking Facilities	C	C	<u>C</u>	P	C	P	P	P	C	<u>C</u>		
Temporary Parking Facilities	C	C	<u>C</u>	N	C	N	N	N	C	<u>N</u>		
Private Clubs, Lodges and Fraternal Organizations	-	C	=	C	C	C	C	C	C	<u>C</u>		
Privately Operated, Outdoor Recreation Facilities over 40,000 square feet in size ⁽¹³⁾	C	C	<u>C</u>	C	C	C	C	C	C	=		
Pushcarts:												
Pushcarts on Private Property	L	L	<u>L</u>	L	L	L	L	L	L	L	<u>L</u>	
Pushcarts in Public Right-of-Way	N	N	<u>N</u>	N	N	N	N	N	N	N	<u>N</u>	
Recycling Facilities:												
Large Collection Facility	L	N	<u>L</u>	N	N	N	L	L	N	<u>N</u>		
Small Collection Facility	L	L	<u>L</u>	L	L	L	L	L	L	<u>L</u>		
Large Construction & Demolition Debris Recycling Facility	-	-	=	N	-	C	C	N	-	<u>C</u>		
Small Construction & Demolition Debris Recycling Facility	-	-	=	N	-	C	N	N	-	<u>C</u>		
Drop-off Facility	L	L	<u>L</u>	L	L	L	L	L	L	<u>L</u>		
Green Materials Composting Facility	-	-	=	N	-	N	N	N	-	<u>N</u>		
Mixed Organic Composting Facility	-	-	=	C	-	C	N	N	-	<u>C</u>		
Large Processing Facility Accepting at Least 98% of Total Annual Weight of Recyclables from Commercial & Industrial Traffic	-	C	=	L	L	L	L	L	C	<u>L</u>		
Large Processing Facility Accepting All Types of Traffic	-	C	=	N	N	N	N	N	C	<u>L</u>		
Small Processing Facility Accepting at Least 98% of Total Annual Weight of Recyclables From Commercial & Industrial Traffic	-	N	=	L	L	L	L	L	N	<u>L</u>		
Small Processing Facility Accepting All Types of Traffic	-	N	=	N	N	N	N	N	N	<u>N</u>		
Reverse Vending Machines	L	L	<u>L</u>	L	L	L	L	L	L	<u>L</u>		
Tire Processing Facility	-	-	=	C	-	C	C	C	-	=		
Sidewalk Cafes	-	L	=	L	L	L	-	L	L	<u>L</u>		

Use Categories/ Subcategories [See Section 131.0112 for an explanation and descriptions of the Use Categories, Subcategories, and Separately Regulated Uses]	Zone	Zones									
	Designator	IP-			IL-			IH-		IS-	IBT-
	1st & 2nd >>	1-	2-	<u>3-</u>	1-	2-	3-	1-	2-	1-	<u>1-</u>
	3rd >>>	1	1	<u>1</u>	1	1	1	1	1	1	<u>1</u>
Theaters that are outdoor or over 5,000 square feet in size	-	C	=	-	C	C	-	C	-	=	
Sports Arenas & Stadiums	-	C	=	-	C	C	-	C	-	=	
Urgent Care Facilities	-	L	=	-	L	P	-	L	L	=	
Veterinary Clinics & Animal Hospitals	-	N	=	N	L	L	N	N	N	<u>N</u>	
Zoological Parks	-	-	=	-	-	-	-	-	-	=	
Offices											
Business & Professional	-	P	<u>P</u>	-	P	P	-	-	P	<u>P</u>	
Government	-	P	<u>P</u>	-	P	P	-	P	P	<u>P</u>	
Medical, Dental, & Health Practitioner	-	-	=	-	P	P	-	-	P	<u>P</u>	
Regional & Corporate Headquarters	P ⁽¹⁾	P	<u>P⁽¹⁾</u>	P ⁽¹⁾	P	P	-	P ⁽¹⁴⁾	P	<u>P⁽¹⁾</u>	
Separately Regulated Office Uses											
Real Estate Sales Offices & Model Homes	-	-	=	-	-	-	-	-	-	=	
<i>Sex Offender Treatment Treatment & and Counseling Counseling Facilities</i>	-	L	=	-	L	L	-	-	L	=	
Vehicle & Vehicular Equipment Sales & Service											
Commercial Vehicle Repair & Maintenance	-	-	=	P	P	P	P	P	P	<u>P</u>	
Commercial Vehicle Sales & Rentals	-	-	=	P	P	P	P	P	P	=	
Personal Vehicle Repair & Maintenance	-	-	=	P	P	P	-	-	P	=	
Personal Vehicle Sales & Rentals	-	-	=	P	P	P	-	P	P	=	
Vehicle Equipment & Supplies Sales & Rentals	-	-	=	P	-	P	P	P	P	=	
Separately Regulated Vehicle & Vehicular Equipment Sales & Service Uses											
Automobile Service Stations	L	L	<u>L</u>	L	L	L	L	L	L	<u>C</u>	
Outdoor Storage & Display of New, Unregistered Motor Vehicles as a <i>primary use</i>	-	-	=	P	P	P	P	P	P	<u>P</u>	
Wholesale, Distribution, Storage											
Equipment & Materials Storage Yards	-	-	=	P	P	P	P	P	P	<u>P</u>	
Moving & Storage Facilities	-	-	=	P	P	P	P	P	P	=	
Warehouses	-	-	=	P	P	P	P	P	P	<u>P</u>	
Wholesale Distribution	-	P	=	P	P	P	P	P	P	<u>P</u>	
Separately Regulated Wholesale, Distribution, and Storage Uses											
Impound Storage Yards	-	-	=	P	P	P	P	P	P	=	
Junk Yards	-	-	=	C	C	C	C	C	C	=	
Temporary Construction Storage Yards Located off-site	L	L	<u>L</u>	L	L	L	L	L	L	<u>L</u>	
Industrial											
Heavy Manufacturing	-	-	=	-	-	-	P	P	-	=	

Use Categories/ Subcategories [See Section 131.0112 for an explanation and descriptions of the Use Categories, Subcategories, and Separately Regulated Uses]	Zone	Zones									
	Designator	IP-			IL-			IH-		IS-	IBT-
	1st & 2nd >>	1-	2-	<u>3-</u>	1-	2-	3-	1-	2-	1-	<u>1-</u>
	3rd >>	1	1	<u>1</u>	1	1	1	1	1	1	<u>1</u>
4th >>	1	1	<u>1</u>	1	1	1	1	1	1	<u>1</u>	
Light Manufacturing	P ⁽¹⁰⁾	P	P ⁽¹⁰⁾	P	P	P	P	P	P	P	<u>P</u>
Marine Industry	-	-	<u>-</u>	P	P	P	P	P	P	P	<u>P</u>
Research & Development	P	P	<u>P</u>	P	P	P	P	P	P	P	<u>P</u>
Trucking & Transportation Terminals	-	-	<u>-</u>	P	-	P	P	P	P	P	<u>P</u>
Separately Regulated Industrial Uses											
<i>Hazardous Waste Research Facility</i>	C	C	<u>C</u>	C	C	C	C	C	C	C	<u>C</u>
<i>Hazardous Waste Treatment Facility</i>	C	C	<u>C</u>	C	C	C	C	C	C	C	<u>-</u>
Marine Related Uses Within the Coastal Overlay Zone	-	-	<u>-</u>	P	P	P	P	P	P	P	<u>P</u>
Mining and Extractive Industries	-	C	<u>-</u>	C	C	C	C	C	C	C	<u>-</u>
Newspaper Publishing Plants	C	P	<u>C</u>	P	P	P	P	P	P	P	<u>P</u>
Processing & Packaging of Plant Products & Animal By-products Grown Off-premises	-	-	<u>-</u>	P	P	P	P	P	P	P	<u>P</u>
Very Heavy Industrial Uses	-	-	<u>-</u>	-	-	-	C	C	-	-	<u>-</u>
Wrecking & Dismantling of Motor Vehicles	-	-	<u>-</u>	C	C	C	P	C	C	C	<u>-</u>
Signs											
Allowable Signs	P	P	<u>P</u>	P	P	P	P	P	P	P	<u>P</u>
Separately Regulated Signs Uses											
<i>Community Entry Signs</i>	L	L	<u>L</u>	L	L	L	L	L	L	L	<u>L</u>
<i>Neighborhood Identification Signs</i>	-	-	<u>-</u>	-	-	-	-	-	-	-	<u>-</u>
Comprehensive Sign Program	N	N	<u>N</u>	N	N	N	N	N	N	N	<u>N</u>
Revolving <i>Projecting Signs</i>	N	N	<u>N</u>	N	N	N	N	N	N	N	<u>N</u>
<i>Signs with Automatic Changing Copy</i>	N	N	<u>N</u>	N	N	N	N	N	N	N	<u>N</u>
<i>Theater Marquees</i>	-	-	<u>-</u>	-	N	N	-	-	-	-	<u>-</u>

Footnotes for Table 131-06B

- 1 through 16 [No change in text.]
- 17 See Section 131.0623(i).

§131.0623 Additional Use Regulations of Industrial Zones

The additional use regulations identified in this section are applicable to uses where indicated in Table 131-06B.

(a) through (d) [No change in text.]

(e) Light manufacturing and assembly uses in the IP-1-1 and the IP-3-1 zones are limited to the following:

(1) through (7) [No change in text.]

(f) through (i) [No change in text.]

- (i) Residential uses in the IP-3-1 zone are permitted subject to the following:
- (A) Residential development is permitted in accordance with the Business Park - Residential Permitted CPIOZ of the applicable community plan:
- (B) Residential development comprises no more than 49 percent of the total lot area within the Business Park - Residential Permitted CPIOZ: and
- (C) Residential development complies with the development regulations of the residential zone identified in the Business Park - Residential Permitted CPIOZ of the applicable community plan, except that the lot area, lot dimensions, floor area ratio, and setback requirements of the IP-3-1 zone shall apply.

§131.0631 Development Regulations Table for Industrial Zones

The following development regulations apply in the industrial zones as shown in Table 131-06C.

Table 131-06C
Development Regulations for Industrial Zones

Development Regulations [See Section 131.0630 for Development Regulations of Industrial Zones]	Zone Designator	Zones									
		IP-			IL-			IH-		IS-	IBT-
	1st & 2nd >>	1-	2-	3-	1-	2-	3-	1-	2-	1-	1-
	3rd >>	1	1	1	1	1	1	1	1	1	1
<u>Max permitted residential density⁽¹⁾</u>		1,000	=	=	=	=	=	=	=	=	=
<u>Supplemental residential regulations [see Section 131.0623(i)]</u>		applies	=	=	=	=	=	=	=	=	=
<u>Lot Lot Area</u>											
Min Lot Lot Area (sf)		40,000	15,000 ⁽¹⁾	30,000	10,000	40,000					
Max Lot Lot Area (sf)		-	-	-	15,000	=					
<u>Min Lot Lot Dimensions</u>											
Lot Lot Width (ft)		100	75	100	50	100					
Street Frontage (ft)		100 ⁽²⁾	75	100	50	100 ⁽²⁾					
Lot Lot Depth (ft)		200	100	150	100	200					
<u>Setback Requirements</u>											

Development Regulations [See Section 131.0630 for Development Regulations of Industrial Zones]	Zone Designator	Zones									
	1st & 2nd >>	IP-			IL-			IH-		IS-	IBT-
	3rd >>	1-	2-	3-	1-	2-	3-	1-	2-	1-	1-
	4th >>	1			1			1		1	1
Min Front <i>Setback</i> (ft)	20 ⁽³⁾			15 ⁽³⁾			20 ⁽³⁾		10	20 ⁽³⁾	
Std Front <i>Setback</i> (ft)	25 ⁽³⁾			20 ⁽³⁾			25 ⁽³⁾			25 ⁽³⁾	
[See Section 131.0643(b)]											
Min Side <i>Setback</i> (ft)	15			10			15		5/0 ⁽⁸⁾	15	
Min <i>Street Side Setback</i> (ft)	20 ⁽⁴⁾			15 ^{(4),(5)}			20 ^{(4),(5)}		10 ⁽⁹⁾	20 ⁽⁴⁾	
Std <i>Street Side Setback</i> (ft)				20 ^{(4),(5)}			25 ^{(4),(5)}			20 ⁽⁴⁾	
Min Side <i>Setback</i> Abutting Residential (ft)	30			25			30		10	30	
Min Rear <i>Setback</i> (ft)	25			0 ⁽⁶⁾			20		10	25	
Std Rear <i>Setback</i> (ft)				15 ⁽⁶⁾						25	
Min Rear <i>Setback</i> Abutting Residential (ft)	50			25			30		15	50	
Max <i>Structure Height</i> [See Section 131.0644]	-			-			-		-	-	
Max <i>Floor Area Ratio</i>	2.0 ⁽⁷⁾⁽¹¹⁾			2.0 ⁽⁷⁾⁽¹¹⁾			2.0 ⁽¹¹⁾		2.0 ⁽¹¹⁾	2.0 ⁽⁷⁾⁽¹¹⁾	
<i>Street Wall Requirements</i> [See Section 142.1030]	-			applies			applies		-	-	
<i>Outdoor Amenities</i> [See Section 131.0665]	applies			applies			applies		-	applies	
<i>Refuse and Recyclable Material Storage</i> [See Section 142.0805]	applies			applies			applies		Applies	applies	
<i>Loading Dock and Overhead Door Screening Regulations</i> [See Section 142.1030]	applies			applies			applies		applies	applies	

Footnotes for Table 131-06C

1 through 9 [No change in text.]

10 One dwelling unit per specified minimum square feet of lot area as determined in accordance with Section 113.0222.

11 Within the Otay Mesa Community Plan area, the maximum floor area ratio is 0.50 unless a final map has been recorded prior to [INSERT the effective date of this ordinance]. This restriction does not apply to residential development in accordance with Section 131.0623(i).

§131.0643 Setback Requirements in Industrial Zones

- (a) Front *Setback* in the IP, IL, and IH, and IBT Zones. Up to 50 percent of the length of the *building facade* may observe the minimum front *setback* provided the remaining percentage observes the standard front *setback*.

This may occur on a floor-by-floor basis. See Diagram 131-06A.

Diagram 131-06A

Front Setback in the IP, IL, and IH Zones

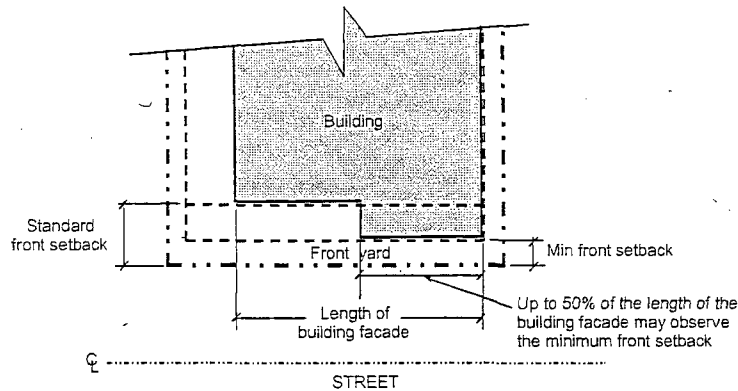

(b) [No change in text.]

(c) Parking *Encroachment* in Street Side Yard of IP, IL, ~~and IH,~~ and IBT

Zones. Parking may encroach up to 5 feet into the required standard street side yard of the IP, IL, and IH zones, but may not be covered or enclosed.

(d) [No change in text.]

(e) Standard/Minimum *Street Side Setback* in the IL, ~~and IH,~~ and IBT Zones.

Up to 50 percent of the length of the *street side building facade* may observe the minimum *street side setback* provided the remaining percentage observes the standard *street side setback*. This may occur on a floor-by-floor basis.

(f) through (g) [No change in text.]

§131.0665 Outdoor Amenities in Industrial Zones

In the IP, IL, ~~and IH,~~ and IBT zones, *development* on a *premises* that exceeds 10 acres in area shall include an outdoor eating and/or recreational facility. The

outdoor amenity shall be at least 2,000 square feet in total area and shall be developed as usable space.

§132.1402 Where the Community Plan Implementation Overlay Zone Applies

- (a) This overlay zone applies to properties that are identified in a community plan as areas requiring supplemental development regulations or processing of a *development permit* and that have been incorporated by ordinance into this overlay zone. Table ~~132-14A~~ 132-14A lists the community plan areas in which this overlay zone has been applied and the corresponding rezone maps that indicate which properties are within the boundaries of the overlay zone. These maps are filed in the office of the City Clerk. The properties within this overlay zone are shown generally on Diagrams ~~132-14A~~ 132-14A through 132-14M.

Table 132-14A

Community Plans with Property in the Community Plan Implementation Overlay Zone

Community Plan	Map Number Showing Boundaries of CPIOZ Area
Clairemont Mesa (See Diagram 132-14A)	C-771.1, B-3951
Linda Vista (See Diagram 132-14C)	C-750
Midway/Pacific Highway Corridor (See Diagram 132-14D)	C-782
Navajo (See Diagram 132-14E)	C-954
<u>Otay Mesa (See Diagram 132-14B)</u>	<u>C-956, B-4300</u>
Pacific Beach (See Diagram 132-14F)	B-37371, B-3857
Peninsula (See Diagram 132-14G)	C-744, C-781
Rancho Bernardo (See Diagram 132-14H)	C-773.1

Community Plan	Map Number Showing Boundaries of CPIOZ Area
Rancho Penasquitos (See Diagram 132-14I)	B-4025
Skyline Paradise Hills (See Diagram 132-14L)	B-4272
Southeastern San Diego (See Diagram 132-14M)	B-4272
University (See Diagram 132-14J)	C-725, C-751.2
Uptown (See Diagram 132-14K)	C-780.2

(b) [No change in text.]

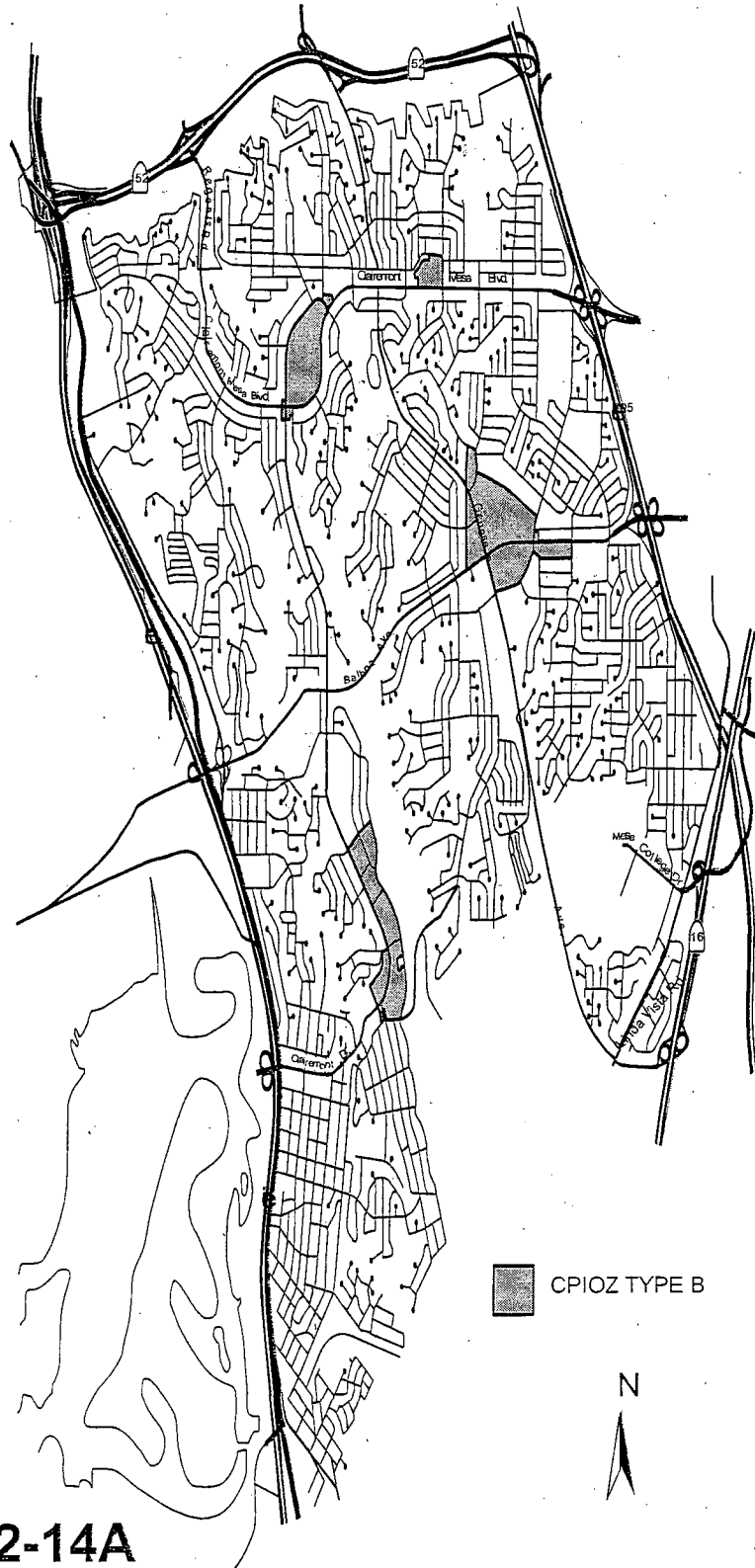

DIAGRAM 132-14A

College Area Clairemont Mesa Community Plan Implementation
Overlay Zone

This is a reproduction of Map Nos. C-771.1 & B-3951 for illustration purposes only.

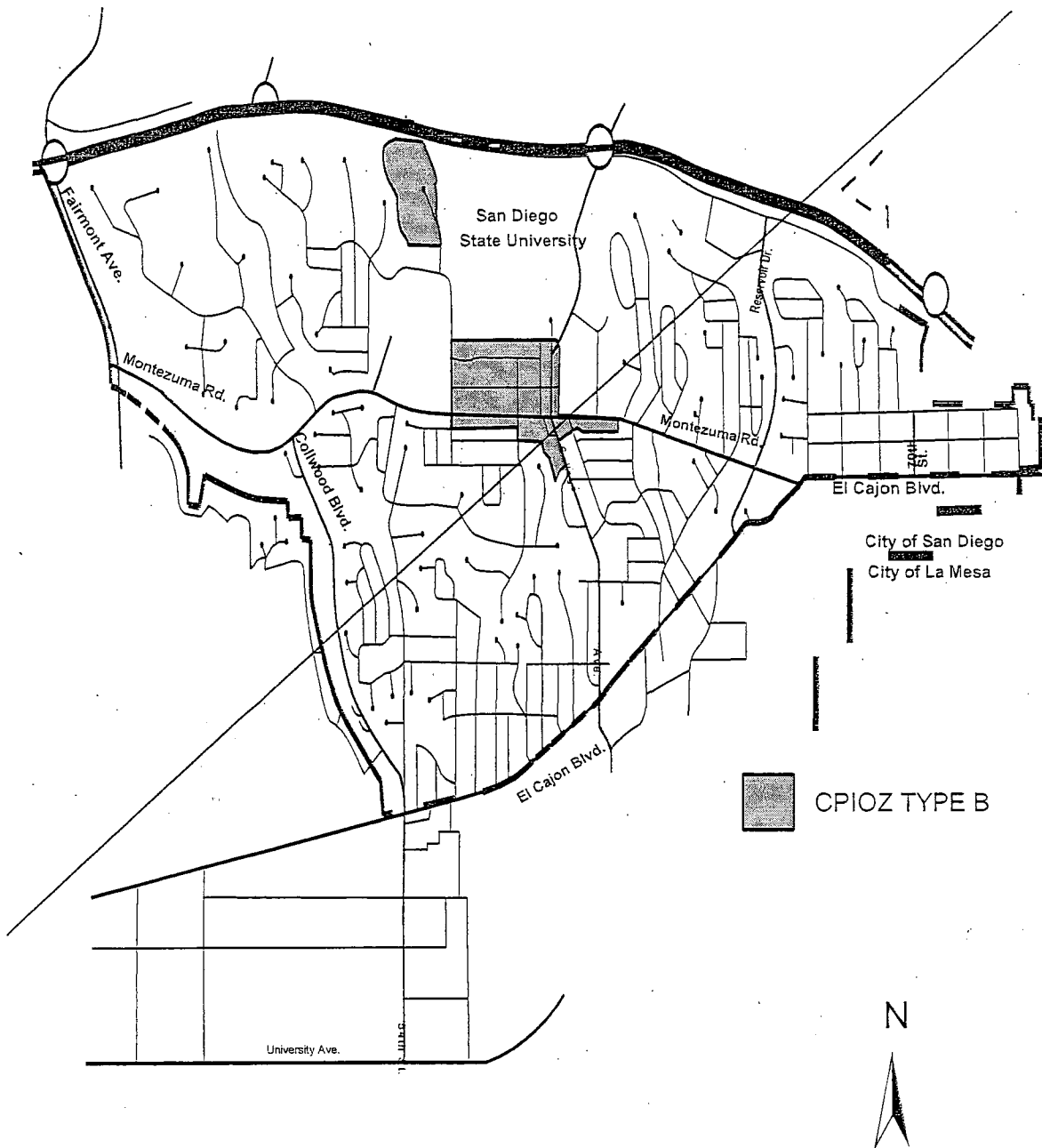

DIAGRAM 132-14B

College Area Community Plan Implementation Overlay Zone

This is a reproduction of Map Nos. C-761.1 for illustration purposes only.

(Added 12-9-1997 by O-18451 N.S.; effective 1-1-2000.)

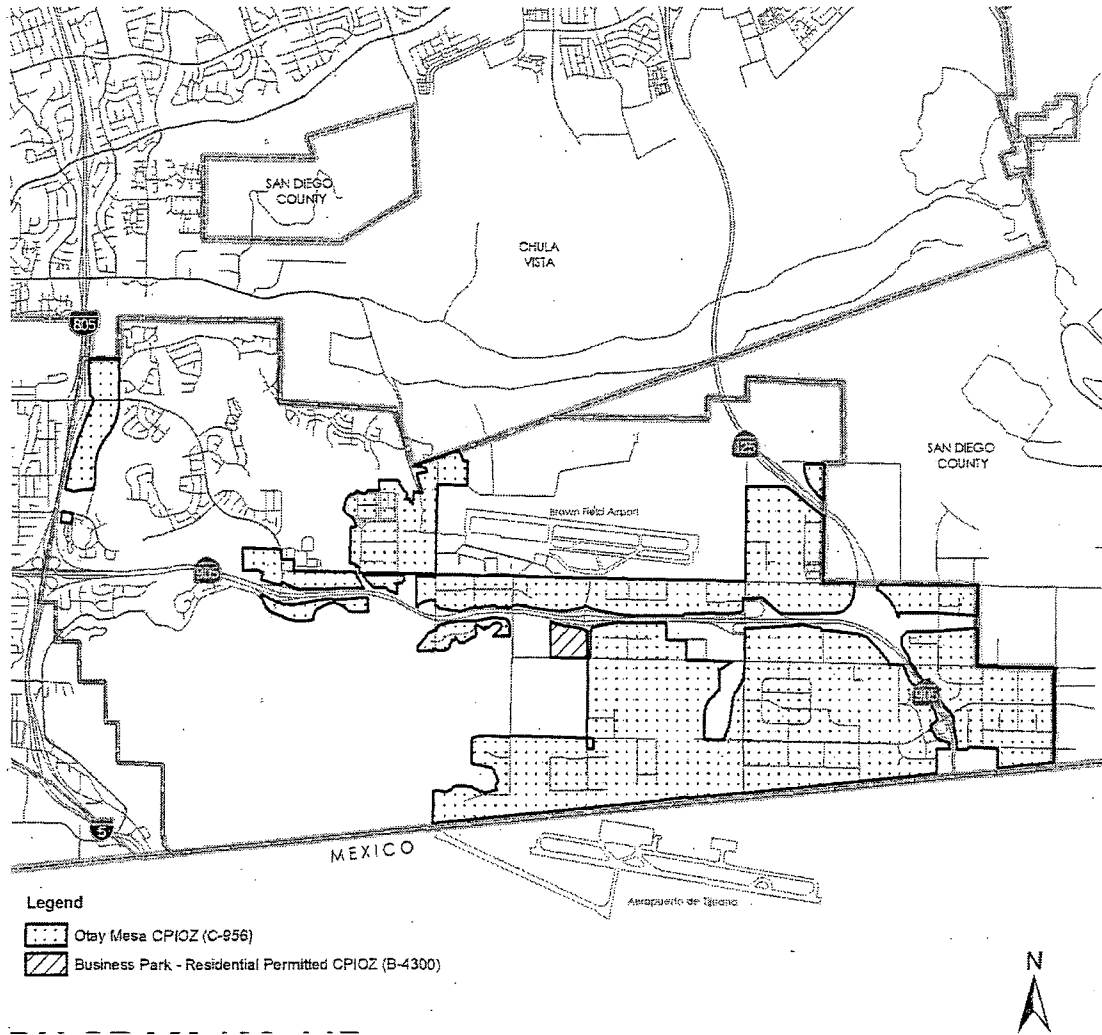

DIAGRAM 132-14B

Otay Mesa Community Plan Implementation Overlay Zone

This is a reproduction of Map Nos. B-4300 & C-956 for illustration purposes only.

§142.0530 Nonresidential Uses — Parking Ratios

- (a) Retail Sales, Commercial Services, and Mixed-Use Development. Table 142-05E establishes the ratio of required parking spaces to building *floor* area in the commercial zones, industrial zones, and planned districts shown, for retail sales uses and for those commercial service uses that are not covered by Table 142-05F or 142-05G. Table 142-05E also establishes the required parking ratios for mixed-use developments in a single *structure* that include an allowed use from at least two of the following use categories: (1) retail sales, (2) commercial services, and (3) offices.

Table 142-05E
Parking Ratios for Retail Sales, Commercial Services, and Mixed-Use Development

Zone	Parking Spaces Required per 1,000 Square Feet of <i>Floor Area</i> Unless Otherwise Noted (<i>Floor Area</i> Includes <i>Gross Floor Area</i> plus below <i>Grade Floor Area</i> and Excludes <i>Floor Area</i> Devoted to Parking)		
	Required Automobile Parking Spaces ⁽¹⁾		
	Minimum Required Outside a <i>Transit Area</i>	Minimum Required Within a <i>Transit Area</i> ⁽²⁾	Maximum Permitted
Commercial Zones [No change in text.]			
Industrial Zones			
IH-1-1 through IS-1-1	[No change in text.]		
<u>IBT-1-1</u>	<u>5.0</u>	<u>4.3</u>	<u>6.5</u>
Planned Districts			
Carmel Valley through Mission Valley: Except CV	[No change in text.]		
Otay Mesa	<u>5.0</u>	<u>4.3</u>	<u>6.5</u>
Old Town through West Lewis Street	[No change in text.]		

Footnotes For Table 142-05E [No change in text.]

- (b) Eating and Drinking Establishments. Table 142-05F establishes the required ratio of parking spaces to building *floor* area in the commercial zones, industrial zones, and planned districts shown, for eating and drinking establishments that are the ~~primary use~~ primary use on a *premises*.

**Table 142-05F
Parking Ratios for Eating and Drinking Establishments**

Zone	Parking Spaces Required per 1,000 Square Feet of Eating and Drinking Establishment ⁽¹⁾ <i>Floor Area Unless Otherwise Noted (Floor Area Includes Gross Floor Area plus below Grade Floor Area and Excludes Floor Area Devoted to Parking)</i>		
	Required Automobile Parking Spaces ⁽²⁾		
	Minimum Required Outside a <i>Transit Area</i>	Minimum Required Within a <i>Transit Area</i> ⁽³⁾	Maximum Permitted
Commercial Zones [No change in text.]			
Industrial Zones			
IH-1-1 through IS-1-1	[No change in text.]		
<u>IBT-1-1</u>	<u>15.0</u>	<u>12.8</u>	<u>25.0</u>
Planned Districts			
Carmel Valley through Mission Valley: Except CV	[No change in text.]		
Otay Mesa	15.0	12.8	25.0
Old Town through West Lewis Street	[No change in text.]		

Footnotes For Table 142-05F [No change in text.]

~~§1517.0101~~ Purpose and Intent

The purpose of the Otay Mesa Development District Ordinance is to create and promote the development of the City's largest and potentially most significant industrial area. It is also the purpose of the Otay Mesa Development District

~~Ordinance to control the use, development intensity, and development design of a primarily industrial area which includes a large commercial subdistrict and a border station mixed-use subdistrict. An objective of the Otay Mesa Development District Ordinance is to expedite the processing of development permit applications.~~

~~It is intended that this District will provide for a full range of industrial uses emphasizing base sector manufacturing and also including wholesaling and distribution, assembly operations, and necessary support services. Because of its location adjacent to the international border, its accessibility to Mexico, and its abundance of large, readily developable parcels, Otay Mesa is a unique area. It has the potential of becoming a major industrial center, not only in San Diego County, but also in the southwestern United States. It is situated near, and accessible to the Mesa de Otay industrial complex in Tijuana B.C., Mexico. It is intended that the Otay Mesa Development District provide the necessary facilities and services to complement the Otay Mesa border crossing. It is also intended that the Otay Mesa Development District Ordinance provide commercial use types necessary to support both the industrial area and the border crossing.~~

~~The Otay Mesa Development District Ordinance provides for, and encourages, agricultural activities as an interim use throughout its area of applicability.~~

§1517.0102 Area of Applicability

~~The regulations contained in this Development District Ordinance, shall apply in the Otay Mesa Development District, the boundaries of which are shown on Map Drawing No. C 855 and described in the appended boundary description filed in the office of the City Clerk under Document No. OO 17985. The Otay Mesa~~

~~Development District contains approximately 3,731 acres of industrially designated land, 240 acres of commercially designated land, 239 acres of canyon and hillside areas, 43 acres of land designated as the Brown Field Flight Activity Zones, 348 acres of land designated as the Brown Field Approach Zones, and a 450-acre Otay International Center Precise Plan Subdistrict.~~

~~§1517.0103~~ **Applicable Regulations**

~~Where not otherwise specified in the Otay Mesa Development District Ordinance, the following provisions of the Land Development Code apply:~~

~~Chapter 11 (Land Development Procedures);~~

~~Chapter 12 (Land Development Reviews);~~

~~Chapter 13 (Zones);~~

~~Chapter 14, Article 1 (Separately Regulated Use Regulations);~~

~~Chapter 14, Article 2, Division 1 (Grading Regulations);~~

~~Chapter 14, Article 2, Division 2 (Drainage Regulations);~~

~~Chapter 14, Article 2, Division 3 (Fence Regulations);~~

~~Chapter 14, Article 2, Division 4 (Landscape Regulations);~~

~~Chapter 14, Article 2, Division 5 (Parking Regulations);~~

~~Chapter 14, Article 2, Division 6 (Public Facility Regulations);~~

~~Chapter 14, Article 2, Division 8 (Refuse and Recyclable Materials Storage Regulations);~~

~~Chapter 14, Article 2, Division 12 (Sign Regulations);~~

~~Chapter 14, Article 3 (Supplemental Development Regulations);~~

~~Chapter 14, Article 4 (Subdivision Regulations);~~

~~Chapter 14, Article 5 (Building Regulations);~~

~~Chapter 14, Article 6 (Electrical Regulations); and~~

Chapter 14, Article 7 (Plumbing and Mechanical Regulations)

~~Where there is a conflict between the Land Development Code and the Otay Mesa Development District Ordinance, the Development District Ordinance applies.~~

§1517.0104 ~~Otay Mesa Development Council~~

(a) ~~Otay Mesa Development Council Created~~

(1) ~~There is hereby created an Otay Mesa Development Council which shall be composed of seven members who shall serve without compensation. The members shall be appointed by the Mayor and confirmed by the City Council. The members shall serve 2-year terms and each member shall serve until his successor is duly appointed and qualified. The members shall be appointed in such a manner that the terms of not more than four members shall expire in any one year. The expiration date shall be April 1. During April of each year, the Mayor may designate one member as Chairman; however, in the absence of such designation, the Board shall, on or after May 15, select a Chairman from among its members.~~

(2) ~~At the time of appointment and during incumbency four members shall be residents or business operators within the Otay Mesa Development District, two shall be property owners within the Otay Mesa Development District, and one member shall be appointed at large. Members of the Council shall include persons who shall be specifically qualified by reason of interest, training or experience in land development, landscape, architecture, planning,~~

~~urban design or other relevant business or profession upon the property values, and development of surrounding areas.~~

- ~~(3) The Council may adopt rules of procedure to supplement those contained within this Development District. Four voting members shall constitute a quorum for the transaction of business and a majority vote; and not less than four affirmative votes shall be necessary to make any Council decision.~~
- ~~(4) The City Manager or his designated representative shall serve as Secretary of the Council and as an ex-officio member and maintain records of all official actions of the Council. The Secretary shall not be entitled to vote.~~
- ~~(5) All officers of the City shall cooperate with the Council and render all reasonable assistance to it.~~
- ~~(6) The Council shall render a report annually on March 31, or on request, to the Mayor.~~

(b) Powers and Duties

~~It shall be the duty of the Council to review and comment on the Facilities Benefit Assessment Program and on major public improvements, particularly drainage facilities. The Council shall submit its recommendations or comments on these items to the Planning Commission and City Council. The Council shall also recommend to the Planning Commission any changes to the regulations, provided such changes are necessary for the proper execution of the adopted plan.~~

The Council shall also consider items of broader scope that may affect the Otay Mesa Development District Ordinance and, when appropriate, offer its recommendations on these matters to the City Manager.

~~§1517.0201~~ Administrative Regulations

(a) General Provisions

- (1) ~~The City Manager shall administer the Otay Mesa Development District Ordinance and ensure compliance with the regulations and procedures of this Ordinance. The Otay Mesa Community Plan as presently adopted or as amended from time to time, shall also be used in reviewing any development permit applied for under this Ordinance.~~
- (2) ~~The City Manager shall not issue any building permit for the erection, construction, conversion, establishment, alteration or enlargement of any building or structure in any portion of the Otay Mesa Development District until an Otay Mesa Development Permit has been obtained by the applicant or owner. Each application for a building permit or occupancy permit shall state therein the purpose for which the proposed building, structure or improvement is intended to be used. Approval of an Otay Mesa Development District Permit is not required for interior modifications, repairs or remodeling, nor any exterior repairs or alterations for which a building permit or occupancy permit is not required.~~

- (3) ~~Expansion or enlargement of previously conforming uses is not permitted in this Development District. Land Development Code Chapter 12, Article 7, Division 1 (General Review Procedures for Previously Conforming Premises and Uses) applies to previously conforming uses with the exception of those provisions which permit expansion or enlargement of a previously conforming use.~~

§1517.0202 General Permit Procedures

- (a) ~~The following projects may be approved or denied by the City Manager in accordance with Process One, and do not require an Otay Mesa Development District Permit.~~
- (1) ~~The proposed use is consistent with the land use designation and text of the Otay Mesa Community Plan.~~
- (2) ~~The proposal is in compliance with this Ordinance, particularly Section 1517.0204 (Financing of Public Facilities), Section 1517.0301 (Permitted Uses), and Section 1517.0305 (Property Development Regulations).~~
- (3) ~~The proposal is within the Otay International Center Precise Plan Subdistrict (Section 1517.0302) and meets all regulations contained therein.~~
- (b) ~~The following projects shall be required to obtain an Otay Mesa Development District Permit in accordance with Section 1517.0203 (Otay Mesa Development District Permit):~~
- (1) ~~Any project that uses transfer of development rights and any project that uses acquired development rights.~~

- (2) ~~Any project within the Canyon and Hillside Subdistrict Section 1517.0303 (Canyon and Hillside Subdistrict).~~
 - (3) ~~Any project which deviates from the regulations of this Ordinance.~~
 - (4) ~~Any project which includes a hotel or motel.~~
 - (5) ~~Any project for which a tentative map has not been approved subsequent to March 14, 1985 (Otay Mesa Reorganization).~~
- (e) ~~Any development within Otay Corporate Center North (VTM 88-1144) or South (VTM 89-0302) is subject to the Otay Corporate Center Design Guidelines, which are to be used in conjunction with this Ordinance.~~

§1517.0203 Otay Mesa Development District Permit

- (a) ~~An application for an Otay Mesa Development District Permit, including fees or deposits, shall be processed in the same manner as an application for a Site Development Permit, in accordance with Land Development Code Chapter 11, Article 2 (Required Steps in Processing) and Chapter 12, Article 6, Division 5 (Site Development Permit Procedures).~~
- (b) ~~In reviewing and approving development plans, the Hearing Officer shall limit review and consideration to the following:~~
 - (1) ~~Landscaping, pursuant to Section 1517.0402 (Landscaping).~~
 - (2) ~~Preservation of existing topography where feasible.~~
 - (3) ~~Layout of site with respect to location and width of driveways and private streets.~~
 - (4) ~~Orientation and location of existing and proposed structures with respect to the site and adjacent properties.~~
 - (5) ~~Location of business support services, if any.~~

- (6) Signs in relation to site location and fronting streets.
- (7) Parking lot location, traffic flow, marking of spaces, placement of lighting and screening from adjacent property.
- (8) Location of loading docks and off-street loading facilities in relation to the adjacent property.
- (9) Outdoor storage area location and screening in relation to adjacent property, streets and highways.
- (10) Building materials utilized for exterior walls and, when appropriate, roofs.
- (11) Building elevations in relation to minimum yard requirements and topographical features of the premises.
- (12) Design guidelines provided in the Community Environmental Design Element of the Otay Mesa Community Plan as presently adopted or hereinafter amended and in Section 1517.0306 (Design Standards) and Section 1517.0404 (Special Regulations).
- (13) Environmental constraints, if any identified during site specific review of the development proposal.
- (14) Needed public improvements.
- (15) The location, size and spacing of projects using business support services in combination with acquired development rights. The location, size and spacing of such projects shall be consistent with the commercial and transportation goals of the Otay Mesa Community Plan and the Progress Guide and General Plan for the City of San Diego.

- (e) ~~An application for an Otay Mesa Development District Permit may be approved, conditionally approved or denied by a Hearing Officer in accordance with Process Three. A Hearing Officer may approve or conditionally approve an Otay Mesa Development District Permit if it is found from the evidence presented that all of the following facts exist:~~
- (1) ~~The application is complete and conforms with all City regulations, policies, guidelines, design standards and density;~~
 - (2) ~~The proposed use and project design meet the purpose and intent of this Ordinance and the Otay Mesa Community Plan;~~
 - (3) ~~The proposed use, because of conditions that have been applied to it, will not be detrimental to the health, safety and general welfare of persons residing or working in the area, and will not adversely affect other property in the vicinity;~~
 - (4) ~~The proposed use will comply with the relevant regulations in the Municipal Code; and~~
 - (5) ~~A plan for the financing of public facilities as provided in Section 1517.0204 (Financing of Public Facilities) of the Otay Mesa Development District has been approved by the City Engineer.~~
- (d) ~~The premises shall be developed in substantial conformance with approved development plans, and substantial conformance shall be determined by the City Manager.~~
- (e) ~~In approving an Otay Mesa Development District Permit, a suspension or variance of any of the Property Development Regulations, as set forth in Section 1517.0305, may be approved by the Hearing Officer, provided~~

~~such suspension or variance shall be based on sufficient showing that there are special circumstances or conditions affecting the property in question, that granting suspension or variance will not be injurious to the neighborhood or otherwise detrimental to the public welfare, and that the granting of the suspension or variance will not adversely affect the Progress Guide and General Plan of the City.~~

- (f) ~~Otay Mesa Development District Permits are issued to development projects and projects to operate facilities. The term "development" includes the following activities: landform alteration, grading, construction or reconstruction of buildings and parking areas, provision of on and off site public facilities, and landscaping. The term "operation" includes the conduct of business on a property consistent with City codes and regulations. The applicant seeking an Otay Mesa Development District Permit that involves the development may be charged development impact fees for both permanent and interim uses. Fees may be prorated for interim uses.~~
- (g) ~~The Hearing Officer's decision may be appealed to the Planning Commission in accordance with Land Development Code Section 112.0506.~~

~~§1517.0204 Financing of Public Facilities~~

- (a) ~~Purpose and Intent~~
- ~~The public health, safety, and welfare require that residents in newly developing areas be adequately served with access, parks, schools, open~~

space, libraries, fire stations and other public facilities concurrent with the need.

(b) Financial Responsibility

All necessary public facilities shall be provided by the project applicant, either directly by the applicant or by other means such as a charge against the area within the Otay Mesa Development District in accordance with the adopted Otay Mesa Community Plan.

(e) Financial Programs for Municipal Facilities

The Municipal Facilities required for the Otay Mesa community shall be financed through these programs:

(1) Facilities Benefit Assessment or Development Impact Fee.

(A) For facilities which already exist outside of the Otay Mesa community, but which require additions or expansions to existing facilities to meet the requirements of the Otay Mesa community: i.e., police and public work facilities.

(B) For new facilities necessitated by the Otay Mesa community: i.e., fire station and transportation facilities.

(C) For facilities which extend beyond the limit of the Otay Mesa community, whose service area is also greater than the Otay Mesa community and the need for which is not solely created by the Otay Mesa community: costs for improvements so constructed may be partially offset by reimbursements from development in those service areas greater than the Otay Mesa community.

~~(D) For facilities within or without the community which are intended for the use of residents such as: street scene improvements (landscaping of the medians and right of way along major streets), traffic signals at the intersection of major streets, and other transportation facilities.~~

~~(2) Improvement District~~

~~An Improvement District under the provisions of state law or local procedural ordinance may be created to create assessments against the land to generate funds to finance facilities which are related to each individual planned district area by amount of benefit received. The facilities to be provided by this improvement district may include, but not be limited to: major perimeter streets; transit improvements; both municipal and other public utilities and drainage facilities contained therein. The boundary of each improvement district will be the centerline of the bordering perimeter streets, or other applicable limit, of each individual development plan area within the Otay Mesa community as the City shall determine.~~

~~(3) On-Site Municipal Improvements~~

~~The on-site municipal facilities, those within the individual neighborhood and not provided by Sections 1517.0204(c)(1)(A) and 1517.0204(c)(1)(B), such as: streets, storm drains, and sewer,~~

~~water, gas, power, and telephone utilities, will be provided by the subdivider under the conventional bonded subdivision agreement.~~

(4) ~~Off-Site Municipal Improvements~~

~~The off-site municipal improvements are those outside of an individual development plan area at the time of its development and not provided under the conventional subdivision process for off-site improvements. The off-site improvements so constructed may be subject to a reimbursement agreement between the persons who constructed the improvements and the City of San Diego.~~

~~Reimbursement pursuant to that agreement will be generated by the subdivider(s) of the subsequent development plan areas, where adjacent, and will be paid to the appropriate subdivider(s) as and when such funds are generated within the subareas covered by the reimbursement agreement.~~

(5) ~~Any other programs approved by the City Council.~~

(6) ~~Implementation~~

~~No final subdivision map, building permit or Otay Mesa Development District Permit for the development of the property shall be approved by the City Manager unless and until the following have been accomplished:~~

- (A) ~~A financing plan for all public facilities needed to support the project, as required by the Otay Mesa Community Plan, has been adopted pursuant to Council Policy 600-28.~~

(B) ~~There has been established either a Facilities Benefit Assessment or a Development Impact Fee applicable to the property covered by the development plan, or a greater area, and the City Council has by resolution, set the amount of such Facilities Benefit Assessment or Development Impact Fee.~~

(7) ~~Financing Agreement~~

~~The requirements of Section 1517.0204(c)(4) (Off Site Municipal Improvements) shall be deemed to be met if the project applicant has entered into a binding financing agreement, approved by the City Council. Said agreement shall require that the project applicant pay its pro rata share of all public facilities needed to support the project.~~

§1517.0205 ~~Transfer of Development Rights Option~~

(a) ~~Purpose and Intent~~

~~The purpose of the transfer of development rights option is to provide a program in the Industrial Subdistrict whereby the owner(s) of property which have not utilized their 5 percent of gross ownership area for business support services may sell their development rights for these uses. This transfer is optional, and the negotiation shall be made exclusively between the private parties owning the subject properties.~~

(b) ~~Determination of Development Rights~~

~~The development rights associated with a lot or an ownership shall herein be defined as the maximum square footage which may be transferred from~~

one legal lot or ownership to a second legal lot or ownership, calculated on permitted area for business support services on the first legal lot or ownership.

(e) ~~Conditions for Transferring Development Rights~~

- (1) ~~The owner of any property in the Industrial Subdistrict may enter into a transfer of development rights agreement.~~
- (2) ~~Any property from which business support uses are transferred may utilize the vacated square footage for any other category of industrial uses permitted in the Industrial Subdistrict.~~
- (3) ~~Any property to which business support uses are transferred must accommodate the acquired square footage within the permitted floor area ratio.~~
- (4) ~~The transfer of development rights shall be limited to a transfer of the total 5 percent of the gross lot or ownership area. Partial transfers shall not be permitted.~~
- (5) ~~Any project utilizing the transfer of development rights shall be required to obtain an Otay Mesa Development District Permit pursuant to Section 1517.0203.~~

(d) ~~Registration of Development Rights~~

~~The party acquiring development rights shall register all development right transfers prior to their utilization, with the City Manager. Failure to register transfer and utilization transactions shall render the right to utilize acquired development rights null and void.~~

~~Registration shall include a copy of the contract between the property owner(s) and the development rights acquired which reflects that the contract has been recorded with the County Recorder, and which shall include:~~

- ~~(1) Street address, legal description and Assessor's parcel number of the property from which the development rights are being transferred;~~
- ~~(2) Name and address of the owner(s) of the property from which the development rights are being transferred and the development rights acquired;~~
- ~~(3) Street address, legal description and Assessor's parcel number of the property to which the development rights are being transferred;~~
- ~~(4) Name and address of the owner(s) of the property to which the development rights are being transferred; and~~
- ~~(5) Square footage of development rights transferred by the property owner(s).~~

~~(e) Conditions for Utilizing Acquired Development Rights~~

~~Development and redevelopment projects utilizing acquired development rights shall comply with all the regulations of the Otay Mesa Development District Ordinance.~~

~~(1) Transfer Area~~

~~Development rights shall be acquired from and utilized in the Industrial Subdistrict as shown on Map Drawing No. C 680.2.~~

~~(2) Maximum Business Support Services~~

~~Acquired development rights for business support services plus permitted area for any property ownership for business support services together may total no more than 20 percent of the gross area of the ownership which receives the development rights, and no single business support services development shall exceed 5 acres in size.~~

(3) ~~Application~~

~~Applications to use acquired development rights shall be filed by the owner(s) of the property where the acquired development rights are to be used, and shall be filed concurrently with applications for permits and/or with the submittal of development plans to the City Manager.~~

§1517.0301 Permitted Uses

(a) ~~Industrial Subdistrict~~

~~No building or improvement or portion thereof shall be erected, constructed, converted, established or enlarged, nor shall any premises be used except for one or more of the following purposes:~~

(1) ~~All uses permitted in the IH 2-1 zone (Land Development Code Section 131.0622 Use Regulations Table for Industrial Zones).~~

(2) ~~Research Services.~~

(A) ~~Scientific research and development activities.~~

~~Administrative offices shall be permitted in conjunction with the primary use where such office use is accessory and subordinate to the primary use.~~

- (B) ~~Manufacturing, fabrication, and/or production of products requiring advance technology and skills and directly related to research and development activities on the premises.~~
- (C) ~~Manufacturing of biochemical research and diagnostic compounds for scientific research and developmental testing purposes.~~
- (D) ~~Production of experimental products, and the manufacturing of such products as may be necessary to the development of production or operating systems where such systems are to be installed and operated at another location.~~
- (E) ~~Medical, dental, biological and X-ray laboratories.~~
- (3) ~~General Industrial~~
~~Establishments engaged in the custom manufacturing, manufacturing, fabricating, assembly, testing, repair, servicing, and processing of a wide range of products. Administrative offices shall be permitted in conjunction with the primary use where such office use is accessory and subordinate to the primary use.~~
- (4) ~~Motor Vehicles and Equipment~~
 - (A) ~~Aircraft, automobile and boat repair shops~~
 - (B) ~~Aircraft and accessories, sales or rental~~
 - (C) ~~Boats and accessories, sales or rental~~
 - (D) ~~Farm and construction vehicles, farm equipment, farm and garden supplies, sales or rental~~

- (5) Construction Sales and Service
 - (A) Equipment and tool rental establishments
 - (B) Storage yards for building materials storage contractor's plant or storage yard, concrete pipe storage, impound storage yard
 - (C) Lumber sales
 - (D) Building and building maintenance materials
 - (E) Fire fighting equipment and supplies sales
 - (F) Swimming pools and supplies sales
- (6) Wholesaling, Storage and Distribution
 - (A) Storage warehouses
 - (B) Wholesale distribution of:
 - (i) Drugs, chemicals, and allied products
 - (ii) Dry goods and apparel
 - (iii) Groceries and related products
 - (iv) Electrical goods
 - (v) Hardware, plumbing, and heating equipment and supplies
 - (vi) Machinery, equipment and supplies
 - (vii) Tobacco and tobacco products
 - (viii) Beer, wine and distilled alcoholic beverages
 - (ix) Paper, paper products, and kindred supplies
 - (x) Furniture and home furnishings
 - (xi) Fuel and ice

- (xii) ~~Agricultural products~~
 - (xiii) ~~Motor vehicles and automotive equipment~~
 - (C) ~~Truck terminals and freight forwarding facilities.~~
 - (D) ~~Customs brokerage operations.~~
 - (E) ~~Postal services.~~
 - (F) ~~Truck and tractor trailer parking facilities.~~
- (7) ~~Business Support Services~~
- (A) ~~These uses shall be limited to 5 percent of the gross ownership area. Projects utilizing business support service uses may be processed by using the Commercial Subdistrict Property Development Regulations contained in Section 1517.0305.~~
 - (B) ~~The use of any property for business support service uses requires notice be given by certified mail to the City Manager for the purpose of recording the location and quantities of property to be used for such purposes. Such notice shall be filed with the City Manager prior to the City Manager's approval or denial of the ministerial permit.~~
 - (C) ~~Business support service uses shall be the same as Commercial Subdistrict uses except that hotels, motels, and automobile and truck sales and rental agencies shall not be permitted.~~
- (8) ~~Major Utilities and Services~~

~~(A) Trade schools instructing in subjects related to a use permitted within the Industrial Subdistrict~~

~~(B) Emergency hospitals~~

~~(C) Central electric plants~~

~~(D) Public utility electric substations~~

~~(E) Data processing facilities~~

~~(9) Agricultural Uses~~

~~Uses permitted in the AR-1-2 or AR-1-1 zones (Land Development Code Section 131.0322 Use Regulations Table for Industrial Zones) except for single dwelling units and churches.~~

~~(b) Commercial Subdistricts~~

~~No building or improvement or portion thereof shall be erected, constructed, converted, established or enlarged, nor shall any premises be used except for one or more of the following purposes:~~

~~(1) Uses identified as business support uses in Section 1517.0301(a)(7) (Business Support Services)~~

~~(2) Business and professional office uses~~

~~(3) Labor unions and trade associations~~

~~(4) Medical, dental, biological and x-ray laboratories~~

~~(5) Hotels and motels~~

~~(6) Retailing of consumer convenience goods and dispensing of consumer services from the following establishments:~~

~~(A) Barber shops~~

~~(B) Beauty shops~~

- (C) Drug stores
 - (D) Recreational facilities
 - (E) Stationers
 - (F) Automobile and truck sales and rental agencies
 - (G) Automobile wash establishments
 - (H) Financial institutions (including currency exchanges)
 - (I) Photographic equipment, supplies, and film processing stores
 - (J) Restaurants and bars, including live entertainment
 - (K) Tire sale, repair and recapping establishments if entirely within an enclosed building
 - (L) Custom shops for curtains, draperies, floor covering, upholstery and wearing apparel
 - (M) Laundries if entirely within an enclosed building
 - (N) Lithography shops and printing establishments
 - (7) Within the area bounded on the north by Otay Mesa Road, on the south by Airway Road, on the west by Alisa Court (to Airway Road), all uses described in section 1517.0301(a) are also permitted.
- (e) ~~Additional Uses—Commercial and Industrial Subdistricts~~
- ~~Other uses shall be permitted within the Commercial and Industrial Subdistricts as follows:~~
- (1) ~~Accessory uses for any of the foregoing permitted uses including signs. As specified in Land Development Code Chapter 14, Article~~

~~2, Division 12 (Sign Regulations), for sign regulatory purposes this Otay Mesa Development District shall be deemed to be an industrial zone.~~

- ~~(2) Any other uses which the Planning Commission finds, in accordance with Process Four, to be similar in character to the uses enumerated in the Otay Mesa Development District Ordinance and which are clearly within the intent and purpose of the Otay Mesa Development District. The adopted resolution embodying any such finding shall be filed in the office of the City Clerk.~~

~~§1517.0302 Otay International Center Precise Plan Subdistrict~~

~~In the Otay International Center Precise Plan Subdistrict identified on Map Drawing No. C 680.2, the property development regulations as set forth within the Otay International Center Precise Plan shall apply, and no building or improvement or portion thereof, shall be erected, constructed, converted, established, altered or enlarged, nor shall any premises be used except for one or more of the land uses permitted on the parcel by the Precise Plan.~~

~~§1517.0303 Canyon and Hillside Subdistrict~~

- ~~(a) The Canyon and Hillside Subdistrict, as identified on Map Drawing No. C 680 shall be applied to properties having slopes with a natural gradient in excess of 25 percent and a minimum elevation differential of 50 feet.~~
- ~~(b) All projects within this Subdistrict shall require an Otay Mesa Development District Permit (Section 1517.0201(a)(2) Administrative Regulations). The regulations contained in Land Development Code Chapter 14, Article 3, Division 1 (Environmentally Sensitive Lands~~

~~Regulations) Section 1517.0305 (Property Development Regulations)~~
~~shall be used in processing the Otay Mesa Development District Permit.~~

- (c) ~~Permitted Uses: Industrial Subdistrict uses may be considered as appropriate uses in conjunction with processing of the Otay Mesa Development District Permit.~~

§1517.0304 ~~Brown Field Flight Activity Subdistrict and Approach Zone~~

~~The Brown Field Flight Activity Subdistrict and Approach Zone, as identified on Map Drawing No. C 680.2, shall be applied to properties adjacent to the ends of the runways which aircraft use on either arrivals or departures.~~

~~The regulations contained in Section 1517.0305 (Property Development Regulations) and Section 1517.0404 (Special Regulations) shall be used in processing the application.~~

- (a) ~~Permitted Uses—Flight Activity Subdistrict~~

~~No building or improvement, or portion thereof, shall be erected, constructed, converted, established or enlarged, nor shall any premises be used except for one or more of the following purposes:~~

- (1) ~~Wholesaling, storage and distribution, however, warehousing or storage of flammables, explosives, and corrosives shall not be permitted.~~

- (2) ~~Agricultural uses permitted in the AR 1 1 or AR 2 1 zones (Land Development Code Section 131.0322) except for single dwelling units and churches.~~

- (b) ~~Permitted Uses—Approach Zones~~

~~Permitted uses in the approach zones shall be the same as the permitted uses in the underlying Industrial or Commercial Subdistricts.~~

~~(c) Federal Aviation Administration Determination Required~~

~~In addition to compliance with Section 1517.0305 (Property Development Regulations) and Section 1517.0306 (Design Standards) all proposed projects within the Brown Field Flight Activity Subdistrict and Approach Zones shall obtain a letter from the Air Traffic Division of the Western Pacific Regional Office of the Federal Aviation Administration stating that the proposed construction has been determined not to be a hazard to air navigation and such determination has become final.~~

§1517.0305 Property Development Regulations

~~No building or portion thereof shall be erected, constructed, converted, established, altered, enlarged, nor shall any legal lot or premises be used unless the legal lot or premises and building comply with the following regulations and standards:~~

~~(a) Front, rear and street side yard setbacks on all Class I roadways as identified on Map Drawing No. C 680.2 shall be 30 feet.~~

~~(b) Two adjoining lots which have a common interior side or rear lot line and which are developed concurrently may be developed with zero side yard setbacks on said common lot line, provided that the opposite side yard setback is not less than 30 feet.~~

~~(c) All applications for the development of buildings or objects higher than 150 feet above ground level within this district shall be required to obtain~~

Federal Aviation Administration Determination as provided in Section
1517.0304(c).

Table 1517-03A
Lot Requirements

	SUBDISTRICT	
	Industrial	Commercial Lot
Area	30,000 sq. ft.	10,000 sq. ft.
Street Frontage	100 ft. ⁽⁴⁾	100 ft.
Lot Width	100 ft.	100 ft.
Minimum Yards		
— Front Yard Setback	20 ft.	15 ft.
— Interior Side Yard	15 ft.	0 ft.
— Abutting residential zone	30 ft.	
— Street Side Yard Setback	20 ft.	15 ft.
— Rear Yard Setback	25 ft.	10 ft.
— Abutting residential zone	50 ft.	
— Floor Area Ratio	2.0	2.0

⁽⁴⁾ Any lot which fronts on a turnaround or curving street having a radius of curvature of less than 100 feet, the minimum frontage shall be 60 feet.

§1517.0306 Design Standards

(a) Building Materials and Construction Types

(1) Industrial Subdistrict

Any building using other than concrete tilt up, precast concrete, concrete block, wood or similar materials as the basic type of construction for 75 percent of the exterior walls shall require an Otay Mesa Development District Permit.

(2) Commercial Subdistrict and Business Support Services Where Processed Ministerially.

Any building using other than concrete tilt up, precast concrete, concrete block, wood or similar materials as the basic type of construction for 75 percent of the exterior walls shall require an

~~Otay Mesa Development District Permit. Exterior surfaces of wood frame constructed walls shall be wood or stucco.~~

(b) ~~Wall Surface Treatment~~

- (1) ~~Buildings with any single exterior wall surface area exceeding 5,000 square feet shall provide architectural reveals to break up the surfaces of individualized wall panels. Architectural reveals shall have a minimum depth of 0.75 inch and be applied to an area greater than one percent of the exterior surface area of all building walls. Building wall reliefs, appliques, and building plane variations may be substituted in place of architectural reveals at the discretion of the City Manager. Where such substitutions are provided they shall meet the same minimal dimensional requirements as architectural reveals above.~~
- (2) ~~Buildings with any single exterior wall surface area exceeding 20,000 square feet, in addition to architectural reveals as required by Section 1517.0306(b)(1), shall contain variations in the exterior wall surface texture of all walls. Variations in texture may include molded patterns, painted, or sandblasted surfaces and shall be applied to the upper portion of all exterior walls. Variations in texture shall be applied so that at least 10 percent but not more than 40 percent of any applicable exterior wall surface is treated.~~

(c) ~~Roofs~~

~~No mechanical equipment, tank, duct, elevator enclosure, cooling tower or mechanical ventilator or air conditioner shall be erected, constructed, converted, established, altered, or enlarged on the roof of any building, unless all such equipment and appurtenances are fully screened by:~~

- ~~(A) The extension of the building side walls to a height no less than the highest piece of equipment or appurtenances; or~~
- ~~(B) A structure whose walls or sides may include grillwork, louvers, and/or latticework.~~

§1517.0401 Fence Regulations

- ~~(a) Regulations governing fences and walls shall be the same as set forth in Land Development Code Chapter 14, Article 2, Division 3 (Fence Regulations).~~
- ~~(b) In addition to the above, the following regulations apply:
 - ~~(1) Chain link fences shall be vinyl coated.~~
 - ~~(2) Coiled, spiraled, or rolled fencing such as razor wire or concertina wire shall not be permitted.~~~~

§1517.0402 Landscaping

~~Unless otherwise specified below, the landscape regulations of the Land Development Code Chapter 14, Article 2, Division 4, apply.~~

- ~~(a) Front and Street Side Yard Setbacks as described in Section 1517.0305:
 - ~~(1) Industrial Subdistrict – Front and street side yard setbacks shall be 100 percent landscaped. Driveways, pedestrian ways outside the right of way, and other city required improvements are exempted from this requirement.~~~~

- (2) ~~Commercial Subdistrict—A minimum of 75 percent of front and street side yard setbacks shall be landscaped. Driveways, pedestrian ways outside the right of way, and other city required improvements are exempted from this requirement.~~
- (3) ~~Properties with front, rear and street side yard setbacks that are adjacent to Class I roadways identified and designated on Map Drawing No. C-680.2 shall landscape 100 percent of the required minimum yard setback area. Where any portion of a building is set back more than 30 feet from the right of way, an equal reduction in the depth of the 100 percent landscaped yard setback will be permitted; however, in no instance shall the 100 percent landscaped yard setback be less than 20 feet. Where the yard setback adjacent to the right of way on Class I roadways is reduced to less than 30 feet the portion that is not required to be landscaped may be used for parking or a combination of parking and driveways.~~
- (b) ~~Interior Side and Rear Yards—Industrial and Commercial Subdistricts~~
- (1) ~~A 5-foot wide landscape strip shall be planted in all interior side yard setbacks from the front or street side yard to a point 5 feet beyond the front or street side of the building.~~
- (2) ~~Developments that utilize the zero side yard setback option described in Section 1517.0305 shall not be required to landscape the common interior side yard setback area unless said area is used for parking.~~

(e) ~~Parking Areas~~

~~An area equivalent to 3 percent of the parking area shall be landscaped within the parking area.~~

(d) ~~Points~~

(1) ~~Front, street side, and interior side yards shall be planted with a combination of trees and shrubs to achieve a minimum of .025 points per square foot of total area.~~

(2) ~~Parking areas shall be planted with a combination of trees and shrubs to achieve a minimum of .015 points per square foot of total area.~~

(3) ~~The point schedule in Table 1517-04A shall be used:~~

**Table 1517-04A
Point Schedule**

	Points
Trees	
— 48 inch box	100
— 36 inch box	55
— 24 inch box	30
— 15 gallon	10
— 5 gallon	3
Shrubs	
— 15 gallon	10
— 5 gallon	4
— 1 gallon	2
Existing Trees in Required Landscape Areas	
— 8 inch caliper or greater	120
— 4-8 inch caliper	100

(e) ~~Maintenance~~

~~All required landscaped areas shall be maintained free of debris and litter and all plant material shall be maintained in a healthy growing condition.~~

~~Diseased or dead plant material shall be satisfactorily treated or replaced within 30 days with material of an equivalent point value.~~

(f) ~~Irrigation~~

~~An automatic irrigation system shall be provided as required for proper irrigation, development and maintenance of the vegetation. The design of the system shall provide adequate support for the vegetation selected.~~

(g) ~~Landscape Application Procedures~~

(1) ~~Permit applications shall be accompanied by a site plan and supplementary information required to establish that all landscaping shall be developed in conformance with the Landscape Guidelines of the Land Development Manual.~~

(2) ~~At the time of an application for a certificate of occupancy, the applicant will provide verification that the landscape improvements are in conformance with the approved landscape plan and in conformance with the Landscape Guidelines of the Land Development Manual.~~

(3) ~~If, at the time of an application for a certificate of occupancy, the required landscaping is not yet in place, the City Manager may, at his discretion, require the owner to make fiscal arrangements by bond, certificate of deposit, or a nonrevocable letter of credit to ensure that the landscaping is installed. This option shall be considered by the City Manager only in cases when demonstrated extenuating circumstances prevent the installation of landscape improvements before the issuance of the occupancy permit. The~~

~~fiscal arrangements shall reflect the cost of required landscaping not yet in place to ensure that such landscaping is installed. Any owner wishing to make such fiscal arrangements must also grant license to the City or its licensed and contracted agent, to enter upon the land for the purposes of installing the required landscaping, in the event that such landscaping is not in place by the date specified in the agreement. Such fiscal arrangements shall be released when landscape improvement verification is received.~~

§1517.0403 Parking Regulations

- (a) ~~Every premises used for one or more of the permitted uses listed in Section 1517.0301 shall be provided with minimum off street parking accommodations on the same premises or on a lot or premises lying within 500 feet horizontal distance from the premises on which the permitted use or uses are located, in accordance with Land Development Code Chapter 14, Article 2, Division 5 (Parking Regulations).~~
- (b) ~~The alteration or conversion of any property which results in increasing the need for parking facilities shall require that an agreement or covenant be executed by the owners of the affected properties. Such agreement or covenant shall be recorded in the office of the County Recorder and a copy filed with the City Manager.~~
- (c) ~~The land used for required off premises parking shall be owned or controlled by the owner or owners of the use requiring the off premises parking. In this connection, the owner or lessee of record of the off premises parking site shall furnish evidence satisfactory to the City~~

~~Manager that he owns or has sufficient interest in such property to provide the off-premises parking required by this section.~~

- (d) ~~Where off premises parking is to be provided on property owned or controlled by a person other than the applicant, there shall have been recorded in the office of the County Recorder an agreement or covenant executed by the owners of such property on which the off premises parking is proposed for the benefit of the City to the effect that the owners will continue to maintain such parking space so long as the off premises parking is required by this Code. Such agreement or covenant will also recite that this title to and the right to use the lots upon which the parking spaces are to be provided will be subservient to the title to the premises where the primary use which it serves is situated and shall warrant that such lots are not and will not be made subject to any other agreement or covenant or contract for such use without the prior written consent of the City. In the event the owners of such use shall thereafter provide parking space equal in area under the same conditions as to ownership upon another lot other than the premises made subservient in a prior such agreement or covenant, the City will upon written application therefore accompanied by the filing of a similar agreement or covenant, release such original subservient premises from such prior covenant.~~
- (e) ~~The owners shall furnish, at their own expense, such title reports or other evidence as the City may require to insure compliance with the provisions of this section.~~

- (f) ~~Off-premises parking spaces required by this section shall be maintained so long as they are required by the provisions of this section. In no event shall off-premises parking facilities which are provided to meet the requirements of this section be considered as providing any of the required spaces for any other structure or use.~~
- (g) ~~Where ambiguity exists in the application of these off-street parking requirements or when any use not specified in Section 1517.0301 is found by the Planning Commission to be a permitted use in accordance with Section 1517.0301(c)(2), the off-street parking requirements shall be determined by the City Manager.~~
- (h) ~~Driveway Widths and Locations~~
~~Driveway width and spacing shall be in conformance with Land Development Code Section 142.0560.~~

§1517.0404 Special Regulations

- (a) ~~All uses, except storage, loading and outdoor work, shall be conducted entirely within an enclosed building. Outdoor work; storage of merchandise, material, and equipment is permitted in interior side or rear yards, provided the area is completely enclosed by sight-obscuring walls, fences, or a combination thereof.~~
- (b) ~~Lighting~~
 - (1) ~~Lighting in all subdistricts of the Otay Mesa Development District shall comply with Land Development Code Section 142.0740.~~
 - (2) ~~In addition, where attached to buildings, lighting fixtures and structures shall be architecturally integrated into the building.~~

- (c) ~~Glazing—Silver colored reflective glass shall not be permitted.~~
- (d) ~~Screening~~
 - (1) ~~All storage and outdoor work areas shall be screened with sight-obscuring walls or fences from public rights-of-way and neighboring properties. All walls and fences shall be constructed of materials and finishes that are compatible with adjacent buildings.~~
 - (2) ~~Storage shall not be permitted within required front or street side yard setback areas, or in rear yards that are adjacent to the right-of-way.~~
 - (3) ~~Refuse containers shall be screened with 6 feet or higher sight-obscuring walls or fences and shall be located at least 25 feet from pedestrian building entries and entry drives.~~
 - (4) ~~Exterior facilities such as plumbing, heating, cooling, electrical, chemical processing, compressors, motors, and incinerators shall be screened with sight-obscuring walls or fences.~~
- (e) ~~Off-street Loading Facilities~~

~~Loading or unloading facilities shall be so sized and located so that they do not require trucks to be located in required front or street side yards during loading and unloading activities.~~
- (f) ~~On-site Access and Circulation~~
 - (1) ~~Properties within the Commercial Subdistrict may take access onto Otay Mesa Road and Airway Road by providing an additional~~

~~traffic lane in front of all commercial properties as approved by the
City Engineer.~~

~~(2) Where the maneuvering of trucks and service vehicles may conflict
with employee pedestrian circulation, pedestrian accessways shall
be clearly marked and identified.~~

~~(g) Signs~~

~~Signs in all Subdistricts of the Otay Mesa Development District shall
comply with Land Development Code Chapter 12, Article 2, Division 12
(Sign Regulations).~~

SMT:als
02/19/14
09/11/14 Cor.Copy
09/23/14 Cor.Copy.1
Or.Dept:DSD
Doc. No. 681830_5

344 DIEGO CV
11 FEBRU 2014
RECEIVED

Passed by the Council of The City of San Diego on MAR 25 2014, by the following vote:

Councilmembers	Yeas	Nays	Not Present	Recused
Sherri Lightner	<input checked="" type="checkbox"/>	<input type="checkbox"/>	<input type="checkbox"/>	<input type="checkbox"/>
District 2 (Vacant)	<input type="checkbox"/>	<input type="checkbox"/>	<input type="checkbox"/>	<input type="checkbox"/>
Todd Gloria	<input checked="" type="checkbox"/>	<input type="checkbox"/>	<input type="checkbox"/>	<input type="checkbox"/>
Myrtle Cole	<input checked="" type="checkbox"/>	<input type="checkbox"/>	<input type="checkbox"/>	<input type="checkbox"/>
Mark Kersey	<input checked="" type="checkbox"/>	<input type="checkbox"/>	<input type="checkbox"/>	<input type="checkbox"/>
Lorie Zapf	<input checked="" type="checkbox"/>	<input type="checkbox"/>	<input type="checkbox"/>	<input type="checkbox"/>
Scott Sherman	<input checked="" type="checkbox"/>	<input type="checkbox"/>	<input type="checkbox"/>	<input type="checkbox"/>
David Alvarez	<input type="checkbox"/>	<input type="checkbox"/>	<input checked="" type="checkbox"/>	<input type="checkbox"/>
Marti Emerald	<input checked="" type="checkbox"/>	<input type="checkbox"/>	<input type="checkbox"/>	<input type="checkbox"/>

Date of final passage APR 11 2014

AUTHENTICATED BY:

KEVIN L. FAULCONER
Mayor of The City of San Diego, California.

(Seal)

ELIZABETH S. MALAND
City Clerk of The City of San Diego, California.

By Karen Cook, Deputy

I HEREBY CERTIFY that the foregoing ordinance was not finally passed until twelve calendar days had elapsed between the day of its introduction and the day of its final passage, to wit, on

MAR 11 2014, and on APR 11 2014

I FURTHER CERTIFY that said ordinance was read in full prior to passage or that such reading was dispensed with by a vote of five members of the Council, and that a written copy of the ordinance was made available to each member of the Council and the public prior to the day of its passage.

(Seal)

ELIZABETH S. MALAND
City Clerk of The City of San Diego, California.

By Karen Cook, Deputy

Office of the City Clerk, San Diego, California

Ordinance Number O- 20361